

# FOREST TYPE MAP

(OF PROPOSED FOREST/REVENUE FOREST LAND DIVERSION TO LAY PIPELINE FOR SPONGE IRON PLANT NEAR GERWANI  
AND PROPOSED CAPTIVE POWER PLANT OF 10MW IN TARAIMAL, RAIGARH)

TOPOSHEET NO. 64-JN8

SCALE - 1:50,000

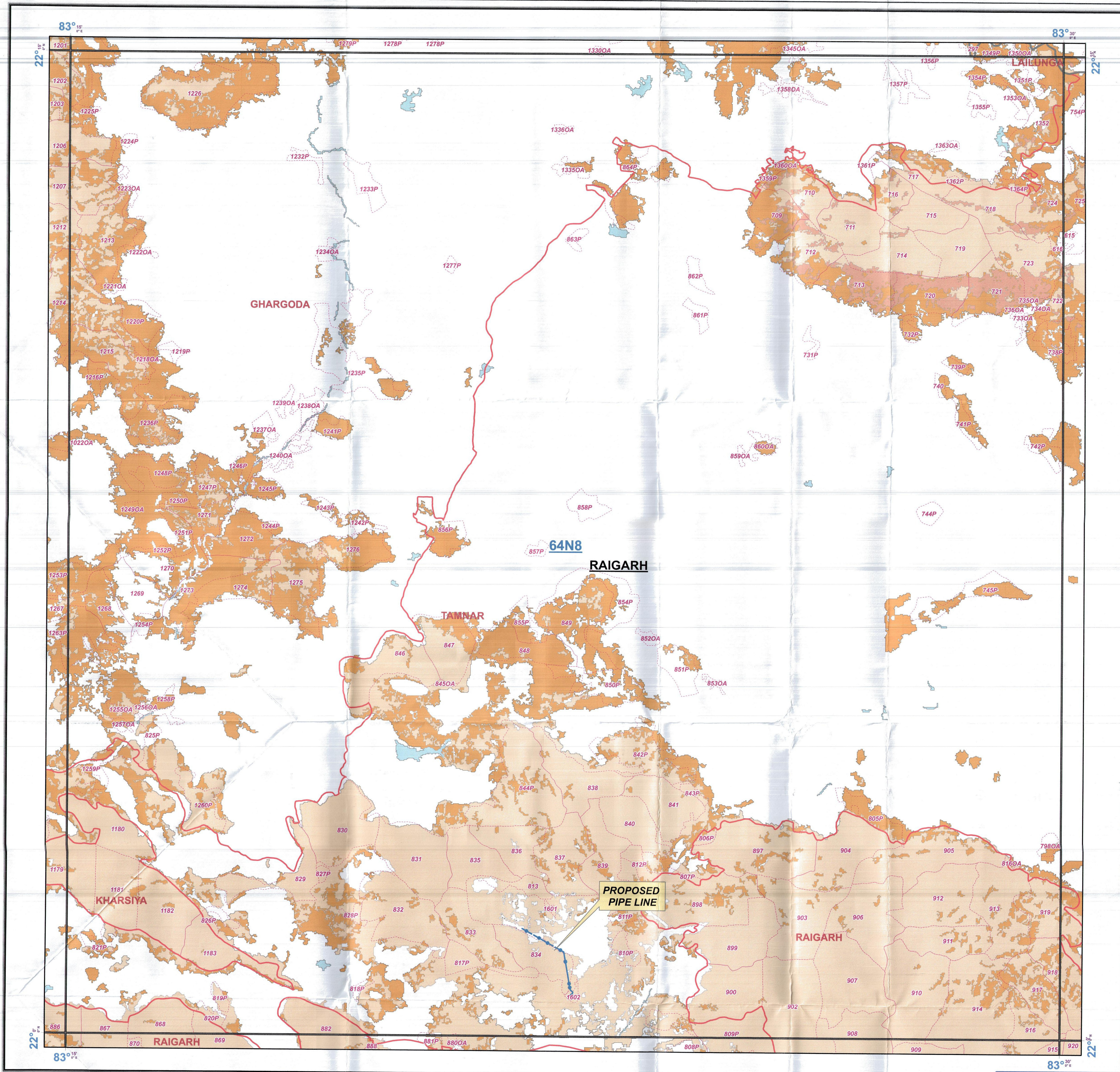

## Legend

- SURVEY SITE
- Division\_Boundary
- Range\_Boundary
- Compartment\_Boundary

## FOREST\_TYPE

- 3B/C1c Slightly Moist Teak Forest
- 3B/C2 Southern Moist Mixed Deciduous
- 3C/C2e(ii) Moist Peninsular Low Level Sal Forest
- 5/DS1 Dry Deciduous Scrub
- 5/E9 Dry Bamboo Brakes
- 5A/C3 Southern Dry Mixed Deciduous Forest
- 5B/C1c Dry Peninsular Sal Forest
- 5B/C2 Northern Dry Mixed Deciduous Forest
- Non Forest
- Plantation/TOF
- Water

## Forest Type map

(As per Champion & Seth's Classification - 1968)

## TOPOSHEET INDEX

64N3	64N7	64N11
64N4	64N8	64N12
64O1	64O5	64O9

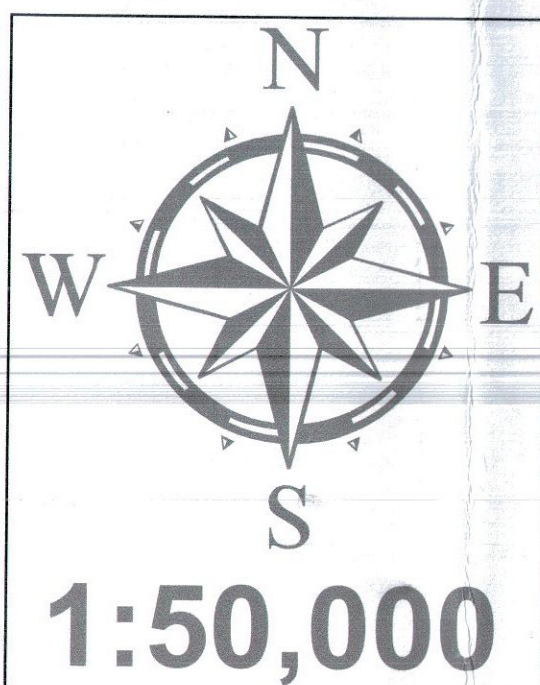

MAP PREPARED FOR SINGHAL ENERGY PVT. LTD., RAIPUR NOT FOR EXPORT

REG NO:

## MAP SUBJECT:

FOREST TYPE MAP OF PROPOSED FOREST/REVENUE FOREST LAND PATCH OF 0.117ha, TO BE DIVERTED FOR NON FORESTRY PURPOSE TO LAY PIPE LINE FOR SPONGE IRON PLANT NEAR GERWANI AND PROPOSED CAPTIVE POWER PLANT OF 10 MW IN TARAIMAL VILLAGE, BLOCK: TAMNAR, DIST: RAIGARH, IN FAVOR OF SINGHAL ENERGY PVT. LTD. RAIPUR (C.G.)

## SHAPEFILE PROVIDED BY USER AGENCY

SCALE 1:50,000

Prepared by

R.G. Biswas (C.G.)

Stock Mapping by

R. G. Biswas (C.G.)

CoOrdinates/Projection System used :

COORDINATE SYSTEM OF SHAPEFILE:  
Projected Coordinate System:  
WGS\_1984\_UTM\_Zone\_44N  
Projection: Transverse\_Mercator

Geographic Coordinate System:  
GCS\_WGS\_1984  
Datum: D\_WGS\_1984  
Prime Meridian: Greenwich  
Angular Unit: Degree

Data Source (s) :

1. Forest Boundaries are based on Stock Map (Scale 1: 15000)
2. Natural Features are based on Digital SOI Data (Scale 1: 50000)

Digitally Compiled and Printed at : REGIONAL GEOMATIC CENTER, BILASPUR

Disclaimer: - The Map provided is subject to inherent discrepancy amongst layers associated with incompatibility between different platforms of reference (L.C.C., W.G.S. 84 etc.) and probable human error angle in digitization. The user agency is advised to use the feature of map subject to prior authentication & supervision by the authorized person of the concerned forest division. The GEOMATIC CENTER BILASPUR shall not be responsible for any complications (legal or otherwise), arising out of this map.