

FOREST COVER MAP

(OF PROPOSED FOREST/REVENUE FOREST LAND DIVERSION TO LAY PIPE LINE FOR SPONGE IRON PLANT NEAR GERWANI
AND PROPOSED CAPTIVE POWER PLANT OF 10MW IN TARAIMAL, RAIGARH)

TOPOSHEET NO. 64-N 8

SCALE - 1:50,000



Legend

- SURVEY SITE
- Division_Boundary
- Range_Boundary
- Compartment_Boundary
- Vegetation**
- Moderately Dense Forest
- Non-Forest
- Open Forest
- Scrub
- Very Dense Forest
- Water

MAP PREPARED FOR SINGHAL ENERGY PVT. LTD., RAIPUR

TOPOSHEET INDEX

64N3	64N7	64N11
64N4	64N8	64N12
64O1	64O5	64O9

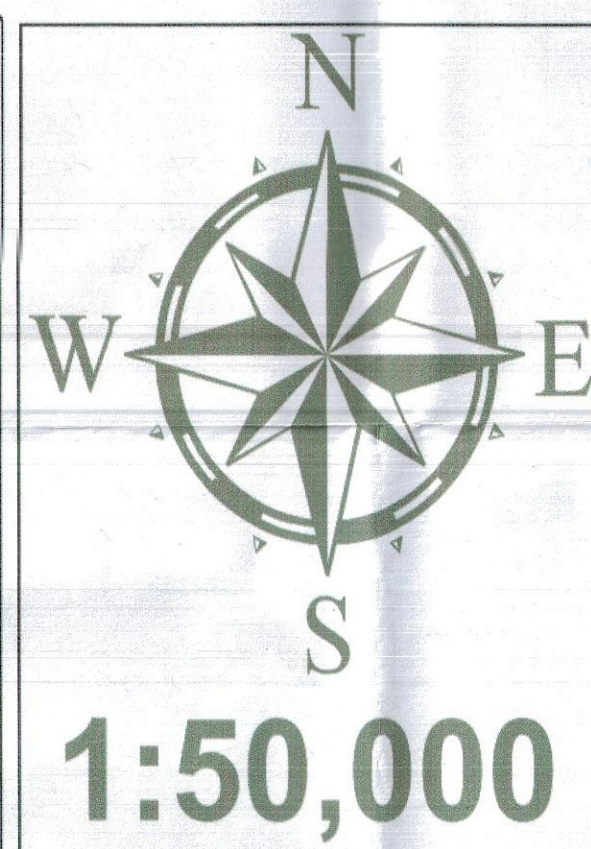

NOTE:-

* Forest Cover based on Digital Interpretation of Data Period 2017
IRS P6-LISS-III 23.5 m, IRS-Resourcesat 2 FSI Report 2015. □

निर्यात के लिये नहीं
NOT FOR EXPORT

REG NO:

MAP SUBJECT:

FOREST COVER MAP OF PROPOSED FOREST/REVENUE FOREST LAND PATCH OF 0.117ha, TO
BE DIVERTED FOR NON FORESTRY PURPOSE TO LAY PIPE LINE FOR SPONGE IRON PLANT
NEAR GERWANI AND PROPOSED CAPTIVE POWER PLANT OF 10 MW IN TARAIMAL VILLAGE,
BLOCK: TAMNAR, DIST: RAIGARH, IN FAVOR OF SINGHAL ENERGY PVT. LTD. RAIPUR (C.G.)

SHAPEFILE PROVIDED BY USER AGENCY

SCALE 1:50,000

CoOrdinates/Projection System used :

Prepared by

COORDINATE SYSTEM OF SHAPEFILE:
Projected Coordinate System:
WGS_1984_UTM_Zone_44N
Projection: Transverse_Mercator

Stock Mapping by

Geographic Coordinate System:
GCS_WGS_1984
Datum: D_WGS_1984
Prime Meridian: Greenwich
Angular Unit: Degree

Data Source (s) :

1. Forest Boundaries are based on Stock Map (Scale 1: 15000)
2. Natural Features are based on Digital SOI Data (Scale 1: 50000)

Digitally Compiled and Printed at : REGIONAL GEOMATIC CENTER, BILASPUR

Disclaimer: - The Map provided is subject to inherent discrepancy amongst layers associated with incompatibility between different platforms of reference (L.C.C., W.G.S. 84 etc.) and probable human error angle in digitization. The user agency is advised to use the feature of map subject to prior authentication & supervision by the authorized person of the concerned forest division. The GEOMATIC CENTER BILASPUR shall not be responsible for any complications (legal or otherwise), arising out of this map.