



भारत कोकिंग कोल लिमिटेड
(कोल इंडिया लिमिटेड का एक अंग)
एक मिनीरत्न कंपनी
महाप्रबंधक का कार्यालय, बरोरा क्षेत्र
पोस्ट - नावागढ़, जिला - धनबाद



पंजीकृत कार्यालय - कोयला भवन, कोयला नगर, धनबाद, 826005

पत्रांक-म. प्र./पर्यावरण/वन अपयोजन/2022/

2087

दिनांक- 15.12.2022

सेवामें,

वन प्रमण्डल पदाधिकारी

धनबाद

विषय- बी. सी. सी. एल. बरोरा क्षेत्र के अन्तर्गत मुराईडीह कोलियरी हेतु प्रस्तावित 133.69 हे. वन भूमि अपयोजन के प्रस्ताव के संबंध में।
सन्दर्भ सं.: - आपका पत्रांक - 2776, दिनांक- 06.12.2022

महाशय,

मुराईडीह कोलियरी, बी. सी. सी. एल. के बरोरा क्षेत्र का एक कोल माइनिंग परियोजना है, जो धनबाद जिला में अवस्थित है।

मुराईडीह परियोजना की वन प्रस्ताव की स्थिति निम्न प्रकार है:-

		अधिसूचित वन (हे.)	जंगल झाड़ी (हे.)	कुल वन क्षेत्र (हे.)	
1		7.6	0	7.6	अपयोजित -10-76/FCE दिनांक 09.06.1997
2	मुराईडीह कोलियरी, बरोरा क्षेत्र	46.17	87.52	133.69	वर्तमान प्रस्ताव (FP/JH/MIN/44804/2020 दिनांक 09-03- 2020)

बिहार गजट, 1964 एवं उपायुक्त- सह- जिला दण्डाधिकारी, धनबाद के ज्ञापांक-1407, दिनांक 11.04.2022 के अनुसार मुराईडीह कोलियरी, बरोरा क्षेत्र में शेष 133.69 हे. वन भूमि अपयोजन का प्रस्ताव समर्पित किया है, जिसमें 46.17 हे. अधिसूचित वन भूमि तथा शेष 87.52 हे. जंगल-झाड़ी है। पूर्व में OB Dumping किये गए भूमि का विवरण निम्न प्रकार से है:-

OB Dumping			
Notified Forest (Ha)= 34.38 Ha		Jungle Jhari (Ha)= 74.72 Ha	
Up to 1980	23.11	Up to 1996	38.30
After 1980	11.27	After 1996	36.35

वर्तमान में 11.79 हे. अधिसूचित वन भूमि तथा 12.87 हे. जंगल-झाड़ी यथावत (Intact in present) है एवं उस पर कोई OB Dumping नहीं की गयी है। (प्रमाण : अनुलग्नक 3)

श्रीमान् को यह सूचित किया जा रहा है कि वन विभाग द्वारा दावा की गयी वन भूमि, बी. सी. सी. एल. को संसदीय अधिनियम Coking Coal Mine (Nationalisation) Act, 1972 के तहत हस्तांतरित किया गया है और कुछ जगहों पर राष्ट्रीयकरण से पूर्व निजी कंपनियों (Central Kendwadih Colliery, Diamond Phularitand Colliery, East Benedih Colliery, Barora Colliery etc.) द्वारा खदान चलायी गयी है, जो कि भारतीय सर्वेक्षण विभाग, भारत सरकार द्वारा निर्गत शीट संख्या Sheet No. 16, 17 & 22 तथा राष्ट्रीयकरण से पूर्व मानचित्रों/ Plans से स्पष्ट है। (प्रमाण: अनुलग्नक 4, अनुलग्नक 5)

Signature

हालांकि, इस संबंध में माननीय उच्च न्यायालय, रांची के आदेश को संदर्भित किया जा सकता है, जिनके अनुसार

Quote

"No reference is there of any notification issued after expiry of thirty years and as such, it can be easily assumed that after 1964, no notification has been issued in terms of Section 30B of the Indian Forest Act and under the situation, one is constrained to hold that the land over which mining activities were done, can never be assumed to be the protected forest land.

Under this situation, no offence can be said to have been committed by the petitioner even if the mining activities were undertaken over the land in question."

Unquote (प्रमाण : अनुलग्नक 1)

माननीय उच्च न्यायालय, रांची के बाद संख्या CWJC-66/1999 में पारित अंतरिम आदेश, दिनांक 11.02.1999 के आलोक में Muraidih Open Cast Project में खनन कार्य किया गया। अंतरिम आदेश के अनुसार

Quote

"During the pendency of the Writ petition, the respondents are restrained from interfering with the mining activities undertaken by the petitioners in connection with the project commonly known as Muraidih Open Cast Project."

Unquote

मुराईडीह कोलियरी, बरोरा क्षेत्र हेतु प्रस्तावित 133.69 हे. वन भूमि अपयोजन प्रस्ताव पर माननीय द्वारा निर्देशित सभी NPV और Compensatory Afforestation का भुगतान प्रयोक्ता अभिकरण द्वारा किय जायेगा।

अतः श्रीमान् से विनम्र निवेदन है कि मुराईडीह कोलियरी हेतु प्रस्तावित 133.69 हे. वन भूमि पर यथाशीघ्र कार्यवाही की जाये।

संलग्न:-

1. Judgement of Hon'ble High Court, Ranchi, दिनांक 29.05.2012.
2. उपायुक्त- सह- जिला दण्डाधिकारी, धनबाद ज्ञापक-1407, दिनांक 11.04.2022
3. AMPC/SURFACE PLAN/2022/262 दिनांक 14.12.2022
4. Sheet No. 16, 17 & 22 by Survey of India (1980-81)
5. Plans of private company pre-nationalization (6 Plans)

भवदीय

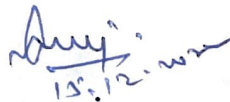

महाप्रबंधक
बरोरा क्षेत्र



वी० सी० सी० एल०

Date: - 29.05.2012

Sub:-

Criminal Misc. No. 4532 of 2001

1) Sri Surendra Prasad Sahu

2) Sri D.P. Singh

-Vrs-

1) The State of Jharkhand

2) The Divisional Forest Officer, Dhanbad
Forest Division, Dhanbad & Anr.

Placed below the order of Hon'ble Jharkhand High Court, Ranchi, dated 12.04.2012 in Cr. Misc. No. 4532 of 2001 in connection with B.F. Case No. 144 of 2000 pending before Judicial Magistrate, Dhanbad. The crux of the order of Hon'ble Jharkhand High Court, Ranchi is appended below:-

"Here in the instant case, as it appears from the prosecution report that the land is being claimed to be the forest land by virtue of a Notification issued in the year 1964.

No reference is there of any notification issued after expiry of thirty years and as such, it can be easily assumed that after 1964, no notification has been issued in terms of section 30B of the Indian Forest Act and under the situation, one is constrained to hold that the land over which mining activities were done, can never be assumed to be the protected forest land.

Under this situation, no offence can be said to have been committed by the petitioners even if mining activities were undertaken over the land in question.

Accordingly, the entire criminal proceeding of B.F. Case No. 144 of 2000 including the order dated 03.10.2000 is hereby quashed.

In the result, this application is *allowed*."

Submitted please for further direction to the dealing / concerned officials to take appropriate action before Ld. Trial Court, Dhanbad in consultation with conducting Advocate,

Encl: - Certified copy of order dated 12.04.2012(in original).

HOD (Legal)

(Dr. K. S. Sinha)

Dy. Manager (Pers.)/IR-L

Sr. Manager (Legal) KB

Pl. handwritten note certified copy of order dt 12.4.12 passed by the Hon'ble High Court, Ranchi to the dealing advocate of the case for taking necessary steps for dropping the case which is against the petition. And following.

Sr. L.G (Deb)

original c.c. enclosed with this request.

157/IN(CR)/
30/5/2012

31.5.12

Criminal Misc. Petition No.4532 of 2001

.....
In the matter of an application under Section 482 of the Criminal Procedure Code.

1. Sri Surendra Prasad Sahu
 2. Sri D.P. Singh
-Petitioners

Versus

1. The State of Jharkhand
 2. The Divisional Forest Officer,
Dhanbad Forest Division, Dhanbad. & Anr.
-Opp, Parties

For the Petitioners : Mr. A.K. Mehta, Advocate
For the State : Mrs. Nikki Sinha, A.P.P.

P R E S E N T

HON'BLE MR. JUSTICE R.R. PRASAD

By Court :

Heard learned counsel appearing for the petitioners and learned counsel appearing for the State.

This application has been filed for quashing of the entire criminal proceeding of B.F. Case No.144 of 2000 including the order dated 03.10.2000 passed by the learned Chief Judicial Magistrate, Dhanbad whereby and whereunder learned Chief Judicial Magistrate, Dhanbad took cognizance of the offence punishable under Section 33 of the Bihar Forest Act, 1927 against the petitioners.

It appears that when these two petitioners and one other person were found indulging themselves in doing mining work over the land situated within the protected forest, an offence report was submitted on 23.11.1998. After investigation, the prosecution report dated 08.08.2000 was submitted, upon which cognizance of the offence was taken on 03.10.2000. That order is under challenge.

Mr. Mehta, learned counsel appearing for the petitioners submits that the petitioners cannot be said to have committed any offence by doing mining work over the land which has been claimed to be the forest land as when the petitioners had earlier been restrained from doing mining work over the piece of land, alleged to be the forest land by the Forest Department, the petitioners did prefer writ application before this Hon'ble Court vide CWJC No.66 of 1999 (R), which was admitted on 11.02.1999 whereby an order was also passed that "during the pendency of the writ petition, the respondents are restrained from interfering with the mining activities of the petitioner in connection with the project commonly known as Muraidih Open Cast Project."

It was further submitted that though the Forest Department has claimed the land as protected forest by virtue of the Notification issued in the year 1964, but it lost its force after expiry of 30 years. Thereafter, no further

notification has been made and if any further notification would have been made after expiry of thirty years reference should have been made in the prosecution report itself. But since, the prosecution report is silent, it can easily be assumed that after 1964, no notification was issued in terms of Section 30 of the Indian Forest Act and on this ground alone, entire prosecution, in view of the decisions rendered in the cases of **Jagdish Mehta vs. State of Jharkhand and others [2003 (2) J.C.R 525 (Jhr)]** and **Janu Khan and others vs. State of Bihar (AIR 1960 Pat 213)** is fit to be quashed.

However, learned counsel appearing for the State submits that there has been a specific allegation that these two petitioners were found doing mining work over the land which was a part of the protected forest land and, thereby, the petitioners are rightly being prosecuted.

Having heard learned counsel appearing for the parties and on perusal of the record, I do find that earlier to lodgment of the instant prosecution, when there was interference on the part of the forest department over the mining work which was being done by these petitioners over a piece of land allegedly the part of the forest land, the petitioners did approach to this Court vide C.W.J.C. No.66 of 1999 (R) whereby this Court vide its order dated 11.02.1999 restrained the respondents from interfering with the mining activities undertaken by the petitioners in connection with the project commonly known as "Muraidih Open Cast Project".

A clear cut stand has been taken that the prosecution, which has been lodged, is with respect to the same "Muraidih Open Cast Project" but it has never been denied. Under this situation, the petitioners cannot be said to have committed any offence.

So far other submission relating to consequence of non-issuance of the notification, after expiry of thirty years is concerned, one needs to take notice of the provision as contained in Section 30B of the Indian Forest Act, which reads as follows:-

" 30. Power to issue notification reserving trees, etc. –

The State Government may, by notification in the Official Gazette, ---

(a).....

(b) declare that any portion of such forest specified in the notification shall be closed for such term, not exceeding thirty years, as the State Government thinks fit, and that the rights of private persons, if any, over such portion shall be suspended during such terms, provided that the remainder of such forest be sufficient, and in a locality reasonably convenient, for the due exercise of the right suspended in the portion so closed; or

(c).....

Here in the instant case, as it appears from the prosecution report

that the land is being claimed to be the forest land by virtue of a Notification issued in the year 1964.

No reference is there of any notification issued after expiry of thirty years and as such, it can be easily assumed that after 1964, no notification has been issued in terms of Section 30B of the Indian Forest Act and under the situation, one is constrained to hold that the land over which mining activities were done, can never be assumed to be the protected forest land.

Under this situation, no offence can be said to have been committed by the petitioners even if mining activities were undertaken over the land in question.

Accordingly, the entire criminal proceeding of B.F. Case No.144 of 2000 including the order dated 03.10.2000 is hereby quashed.

In the result, this application is allowed.

sd/- R. R. Prasad. J.

Jharkhand High Court, Ranchi

Dated 12nd April, 2012

Ravi/N.A.F.R.

Certified to be true Copy

Dr. Bhagat -
21/4/12
Copying Officer

Designated under Rule 252 (1) of J.H.C. Rules

Authorized Under Act of 1872

The 01st Vaishak, 1934
21/4/12

21/4/12

प्रपत्र-1

प्रमाण-पत्र

प्रमाणित किया जाता है कि अंचल-बाघमारा के मौजा-बरमसिया/105, बरोरा/97, केन्दुआडीह/96, बहालडीह/103 एवं मुराईडीह/104, जिला-धनबाद के खाता एवं प्लॉट में सन्निहित भूमि का कैडेस्ट्रल सर्वे (CS)/25.10.1980 के पूर्व प्रकाशित अंतिम रिवीजनल सर्वे (RS) का अभिलेख अथक प्रयासों के पश्चात् भी ~~विभिन्न सजख अभिलेखागारों, अंचलाधिकारी कार्यालय, जिला अभिलेखागार, भू-अर्जन कार्यालय, बंदोवस्त कार्यालय, सजखीय मुद्रणालय आदि में उपलब्ध नहीं हो पाया अथवा जीर्ण शीर्ण/कटे फटे अवस्था में है तथा अपठनीय है।~~

अतः 25.10.1980 को वर्णित भूमि का किस्म क्या था यह पता नहीं चल पा रहा है। संबंधित भूमि का अभिलेख वर्ष 2005 में प्रकाशित वर्तमान रिवीजनल सर्वे के आधार पर अंचल अधिकारी, बाघमारा द्वारा उपलब्ध कराया गया है, जिसकी विवरणी संलग्न है (पृष्ठ सं०-01-42)।

अतः स्पष्ट है कि वर्ष 2005 में प्रकाशित रिवीजनल सर्वे के अनुसार उक्त भूमि वन (संरक्षण) अधिनियम, 1980 के प्रयोजन हेतु वनभूमि की श्रेणी में नहीं आती है।

उपरोक्त संबंध में यह वचनबद्धता दी जाती है कि भविष्य में यदि 25.10.1980 के पूर्व के सर्वे अभिलेखों के आधार पर उक्त भूमि की प्रकृति वन/जंगल-झाड़ी आदि (deemed forest) के रूप में पायी जाती है, तो इसे तत्काल सभी संबंधित कार्यालयों तथा प्रयोक्ता अभिकरण को सूचित किया जायेगा एवं उसके अनुसार संबंधित प्रयोक्ता अभिकरण वन (संरक्षण) अधिनियम, 1980 अंतर्गत परियोजना में सम्मिलित उक्त चिन्हित वनभूमि के अपयोजन का प्रस्ताव समर्पित करने हेतु बाध्य होंगे।

६०/-

(संदीप सिंह),

उपायुक्त-सह-जिला दण्डाधिकारी,
धनबाद।

प्रतिलिपि:- झापांक...../1407...../रा०, धनबाद, दिनांक...../11/04/2022
अध्यक्ष-सह-प्रबंध निदेशक, भारत कोकिंग कोल लि० को सूचनार्थ एवं आवश्यक कार्यार्थ प्रेषित।

(संदीप सिंह),

उपायुक्त-सह-जिला दण्डाधिकारी,
धनबाद।

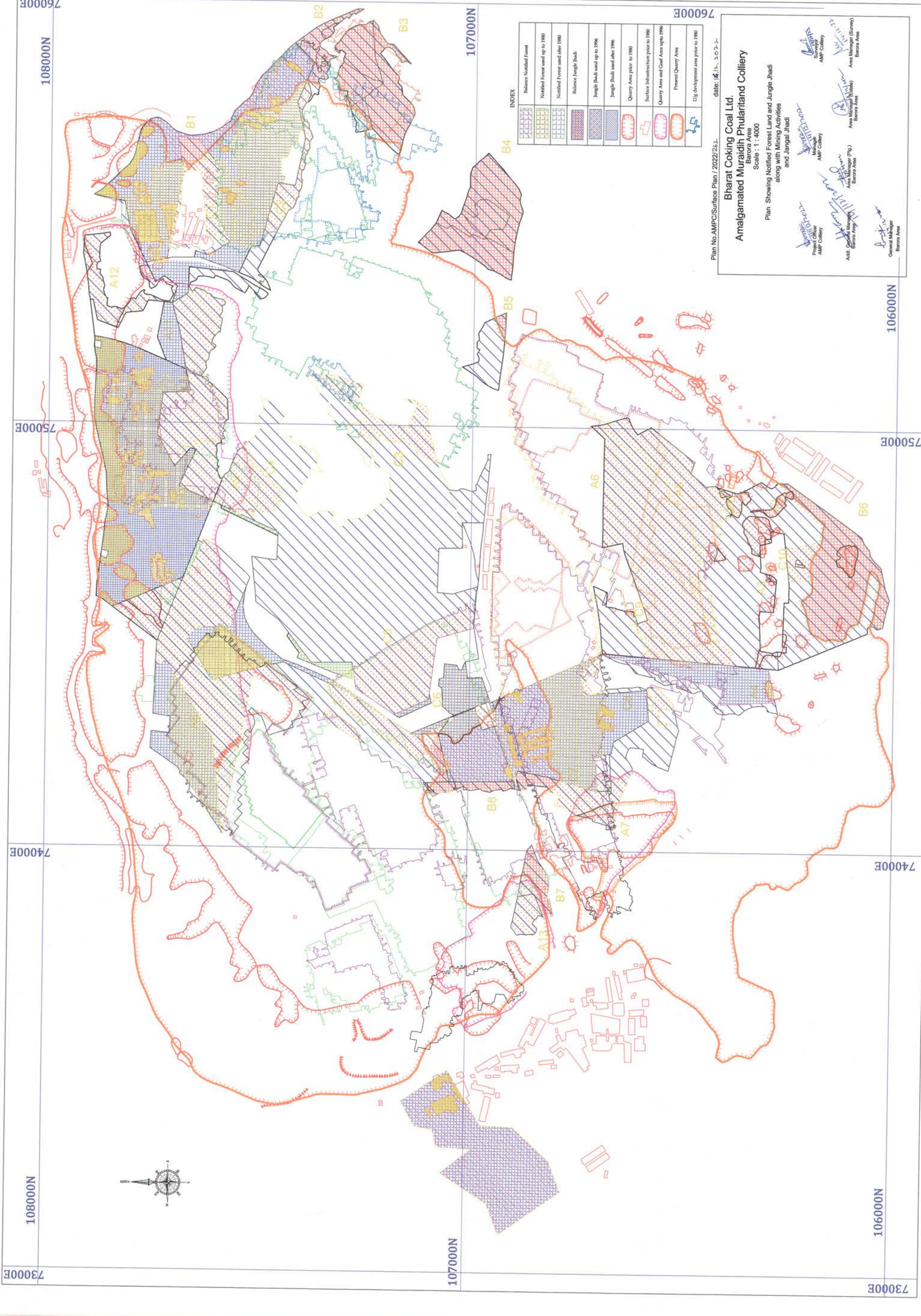

INDEX	
[Pattern]	Balance Notified Forest
[Pattern]	Notified Forest used up to 1980
[Pattern]	Notified Forest used after 1980
[Pattern]	Balance Jungle Jhadi
[Pattern]	Jungle Jhadi used up to 1996
[Pattern]	Jungle Jhadi used after 1996
[Pattern]	Quarry Area prior to 1980
[Pattern]	Surface Infrastructure prior to 1980
[Pattern]	Quarry Area and Coal Area upto 1996
[Pattern]	Present Quarry Area
[Pattern]	U/g development area prior to 1980

Plan No.AMPC/Surface Plan / 2022/262.
date: 14.11.2022

Bharat Coking Coal Ltd.
Amalgamated Muraidih Phularitand Colliery
Barora Area
Scale : 1 : 4000
Plan Showing Notified Forest Land and Jungle Jhadi
along with Mining Activities
and Jangal Jhadi

Project Officer
AMPC Colliery

Area Manager
AMPC Colliery

Area Manager (Pg.)
Barora Area

Area Manager (Survey)
Barora Area

General Manager
Barora Area

73000E 74000E 75000E 76000E

106000N 107000N 108000N

The area left blank on this sheet has been published on 1:50,000 scale as part of sheet No. 73/1/5.

108000N

107000N

106000N

73000E

74000E

75000E

108000N

107000N

76000E

Plan No. AMPOS/Bara/Phu/1022/263.

date: 14.12.2022

Bara Coking Coal Ltd.
Amalgamated Muraidih Phuland Colliery
Bara Area
Scale: 1:4000
Part Surface Plan, Mining Surface Feature, Up Degraded Area
Up Development Area, Infrastructure Prior to 1980 along with Forest Land
and Jangal Jhadi

[Signatures and stamps of officials]
Project Officer
AMF Colliery
Bara Area
Area Manager (Survey)
Bara Area
Area Manager (Survey)
Bara Area

INDEX

	Quarry Area prior to 1980
	Up Degraded Area prior to 1980
	Up Development Area prior to 1980
	Surface Infrastructure prior to 1980
	Forest Land
	Jangal Jhadi

GOVERNMENT OF INDIA COPYRIGHT: 1981

This map is NOT to be published, copied or reproduced in part or whole without the written permission of the Survey of India.

106000N

Contours are approximate.
The map is not to be published, copied or reproduced in part or whole without the written permission of the Survey of India.
A relative height, 20' represents the approximate height, in meters, between the top and bottom of a steep slope.
Bench-mark heights shown on the sheet are top heights and may not be in agreement with the contours which are based on ground heights.

THE NEW BUREAU (E.C. 131-1000) 1978
Roads: metalled/unmetalled with distance stone and/or
Carriageway: Paved/unpaved
Canal: Paved/unpaved
River: Paved/unpaved
Well: Paved/unpaved
Mud: Paved/unpaved
Light railway: Paved/unpaved
Contours: 10m/20m/30m/40m/50m/60m/70m/80m/90m/100m/110m/120m/130m/140m/150m/160m/170m/180m/190m/200m/210m/220m/230m/240m/250m/260m/270m/280m/290m/300m/310m/320m/330m/340m/350m/360m/370m/380m/390m/400m/410m/420m/430m/440m/450m/460m/470m/480m/490m/500m/510m/520m/530m/540m/550m/560m/570m/580m/590m/600m/610m/620m/630m/640m/650m/660m/670m/680m/690m/700m/710m/720m/730m/740m/750m/760m/770m/780m/790m/800m/810m/820m/830m/840m/850m/860m/870m/880m/890m/900m/910m/920m/930m/940m/950m/960m/970m/980m/990m/1000m/1010m/1020m/1030m/1040m/1050m/1060m/1070m/1080m/1090m/1100m/1110m/1120m/1130m/1140m/1150m/1160m/1170m/1180m/1190m/1200m/1210m/1220m/1230m/1240m/1250m/1260m/1270m/1280m/1290m/1300m/1310m/1320m/1330m/1340m/1350m/1360m/1370m/1380m/1390m/1400m/1410m/1420m/1430m/1440m/1450m/1460m/1470m/1480m/1490m/1500m/1510m/1520m/1530m/1540m/1550m/1560m/1570m/1580m/1590m/1600m/1610m/1620m/1630m/1640m/1650m/1660m/1670m/1680m/1690m/1700m/1710m/1720m/1730m/1740m/1750m/1760m/1770m/1780m/1790m/1800m/1810m/1820m/1830m/1840m/1850m/1860m/1870m/1880m/1890m/1900m/1910m/1920m/1930m/1940m/1950m/1960m/1970m/1980m/1990m/2000m/2010m/2020m/2030m/2040m/2050m/2060m/2070m/2080m/2090m/2100m/2110m/2120m/2130m/2140m/2150m/2160m/2170m/2180m/2190m/2200m/2210m/2220m/2230m/2240m/2250m/2260m/2270m/2280m/2290m/2300m/2310m/2320m/2330m/2340m/2350m/2360m/2370m/2380m/2390m/2400m/2410m/2420m/2430m/2440m/2450m/2460m/2470m/2480m/2490m/2500m/2510m/2520m/2530m/2540m/2550m/2560m/2570m/2580m/2590m/2600m/2610m/2620m/2630m/2640m/2650m/2660m/2670m/2680m/2690m/2700m/2710m/2720m/2730m/2740m/2750m/2760m/2770m/2780m/2790m/2800m/2810m/2820m/2830m/2840m/2850m/2860m/2870m/2880m/2890m/2900m/2910m/2920m/2930m/2940m/2950m/2960m/2970m/2980m/2990m/3000m/3010m/3020m/3030m/3040m/3050m/3060m/3070m/3080m/3090m/3100m/3110m/3120m/3130m/3140m/3150m/3160m/3170m/3180m/3190m/3200m/3210m/3220m/3230m/3240m/3250m/3260m/3270m/3280m/3290m/3300m/3310m/3320m/3330m/3340m/3350m/3360m/3370m/3380m/3390m/3400m/3410m/3420m/3430m/3440m/3450m/3460m/3470m/3480m/3490m/3500m/3510m/3520m/3530m/3540m/3550m/3560m/3570m/3580m/3590m/3600m/3610m/3620m/3630m/3640m/3650m/3660m/3670m/3680m/3690m/3700m/3710m/3720m/3730m/3740m/3750m/3760m/3770m/3780m/3790m/3800m/3810m/3820m/3830m/3840m/3850m/3860m/3870m/3880m/3890m/3900m/3910m/3920m/3930m/3940m/3950m/3960m/3970m/3980m/3990m/4000m/4010m/4020m/4030m/4040m/4050m/4060m/4070m/4080m/4090m/4100m/4110m/4120m/4130m/4140m/4150m/4160m/4170m/4180m/4190m/4200m/4210m/4220m/4230m/4240m/4250m/4260m/4270m/4280m/4290m/4300m/4310m/4320m/4330m/4340m/4350m/4360m/4370m/4380m/4390m/4400m/4410m/4420m/4430m/4440m/4450m/4460m/4470m/4480m/4490m/4500m/4510m/4520m/4530m/4540m/4550m/4560m/4570m/4580m/4590m/4600m/4610m/4620m/4630m/4640m/4650m/4660m/4670m/4680m/4690m/4700m/4710m/4720m/4730m/4740m/4750m/4760m/4770m/4780m/4790m/4800m/4810m/4820m/4830m/4840m/4850m/4860m/4870m/4880m/4890m/4900m/4910m/4920m/4930m/4940m/4950m/4960m/4970m/4980m/4990m/5000m/5010m/5020m/5030m/5040m/5050m/5060m/5070m/5080m/5090m/5100m/5110m/5120m/5130m/5140m/5150m/5160m/5170m/5180m/5190m/5200m/5210m/5220m/5230m/5240m/5250m/5260m/5270m/5280m/5290m/5300m/5310m/5320m/5330m/5340m/5350m/5360m/5370m/5380m/5390m/5400m/5410m/5420m/5430m/5440m/5450m/5460m/5470m/5480m/5490m/5500m/5510m/5520m/5530m/5540m/5550m/5560m/5570m/5580m/5590m/5600m/5610m/5620m/5630m/5640m/5650m/5660m/5670m/5680m/5690m/5700m/5710m/5720m/5730m/5740m/5750m/5760m/5770m/5780m/5790m/5800m/5810m/5820m/5830m/5840m/5850m/5860m/5870m/5880m/5890m/5900m/5910m/5920m/5930m/5940m/5950m/5960m/5970m/5980m/5990m/6000m/6010m/6020m/6030m/6040m/6050m/6060m/6070m/6080m/6090m/6100m/6110m/6120m/6130m/6140m/6150m/6160m/6170m/6180m/6190m/6200m/6210m/6220m/6230m/6240m/6250m/6260m/6270m/6280m/6290m/6300m/6310m/6320m/6330m/6340m/6350m/6360m/6370m/6380m/6390m/6400m/6410m/6420m/6430m/6440m/6450m/6460m/6470m/6480m/6490m/6500m/6510m/6520m/6530m/6540m/6550m/6560m/6570m/6580m/6590m/6600m/6610m/6620m/6630m/6640m/6650m/6660m/6670m/6680m/6690m/6700m/6710m/6720m/6730m/6740m/6750m/6760m/6770m/6780m/6790m/6800m/6810m/6820m/6830m/6840m/6850m/6860m/6870m/6880m/6890m/6900m/6910m/6920m/6930m/6940m/6950m/6960m/6970m/6980m/6990m/7000m/7010m/7020m/7030m/7040m/7050m/7060m/7070m/7080m/7090m/7100m/7110m/7120m/7130m/7140m/7150m/7160m/7170m/7180m/7190m/7200m/7210m/7220m/7230m/7240m/7250m/7260m/7270m/7280m/7290m/7300m/7310m/7320m/7330m/7340m/7350m/7360m/7370m/7380m/7390m/7400m/7410m/7420m/7430m/7440m/7450m/7460m/7470m/7480m/7490m/7500m/7510m/7520m/7530m/7540m/7550m/7560m/7570m/7580m/7590m/7600m/7610m/7620m/7630m/7640m/7650m/7660m/7670m/7680m/7690m/7700m/7710m/7720m/7730m/7740m/7750m/7760m/7770m/7780m/7790m/7800m/7810m/7820m/7830m/7840m/7850m/7860m/7870m/7880m/7890m/7900m/7910m/7920m/7930m/7940m/7950m/7960m/7970m/7980m/7990m/8000m/8010m/8020m/8030m/8040m/8050m/8060m/8070m/8080m/8090m/8100m/8110m/8120m/8130m/8140m/8150m/8160m/8170m/8180m/8190m/8200m/8210m/8220m/8230m/8240m/8250m/8260m/8270m/8280m/8290m/8300m/8310m/8320m/8330m/8340m/8350m/8360m/8370m/8380m/8390m/8400m/8410m/8420m/8430m/8440m/8450m/8460m/8470m/8480m/8490m/8500m/8510m/8520m/8530m/8540m/8550m/8560m/8570m/8580m/8590m/8600m/8610m/8620m/8630m/8640m/8650m/8660m/8670m/8680m/8690m/8700m/8710m/8720m/8730m/8740m/8750m/8760m/8770m/8780m/8790m/8800m/8810m/8820m/8830m/8840m/8850m/8860m/8870m/8880m/8890m/8900m/8910m/8920m/8930m/8940m/8950m/8960m/8970m/8980m/8990m/9000m/9010m/9020m/9030m/9040m/9050m/9060m/9070m/9080m/9090m/9100m/9110m/9120m/9130m/9140m/9150m/9160m/9170m/9180m/9190m/9200m/9210m/9220m/9230m/9240m/9250m/9260m/9270m/9280m/9290m/9300m/9310m/9320m/9330m/9340m/9350m/9360m/9370m/9380m/9390m/9400m/9410m/9420m/9430m/9440m/9450m/9460m/9470m/9480m/9490m/9500m/9510m/9520m/9530m/9540m/9550m/9560m/9570m/9580m/9590m/9600m/9610m/9620m/9630m/9640m/9650m/9660m/9670m/9680m/9690m/9700m/9710m/9720m/9730m/9740m/9750m/9760m/9770m/9780m/9790m/9800m/9810m/9820m/9830m/9840m/9850m/9860m/9870m/9880m/9890m/9900m/9910m/9920m/9930m/9940m/9950m/9960m/9970m/9980m/9990m/10000m/10010m/10020m/10030m/10040m/10050m/10060m/10070m/10080m/10090m/10100m/10110m/10120m/10130m/10140m/10150m/10160m/10170m/10180m/10190m/10200m/10210m/10220m/10230m/10240m/10250m/10260m/10270m/10280m/10290m/10300m/10310m/10320m/10330m/10340m/10350m/10360m/10370m/10380m/10390m/10400m/10410m/10420m/10430m/10440m/10450m/10460m/10470m/10480m/10490m/10500m/10510m/10520m/10530m/10540m/10550m/10560m/10570m/10580m/10590m/10600m/10610m/10620m/10630m/10640m/10650m/10660m/10670m/10680m/10690m/10700m/10710m/10720m/10730m/10740m/10750m/10760m/10770m/10780m/10790m/10800m/10810m/10820m/10830m/10840m/10850m/10860m/10870m/10880m/10890m/10900m/10910m/10920m/10930m/10940m/10950m/10960m/10970m/10980m/10990m/11000m/11010m/11020m/11030m/11040m/11050m/11060m/11070m/11080m/11090m/11100m/11110m/11120m/11130m/11140m/11150m/11160m/11170m/11180m/11190m/11200m/11210m/11220m/11230m/11240m/11250m/11260m/11270m/11280m/11290m/11300m/11310m/11320m/11330m/11340m/11350m/11360m/11370m/11380m/11390m/11400m/11410m/11420m/11430m/11440m/11450m/11460m/11470m/11480m/11490m/11500m/11510m/11520m/11530m/11540m/11550m/11560m/11570m/11580m/11590m/11600m/11610m/11620m/11630m/11640m/11650m/11660m/11670m/11680m/11690m/11700m/11710m/11720m/11730m/11740m/11750m/11760m/11770m/11780m/11790m/11800m/11810m/11820m/11830m/11840m/11850m/11860m/11870m/11880m/11890m/11900m/11910m/11920m/11930m/11940m/11950m/11960m/11970m/11980m/11990m/12000m/12010m/12020m/12030m/12040m/12050m/12060m/12070m/12080m/12090m/12100m/12110m/12120m/12130m/12140m/12150m/12160m/12170m/12180m/12190m/12200m/12210m/12220m/12230m/12240m/12250m/12260m/12270m/12280m/12290m/12300m/12310m/12320m/12330m/12340m/12350m/12360m/12370m/12380m/12390m/12400m/12410m/12420m/12430m/12440m/12450m/12460m/12470m/12480m/12490m/12500m/12510m/12520m/12530m/12540m/12550m/12560m/12570m/12580m/12590m/12600m/12610m/12620m/12630m/12640m/12650m/12660m/12670m/12680m/12690m/12700m/12710m/12720m/12730m/12740m/12750m/12760m/12770m/12780m/12790m/12800m/12810m/12820m/12830m/12840m/12850m/12860m/12870m/12880m/12890m/12900m/12910m/12920m/12930m/12940m/12950m/12960m/12970m/12980m/12990m/13000m/13010m/13020m/13030m/13040m/13050m/13060m/13070m/13080m/13090m/13100m/13110m/13120m/13130m/13140m/13150m/13160m/13170m/13180m/13190m/13200m/13210m/13220m/13230m/13240m/13250m/13260m/13270m/13280m/13290m/13300m/13310m/13320m/13330m/13340m/13350m/13360m/13370m/13380m/13390m/13400m/13410m/13420m/13430m/13440m/13450m/13460m/13470m/13480m/13490m/13500m/13510m/13520m/13530m/13540m/13550m/13560m/13570m/13580m/13590m/13600m/13610m/13620m/13630m/13640m/13650m/13660m/13670m/13680m/13690m/13700m/13710m/13720m/13730m/13740m/13750m/13760m/13770m/13780m/13790m/13800m/13810m/13820m/13830m/13840m/13850m/13860m/13870m/13880m/13890m/13900m/13910m/13920m/13930m/13940m/13950m/13960m/13970m/13980m/13990m/14000m/14010m/14020m/14030m/14040m/14050m/14060m/14070m/14080m/14090m/14100m/14110m/14120m/14130m/14140m/14150m/14160m/14170m/14180m/14190m/14200m/14210m/14220m/14230m/14240m/14250m/14260m/14270m/14280m/14290m/14300m/14310m/14320m/14330m/14340m/14350m/14360m/14370m/14380m/14390m/14400m/14410m/14420m/14430m/14440m/14450m/14460m/14470m/14480m/14490m/14500m/14510m/14520m/14530m/14540m/14550m/14560m/14570m/14580m/14590m/14600m/14610m/14620m/14630m/14640m/14650m/14660m/14670m/14680m/14690m/14700m/14710m/14720m/14730m/14740m/14750m/14760m/14770m/14780m/14790m/14800m/14810m/14820m/14830m/14840m/14850m/14860m/14870m/14880m/14890m/14900m/14910m/14920m/14930m/14940m/14950m/14960m/14970m/14980m/14990m/15000m/15010m/15020m/15030m/15040m/15050m/15060m/15070m/15080m/15090m/15100m/15110m/15120m/15130m/15140m/15150m/15160m/15170m/15180m/15190m/15200m/15210m/15220m/15230m/15240m/15250m/15260m/15270m/15280m/15290m/15300m/15310m/15320m/15330m/15340m/15350m/15360m/15370m/15380m/15390m/15400m/15410m/15420m/15430m/15440m/15450m/15460m/15470m/15480m/15490m/15500m/15510m/15520m/15530m/15540m/15550m/15560m/15570m/15580m/15590m/15600m/15610m/15620m/15630m/15640m/15650m/15660m/15670m/15680m/15690m/15700m/15710m/15720m/15730m/15740m/15750m/15760m/15770m/15780m/15790m/15800m/15810m/15820m/15830m/15840m/15850m/15860m/15870m/15880m/15890m/15900m/15910m/15920m/15930m/15940m/15950m/15960m/15970m/15980m/15990m/16000m/16010m/16020m/16030m/16040m/16050m/16060m/16070m/16080m/16090m/16100m/16110m/16120m/16130m/16140m/16150m/16160m/16170m/16180m/16190m/16200m/16210m/16220m/16230m/16240m/16250m/16260m/16270m/16280m/16290m/16300m/16310m/16320m/16330m/16340m/16350m/16360m/16370m/16380m/16390m/16400m/16410m/16420m/16430m/16440m/16450m/16460m/16470m/16480m/16490m/16500m/16510m/16520m/16530m/16540m/16550m/16560m/16570m/16580m/16590m/16600m/16610m/16620m/16630m/16640m/16650m/16660m/16670m/16680m/16690m/16700m/16710m/16720m/16730m/16740m/16750m/16760m/16770m/16780m/16790m/16800m/16810m/16820m/16830m/16840m/16850m/16860m/16870m/16880m/16890m/16900m/16910m/16920m/16930m/16940m/16950m/16960m/16970m/16980m/169

DHANBAD DISTRICT.

Surveyed 1980-81

JHARIA COALFIELD
BIHAR

SHEET No. 17

106000N

106000N

105000N

105000N

104000N

104000N

73000E

73000E

76000E

Res. No. 3586 E 81 (E.C. 18-1-800) 97/81.

Roads, metalled: unmetalled: with distance stone and bridge
Cart-track, Pack-track, Foot-path
Causeway, Ford or Ferry, Dams
Streams, with track in bed undefined, Canal
River banks, shewing steep, 3 to 6 metres; over 6 metres
dry with water channel, with island & rocks
Wells: lined: unlined: Tube-well: Spring: Tanks: perennial: dry
Embankments: road or rail, tank, Broken ground
Railways: with distance stone and station, Cutting with tunnel
Light railways, tramway or trolleyway
Contours, with sub features Rocky slopes, Cliffs

Published under the authority of Lieutenant-General Kishori Lal Khosla, B.Sc. (Distinction) BE (Civil), F.I.S., F.I.E., F.I.G.U., M.A.S.C.E. (U.S.A.), Surveyor General of India.

1981.

1:4,000

Metres 500 400 300 200 100 0 500 Metres

CONTOUR INTERVAL 2 METRES

Index to Sheets and Incidence on 1:50,000 Sheets

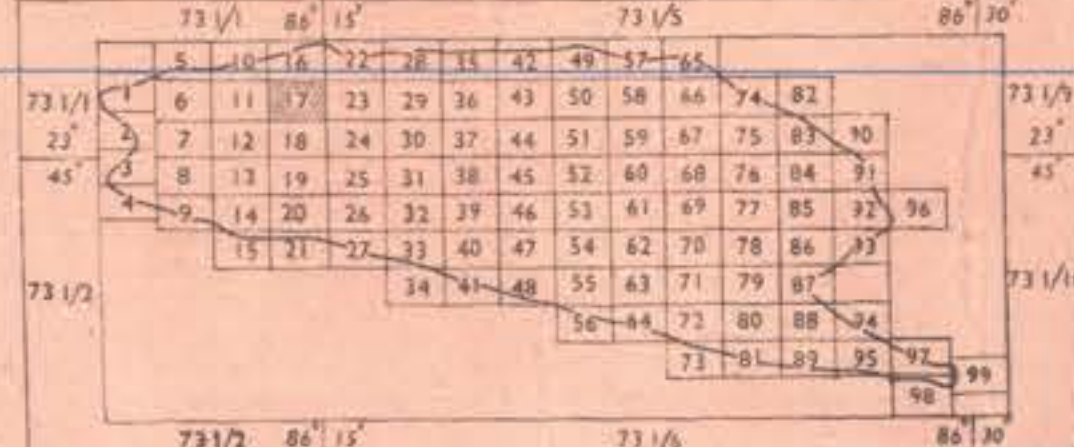

Contours are spot heights.
Tanks in this area usually contain water from June to March.
Bore holes which are found on the ground have been shown.
The approximate height, in metres, between the top and bottom of a steep slope.
The spot heights and are not to be mistaken with the contours which are based on ground heights.

Towns or Villages: inhabited: deserted: Fort
Quarters: Huts: permanent: temporary: Tower
Temple: Chhatra: Church: Mosque: Idga: Tomb: Graves
Palms: palms: other: Plantain: Conifer: Bamboo: Other trees
Ropeway
Power line
Post office: Telegraph office: Combined office: Police station
Bungalows: dsk or travellers: inspection: Rest-house
Mine: Pit: Bore hole: Incline: Quarry
Height: triangulated: station: point: approximate
Bench mark: geodetic: tertiary

GOVERNMENT OF INDIA COPYRIGHT, 1981.

This map is NOT to be published, copied or reproduced in part or in whole either by photography or by any other means should be kept in safe custody and handled by authorized person only.

INDEX

	Quarry Area prior to 1980
	Ulg depillared area prior to 1980
	Ulg development area prior to 1980
	Surface Infrastructure prior to 1980
	Forest Land
	Jangal (Badi)

Plant No. AMPC/Surface Plan / 2022/164 date: 14.12.22.

Bharat Coking Coal Ltd.
Amalgamated Muraidih Phularitand Colliery
Barora Area
Scale: 1:4000

Part Surface Plan Showing Surface Feature, Ulg Depillared Area, Ulg Development Area, Infrastructure Prior to 1980 along with Forest Land and Jangal Jhadi

General Manager
Barora Area

Area Manager (Estate)
Barora Area

Area Manager (Survey)
Barora Area

Surveyor
AMP Colliery

Manager
AMP Colliery

Assistant Manager
AMP Colliery

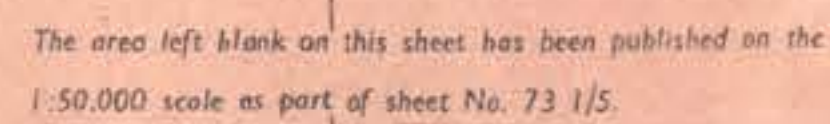

Published under the authority of Lieutenant-General Kishori Lal Khosla, B.Sc. (Distinction), B.E. (Civil), F.I.S., F.I.E., F.I.G.U., M.A.S.C.E. (U.S.A.), Surveyor General of India

PRINTED AT THE 102(P.L.O.)PRINTING GROUP OF SURVEY OF INDIA.

1981.

1:4,000





CONTOUR INTERVAL 2 METRES
Index to Sheets and Incidence on 1:50,000 Sheets.



Contours are approximate.
Tanks in this area usually contain water from June to March.
Bore holes which are found on the ground have been shown.
A relative height, J.R., represents the approximate height, in metres, between the top and bottom of a steep slope.
Benchmark heights shown on the sheet are top heights and may not be in agreement with the contours which are fixed on ground heights.

GOVERNMENT OF INDIA COPYRIGHT, 1981

This map is NOT to be published, copied or reproduced in part or in whole either by photography or by any other means should be kept in safe custody and handled by authorized persons only.

INDEX	
	Quarry Area prior to 1980
	Ulg. development area prior to 1980
	Surface Infrastructure prior to 1980
	Forest Land
	Irrigated Land

Plan No AMPC/Surface Plan / 2022/265 date: 14.12.2022

Bharat Coking Coal Ltd.
Amalgamated Muraidih Phularitand Colliery
Barora Area
Scale : 1 : 4000

Part Surface Plan Showing Surface Feature, U/g Depillared Area
U/g Development Area, Infrastructure Prior to 1980 along with Forest Land
and Jangal Jhadi

 Project Officer
 AMP Coltery

 Manager
 AMP Coltery



 Supervisor
 AMP Coltery

 General Manager
 Barona Area

 Area Manager (Survey)
 Barona Area

 Area Manager (Survey)
 Barona Area

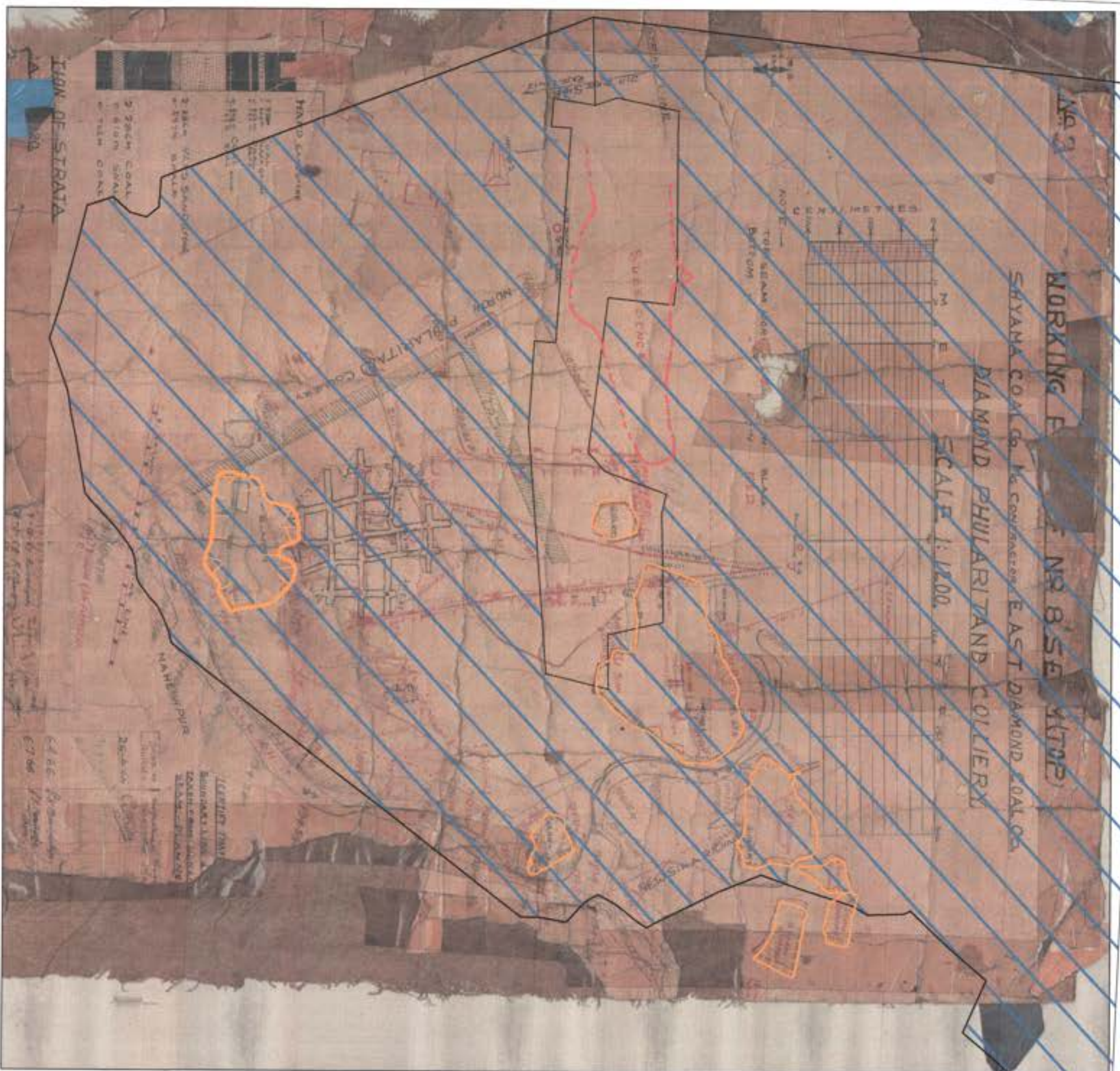
 General Manager



INDEX	
	Quarry Area prior to Nationalisation
	Subsidence area prior to Nationalisation
	U/g development area prior to Nationalisation
	Surface Infrastructure prior to Nationalisation
	Jangal Jhadi

Plan No. AMP/ Surface Plan/2022/240

Date - 14.12.2022

Bharat Coking Coal Ltd. **Amalgamated Muraidh Phularitand Colliery**

Old Mine Plan of Diomand Phularitand Colliery (Pre-Nationalised Company)
 along with Jangal Jhadi

Barora Area
 Scale : 1 : 2000

Project Officer
 AMP Colliery

Manager
 AMP Colliery

Surveyor
 AMP Colliery

Addl. General Manager
 Barora Area

Area Manager (Estate)
 Barora Area

Area Manager (Survey)
 Barora Area

General Manager
 Barora Area



INDEX

	Quarry Area
	Old U.G. developed area
	Old U.G. development area
	Surface Infrastructure
	Forest Land
	Jangal Bhumi

Plan No. BMR/Surface Plan/2022/268 Date: 16/12/2022

Bharat Coking Coal Ltd.
Amalgamated Muradhi Phulandh Colliery
 Barora Area
 Scale: 1:2000

Old Mine Plan of Central Kendra Phulandh Colliery (Pre-Nationalised Company)
 along with Forest Land and Jangal Bhumi

General Manager
 Barora Area

Project Officer
 A.M.P. Colliery

Area Manager (P&I)
 Barora Area

Area Manager (Estates)
 Barora Area

Area Manager (Survey)
 Barora Area

B.C.C.I
UNDERGROUND WORKING PLAN
OF NOT SEAM 2ND SECTION
BARORA C SECTION 1
BARORA COLLIERY

SCALE - 1CM = 12 METRES







SPECIFICATION	OF WATER DAM
BUET	EPH 2.5 CM 2ND SEC
	BAKORA SECTION
DAM No 1	
LENGTH	4.85 M
HEIGHT	2.4 M
WIDTH	1.85 M
CONSTRUCTED WITH A CLASS WALL, 20 CM	
WITH A GRADIENT 1:0.5 H:1 V	

SECTION OF NO. 7 SEAM

DATE	SPRIN.
WEEK	10
DAY	MON
TIME	5:45
WIND	10
TEMP	54
COAL	2 1/2 W SEC
BLACK STONE	6
TOTAL (300 SEC)	8

10

QAL (47.5 SEC) 11.0
STONE (47.5 SEC) 7.0

INDEX	
	Quarry Area
	Old U/g depolluted area
	Old U/g development area
	Surface infrastructure
	Forest Land
	Jungle Bush

Plan No.	Amprc	Surface Plan	2022	267	Date	14.12.2022
----------	-------	--------------	------	-----	------	------------

Bharat Coking Coal Ltd

Amalgamated Muraidih Phularitand Colliery

Barora Area
Scale : 1 : 2000

Old Mine Plan of Barora Colliery (Pre-Nationalised Company)

along with Forest Land and Jangal Jhadi

[illegible]

1. Survivor
 2. Manager
 3. Team
 4. Team
 5. Team
 6. Team
 7. Team
 8. Team
 9. Team
 10. Team
 11. Team
 12. Team
 13. Team
 14. Team
 15. Team
 16. Team
 17. Team
 18. Team
 19. Team
 20. Team
 21. Team
 22. Team
 23. Team
 24. Team
 25. Team
 26. Team
 27. Team
 28. Team
 29. Team
 30. Team
 31. Team
 32. Team
 33. Team
 34. Team
 35. Team
 36. Team
 37. Team
 38. Team
 39. Team
 40. Team
 41. Team
 42. Team
 43. Team
 44. Team
 45. Team
 46. Team
 47. Team
 48. Team
 49. Team
 50. Team
 51. Team
 52. Team
 53. Team
 54. Team
 55. Team
 56. Team
 57. Team
 58. Team
 59. Team
 60. Team
 61. Team
 62. Team
 63. Team
 64. Team
 65. Team
 66. Team
 67. Team
 68. Team
 69. Team
 70. Team
 71. Team
 72. Team
 73. Team
 74. Team
 75. Team
 76. Team
 77. Team
 78. Team
 79. Team
 80. Team
 81. Team
 82. Team
 83. Team
 84. Team
 85. Team
 86. Team
 87. Team
 88. Team
 89. Team
 90. Team
 91. Team
 92. Team
 93. Team
 94. Team
 95. Team
 96. Team
 97. Team
 98. Team
 99. Team
 100. Team
 101. Team
 102. Team
 103. Team
 104. Team
 105. Team
 106. Team
 107. Team
 108. Team
 109. Team
 110. Team
 111. Team
 112. Team
 113. Team
 114. Team
 115. Team
 116. Team
 117. Team
 118. Team
 119. Team
 120. Team
 121. Team
 122. Team
 123. Team
 124. Team
 125. Team
 126. Team
 127. Team
 128. Team
 129. Team
 130. Team
 131. Team
 132. Team
 133. Team
 134. Team
 135. Team
 136. Team
 137. Team
 138. Team
 139. Team
 140. Team
 141. Team
 142. Team
 143. Team
 144. Team
 145. Team
 146. Team
 147. Team
 148. Team
 149. Team
 150. Team
 151. Team
 152. Team
 153. Team
 154. Team
 155. Team
 156. Team
 157. Team
 158. Team
 159. Team
 160. Team
 161. Team
 162. Team
 163. Team
 164. Team
 165. Team
 166. Team
 167. Team
 168. Team
 169. Team
 170. Team
 171. Team
 172. Team
 173. Team
 174. Team
 175. Team
 176. Team
 177. Team
 178. Team
 179. Team
 180. Team
 181. Team
 182. Team
 183. Team
 184. Team
 185. Team
 186. Team
 187. Team
 188. Team
 189. Team
 190. Team
 191. Team
 192. Team
 193. Team
 194. Team
 195. Team
 196. Team
 197. Team
 198. Team
 199. Team
 200. Team
 201. Team
 202. Team
 203. Team
 204. Team
 205. Team
 206. Team
 207. Team
 208. Team
 209. Team
 210. Team
 211. Team
 212. Team
 213. Team
 214. Team
 215. Team
 216. Team
 217. Team
 218. Team
 219. Team
 220. Team
 221. Team
 222. Team
 223. Team
 224. Team
 225. Team
 226. Team
 227. Team
 228. Team
 229. Team
 230. Team
 231. Team
 232. Team
 233. Team
 234. Team
 235. Team
 236. Team
 237. Team
 238. Team
 239. Team
 240. Team
 241. Team
 242. Team
 243. Team
 244. Team
 245. Team
 246. Team
 247. Team
 248. Team
 249. Team
 250. Team
 251. Team
 252. Team
 253. Team
 254. Team
 255. Team
 256. Team
 257. Team
 258. Team
 259. Team
 260. Team
 261. Team
 262. Team
 263.

Project Officer	AMP Colliery	AMP Colliery	AMP Colliery

[Handwritten signature]

Area Manager (Surrey)
Barro Area

Area Manager (Tate)
Barro Area

Area Manager (Pig)
Barro Area

Asst. General Manager
Barro Area

10. *Journal of the American Medical Association*, 2000; 284: 2689-2695.

2000-2001

General Manager
Barora Area

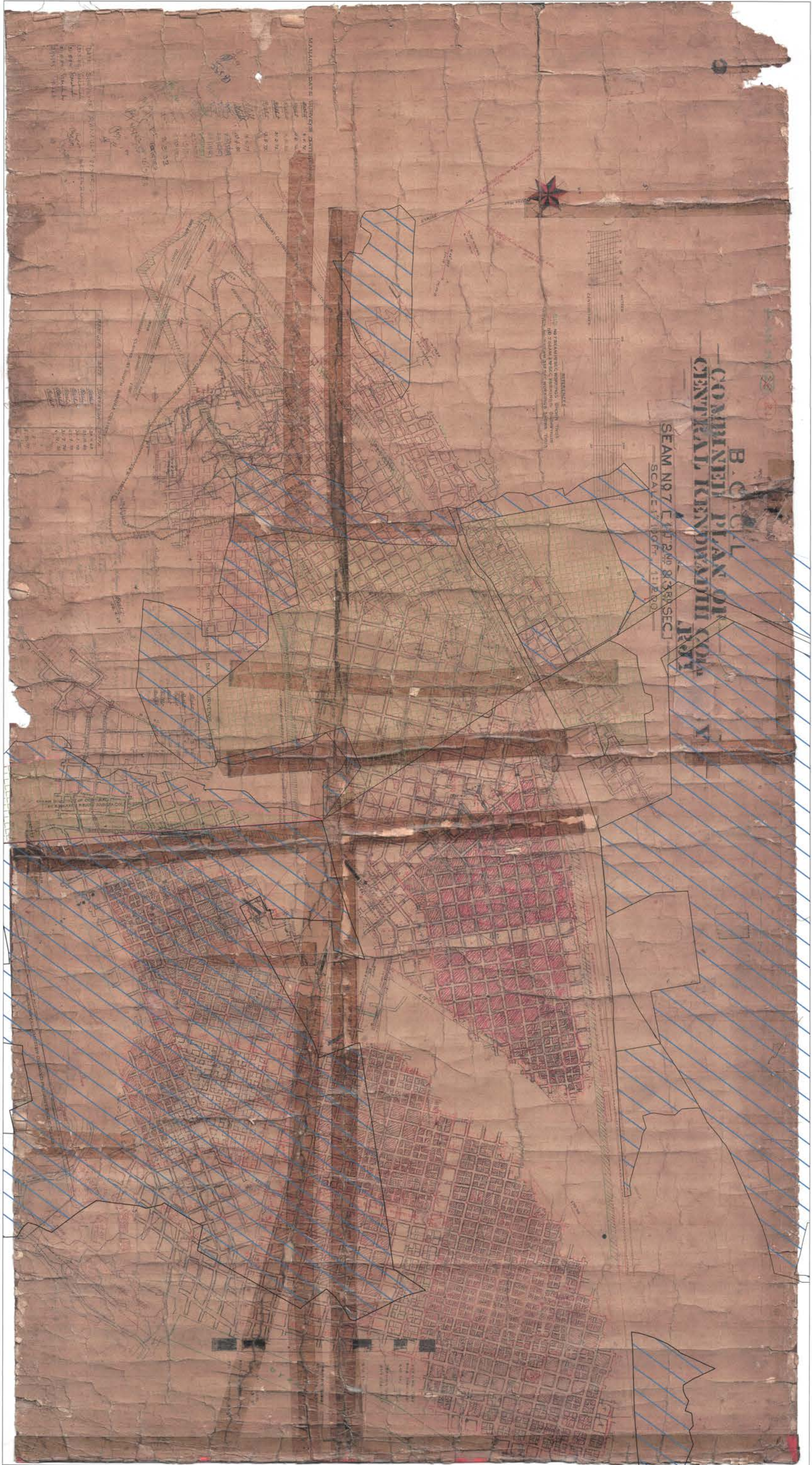

INDEX	
	Quarry Area
	Old Ulg settled area
	Old Ulg settlement area
	Surface Infrastructure
	Forest Land
	Jangal Badi

Plan No. AMPC/Surface Plan/2023/269 Scale: 1:10,000

Bharat Coking Coal Ltd.
Amalgamated Muraidih Puhariland Colliery
Scale - 1 : 2000

Old Mine Plan of Central Kendraah Colliery (Pre-Nationalised Company)
along with Forest Land and Jangal Badi

[Signature] Project Officer
AMPC Colliery

[Signature] Manager
AMPC Colliery

[Signature] Asst. Manager (Estate)
Baroda Area

[Signature] Asst. Manager (Survey)
Baroda Area

[Signature] General Manager
Baroda Area