

**Annexure-18**

Details of non-forest land / degraded forest area identified for compensatory afforestation viz.. Survey No. / Compartment No. / Khasra No./ Khatoni No. Village, Tehsil, District etc. along with map in appropriate scale showing the boundaries of adjoining forest areas with their use in distinct colours and GPS readings.

Sr.No.	Details	Description
1	Village	Jadiyal
2	Taluka	Palanpur
3	District	Banaskantha
4	Survey No/Compartment No./Khasra No.	88/pt.
5	Area To be Afforested	1.68 Ha.
6	Name of Range	Palanpur
7	Name of Division	Banaskantha
8	G.P.S. Location With Longitude & Latitude of Proposal	Attached herewith

Palanpur

Date: 8 /12/2020

Dy. Conservator of Forests,  
Banaskantha Palanpur

## Compensatory Afforestation scheme

Village: Jadhival  
Taluka: Palanpur  
Dist.: Banaskantha  
Survey no.: 88/pt.  
Ha: 1.68  
Range: Palanpur

P2-N24.21935 E72.56821

P1-N24.21934 E72.56666

P4-N24.21839 E72.56668

P3-N24.21836 E72.56823

Google Earth

Image © 2020 Maxar Technologies  
© 2020 Google

90 m



*[Handwritten signature]*

Deputy Conservator of Forests  
Banaskantha, Palanpur.

93

**Compensatory Afforestation Scheme for Non forest area acquired under FCA Proposal**

Diversion of 1.68 ha Forest/Sanctuary Land For use of Constructing Checkdam on Baram River near Baram Temple At. village Chitrasani, Taluka - Palanpur, Dist. Banaskantha.

Detailed scheme of Compensatory Afforestation for Non forest area acquired under FCA Proposal 1.68 ha. to be carried out in lieu of 1.68 ha. of Forest/Sanctuary land to be diverted in Banaskantha Forest Division, Palanpur.

**1. Details of degraded land.**

Village	Jadiyal
Taluka	Palanpur
Range	Palanpur
District	Banaskantha
Division	Banaskantha
Block/ Patal, Compartment No., Survey No	88/ pt
Area to be afforested	1.68 Ha.
Working circle	--

**2. Description of Area.**

Soil type	Sandy/Soft Murram
Topography	Medium
Slope	Medium
Whether the area is bearing any root stock of Vegetation	Yes

**3. Name of Plantation Programme:-**

Compensatory Afforestation Scheme for Non forest area acquired under FCA Proposal.

**4. Schedule of Plantation Programme:-**

(i)	The Compensatory Afforestation on Non forest area acquired under FCA Proposal would be started by Dy.Conservator of Forest Banaskantha Division as early as possible after the proposal is formally approved.
(ii)	Compensatory Afforestation will be done in 1.68 ha. area. The total afforestation cost will be about <b>Rs. 9,91,954/-</b> Executive Engineer Sipu Project Division, Palanpur has given an undertaking to pay the cost of Compensatory Afforestation as per the prevailing wages (including the price escalation and supervision charges).

## 5. Technical Details:-

Technical details of Compensatory Afforestation are as Follows:

Sr. No.	Details	Specifications																																										
a	General Details	The C.A. will be taken under Compensatory Afforestation Non forest area acquired under FCA Proposal. The prevailing wage rates 324.50 per day.																																										
b	Spacement	3 X 3 mtr., 1111 plants per ha.																																										
c	Species to be planted (No. of plants per ha.)	<table border="1"> <thead> <tr> <th>Speaces</th> <th>Number of Tree</th> <th>Minimum planting height (in cm.)</th> <th>Minimum planting collar growth (in cm.)</th> </tr> </thead> <tbody> <tr> <td>Babul</td> <td>100</td> <td>65</td> <td rowspan="12">Minimum planting collar growth 1c.m. diameter at the time of planting.</td> </tr> <tr> <td>Kanji</td> <td>200</td> <td>75</td> </tr> <tr> <td>Boradi</td> <td>250</td> <td>65</td> </tr> <tr> <td>Neem</td> <td>50</td> <td>75</td> </tr> <tr> <td>Gunda</td> <td>50</td> <td>75</td> </tr> <tr> <td>Gundi</td> <td>50</td> <td>50</td> </tr> <tr> <td>Bamboo</td> <td>25</td> <td>65</td> </tr> <tr> <td>Ardusa</td> <td>125</td> <td>90</td> </tr> <tr> <td>RagatRoyado</td> <td>50</td> <td>50</td> </tr> <tr> <td>Garmalo</td> <td>100</td> <td>65</td> </tr> <tr> <td>Khakhro (Butea monospermavar, lutea), Dudhkudi (Wrightiatinctoria), Aval, kada</td> <td>111</td> <td>50</td> </tr> <tr> <td><b>Total</b></td> <td><b>1111</b></td> <td></td> <td></td> </tr> </tbody> </table>	Speaces	Number of Tree	Minimum planting height (in cm.)	Minimum planting collar growth (in cm.)	Babul	100	65	Minimum planting collar growth 1c.m. diameter at the time of planting.	Kanji	200	75	Boradi	250	65	Neem	50	75	Gunda	50	75	Gundi	50	50	Bamboo	25	65	Ardusa	125	90	RagatRoyado	50	50	Garmalo	100	65	Khakhro (Butea monospermavar, lutea), Dudhkudi (Wrightiatinctoria), Aval, kada	111	50	<b>Total</b>	<b>1111</b>		
Speaces	Number of Tree	Minimum planting height (in cm.)	Minimum planting collar growth (in cm.)																																									
Babul	100	65	Minimum planting collar growth 1c.m. diameter at the time of planting.																																									
Kanji	200	75																																										
Boradi	250	65																																										
Neem	50	75																																										
Gunda	50	75																																										
Gundi	50	50																																										
Bamboo	25	65																																										
Ardusa	125	90																																										
RagatRoyado	50	50																																										
Garmalo	100	65																																										
Khakhro (Butea monospermavar, lutea), Dudhkudi (Wrightiatinctoria), Aval, kada	111	50																																										
<b>Total</b>	<b>1111</b>																																											
d	Nursery Technique	Nine months old polypot raised plants will be planted at the onset of monsoon.																																										
e	Site Preparation	The malformed rootstock present in the area will be cutback & the site will be cleaned in the month of Nov-Dec. Alignment & pit digging 45 x 45 x 45 cms. will be carried out in the month of Dec-Jan.																																										
f	Plantation Method	Polypot raised plants will be planted during monsoon.																																										
g	Soil & Moisture Conservation Works	(i) Pucca structure like Check dam, check wall, retaining wall (ii) Contour trenches 2.00 x 0.45 x 0.30, 300 Nos/ha.will be dug along the contour line. the dug out soil will be heaped on the down ward side. Gully plugging, Nala Banding & percolation tank will be carried out as per requirement. Seeds of Jatropha, Agave plants ...etc. will be planted during monsoon in the upper side of nala as per suitability.																																										
h	Protection Trench	Barbed wire fencing, Seed sowing And planting of cuttings of Ipomea/Glarcidia along the fence																																										
i	Silvicultural Operations	1 <sup>st</sup> year three weeding soil working, Support watering will be provided if needed. 2 <sup>nd</sup> year two weeding soil working. 3 <sup>rd</sup> year one weeding soil working.																																										
j	Maintenance	It is proposed to maintain the Plantation up to ten years.																																										

k	Subsequent silvicultural Operation	Cleaning, cutbacks, thinning etc. (as per species specific requirement) will be carried out at the age as per prescribed in the working plan. 99
l	Proposed monitoring mechanism	<p>(i) A plantation register is to be maintained.</p> <p>(ii) Monitoring is to be done as per the following norms. Forester – 100% RFO – 100% ACF – 20% DCF – 10%</p> <p>(iii) The results of survival etc. are maintained in the plantation register on a periodical basis, which is updated at the end of September and March each year.</p> <p>(iv) The collar girth is also to be reordered at the end of each year.</p> <p>(v) At the end of maintenance period, the area is aimed at full stocking and pole crop girth for all the species, except bamboo.</p> <p>(vi) Bamboo would be of the harvestable size by the end of 4<sup>th</sup> year.</p> <p>(vii) Third party monitoring mechanism is also in the State and if the plantation is in the sample selected, it will also be monitored by the third party selected for this purpose.</p>
m	Regeneration cleaning	Cut-back and promotion of root suckers.
n	Silviculture & other activities	Only afforestation aimed plantation will be taken up, as the area falls under degraded forest land.

  
Dy. Conservator of Forest  
Banaskantha, Palanpur

The Compensatory Afforestation scheme at the cost of **Rs. 9,91,954/-** is technically and administrative approved by the undersigned.

  
Dy. Conservator of Forest  
Banaskantha, Palanpur

181

## Model No - 3

Compensatory Afforestation Scheme for Non forest area acquired under FCA Proposal

Daily wages Rs.324.50

Spacemts = 3 m x 3 m				
1111 seedling / ha				
1st year replacement 10 % = 111 seedling / ha				
2nd year replacement 20 % = 111+111 seedling / ha				
3rd year replacement 10 % = 111 seedling / ha				
Total Seedlings = 1333 seedling / ha				
Polypot size : 15 cm X 25 cm X 200				
Item of work 1	Qty. 2	Labour 3	Material 4	Total 5
<b>0 year</b>				
Nursery				
(a) Cost of soil, ,manure, seeds, water, fertillizer, insecticides, implements, rent of lands. Shade, etc. (including 10 % for casuality replacement)	1222	0	1913	1913
(b) labour : Preparation of beds, filling and arranging of bags,showing of seeds, watering shifting, weeding etc.	1222	4681	242	4923
(c) Seedling cost for casuality replacement in one year old (20%)	222	1478	442	1920
(d) Seedling cost for casuality replacement in two year old (10%)	111	740	220	960
<b>Total</b>		<b>6899</b>	<b>2817</b>	<b>9716</b>
<b>2. Area Development ( Land Preparation )</b>				
(a) Survey, cutback and promotion of root suckers		3518	0	3518
(b) Aligment and digging of pits 0.45 X 0.45 X 0.45	1111 @ 6.00	10156	0	10156
<b>Total</b>		<b>13674</b>	<b>0</b>	<b>13674</b>
(a) Natural fertilizer (Neem cake/ Castor cake)	1111 @ 5.00	0	10360	10360
<b>Total</b>		<b>0</b>	<b>10360</b>	<b>10360</b>
<b>3. SMC Works</b>				
(a) Check wall/ retaining wall /checkdem (all pucca only)	L.S.	12495	24804	37299
(b) Contour trench 2 M x 45 Cm x 30 Cm as per Rs.17.00/rmt (300 trench)	600 rmt.	9512	0	9512
<b>Total</b>		<b>22007</b>	<b>24804</b>	<b>46811</b>
<b>4. Protection</b>				
(a) Barbed wire fencing per 1 rmt. 457/- Rs.	315 rmt.	63340	95010	158350
(b) Seed sowing and planting of cuttings of Ipomea/ Glaricidia along the fence		1161	498	1659
<b>Total</b>		<b>64501</b>	<b>95508</b>	<b>160009</b>
<b>Total for 0 year</b>		<b>107081</b>	<b>133489</b>	<b>240570</b>
<b>1st Year</b>				
(a) Maintenance of nursery (April to June)	1222	3590	359	3949
(b) Transport of seedling for plantation	1111	1970	407	2377
(c) Planting with khamna of Min 1 m dia	1111	6055	0	6055
(d)Transport & planting of seediling for casuality replacement	111	210	46	256
(e) 3 weeding cum soil working	1111	23600	0	23600
(f) Support watering 5 times @ 3.25		15085	21647	36732
(g) Protection / tending operation		4883	0	4883
(h) Tending to natural vegetation		1220	0	1220
(i) Contigency		0	1220	1220
<b>Total for 1st year</b>		<b>56613</b>	<b>23679</b>	<b>80292</b>

Item of work	Qty.	Labour	Material	Total
<b>2nd Year</b>				
(a) 2 weeding & soil working		13108	0	13108
(b) 20 % Casually replcement, transport and planting	111+111	221	1097	1318
(c) Natural fertilizer (neem cake / caster cake ) etc.	Rs.5/ plant	0	12243	12243
(d ) Support watering 3 times @ 3.25		9803	14070	23873
(e) Protection / tending operation		5290	0	5290
<b>Total for 2nd year</b>		<b>28422</b>	<b>27410</b>	<b>55832</b>
<b>3rd Year</b>				
(a) 2 weeding & soil working		14116	0	14116
(b) 10 % Casually replcement, transport and planting	111	119	591	710
(b) Natural fertilizer, neem cake etc.	Rs.5/ plant	0	13185	13185
(c ) Support watering 1 times @ 3.25		3520	5051	8571
(d) Protection & maintenance of fencing / tending operation	L.S.	7120	0	7120
<b>Total for 3rd year</b>		<b>24875</b>	<b>18827</b>	<b>43702</b>
<b>4thYear</b>				
(a) 1 weeding & soil working		7560	0	7560
(b) Protection & Maintenance of fencing/ Tending operation	L.S.	7629	0	7629
<b>Total for 4th year</b>		<b>15189</b>	<b>0</b>	<b>15189</b>
<b>5thYear</b>				
Protection & maintenance of fencing/ tending operation	L.S.	8138	0	8138
<b>Total for 5th year</b>		<b>8138</b>	<b>0</b>	<b>8138</b>
<b>6thYear</b>				
Protection & maintenance of fencing/ tending operation	L.S.	8646	0	8646
<b>Total for 6th year</b>		<b>8646</b>	<b>0</b>	<b>8646</b>
<b>7thYear</b>				
Protection & maintenance of fencing/ tending operation	L.S.	9155	0	9155
<b>Total for 7th year</b>		<b>9155</b>	<b>0</b>	<b>9155</b>
<b>8thYear</b>				
Protection & maintenance of fencing/ tending operation	L.S.	9663	0	9663
<b>Total for 8th year</b>		<b>9663</b>	<b>0</b>	<b>9663</b>
<b>9thYear</b>				
Protection & maintenance of fencing/ tending operation	L.S.	10172	0	10172
<b>Total for 9th year</b>		<b>10172</b>	<b>0</b>	<b>10172</b>
<b>10thYear</b>				
Protection & maintenance of fencing/ tending operation	L.S.	10681	0	10681
<b>Total for 10th year</b>		<b>10681</b>	<b>0</b>	<b>10681</b>
<b>SubTotal</b>		<b>288635</b>	<b>203405</b>	<b>492040</b>
<b>Total cost of supervision/subsequentalsilvicultureal operations</b>	20%	57727	40681	98408
<b>Grand Total</b>		<b>346362</b>	<b>244086</b>	<b>590448</b>

**Note :-**

- (1) Seed sowing along fencing towards the inner side.
- (2) Planting of cutting of ipomea//Glarcidia along the fencing towards outer side

  
 Dy. Conservator of Forests  
 Banaskantha, Palanpur  
 Model-3-1111 Final @310.40 (2)

## Rate Structure for Compensatory Afforestation Scheme

Daily Wages : Rs. 324.50

Model-3 1111 Pt/Ha.

Sr. No.	Rate	Hactor	0 Year	1st Year	2nd Year	3rd Year	4th Year	5th Year	6th Year	7th Year	8th Year	9th Year	10th Year	Total	20% Add	Grand Total
1	3	4	5	6	7	8	9	10	11	12	13	14	15	16	17	18
A	Normal Rate par 1.00 Ha.	1.00	218700	66911	42948	31216	10126	5086	5086	5086	5086	5086	5086	400417	80083	480500
B	Increased Rate par 1.00 Ha. by 10% Year	1.00	240570	80292	55832	43702	15189	8138	8646	9155	9663	10172	10681	492040	98408	590448
A	Normal Rate	1.6800	367416	112410	72153	52443	17012	8544	8544	8544	8544	8544	8544	672698	134540	807238
B	Increased by 10% Year	1.6800	404158	134891	93798	73419	25518	13672	14525	15380	16234	17089	17944	826628	165326	991954
														<b>Total Cost Rs.</b>	<b>991954</b>	



Dv. Conservator of Forests  
Banaskantha, Palanpur

105

<b>NB:(1)</b>	
For Different Years the rate shown for B has been derived from A as Follows.	
0 Year-B=A +10% of A	6 Year-B=A +70% of A
1 Year-B=A +20% of A	7 Year-B=A +80% of A
2 Year-B=A +30% of A	8 Year-B=A +90% of A
3 Year-B=A +40% of A	9 Year-B=A +100% of A
4 Year-B=A +50% of A	10 Year-B=A +110% of A
5 Year-B=A +60% of A	
<b>NB:(2)-</b>	
In column 17 the additional 20% is towards the cost of supervision/subsequent silvicultural operations	

Name of works	Model No.	Area		Rate per	Amount										Total Rs.				
		H.A.	Hac.		0 Year	1st Year	2nd Year	3rd Year	4th Year	5th Year	6th Year	7th Year	8th Year	9th Year		10th Year	20%		
0 Year 70 % Adv.work. 1st Year Operation.	Model-3	1.6800	240570	404158	0	0	0	0	0	0	0	0	0	0	0	0	0	80832	484990
1st Year 30 % Advance work Current year plantation			80292	0	134891	0	0	0	0	0	0	0	0	0	0	0	0	26978	161869
2nd Year operation Maintenance of one year old plantation.			55832	0	0	93798	0	0	0	0	0	0	0	0	0	0	0	18760	112558
3rd Year operation Maintenance of 2 years old plantation.			43702	0	0	0	73419	0	0	0	0	0	0	0	0	0	0	14684	88103
4th year operation Maint.of 3 years old plantation.			15189	0	0	0	0	25518	0	0	0	0	0	0	0	0	0	5104	30622
5th year operation Maint.of 4 years old plantation.			8138	0	0	0	0	0	13672	0	0	0	0	0	0	0	0	2734	16406
6th year operation Maint.of 5 years old plantation.			8646	0	0	0	0	0	0	14525	0	0	0	0	0	0	0	2905	17430
7th year operation Maint.of 6 years old plantation.			9155	0	0	0	0	0	0	0	15380	0	0	0	0	0	0	3076	18456
8th year operation Maint.of 7 years old plantation.			9663	0	0	0	0	0	0	0	0	16234	0	0	0	0	0	3247	19481
9th year operation Maint.of 8 years old plantation.			10172	0	0	0	0	0	0	0	0	0	17089	0	0	0	0	3418	20507
10th year operation Maint.of 9 years old plantation.			10681	0	0	0	0	0	0	0	0	0	0	17944	0	0	0	3589	21533
Total			492040	404158	134891	93798	73419	25518	13672	14525	15380	16234	17089	17944	165325.6	17944	165325.6	991954	

  
Dy. Conservator of Forests  
Banaskantha, Palanpur

## ***CERTIFICATE***

This is to certify that the compensatory afforestation scheme attached herewith for 1.68 ha. in Jadiyal Village, Ta. Palanpur, Survey No. 88pt. in lieu 1.68 ha. Diversion of 1.68 ha Forest/Sanctuary Land For use of Constructing Checkdam on Balaram River near Balaram Temple At. village Chitrasani, Taluka - Palanpur, Dist. Banaskantha. with the guidelines issued vide additional Principal Chief Conservator of Forests, Land Gujarat State Gandhinagar Letter No. land/31/b/147-216/2016-17, Dated.06/04/2016 and same is here by approved technically.

Palanpur

Date: 8/12/2020



Dy.Conservator of Forests,  
Banaskantha-Palanpur

**CERTIFICATE**

This is to certify that I have visited 1.68 ha. area of Jadiyal Village of Palanpur Range Non forest land (for taking up 1.68 ha. of CA), Survey No.88pt. Jadiyal Village, Ta. Palanpur, Dist. Banaskantha on dt. 7/12/2020 (Date) which has been identified for compensatory Afforestation Scheme against the 1.68 ha. Diversion of 1.68 ha Forest/Sanctuary Land For use of Constructing Checkdam on Balaram River near Balaram Temple At. village Chitrasani, Taluka - Palanpur, Dist. Banaskantha. for Forest land the side area is suitable for compensatory afforestation. It is also certified that the compensatory afforestation scheme suggested in the area is in consonance with the Site specific treatment Requirements.

Palanpur

Date: 8/12/2020



Dy.Conservator of Forests,  
Banaskantha-Palanpur

Detailed scheme of Compensatory Afforestation to be carried out in lieu of 1.68 Ha. of Non forest land for Diversion of 1.68 ha Forest/Sanctuary Land For use of Constructing Checkdam on Balaram River near Balaram Temple At. village Chitrasani, Taluka - Palanpur, Dist. Banaskantha. the Purpose of Checkdam.

Sr.No.	Name of Village	Taluka	District	Survey No.	C.A. Area to be carried out for this proposal ha.
1	Jadiyal	Palanpur	Banaskantha	88/pt	1.6800

Dy.Conservator of Forests,  
Banaskantha-Palanpur

Detailed of Compensatory Afforestation scheme to be carried out in lieu of 1.68 Ha. of Non Forest land to Executive Engineer Sipu Project Division, Palanpur Proposal For Diversion 1.68 Ha. Forest Land of Banaskantha Forest Division For The Purpose of Check Dem.

Village:Jadiyal  
Taluka:Palanpur  
Dist.:Banaskantha  
Survey no.:88/pt.  
Ha:1.68  
Range:Palanpur

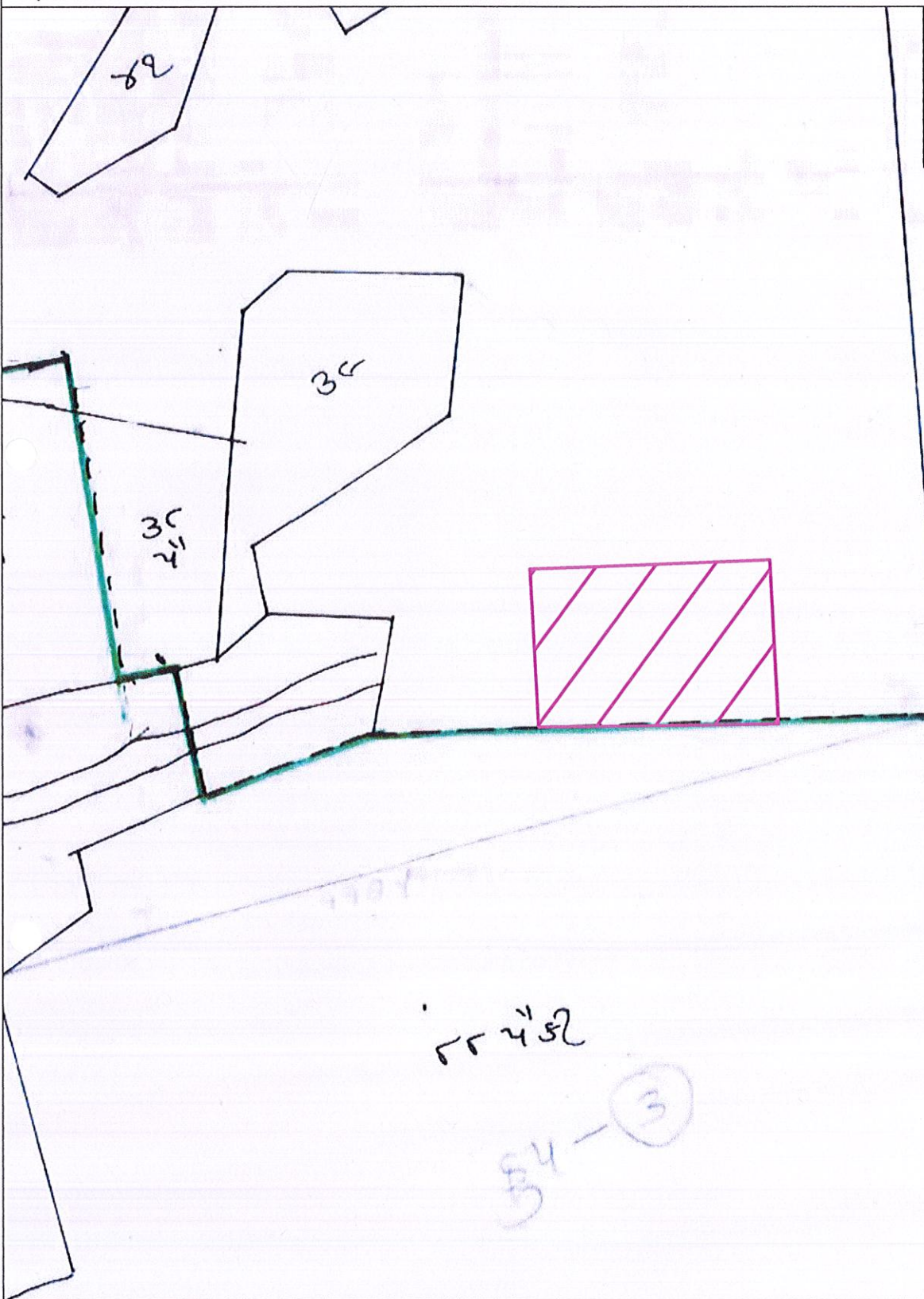

 Forest Area

 Area to be taken for Compensatory Afforestation 1.68 Ha.



SCALE:1 C.M = 39.60 M.T

  
Deputy Conservator of Forests  
Banaskantha, Palanpur.

Detailed of Compensatory Afforestation scheme to be carried out in lieu of 1.68 Ha. of Non Forest land to Executive Engineer Sipu Project Division, Palanpur Proposal For Diversion 1.68 Ha. Forest Land of Banaskantha Forest Division For The Purpose of Check Dem.

Topo Sheet No.  
G43512  
Village: Jadiyal  
Taluka: Palanpur  
Dist.: Banaskantha  
Survey no.: 88/pt.  
Ha: 1.68  
Range: Palanpur

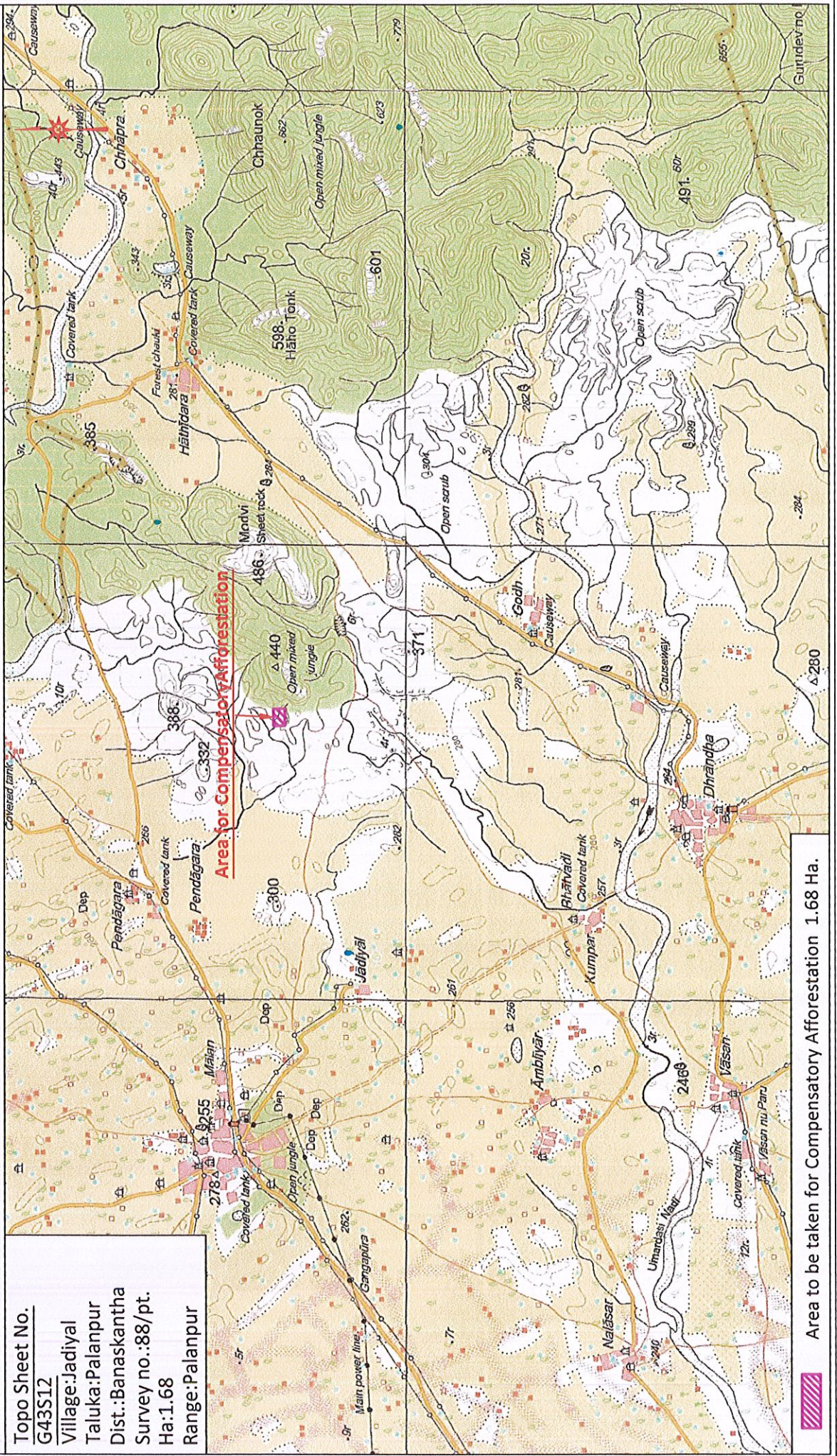

*(Handwritten signature)*

Deputy Conservator of Forests  
Banaskantha, Palanpur.

**Annexure-21****CERTIFICATE**

This is certified that 1.68 Ha. land of S.No. 88pt. of Village Jadiyah, Ta. Palanpur, Dist. Banaskantha proposal for Compensatory Afforestation against the Diversion of 1.68 ha Forest/Sanctuary Land For use of Constructing Checkdam on Balam River near Balam Temple At. village Chitrasani, Taluka - Palanpur, Dist. Banaskantha. is identified and found suitable for afforestation.

Palanpur

Date: 8/12/2020



Dy.Conservator of Forests,  
Banaskantha-Palanpur