

GOVERNMENT OF MEGHALAYA
OFFICE OF THE DIVISIONAL FOREST OFFICER
SOCIAL FORESTRY & TERRITORIAL DIVISION
WEST & SOUTH WEST KHASI HILLS, NONGSTOIN

No. T/WSW/80/CA/Lafarge/5. 156 ha/ 832

Dated: Nongstoin, the 22nd July, 2021

From: The Divisional Forest Officer
Social Forestry & Territorial Division
West & South West Khasi Hills, Nongstoin

To, ☒ The Divisional Forest Officer,
East Khasi Hills & Ri Bhoi (T) Division, Shillong

Subject: Forest diversion for shale-siltstone mining project over an area of 5.156 ha of forest land located at Shella Village in East Khasi Hills District of Meghalaya in favour of M/S Lafarge Umiam Mining Private Limited (LUMPL)

Ref: KH/1/45/301/1673 dated: 16-07-2021

Sir,

With reference to the subject and letter under reference above, I am submitting herewith the Land Sustainability Certificate for proposed Compensatory Afforestation area of 5.156 Ha of M/S Lafarge.

This is for your kind information and necessary action.

Enclosed: As above

Yours Faithfully



(Dr. G H CHYRMANG, MFS)
Divisional Forest Officer
Social Forestry & Territorial Division
West & South West Khasi Hills, Nongstoin

No. T/WSW/80/CA/Lafarge/5. 156 ha/ _____

Dated: Nongstoin, the ____ July, 2021

Copy to:

1. The Chief Conservator of Forests (FC Act), Meghalaya, Shillong for information and necessary action.

Divisional Forest Officer
Social Forestry & Territorial Division
West & South West Khasi Hills, Nongstoin

Land Suitability Certificate for Compensatory Afforestation
in lieu of Forest diversion for shale-siltstone mining project over an area of 5.156 ha of forest
land located at Shella Village in East Khasi Hills District of Meghalaya in favour of M/S Lafarge
Umiam Mining Private Limited (LUMPL)

The proposed Compensatory Afforestation land of 5.156 Ha has been identified contiguous to 31.145 Ha CA land of Green Valley Industrial Limited towards the North West which in turn is contiguous to Nongumiang Reserve Forest of Social Forestry & Territorial Division, West & South West Khasi Hills, Nongstoin. Further it is certified that the land identified as above is blank area and is suitable for creation of new plantation under Compensatory Afforestation Scheme and for Management purposes. The aforesaid land is free from encroachment and shall be used for Compensatory Afforestation in lieu of forest diversion of 5.156 Ha of land in favour of M/S Lafarge Umiam Mining Private Limited for shale-siltstone mining project located at Shella Village in East Khasi Hills District of Meghalaya and not for any other purposes.



Divisional Forest Officer,
Social Forestry & Territorial Division,
West & South West Khasi Hills, Nongstoin

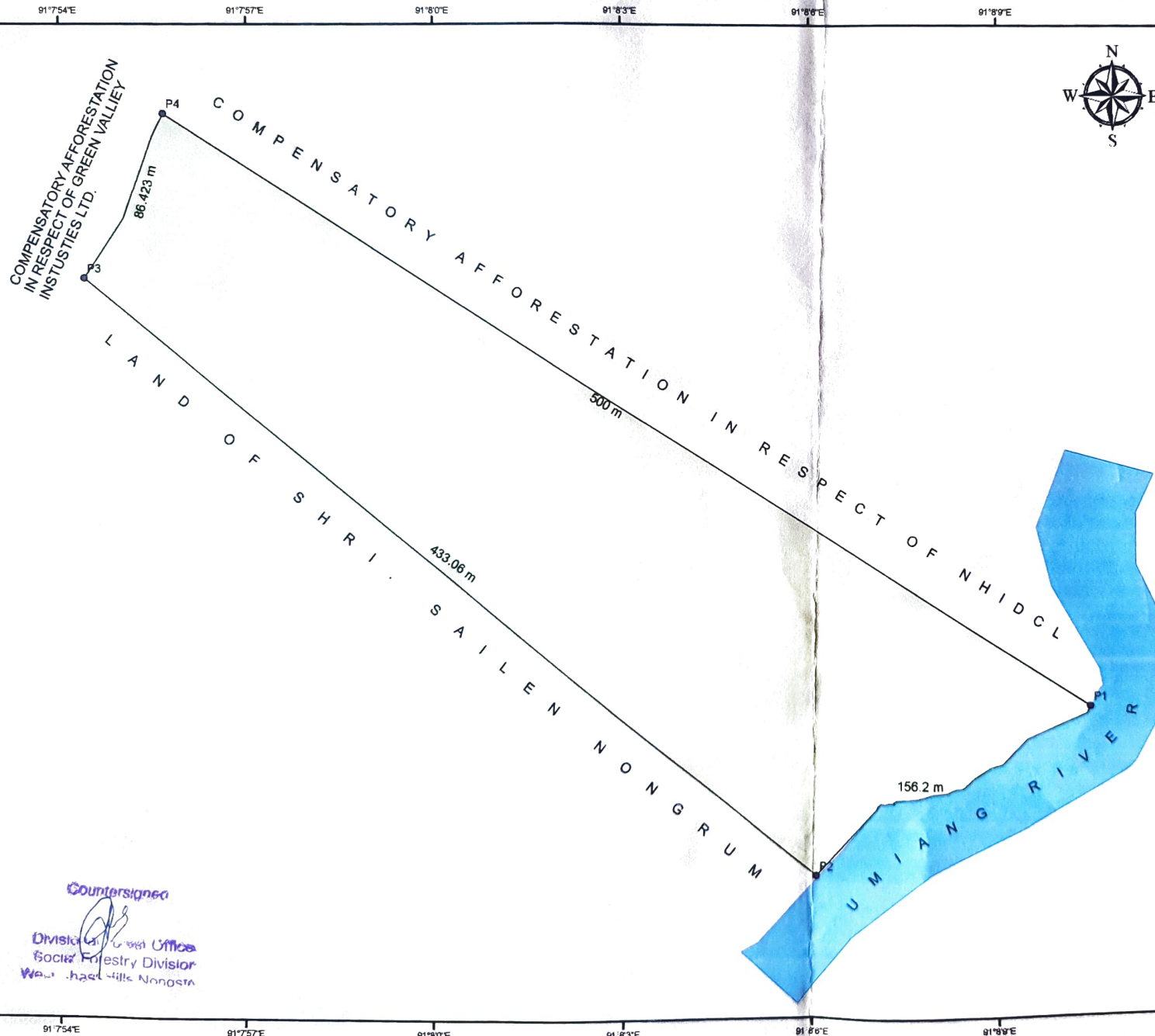

**MAP SHOWING THE SITE FOR COMPENSATORY AFFORESTATION IN RESPECT OF LAFARGE UMIAM MINING PRIVATE LIMITED,
AT NONGUMIANG, WEST KHASI HILLS DISTRICT, MEGHALAYA
GPS MAP**

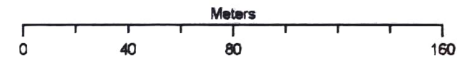

Area: 5.156 hectares
Perimeter: 1.176 km
1 centimeter = 20 meters



INDEX

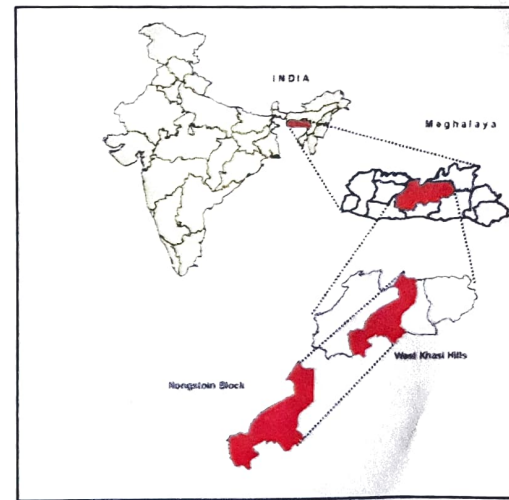

WAYPOINTS	LONGITUDE	LATITUDE
P1	91° 08' 10.4700" E	25° 26' 5.6347" N
P2	91° 08' 6.0841" E	25° 26' 2.9646" N
P3	91° 07' 54.4093" E	25° 26' 12.2205" N
P4	91° 07' 55.6688" E	25° 26' 14.7663" N

Legend

- WAYPOINTS
- BOUNDARY LINE
- LAND AREA
- RIVER

Countersigned
Divisional Forest Officer
Social Forestry Division
West Khasi Hills Nongstoin