

SITE PLAN  
SCALE 1:2000

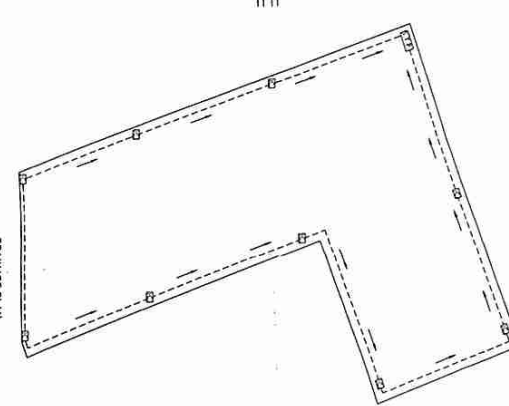

DRAINAGE PLAN  
SCALE 1:1000

PROPOSED SITE FOR GURU NANAK DEV NURSING COLLEGE  
PNO/DA NO. 31/1/27, 12/2, 15, 1, 12

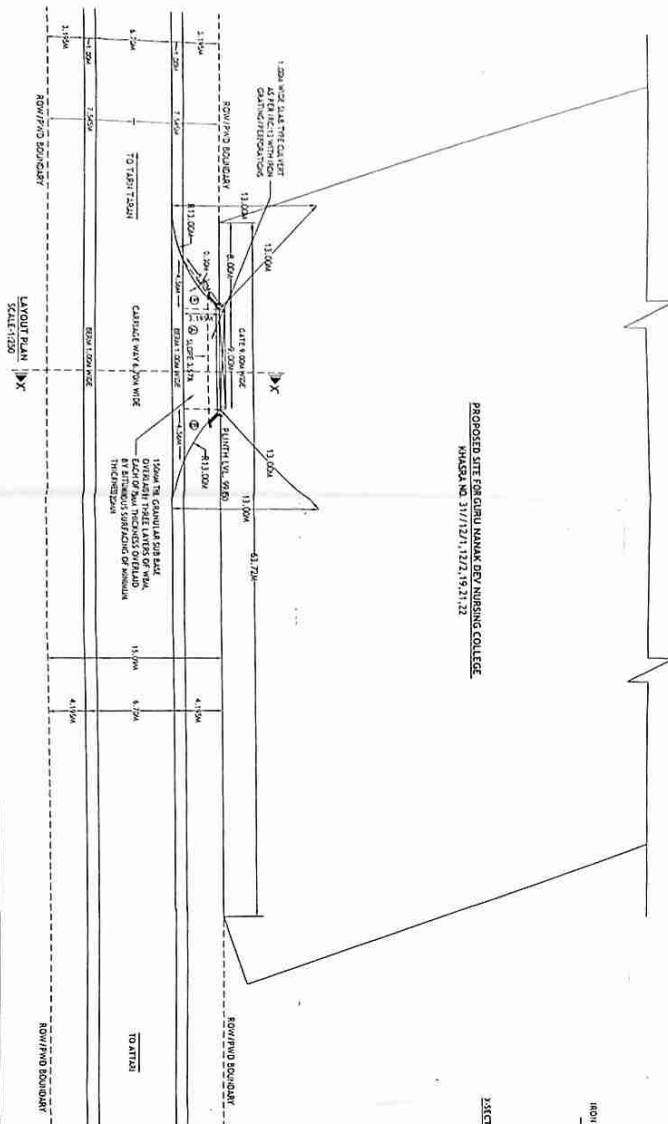

LAYOUT PLAN  
SCALE 1:200

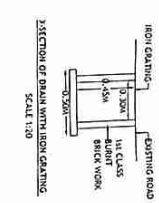

SECTION OF DRAIN WITH ROAD CROSSING  
SCALE 1:30

AREA OF APPROACHES (TO BE LEASED)	
1. AREA OF A	= 9.00X.195
	= 28.7550 M.
2. AREA OF B	= 21.12X.195X.56
	= 12.3450 M.
TOTAL	= 41.0950 M.

TYPICAL X-SECTION OF APPROACH ROAD  
SCALE 1:30

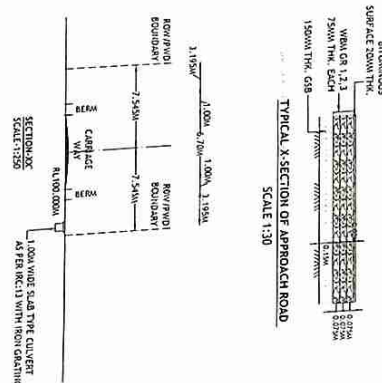

SECTION OF SLAB TYPE CULVERT  
SCALE 1:30

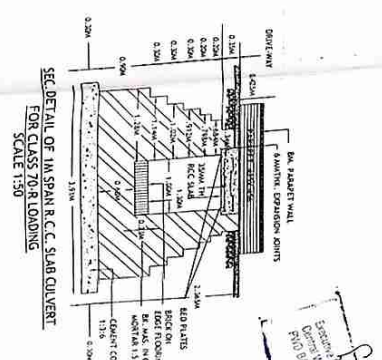

SECTION OF SLAB TYPE CULVERT  
SCALE 1:30

CLIENT:-  
BABA JIWAN SINGH BABA DALIP SINGH  
EDUCATIONAL TRUST (REGD.)  
HEAD OFFICE : GOINDWAL, SAHIB ROAD, TARN TARAN.  
AUTHORIZED SIGNATORY :- S. SUKAKHAN SINGH (P.B.)

NOTES  
1. CERTIFIED THAT ALL THE TRAFFIC SIGNS ARE AS PER  
IRC: 67-2001 AND IRC: 55-2001.  
2. CERTIFIED THAT THERE IS NO ANY BARRIER OF SALES  
TAX ETC WITHIN 1 K.M. RANGE.  
3. ALL THE STANDARD CONDITIONS HAVE BEEN SATISFIED.  
4. ALL THE DIMENSIONS ARE IN METERS UNLESS OTHER WISE SPECIFIED.  
5. STORM WATER OF OUR BUILDING WILL NOT DISTURB THE PWD ROAD.  
6. SLAB TYPE CULVERT WILL BE PROVIDED BY US.  
7. LEVEL OF BUILDING KEPT 15 BELOW OR ROAD LEVEL.  
8. WE WILL NOT BEHOLD ANY OAD IN CENTRAL VERGE IN FRONT OF OUR PLOT.  
9. WE WILL PAY THE NECESSARY FEE FOR THE USE OF PWD LAND  
WHENEVER ASKED BY THE AUTHORITIES.

SIGNATURE OF DEVELOPERS

SIGNATURE OF ARCHITECT

DWG. NO.	TCS/PT/2006
DRAWN BY:-	THE CYBER SPACE
	Plot no. 2, 1st floor, Sardar Saini Bazar, C.T. Road, Gurukul, Sahib Road, Tarn Taran, Punjab-147001, India E-mail:- thecyberspace@gmail.com

Stamp and signature of the developer.