

## Protected Forest Land Area Calculation

- A. Forest Area Calculation for Entry
- B. Forest Area Calculation for Exit
- C. Forest Area Calculation for Separator Island

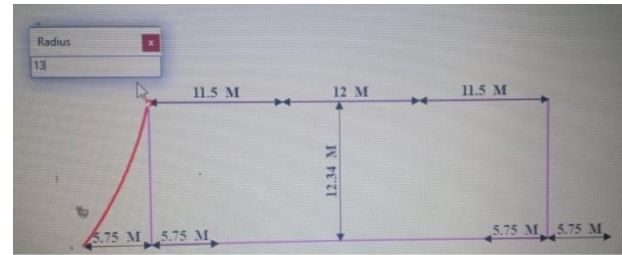

### A. Forest Area Calculation for Entry (A):

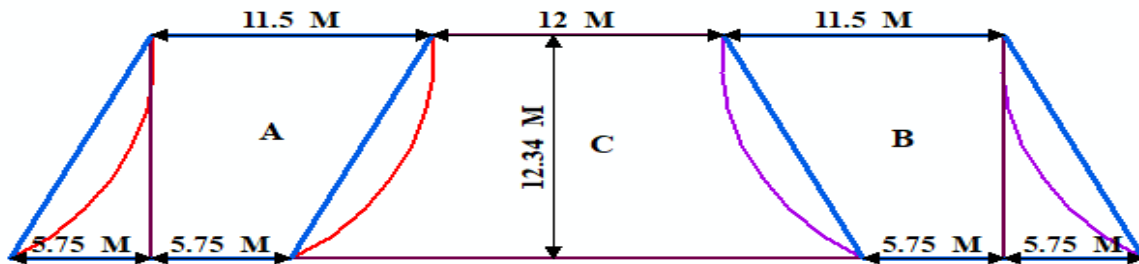

A is a Parallelogram in Shape so Area of Parallelogram is calculated by below mathematical formula

$$\begin{aligned}\text{Area of A} &= \text{Length of Base} * \text{Height Sq M} \\ &= 11.5 * 12.34 \text{ Sq M}\end{aligned}$$

$$\text{Area of A} = 141.91 \text{ Sq. M}$$

### B. Forest Area Calculation for Exit (B):

It is same in shape as A, thus area of Exit must be

$$\text{Area of B} = 141.91 \text{ Sq M}$$

### C. Forest Area Calculation for Separator Island (C)

The Area is Calculated by Arc GIS is shown below

$$\text{Area of C} = 183.55 \text{ Sq M}$$

$$\text{Total Area} = \text{Area of (A)} + \text{Area of (B)} + \text{Area of (C)}$$

$$= 141.91 + 141.91 + 183.55 \text{ Sq M}$$

$$\text{Total Area (Sq.m.)} = 467.37 \text{ Sq M}$$

$$\text{Total Area (Ha)} = 0.046737 \text{ Ha.}$$

$$\text{Total Area (Ha)} = 0.04674 \text{ Ha.}$$

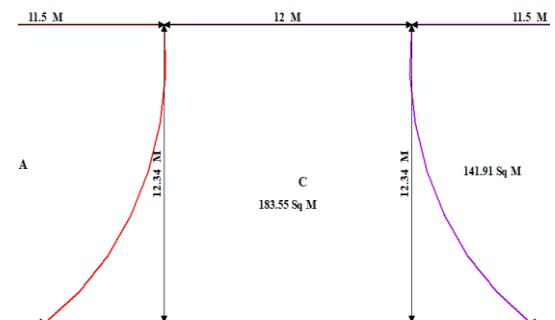

04.01.2021  
कुमार विभाष  
वरिष्ठ प्रबंधक (रिटेल सेल्स)  
इंडियन ऑयल कॉर्पोरेशन लिमिटेड (एम.डी.)  
बरेली मंडल कार्यालय  
35-ए, सिविल लाईन्स, कमला नेहरू मार्ग,  
बरेली-243001 (उ०प्र०)