

**HIMACHAL PRADESH
PUBLIC WORKS DEPARTMENT**

NO.PW-BD/CB/W-11/Forest-2020-21 17895-96

Dated: - 21-12-2022

To

✓ The Divisional Forest Officer,
Seraj Forest Division at Banjar,
Distt. Kullu H.P.

Subject: - Diversion of 1.433 ha. of forest land in favour of HPPWD, Banjar for the construction of Panchveer to Docha via Bion road km 0/0 TO 3/00, within the jurisdiction of Seraj Forest Division, Distt. Kullu, H.P.(Online Proposal no. FP/HP/Road/150698/2021). Re-submission of the proposal after attending the observations thereof.

Reference: - पत्र सं: एफ.सी. /एच.पी.बी. /06 /118 /2022 received on-line dated 23.09.2022.

Sir,

As per the Notd Officer-cum-addl. Pr.CCF (FCA) office पत्र सं: एफ.सी. /एच.पी.बी. /06 /118 /2022 received dated 23.09.2022 on the above subject cited matter. In this regard, it is submitted that the observations raised by Addl. Chief Secretary (Forest) pertaining to this office are being attended as under: -

S. No	Observation Raised	Reply of User Agency
1	Administrative approval is required to be submitted/ uploaded.	Administrative approval is being submitted and uploaded now.
2	On online portal Part II legal status mentioned is Unclassed Forest and Protected Forest. Whereas in documents provided by DFO it has been mentioned DFF and DPF. Legal status DFF may be clarified and needful may be done in this regard.	This observation pertains to your good office.
3	Layout plan needs to be authenticated by the concerned DFO. Further, the layout plan must include a legend and the proper dimensions of each component, such as Carriageway, Paved Shoulder, Earth Filling, Drain, and Protection Work, as well as an area-wise calculation. The revised layout plan may be submitted/ uploaded.	Revised Layout plan duly authenticated by DFO is being Submitted.
4	A large number of trees and saplings are going to be affected in the proposed alignment. Therefore, the State Govt. may explore all the possibilities to reduce the number of trees specially the ecologically important tree species (Cedrus deodara) to be affected. Accordingly revised enumeration list may be provided/ uploaded.	In this regard it is submitted that we have informed earlier also. That utmost care has been taken while finalizing the alignment. And every effort was made to protect the plants/ trees. But the proposed alignment is unavoidable and is serving a large number of populations. Further to add the proposed alignment was considered only after inspecting two other alignments. Only then

		the proposed alignment was considered as it was involving less numbers of trees. Hence alignment cannot be revised.
5	As large number of trees (854 trees and saplings) are going to be affected in the proposal and the location of the proposal being in hilly terrain, accelerated soil erosion during/after Construction of the road will be inevitable. Therefore, State Govt. may provide Soil Moisture Conservation Plan as per recent Guidelines of MoEFCC letter dated 7th June 2022.	<p>In this regard it is intimated that as per the recent guidelines of MoEFCC dated 7th June 2022 wherein (Meeting Held by Forest Advisory Committee held on 11th May, 2022 wherein Committee inter-alia observed that preparation of such plans by the premier / reputed institutes consumes substantial time is resulting into Considerable delay in the process which is ultimately delaying the commencement of different developmental projects. Committee further opined that implementation of mitigating measures should invariably be commenced with the commencement of non-forestry use of forest land and under no circumstances such mitigating measures should be delayed beyond 2 years to ensure commencement of rejuvenation of ecosystem services lost from the forest area allowed for non-forestry use at the Earliest possible time. After detailed deliberations and discussion in the matter, the Committee recommended that a lump sum amount towards the cost of implementation of Wildlife Management Plan and Soil and Moisture Conservation Plan should be charged in cases where preparation of such Plans is likely to take more time as compare to submission of other compliance for obtaining Stage-II approval. Based on the recommendation of the Forest Advisory Committee (FAC) and acceptance of the same by the competent authority of the MoEF&CC, the Central Government provides the following provisions to deal with situations where preparation and finalization of Wildlife Management Plan and Soil and Moisture Conservation Plan is delayed for various reasons not attributable to State/User agency:</p> <p>i. The State Government should submit Wildlife Management Plan, along with detail cost of its implementation into the account of CAMPA along with the Stage-I compliance. However, in cases where it is not possible for the State to submit the compliance due to delay in preparation of such plan, a lump sum quantum of following amount may be realized from the User agency and submitted along with the Stage I Compliance:</p>

		<p>a. 2% of total project cost towards the cost of implementation of the Wildlife Management Plan and/or 0.5% of the project cost towards the cost of implementation of Soil and Moisture Conservation Plan, as the File No.FC-11/43/2021-FC case may be, shall be charged from the user agency and deposited into the account of CAMPA and the same may be intimated to the MoEF&CC for the purpose of obtaining approval under the FC Act, 1980.</p> <p>b. The provisions provided in the WLMP or SMC Plan shall be approved by the competent authority in the State and accordingly, the deficit amount, if any, from the money already realized to the tune of 2% and/or 0.5% of project cost, shall be paid by the user agency, and same shall be deposit in the CAMPA account prior to actual working on the Forest area.) Hence as per the above notification/ File No.FC-11/43/2021- FC dated 7th June 2022. We are hereby submitting the Undertakings to Pay the cost towards the implementation Soil and Moisture Conservation Plan.</p>
6	All the dumping sites have been proposed in forest land. The State Govt. may explore non-forest land for dumping. If necessarily dumping sites are to be proposed in the forest land, the area of forest land involved for dumping must be reduced. Accordingly the proposal may be reviewed and revised. Further, revised enumeration list of trees standing at dumping sites may be provided/ uploaded.	In this context it is submitted that proposed road is in a hilly Terrain and the land holding is very low. But still the local people have donated 0.567 hectare of land for the road. Hence shifting of dumping site to non forest land is not possible. Further as to area of dumping is concerned. It is clear from the Muck Management Plan that 12600 cum of muck produced will be dumped and the dumping capacity has been proposed for 13000 cum. hence the dumping area is justified and the area cannot be reduced.
7	The State Govt. may clarify whether the proposed CA land are notified forest under IFA or a Waste Land under HP Govt. notification, 1952.	This observation pertains to your good office.
8	As per DSS analysis, proposed CA sites in patch 2 is covering 1 ha Moderately Dense Forest. The State Govt. may revise the CA site as per guidelines	The C A Site of Patch No.2 has been revised now. Revised Maps of the C.A Sites are being Submitted.
9	As per DSS analysis the diversion area violated the VDI rule. Therefore Eco-Class VI with Very Dense rates shall be applicable for the NPV calculation. Needful corrections in the NPV bill	This observation pertains to your good office.

	calculation may be done and revised NPV calculation bill may be provided/ uploaded.	
10	Muck Management Plan has been submitted, however the same is required to be authenticated by the concerned DFO. The revised Muck Management Plan may be submitted/ uploaded.	Muck Management Plan duly authenticated by DFO is being submitted now.
11	The FRA certificates have been provided, however the records of meeting at Gram Sabha level Has not been furnished with documents submitted. The same may be provided/ uploaded before Stage II. Undertaking for submission of records of meetings of Gram Sabha before Stage II may be provided.	The remaining FRA certificates will be provided/ uploaded before Stage II. The Undertaking for submission of records of meetings of Gram Sabha before Stage II is being Provided.
12	In Part I, Para K, the status of settlement of rights under the Forest Rights Act, 2006 has been Mentioned as no. However the documents were submitted as additional documents. The Documents are uploaded against appropriate column. Needful in this regards may be done.	Necessary correction in Part I, Para K, have been done now.
13	Noc/Sale deed/Gift deeds for non-forest land acquired Form private individuals are required to be submitted/uploaded.	Noc/ Sale deed/ Gift deeds for non-forest land acquired Form private individuals is being submitted and uploaded now.
14	As per DSS analysis, the proposed DA is 1.433 ha while the calculated area is 2.11 ha. Therefore, Necessary corrections in the KML file may be done.	Necessary corrections in the KML have been made now.

Encl: - As above.

Executive Engineer,
Banjar Division,
HPPWD Banjar.

Copy to the Assistant Engineer, Sub-Division Banjar, HPPWD Banjar, for information and necessary action. He is requested to pursue the matter in aforesaid office under intimation to this

Executive Engineer,
Banjar Division,
HPPWD Banjar.

RK
29/12/22

for 29/12/22

No. 4243
HP Forest Department
Dated Banjar, the 4-1-2023

From:- DFO Seraj

To: CF Kullu.

Subject:- Diversion of 1.433 ha of forest land in favour of HPPWD, Banjar for the construction of Panchveer to Docha via Bion road km 0/0 to 3/00, within the jurisdiction of Seraj Forest Division, Distt. Kullu, HP. (Online Proposal No. FP/HP/Road/150698/2021).

Memo:

Kindly refer to EDS Proposal No. FP/HP/Road/150698/2021 dated 23.09.2022 and reply furnished by User Agency vide letter No PW-BD/CB/WA-II/Forest-2020-21/17895-96 dated 21.12.2022 on the subject cited above.

The point wise reply of EDS dated 23.09.2022 is as under:-

1. Needful has been done by UA and administrative approval has been submitted/uploaded online in part-I. (Copy attached as Annexure-I)
2. Needful has been done, the legal status of forest has been mentioned DFF advertently, but now correction has been made in Part-II and DPF has been mentioned instead of DFF (Copy attached as Annexure-II)
3. Revised Layout plan has been submitted/uploaded by UA in part-I (Copy attached as Annexure-III).
4. User Agency has reported that utmost care has been taken while finalizing the alignment and every effort was made to protect the plants/trees. But the proposed alignment is unavoidable and is serving a large number of populations. Further to add the proposed alignment was considered only after inspecting two other alignment. Only then the proposed alignment was considered as it was involving less numbers of trees. Hence alignment cannot be revised.
5. User Agency has been submitted the undertaking for payment of cost for implementation of soil and moisture conservation plan (Copy attached as Annexure-IV).
6. User Agency reported that proposed road is in a hilly Terrain and the land holding is very low. But still the local people have donated 0.567 ha of land for the road. Hence shifting of dumping site to non forest land is not possible. Further as to area of dumping is concerned. It is clear from the Muck Management Plan that 12600 cum of muck produced will be dumped and the dumping capacity has been proposed for 13000 cum hence the dumping area is justified and the area cannot be reduced.
7. Needful has been done copy of the certificate is attached as Annexure-V.

8. Revised CA site map has been submitted/uploaded in part-II (Copy attached as Annexure-VI)
9. The revised bill of NPV is attached as Annexure-VII.
10. Muck Management Plan has been uploaded by the user agency in online part-I (copy attached as Annexure-VIII).
11. User Agency informed that the remaining FRA certificates will be provided/uploaded before Stage-II approval. The Undertaking of complete FRA certificate is attached as Annexure-IX.
12. Needful has been done by the User Agency in online Part-I of Para k.
13. User Agency has been submitted/uploaded the NoC/Sale deed/Gift deeds for non-forest land in online part-I (Copy attached as Annexure-X).
14. The revised Kml file of Diverted area has been uploaded by User Agency in Online Part-I.

So it is, therefore, requested that necessary approval under Forest Conservation Act, 1980 may kindly be obtained from the competent authority and conveyed to this office please.

Encl : As above.

Divisional Forest Officer,
Seraj Forest Division at, Banjar.

संख्या 10 लोक निर्माण-मंडक, पूल तथा भवन

Copy attached
the part-I
be

कार्य कोड	कार्य का नाम	वास्तविक व्यय अनुमानित व्यय 31 मार्च-2021-तक	स्वीकृत बजट 2021-2022	संशोधित अनुमान 2021-2022	बजट अनुमान 2022-2023
2034-04-337-02					मंडी जोर
2021-307-1551	देओरी से बगलाडी सड़क का निर्माण	0	1000	1000	50000
2021-307-1550	बगलाडी से दाडी सड़क का निर्माण	0	1000	1000	50000
2021-307-1549	हामपि से आसी पुल का निर्माण	0	0	0	50000
2021-307-1548	पुनवी से फलों सायासोतला फाट परगाना सड़क का निर्माण	0	1000	1000	50000
2021-307-1547	भरगोरी से कल्याणपुर सड़क का निर्माण	0	1000	1000	50000
2021-307-1546	कासुपुल से मिहडा सड़क का निर्माण	0	1000	1000	50000
2021-307-1545	सैरासौर सड़क से कोपी सड़क का निर्माण	0	1000	1000	50000
2021-307-1544	आनशर सड़क से कोपी सड़क का निर्माण	0	1000	1000	50000
2021-307-1543	आनशर सनाहरा से बलाडी सड़क का निर्माण	0	1000	1000	50000
2021-307-1542	सरोहीधर से कल्याणपुर सड़क का निर्माण	0	1000	1000	50000
2021-307-1541	बटाह से सड़क सड़क का निर्माण	0	1000	1000	50000
2021-307-1540	देओरी से शरीरुल कल्याणपुर सड़क का निर्माण	0	1000	1000	50000
2021-307-1539	बाहरी से सैरा सड़क का निर्माण	0	1000	1000	50000
2021-307-1538	भुवनासेल से सनाह सड़क का निर्माण	0	1000	1000	50000
2021-307-1537	चीलवाली से सनाह सड़क का निर्माण	0	1000	1000	50000
2021-307-1536	भाटवा से प्याथानी बाया टीक सड़क का निर्माण	0	1000	1000	50000
2021-307-1535	बेहल बंकी से उपेरा प्याथानी सड़क का निर्माण	0	1000	1000	50000
2021-307-1534	बगमिधुधर से दुमबुकी हवाई सड़क का निर्माण	0	1000	1000	50000
2021-307-1533	शसवार सड़क से जगरी डिपरीधर सड़क का निर्माण	0	1000	1000	50000
2021-307-1532	बटावारी सड़क से भुन पाथी थाटधर सड़क का निर्माण	0	1000	1000	50000
2021-307-1531	हुली सड़क से भुन सड़क का निर्माण	0	1000	1000	50000
2021-307-1530	सगला से फरारी सड़क का निर्माण	0	1000	1000	50000
2021-307-1529	दीन से धुन सड़क का निर्माण	0	1000	1000	50000
2021-307-1528	शंकु बीर से दोचा बाया पियोन बाह सड़क का निर्माण	0	1000	1000	50000
2021-307-1527	पोखरीधर से साधा बाया पन्ना चलोमे बलाड शुट बलाडी पाचा सड़क का निर्माण	0	1000	1000	50000
2021-307-1526	चिपनी से धारा थलिया सड़क का निर्माण	0	1000	1000	50000
2021-307-1525	साला धार से बगारी सड़क का निर्माण	0	1000	1000	50000
2021-307-1524	बिलाडी से बरा हिला ग्राम पंचायत देओरीधर सड़क का निर्माण	0	1000	1000	50000
2021-307-1523	थिमा से वेडा ग्रामपंचायत बाह सड़क का निर्माण	0	1000	1000	50000
2021-307-1522	निंदर से सनियार लोहा सड़क का निर्माण	0	1000	1000	50000
2021-307-1521	बिलाडी से थलिया ग्राम पंचायत बलाड सड़क का निर्माण	0	1000	1000	50000

Executive Engineer
Banjar Division
H.P.W.D. Banjar

PART-II

(To be filled by the concerned Deputy Conservator of Forests)

7	Location of the Project/ Scheme	
i)	State/Union Territory	Himachal Pradesh
ii)	District	Kullu
iii)	Forest Division	Seraj at Banjar
iv)	Area of Forest Land Proposed for diversion (in ha.)	1.433 Ha. For C/oPanchveer to Dhocha via Bion road.
v)	Legal Status of Forest	Tilokpur-III (Unclassed Forest), Kruhadhar-DPF & Raghunai-DPF (Demarcated Protected Forest).
vi)	Destiny of vegetation	0.73
vii)	Species wise (scientific names) and diameter class wise enumeration of trees (to be enclosed) in case of irrigation/Hydel projects enumeration at FRL-I meter also to be enclosed.	As per list Attached Page...49
viii)	Brief on vulnerability of the forest area to erosion.	Area is not vulnerable to soil erosion.
ix)	Approximate distance of proposed site for diversion from boundary of forest.	0.1 KM and road passes through private land and forest land.
x)	Whether forms part of national park, wildlife sanctuary, biosphere, reserve, tiger reserve, elephant corridor etc (it so the detail of the area and comments of the Chief Wildlife warden to be annexed)	No
xi)	Whether any rare/endangered/unique species to flora and fauna found in the area? If so detail thereof.	No
xii)	Whether any protected archaeological/heritage site/ defence establishment or any other important monument is located in the area? If so the detail thereof with NOC from competent authority if required.	No
8	Whether the requirement of forest land as proposed by the user agency in col.2 of Part-I is unavoidable and barest minimum for the project? If no recommended area item wise with detail of alternatives examined.	The requirement of forest land is unavoidable and barest minimum.
9	Whether any work in violation of the act has been carried out? if yes, detail of the same including period of work done, action taken on erring officials, whether work in violation is still in progress?	No
10	Detail of compensatory afforestation scheme i) Detail of non-forest area/degraded forest area identified for compensatory	Attached Page—52 to 58

	afforestation, its distance from adjoining forest, number of patches and size of each patch.	
	ii) Map showing non-forest/degraded forest area identified for compensatory afforestation and adjoining forest boundaries.	Attached Page--58
	iii) Detailed compensatory afforestation and adjoining forest boundaries.	Attached Page
	iv) Total financial outlay for compensatory	863538
	v) Certificate from competent authority regarding suitability of compensatory afforestation and from management point of view (to be signed by the concerned Deputy Conservator of Forest)	
11	Site inspection report of the DCF (to be Enclosed) especially high lighting facts asked in Col. 7 (ixxii) 8 and 9 above.	Attached Page --50
12	Division/District Profile	Seraj Forest Division Banjar
	i) Geographical area of the district	5503 Sqkms
	ii) Forest area of the district	270.17 Sqkms
	iii) Total Forest area diverted since 1980 on.	299.3983 ha (45 cases)
	iv) Forest land including penal compensatory afforestation	592.27 ha
	v) Non Forest land	Nil
	vi) Progress of compensatory as on dated 31.12.22on.	592.27
	vii) Forest land	
	viii) Non Forest land	Nil
13	Specific recommendations of the DCF for acceptance of otherwise of the proposal with reasons.	Recommended

Date Banjor
Place 24/01/2023

Divisional Forest Officer
Seraj Forest Division at Banjar.

R. To DHOCHA VIA BION ROAD K.M 0/0 TO 3/0

AN SHOWING THE STATUS OF LAND:

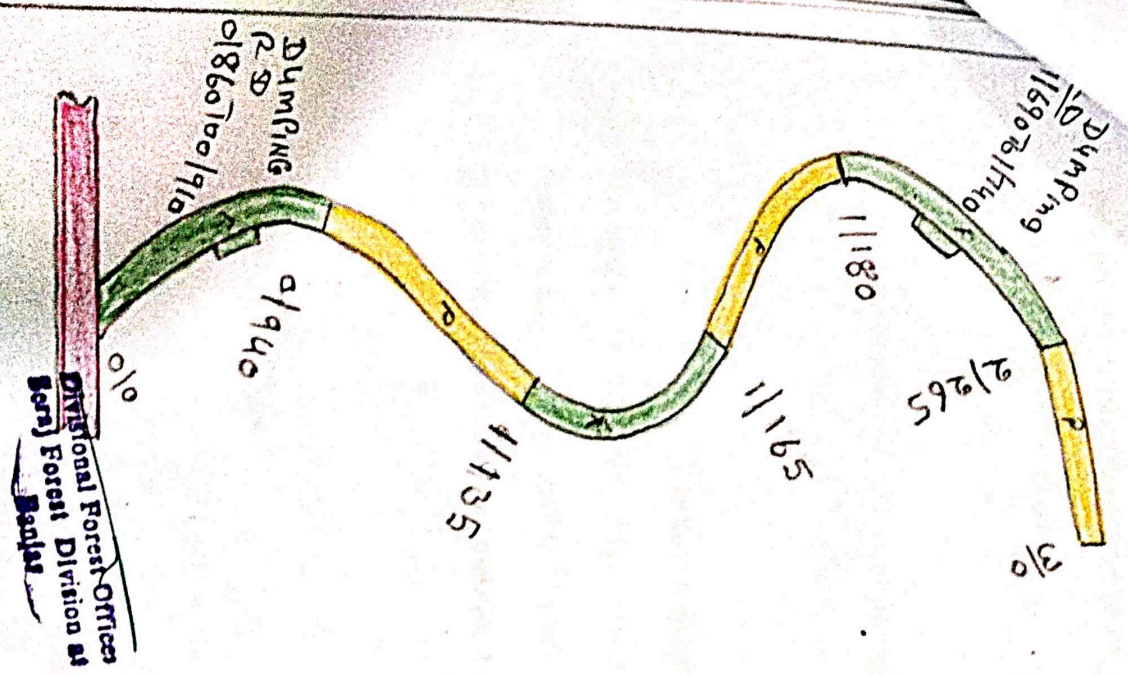

TYPICAL X-SECTION OF ROAD

REFERENCES	
LENGTH OF ROAD	3 K.M
AVERAGE WIDTH ROAD	6 m
LENGTH OF FOREST LAND	20.55 M
AREA OF FOREST LAND	1.2330 HECT
LENGTH OF PRIVATE LAND	945 M
AREA OF PRIVATE LAND	0.5610 HECT
DUMPING AREA	0.2000 HECT
TOTAL FOREST & AREA	1.4330 HECT

LEGEND	
PRIVATE LAND SHOWN	—
FOREST LAND SHOWN	—
EXISTING ROAD SHOWN	—

CARRAGEWAY	—
SHOULDER	—
DRAIN	—
PARAPET	—
SLOPE	—

Assistant Engineer
Banjar Sub-Division,
H.P.P.W.D. Banjar

Executive Engineer
Banjar Division
H.P.P.W.D. Banjar

Divisional Forest Officer
Banjar
Office

Amesbury III

13 DEC 7
Memo to
H.P. Star
Duty

1 Title of the Project :- C/O PANCHVEER TO DOCHA VIA BION ROAD KM 0/0
TO 3/00

File No: FP/HP/ROAD/150698/2021

Date of Proposal: 31-12-2020

**UNDERTAKING FOR PAYMENT OF COST FOR IMPLEMENTATION OF
SOIL AND MOISTURE CONSERVATION PLAN**

I, Executive Engineer, Banjar Division, HPPWD Banjar do hereby,
undertake to pay the cost towards the implementation of Soil and Moisture
Conservation Plan as decided by the recent Guidelines of MoEFCC dated 07-06-2022
in lieu of the forest area diverted for 1.433 hect.

Place: - Banjar
Date: - 13-12-2020

(Signature of User Agency)
Executive Engineer
Official Seal Banjar Division
H.P.W.D. Banjar

Countersigned by:-

Divisional Forest Officer
.....
Divisional Forest Officer
Office Banjar Division
Banjar

Divisional Forest Officer
Divisional Forest Officer
Forest Division
Office Seal, Banjar

प्रारूप

परियोजना ऑनलाइन संख्या	FP/HP/Road/150698/2021
परियोजना का नाम एवं जनपद	पांचवीर से ढोचा सड़क का निर्माण
परियोजना का क्षेत्रफल (है.)	1.433
प्रयोक्ता एजेंसी का नाम व पता	अधिशापी अभियंता, लोक निर्माण विभाग बंजार, जिला कुल्लू ।
वन मण्डल का नाम	सराज

प्रमाणित किया जाता है कि क्षतिपूरक वृक्षारोपण हेतु चयनित वन भूमि रघुनाल (1.066 है.) हिमाचल प्रदेश सरकार की अधिसूचना 1952 के अन्तर्गत Notified Forest है तथा क्षतिपूरक वृक्षारोपण हेतु चयनित वन भूमि शिकारी-III (1.80 है.) हिमाचल प्रदेश सरकार की अधिसूचना 1952 के अन्तर्गत Waste Land है ।

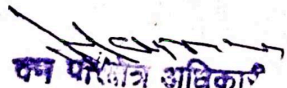
वन परिक्षेत्र अधिकारी
 वन परिक्षेत्र अधिकारी
 वन परिक्षेत्र बंजार

**Divisional Forest Officer
 Saraj Forest Division at
 Banjar**

USE MAP OF REVISED PROPOSED C.A SITE FOR CIO PANCHVEER TO DOCHA ROAD KM 010 TO 3100

Annexure IV

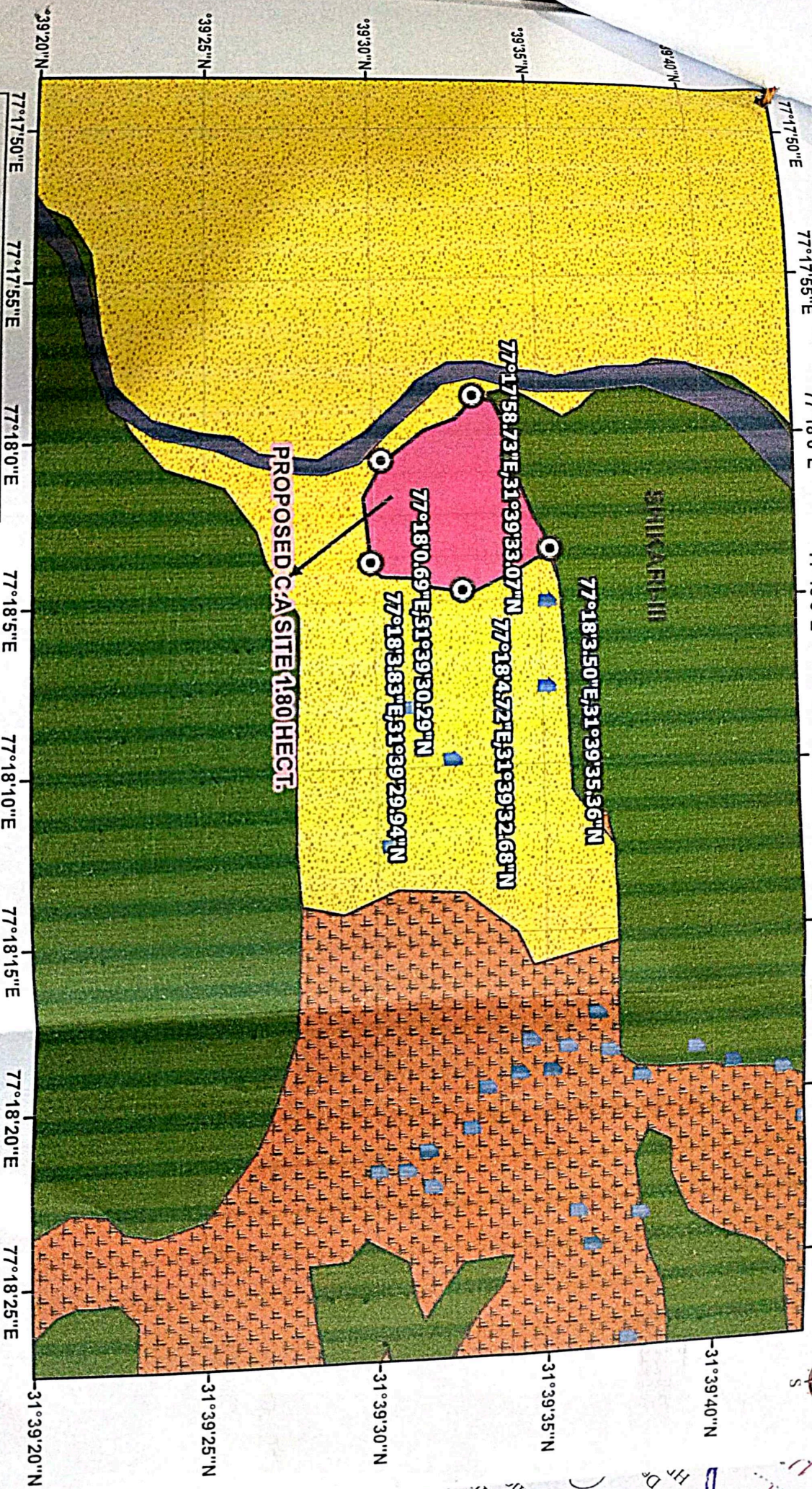

Legend

- Settlement
- Proposed C.A site
- Nallah
- Open Scrub Forest
- Dense Forest
- Agriculture Land

Site Information:

Additional Forest Office Beat : Tandi
Banjar Forest Division Block : Banjar
Range : Banjar
Forest : Shikari-III
Compartment- Nil

Prepared By:

Genius Geo Solutions
#62/2, Purani Mandi
Tehsil Sadar, Distt Mandi(H.P)
Mob: 7807377126

Annexure - VI



Full Title of the Project:-

Diversion of 1.433 ha of forest land in favour of Executive Engineer HPPWD BanjarKullu (H.P.) for the construction of Panchveer to Dhocha via Bion road within the jurisdiction of Seraj Forest Division, Distt. Kullu, Himachal Pradesh.

File No:FP/HP/road/150693/2021

Date of Proposal

CHECK LIST SERIAL NUMBER-18

"SCHEME FOR COMPENSATORY AFFORESTATION"

Detailed scheme of CA be carried out in lieu of 1.433 ha of Forest area to be diverted for the C/O Panchveer to Dhocha via Bion road, In Kullu Distt. H.P.

1. Details of degraded forest land/non-forest land:-

District Kullu village Ghat/Shikari Tehsil: Banjar

Name of Forest Division:-Seraj, Range:- Banjar

Block/Compartment/Survey No.: -Banjar/Shikari-III/53E/06 to be Afforested 1.80 ha.

(Land Bank)

2. Description of Area:-

- i. Whether the site selected for Compensatory Afforestation is a land Bank or Not:-Land Bank.
- ii. If the CA site is other than the land bank, reasons be given:- NA
- iii. In case of non-forest area identified of CA, then what is the distance of CA site from the adjoining Forest boundary:- N.A.
- iv. Soil type:- Clayey Loam.
- i. Topography:-
- ii. Hilly/undulating/Plain= Hilly-Undulating
- iii. Slope: Steep/Medium/Gentle = Steep to medium
- iv. Whether the area is bearing any root stock of vegetation: Only few bush growths

3. Plantation Model:-

Copy of the approved Compensatory Afforestation Scheme/Model showing Component-wise physical and financial break up to be enclosed.

4. Schedule of Plantation Programme:-

Detail of year wise break-up requirements of funds is as under:-

Abstract	Unit	Area	Rate/ha.	Total Amount
New Plantation	Ha	1.8	94890	170802
1st Year Maintenance	Ha	1.8	19200	34560
2nd Year Maintenance	Ha	1.8	13370	24066
3rd Year Maintenance	Ha	1.8	7550	13590
4th Year Maintenance	Ha	1.8	7550	13590
5th Year Maintenance	Ha	1.8	7550	13590
6th Year Maintenance	Ha	1.8	7550	13590
7th Year Maintenance	Ha	1.8	7550	13590
8th Year Maintenance	Ha	1.8	7550	13590
9th Year Maintenance	Ha	1.8	7550	13590
10th Year Maintenance	Ha	1.8	7550	13590
TOTAL (1) COST of Compensatory afforestation Area 5 ha =			187860	338148
Cost Escalation @ 30%				101444
Add Contingencies @ 5% of total Cost.				21980
Total Cost (1+2) =				461571
Add Departmental Charges @ 17.5% on total cost (1+2).				80775
Grand Total				542347
Or Say				542347

1. Technical Detail:-

Technical details of Compensatory afforestation Scheme are as follows:-

a	General Details	Area for Compensatory Afforestation in Shikari Beat, Banjar Block, Banjar Range in, Shikari-III to be Afforested 1.80 Ha.
b	Spacing	3mx3m
c	Species	Site specific species OBL, Ban Oak, Deodar, Fir/Spruce etc.
d	Plantation method	By pits 60*60*60 cm
e	Protection (Fencing watch man, People's participation etc.)	Through people participation, Forest Guard etc, and fencing 5 Stand B/Wire interlacing with thorny bushes.
f	Proposed Monitoring Mechanism: Manually:	Proper inspection of the area by field Staff & Officers of the Department as per mandatory Field inspection protocol
g	Any other information:	NA

Place : Banjar

Dated:- 24/01/2023

Divisional Forest Officer
Seraj Forest Division
 Seraj Forest Division, Banjar

The Compensatory Afforestation Scheme for Planting of plants for the Diversion of 1.433 ha of forest land in favour of Executive Engineer, HPPWD Banjar for the construction of Panchveer to Dohocha via Bion road within the jurisdiction of Seraj Forest Division, District Kullu, H.P. (CA site Shikari-III = 1.80 ha)

Sr. No.	Particulars of work	Unit	Quantity	Rate per unit at	Norm at the wage	Amount
A	FENCING COST					
1	Survey and demarcation of plantation area	ha	1	101	202.00	202.00
2	Preparation/Purchase of RCC fence posts @ rate of Rs. 358 per post	No	60	210	358.00	21480.00
3	Carriage of RCC Fence post upto 165cm long over a distance of 2 km uphill/download	Km/ No	60	33.5	67.00	8040.00
4	Preparation/Digging of holes 20-30cm dia 50 cm size	No	60	9.06	18.12	1087.20
5	Fixing of RCC fence Post i/c strutting	No.	60	7.16	14.32	859.20
6	Carriage of B/Wire over a distance of 2 Km uphill/download	KM/ Qtl	0.85	73.65	147.30	250.41
7	Stretching & Fixing of Barbed Wire in 4 strands	Rmt	720	4.8	9.60	6912.00
8	Interlacing of Thorny Bushes along the Fence	Rmt	180	4.09	8.18	1472.40
9	Cost of Barbed Wire	Qtl	0.9	6510.00		5859.00
	Total Fencing (A) =					46162.21
	Or Say					46170
B	PLANTING COST					
1	Bush Cutting in Strips (3mx3m)	Ha	1	1192.8	2385.60	2385.60
2	Digging of pits 45*45*45* cm size	No	1100	9.54	19.08	20988.00
3	Filling of pits 45*45*45* cm.	No	1100	2.72	5.44	5984.00
4	Carriage of Plants in P Bags over distance 2 Km uphill/downhill	KM/ No	1100	1.9	3.80	8360.00
5	Planting of Plants Raised in P/Bags	No	1100	2.18	4.36	4796.00
6	Construction of inspection Path 60 cm wide	Rmt	100	11	22.00	2200.00
7	Cost of Sign Board Carriage & Fixing	No	1	15	4000.00	4000.00
	Total (B)					48713.60
	Or Say					48720.00
	Grand Total (Fencing+Planting) A+B=					94890.00
C	MAINTENANCE COST					
a	1ST YEAR MAINTENANCE - 30% MORTALITY					
1	Re-digging of pits 45*45*45* cm	Nos	330	4.77	9.54	3148.20
2	Filling of pits 45*45*45* cm	Nos	330	2.72	5.44	1795.20
3	Carriage of poly plants from nursery to nearest road head near plantation site in motor	Nos	330	15	15	1500.00
4	Carriage of Plants in P Bags over distance 2 km uphill/downhill	Nos	330	1.9	3.80	2508.00
5	Planting of Plants raised in P/Bags	Nos	330	2.18	4.36	1438.80
6	Cost of Normal Plants raised in P-bag	Nos	330	26	26.00	8580.00
7	Repair of Fencing	Rmt	60	1.8	3.60	216.00
	Total 1st Year Maintenance					19186.20
	Or Say					19200
b	2ND YEAR MAINTENANCE - 20% MORTALITY					
1	Re-digging of pits 45*45*45* cm	Nos	220	4.77	9.54	2098.80
2	Filling of pits 45*45*45* cm	Nos	220	2.72	5.44	1196.80
3	Carriage of poly plants from nursery to nearest	Nos	220	15	15	1500.00
4	Carriage of Plants in P Bags over distance 2 km uphill/downhill	Nos	220	1.9	3.80	1672.00
5	Planting of Plants raised in P/Bags	Nos	220	2.18	4.36	959.20
6	Cost of Normal Plants raised in P-bag	Nos	220	26	26.00	5720.00
7	Repair of Fencing	Rmt	60	1.8	3.60	216.00
	Total 2nd Year Maintenance					13362.80
	Or Say					13370
c	3RD YEAR MAINTENANCE - 10% MORTALITY					
1	Re-digging of pits 45*45*45* cm	Nos	110	4.77	9.54	1049.40
2	Filling of pits 45*45*45* cm	Nos	110	2.72	5.44	598.40

	3	Carriage of poly plants from nursery to nearest	Nos	110	LS	LS	1500.00
	4	Carriage of Plants in P Bags over distance 2 km huhill/downhill	Nos	110	1.9	3.80	836.00
	5	Planting of Plants raised in P/Bags	Nos	110	2.18	4.36	479.60
	6	Cost of Normal Plants raised in P bag	Nos	110	26	26.00	2860.00
	7	Repair of Fencing	Rmt	60	1.8	3.60	216.00
		Total 3st Year Maintenance					7539.40
		Or Say					7550
d		4th YEAR MAINTENANCE	L/s				7550.00
e		5th YEAR MAINTENANCE	L/s				7550.00
f		6th YEAR MAINTENANCE	L/s				7550.00
i		7th YEAR MAINTENANCE	L/s				7550.00
j		8th YEAR MAINTENANCE	L/s				7550.00
k		9th YEAR MAINTENANCE	L/s				7550.00
l		10th YEAR MAINTENANCE	L/s				7550.00
		Grand Total--Maintenance (C) =					92970.00
D		Grand Total -New+Maintenance (A+B+C) =					187860.00
		ABSTRACT	Unit	Area (Ha)	Rate /ha	Total Amount	
	1	New Plantation	Ha	1.8	94890	170802	
		1st Year Maintenance	Ha	1.8	19200	34560	
		2nd Year Maintenance	Ha	1.8	13370	24066	
		3rd Year Maintenance	Ha	1.8	7550	13590	
		4th Year Maintenance	Ha	1.8	7550	13590	
		5th Year Maintenance	Ha	1.8	7550	13590	
		6th Year Maintenance	Ha	1.8	7550	13590	
		7th Year Maintenance	Ha	1.8	7550	13590	
		8th Year Maintenance	Ha	1.8	7550	13590	
		9th Year Maintenance	Ha	1.8	7550	13590	
		10th Year Maintenance	Ha	1.8	7550	13590	
		TOTAL (1) COST of Compensatory afforestation			187860	338148	CAMPA
		Cost Escalation @ 30%				101444	
						439592	
	2	Add Contingencies @ 5% of total Cost.				21980	CAMPA
		Total Cost (1+2) =				461572	
	3	Add Departmental Charges @ 17.5% on total				80775	Treasury
		Grand Total				542347	
		Or Say				542347	

Divisional Forest Officer
Boraj Forest Division at
Banjar

Full Title of the Project:- *Diversion of 1.433 ha of forest land in favour of Executive Engineer HPPWD BanjarKullu (H.P.) for the construction of Panchveer to Dhocha via Bion road within the jurisdiction of Seraj Forest Division, Distt. Kullu, Himachal Pradesh.*

File No:FP/HP/road/150698/2021

Date of Proposal

CHECK LIST SERIAL NUMBER-18

"SCHEME FOR COMPENSATORY AFFORESTATION"

Detailed scheme of CA be carried out in lieu of 1.433 ha of Forest area to be diverted for the C/O Panchveer to Dhocha via Bion road, In Kullu Distt. H.P.

1. Details of degraded forest land/non-forest land:-

District Kullu village Bion (Ragunaal) Tehsil: Banjar

Name of Forest Division:-Seraj, Range:- Banjar

Block/Compartment/Survey No.:-Banjar/Ragunaal/53E/06 to be Afforested 1.066 ha.
(Land Bank)

2. Description of Area:-

- i. Whether the site selected for Compensatory Afforestation is a land Bank or Not:-Land Bank.
- ii. If the CA site is other than the land bank, reasons be given:- NA
- iii. In case of non-forest area identified of CA, then what is the distance of CA site from the adjoining Forest boundary:- N.A.
- iv. Soil type:- Clayey Loam,
- v. Topography:-
- vi. Hilly/undulating/Plain= Hilly-Undulating
- vii. Slope: Steep/Medium/Gentle = Steep to medium
- viii. Whether the area is bearing any root stock of vegetation:Only few bush growths

3. Plantation Model:-

Copy of the approved Compensatory Afforestation Scheme/Model showing Component-wise physical and financial break up to be enclosed.

4. Schedule of Plantation Programme:-

Detail of year wise break-up requirements of funds is as under:-

	ABSTRACT	Unit	Area (Ha)	Rate /ha	Total Amount
1	New Plantation	Ha	1.066	94890	101153
	1st Year Maintenance	Ha	1.066	19200	20467
	2nd Year Maintenance	Ha	1.066	13370	14252
	3rd Year Maintenance	Ha	1.066	7550	8048
	4th Year Maintenance	Ha	1.066	7550	8048
	5th Year Maintenance	Ha	1.066	7550	8048
	6th Year Maintenance	Ha	1.066	7550	8048
	7th Year Maintenance	Ha	1.066	7550	8048
	8th Year Maintenance	Ha	1.066	7550	8048
	9th Year Maintenance	Ha	1.066	7550	8048
	10th Year Maintenance	Ha	1.066	7550	8048
	TOTAL (1) COST of Compensatory afforestation Area 1.066 ha =			187860	200259
	Cost Escalation @ 30%				60078
	Total				260337
2	Add Contingencies @ 5% of total Cost.				13017
	Total Cost (1+2) =				273354
3	Add Departmental Charges @ 17.5% on total cost (1+2).				47837
	Grand Total				321191
	Or Say				321191

5. Technical Detail:-

Technical details of Compensatory afforestation Scheme are as follows:-

a	General Details	Area for Compensatory Afforestation in Shikari Beat, Banjar Block, Banjar Range in, Ragunaal to be Afforested 1.066 Ha.
b	Spacing	3mx3m
c	Species	Site specific species OBL, Ban Oak, Deodar, Fir/Spruce etc.
d	Plantation method	By pits 60*60*60 cm
e	Protection (Fencing watch man, People's participation etc.)	Through people participation, Forest Guard etc, and fencing 5 Stand B/Wire interlacing with thorny bushes.
f	Proposed Monitoring Mechanism; Manually:	Proper inspection of the area by field Staff & Officers of the Department as per mandatory Field inspection protocol
g	Any other information:	NA

Place : Banjar

Dated:- 24/01/2023

Divisional Forest Officer
Seraj Forest Division
Banjar

The Compensatory Afforestation Scheme for Planting of plants for the Diversion of 1.433 ha of forest land in favour of Executive Engineer, HPPWD Banjar for the construction of Panchveer to Dohocha via Bion road within the jurisdiction of Seraj Forest Division, District Kullu, H.P. (CA site Ragunaal= 1.066 ha)

	Sr. No.	Particulars of work	Unit	Quantity	Rate per unit at	Norm at the wage	Amount
A FENCING COST							
	1	Survey and demarcation of plantation area	ha	1	101	202.00	202.00
	2	Preparation/Purchase of RCC fence posts @ rate of Rs. 358 per cost	No	60	358.00	21480.00	
	3	Carriage of RCC Fence post upto 16/16 cm long over a distance of 2 km uphill/downhill	Km/ No	60	33.5	67.00	8040.00
	4	Preparation/Digging of holes 20/30cm dia 50 cm size	No	60	9.06	18.12	1087.20
	5	Fixing of RCC fence Post i/c strutting	No.	60	7.16	14.32	859.20
	6	Carriage of B/Wire over a distance of 2 Km uphill/downhill	KM/ Qtl	0.85	73.65	147.30	250.41
	7	Stretching & Fixing of Barbed Wire in 4 strands	Rmt	720	4.8	9.60	6912.00
	8	Interlacing of Thorny Bushes along the Fence	Rmt	180	4.09	8.18	1472.40
	9	Cost of Barbed Wire	Qtl	0.9	6510	6510.00	5859.00
		Total -Fencing (A) =					46162.21
		Or Say					46170
B PLANTING COST							
	1	Bush Cutting in Strips (3mx3m)	Ha	1	1192.8	2385.60	2385.60
	2	Digging of pits 45*45*45* cm size	No	1100	9.54	19.08	20988.00
	3	Filling of pits 45*45*45* cm.	No	1100	2.72	5.44	5984.00
	4	Carriage of Plants in P Bags over distance 2 km uphill/downhill	KM/ No	1100	1.9	3.80	8360.00
	5	Planting of Plants Raised in P/Bags	No	1100	2.18	4.36	4796.00
	6	Construction of Inspection Path 10 cm wide	Rmt	100	11	22.00	2200.00
	7	Cost of Sign Board Carriage & Fixing	No	1	15	4000.00	4000.00
		Total (B)					48713.60
		Or Say					48720.00
		Grand Total [Fencing+Planting] A+B=					94890.00
C MAINTENANCE COST							
a 1ST YEAR MAINTENANCE - 30% MORTALITY							
	1	Re-digging of pits 45*45*45* cm	Nos	330	4.77	9.54	3148.20
	2	Filling of pits 45*45*45* cm.	Nos	330	2.72	5.44	1795.20
	3	Carriage of poly plants from nursery to nearest road head near plantation site in motor	Nos	330	15	15	1500.00
	4	Carriage of Plants in P Bags over distance 2 km uphill/downhill	Nos	330	1.9	3.80	2508.00
	5	Planting of Plants raised in P/Bags	Nos	330	2.18	4.36	1438.80
	6	Cost of Normal Plants raised in P-bag	Nos	330	26	26.00	8580.00
	7	Repair of Fencing	Rmt	60	1.8	3.60	216.00
		Total 1st Year Maintenance					19186.20
		Or Say					19200
b 2nd YEAR MAINTENANCE -20% MORTALITY							
	1	Re-digging of pits 45*45*45* cm	Nos	220	4.77	9.54	2098.80
	2	Filling of pits 45*45*45* cm.	Nos	220	2.72	5.44	1196.80
	3	Carriage of poly plants from nursery to nearest	Nos	220	15	15	1500.00
	4	Carriage of Plants in P Bags over distance 2 km uphill/downhill	Nos	220	1.9	3.80	1672.00
	5	Planting of Plants raised in P/Bags	Nos	220	2.18	4.36	959.20
	6	Cost of Normal Plants raised in P-bag	Nos	220	26	26.00	5720.00
	7	Repair of Fencing	Rmt	60	1.8	3.60	216.00
		Total 2nd Year Maintenance					13362.80
		Or Say					13370
c 3rd YEAR MAINTENANCE -10% MORTALITY							
	1	Re-digging of pits 45*45*45* cm	Nos	110	4.77	9.54	1049.40
	2	Filling of pits 45*45*45* cm.	Nos	110	2.72	5.44	598.40

	3	Carriage of poly plants from nursery to nearest	Nos	110	LS	LS	1500.00
	4	Carriage of Plants in P Bags over distance 2 km huhill/downhill	Nos	110	1.9	3.80	836.00
	5	Planting of Plants raised in P/Bags	Nos	110	2.18	4.36	479.60
	6	Cost of Normal Plants raised in P-bag	Nos	110	26	26.00	2860.00
	7	Repair of Fencing	Rmt	60	1.8	3.60	216.00
		Total 3st Year Maintenance					7539.40
		Or Say					7550
d		4th YEAR MAINTENANCE	L/s				7550.00
e		5th YEAR MAINTENANCE	L/s				7550.00
f		6th YEAR MAINTENANCE	L/s				7550.00
i		7th YEAR MAINTENANCE	L/s				7550.00
j		8th YEAR MAINTENANCE	L/s				7550.00
k		9th YEAR MAINTENANCE	L/s				7550.00
l		10th YEAR MAINTENANCE	L/s				7550.00
		Grand Total--Maintenance (C) =					92970.00
D		Grand Total -New+Maintenance (A+B+C) =					187860.00
		ABSTRACT	Unit	Area (Ha)	Rate /ha	Total Amount	
	1	New Plantation	Ha	1.066	94890	101153	
		1st Year Maintenance	Ha	1.066	19200	20467	
		2nd Year Maintenance	Ha	1.066	13370	14252	
		3rd Year Maintenance	Ha	1.066	7550	8048	
		4th Year Maintenance	Ha	1.066	7550	8048	
		5th Year Maintenance	Ha	1.066	7550	8048	
		6th Year Maintenance	Ha	1.066	7550	8048	
		7th Year Maintenance	Ha	1.066	7550	8048	
		8th Year Maintenance	Ha	1.066	7550	8048	
		9th Year Maintenance	Ha	1.066	7550	8048	
		10th Year Maintenance	Ha	1.066	7550	8048	
		TOTAL (1) COST of Compensatory afforestation			187860	200259	CAMPA
		Cost Escalation @ 30%				60078	
						260337	
	2	Add Contingencies @ 5% of total Cost.				13017	CAMPA
		Total Cost (1+2) =				273354	
	3	Add Departmental Charges @ 17.5% on total				47837	Treasury
		Grand Total				321191	
		Or Say				321191	

Divisional Forest Officer,
Seraj Forest Division at Banjar
Banjar

NPV Bill

Diversion of 1.433 ha of Forest land for the construction of road from Panchveer to Dhocha via Bion 0/00 to 3/00 km in Kullu District, in the jurisdiction of Banjar Forest Range, Seraj Forest Division Distt. Kullu (H.P.).

Sr. No.	Particular	Qty.	Rate	Amount
1.	NPV of Eco-Value Class VI for Very Dense Forest as per guidelines of Hon'ble Supreme Court of India vide order dated 28.3.2008.	1.433/-	15,16,230	21,72,757/-
			Or Say	21,72,760/-



 Divisional Forest Officer
 Banjar Forest Division
 Seraj Forest Division at Banjar.

MUCK MANAGEMENT PLAN (MMP)

1	Total quantity of muck being produced	27000.00	Cum
2	Deduction of useful stone as required under the clause of agreement to be executed by the contractor and Executive Engineer of project.	4500.00	Cum
3	Net balance quantity of debries/muck (1-2) (A)	22500.00	Cum A
4	Quantity available on site with swell factor @ 40% (1.40x A)	31500.00	Cum B
5	Material/muck used in the project:-		
	(i) Deduction for material required for the construction of dumping place in dry masonry/edge wall @ 5% of B	1575.00	Cum
	(ii) Less material/muck required for levelling of proposed road for the construction @ 15% of B	4725.00	Cum
	(iii) Less material/muck required for the construction of proposed road on the analogy of half cutting and half filling @ 40% of B	12600.00	Cum
	Total:- 5(i)+(ii)+(iii)	18900.00	Cum C
6	Net Material/Muck to be dumped in dumping site (B-C)	12600.00	Cum D
7	Proposed dumping Sites:- Material/Muck left at the site which required carriage for the proper dumping at the recognised site as per instructions of Forest and environment Ministry reinforced by the various judgments of the Apex Court/Govt of India		

DUMPING CAPACITY PLAN

Sr.No.	Dumping Site No.	RD	Length & Width	Design annexed yes/No	Capacity (Cum)
1	1	0/860 to 0/910	50 x 20 =	Yes	50 x 20 x 6.5 = 6500 Cum
		1/690 to 1/740	50 x 20 =	Yes	50 x 20 x 6.5 = 6500 Cum
				Total	13000.00 cum

Divisional Forest Officer
 Borsj Forest Division at
 Banjar



Executive Engineer
 Banjar Division
 H.P.P.W.D. Banjar

JAY DE WIRE

CPD Ranchuser to

Nhacha via Bion Road Km.

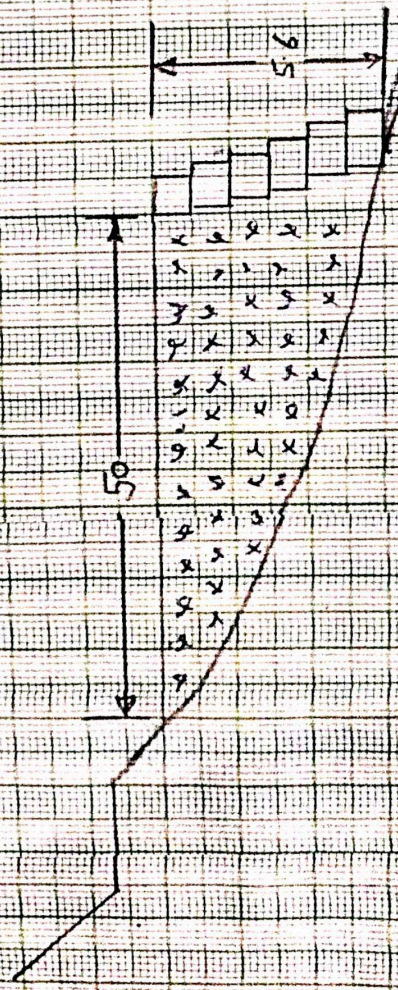
0/000 to 3/600



Dumping capacity = 6500 cum

RD 0/860 to 0/910

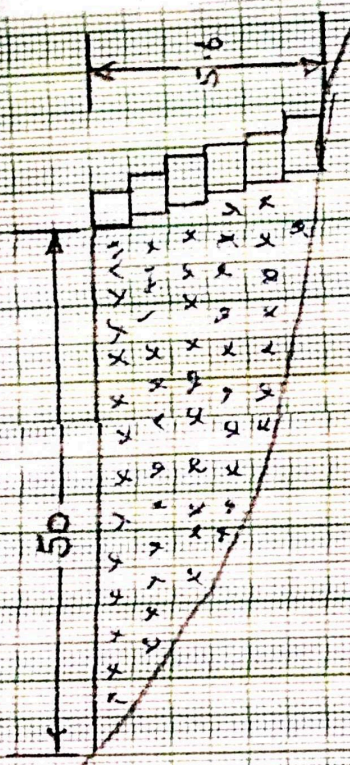

Dumping capacity = 6500 cum

1/690 to 1/740

Handwritten signature

Executive Engineer
Banjar Division
H.P.P.W.D. Banjar

Divisional Forest Officer
Banjar Forest Division
Banjar

Full Title of the Project: - C/O PANCHVEER TO DHOCHA VIA BION
ROAD KM 0/0 TO 3/00

UNDERTAKING FOR PROVIDING OF COMPLETE FRA CERTIFICATE

I, Executive Engineer, Banjar Division HPPWD Banjar H.P do hereby undertake to submit the Complete Forest Right Acts (F.R.A.) certificates (To be submitted under FCA Act 1980) for the proposed C/O PANCHVEER TO DHOCHA VIA BION ROAD KM 0/0 TO 3/00 at the time of Stage-II approval.

Place :-.....*Banjar*.....
Date:-.....*13.12.2022*.....

Executive Engineer
Banjar Division
HPPWD Banjar