

To,

Date: 27/01/2020

Principal Chief Conservator of Forest

Cum FCA Nodal Officer,

Jhalana Institutional Area

Aranaya Bhawan, Jaipur (Rajasthan)

Subject: Compliance Report of EDS Letter regarding Forest diversion Proposal No. **FP/RJ/ROAD/42702/2019.**

Ref: EDS letter no. F14 () 2019/BUNDI ROADS/FCA/PCCF/ESS II/Dated 30.12.2019

Dear Sir,

With reference to above mentioned Subject, we have received the EDS vide above cited letter regarding Forest Diversion Proposal "**Widening of Road Construction of Divider from Sr. School Lohagal to police Chowki Shastri Nagar Ajmer, District-Ajmer, Rajasthan**".

We have incorporated all the comments and uploaded the required document on **MoEFCC** Web portal for your reference and further processing please.

Point Wise Compliance Report:

Point No.	EDS Observation by Forest Department	Reply by User Agency
1	एरिया केलकुलेशन शीट ग्रामवार/खसरावार संलग्न नहीं है।	ग्रामवार/खसरावार एरिया केलकुलेशन शीट संलग्न कर दिया गया है।
2	प्रोजेक्ट रिपोर्ट	प्रोजेक्ट रिपोर्ट संलग्न कर दी गई है।
3	राजस्व मेप पर प्रस्ताव का अंकन एवं जमाबंदी संलग्न नहीं है।	राजस्व मेप पर प्रस्ताव का अंकन एवं जमाबंदी संलग्न कर दी गई है।

Place: Ajmer

Date: 27.01.2020

(दीपेन यादव)
अधिराषो अभियन्ता
अजमेर विकास प्राधिकरण
अजमेर
Signature of User Agency
Office Seal

Area Calculation Sheet											
Name of Project: Widening of Road and Construction of Divider from Sr. School Lohagal to police Chowki Shastri Nagar Ajmer, District-Ajmer, Rajasthan.											
Proposal No. : FP/RJ/ROAD/42702/2019 (Applied Area - 1.7890 Hectare)											
Sr.No.	District	Division	Village	Forest Land			Non Forest Land			Total Forest Land In Hectare	Total Non Forest Land In Hectare
				Length (Meter)	Width (Meter)	Area (ha.)	Length (Meter)	Width (Meter)	Area (ha.)		
1	Ajmer	Ajmer	Lohagal	1177.00	15.20	1.7890	923.00	15.20	1.4029		
Total Forest Land (ha)					1.7890		1.4029				

 (दीपेन यादव)
 अधिशासी अभियन्ता
 अजमेर विकास प्राधिकरण
 अजमेर

Place: Ajmer
Date: 27/01/2020

Signature of User Agency
Office Seal

Counter signed by:-
Divisional Forest Officer
Ajmer Forest Division
Office Seal_____

AJMER DEVELOPMENT AUTHORITY, AJMER

Estimate

Name of Work :- Widening of road and Construction of divider from Sr.school lohagal to police chowki shastri nagar, Ajmer

BSR 2013 (PWD Circle Building & Road)

Item Description	Unit	Number	Length	Breadth	Depth	Quantity	Rate	Amount
1 Excavation in soil using Hydraulic Excavator and Tipplers with disposal up to 1000 m. Excavation for roadway in soil with hydraulic excavator of 0.9 cum bucket capacity including cutting and loading in tipplers, trimming bottom and side slopes, in accordance with requirements of lines, grades and cross-sections, and transporting to the embankment location with a lift upto 1.5 m and lead upto 1000 m as per Technical Specification Clause 302.3								
For Storm water drain	Cum	1	100	1.9	1.40	266.00		
For Retaining Wall	Cum	1	130	3.2	1.40	582.40		
Widening of Road	Cum	2	1730	4.3	0.55	8182.90		
Total Quantity Say	Cum					266.00	25.0	6,650.00
2 Excavation in Ordinary Rock using Hydraulic Excavator and Tipplers with disposal upto 1000 m. Excavation for roadway in ordinary rock with hydraulic excavator of 0.9 cum bucket capacity including cutting and loading in tipplers, transporting to embankment site with a lift upto 1.5 m and lead upto 1000 m, trimming bottom and side slopes in accordance with requirements of lines, grades and cross-sections as per Technical Specification Clause 302.3.5								
L.H.S from lohagal to janana	Cum	1	150	7.25	3.25	3534.38		
L.H.S from lohagal to janana	Cum	1	150	7.25	2.25	2446.88		
R.H.S from lohagal to janana	Cum	1	100	7.25	2.75	1993.75		
Total Quantity Say	Cum					7975.00	43.5	346,912.50
3 Excavation in Hard Rock (blasting prohibited) Excavation for roadway in Hard Rock (blasting prohibited) with rock breakers including breaking rock, loading in tipplers and disposal with a lift upto 1.5 m and lead upto 1000 metres, trimming bottom and side slopes in accordance with requirements of lines, grades and cross-sections as per Technical Specification Clause 302.3.5								
R.H.S from lohagal to janana	Cum	1	170	6	4.00	4080.00		
L.H.S from lohagal to janana	Cum	1	100	6	2.25	1350.00		
Total Quantity Say	Cum					5430.00	196	1,064,280.00
4 Dismantling of flexible pavements and disposal of dismantled materials upto a lead of 100 m, stacking serviceable and unserviceable materials separate (Rs) /lv as per Technical Specification Clause 202 By Mechanical Means, Bituminous Courses								
For strengthening of Existing road	Cum	2	1730	2.7	0.05	467.10		
Total Quantity Say	Cum					467.10	118.0	55,117.800
5 Construction of granular sub base by providing well graded material as per MORD specification Table No- 400.1 & 400.2 having P.I. Not more than 6 including spreading in layer manually not exceeding 150mm loose thickness and consolidating with smooth wheel roller to achieve the 100% proctor density at OMC with all lead of granular material and water, hire charges of machinery and T&P complete as per technical specifications (compacted thickness to be measured) For grading-II material, By Manual Means								
For Widening of road Both sides	Cum	2	2200.0	4.30	0.20	3784.00		
Benns both sides	Cum	2	2200.0	1.5	0.20	1320.00		
Total Quantity Say	Cum					5104.00	227.00	1158608.00
6 Wet Mix Macadam								
Providing, Laying, spreading and compacting graded stone aggregate wet mix macadam, specification, including premixing the material with water at OMC in mechanical mixer (Pug Mill) carriage of mixed material by tipper to site, laying in uniform layers in sub-base/base course on a well prepared sub-base and compacting with smooth wheel roller of 80 to 100kN weight to achieve the desired density including watering, barricading and maintenance of diversion, etc as per Tables 400.11 & 400.12 and Technical specification clause 406. By Mechanical Means with 1 km lead								
For Widening of road Both sides	Cum	2	1730.0	4.30	0.250	3719.50		
Total Quantity Say	Cum					3719.50	862.00	3206209.00
7 Primer coat								
Providing and applying primer coat with bitumen emulsion (SS-1) on prepared surface of granular base including cleaning of road surfaces and spraying primer at the rate of 0.70-1.0 kg/sqm using mechanical means as per Technical specification clauses 502								
Total Quantity Say	Sqm	2	1730.0	4.30		14878.00	35.00	520730.00

(दीपेन यादव)

अधिशायो अभियन्ता
गन्तव्य विकास प्राधिकरण

S.N	Item Description	Unit	Number	Length	Breadth	Depth	Quantity	Rate	Amount
8	Tack Coat with Bitumen Providing and applying tack coat with Bitumen emulsion (RS-1) using emulsion distributor at the Rate (Rs.) of 0.25 to 0.30 kg per sqm on the prepared granular surfaces treated with primer & cleaned with Hydraulic broom as per Technical Specification Clause 503.								2
		Sqm	2	1730	7.00		24,220.00		
	Total Quantity Say	Sum					24220.00	11.00	266420.00
9	Dense Bituminous Macadam Providing and laying dense bituminous macadam on prepared surface with specified graded crushed aggregates for base/ binder course, (including cost of antistripping compound, to bring the stripping value of aggregate within permissible limits as per specification, if required) including loading of material with F.E. loader, heating binder, aggregates and filler in hot mix plant, transporting the mixed material by tipper and laying with paver finisher to the required level and grade, rolling, by power roller to achieve the desired density but excl. primer/tack coat as per MoRTH specification CI 507 with 4.5% bitumen content variation to be paid/ deducted as per Item No. 16.15. With 60/70 grade straight run bitumen								
		MT	2.25	1730.0	8.60	0.050	1673.775		
	Total Quantity Say	MT					1673.775	2735.00	457774.63
10	Bituminous Concrete Providing and laying bituminous concrete as per design mix on prepared surface with specified graded stone aggregate including 5% of aggregate with F.E. loader and hot mixing of binder (including cost of anti-stripping compound, wherever required) and 3% cement filler with aggregate in hot mix plant 40-60 TPH transporting the mix material with tipper to paver and laying with sensor paver finisher (as per clause 504.3.5) to the required level, grades and rolling with vibratory compactor and pneumatic tyred roller 150-250 KN, TP = 0.7 MPa to achieve the density (approved by the department) excluding cost of primer/tack coat (MoRTH Specification : Clause 509) Binder variation to be paid/deducted as per job mix formula as per item no.16.16. 30 to 45 mm compacted using 5% binder with all lead of mix material. With 60/70 penetration grade straight run bitumen								
		MT	2.3	1730.0	14.00	0.030	1671.180		
	Total Quantity Say	MT					1671.180	3055.00	5105454.90
11	Supplying & fixing of Cat's Eye made of aluminium alloy size 75x100x22 mm having 21 biconvex lenses embedded in circular disk of ABS plastic on each side [2200/3]X6]								
		Each					4400.000		
	Total Quantity Say	Each					4400.000	277.00	1218800.00
12	Marking centre Line and stop lines etc. on road as per IRC pattern with thermoplastic paint of approved quality and make with 8% glass beads laid on the road surface at temperature 160° C with a special applicator machine complete with a special applicator machine complete with labour material and traffic diversion arrangements.								
		Sqm	6.0	2200	0.15		1,980.00		
	Total Quantity Say	Sqm					1980.00	638.00	1263240.00
13	Demolishing cement concrete including disposal of material within 50 meters lead 1:3:6 or richer mix. Cutting C.C road and Couseways								
		Cum	1	350	5	0.20	350.00		
		Cum	4	30	5	0.20	120.00		
	Total Quantity Say	Cum					470.00	319.0	149,930.00
	Providing concrete for plain/reinforced concrete in open foundations complete as per drawings and technical specifications Clause 802, 803, 804 & 1203 Nominal mix 1:3:6 Retaining wall and storm water drain								
		Cum	1	100	1.6	0.20	32.00		
	For C.C pavement	Cum	1	130	2.9	0.20	75.40		
	For Couseway	Cum	1	350	14	0.10	490.00		
		Cum	4	30	14	0.10	168.00		
	For Drain Both sides [2X350X0.8X0.100]	Cum	2	350	0.8	0.10	56.00		
	Total Quantity Say	Cum					821.40	2258.0	1,554,721.20

(दीपेन यादव)
अभिशाषो अभियन्ता
अजमेर विकास प्राधिकरण
अजमेर

S.N	Item Description	Unit	Number	Length	Breadth	Depth	Quantity	Rate	Amount
15	Construction of un-reinforced, dowel jointed at expansion and construction joint only, plain cement concrete pavement, thickness as per design, over a prepared sub base, with 43 grade cement or any other type as per Clause 1501.2.2 M30 (Grade), coarse and fine aggregates conforming to IS:383, maximum size of coarse aggregate not exceeding 25 mm, mixed in a concrete mixer of not less than 0.2 cum capacity and appropriate weigh batcher using approved mix design, laid in approved fixed side formwork (steel channel, laying and fixing of 125 micron thick polythene film, wedges, steel plates including levelling the formwork as per drawing), spreading the concrete with shovels, rakes, compacted using needle, screed and plate vibrators and finished in continuous operation including provision of contraction and expansion, construction joints, applying debonding strips, primer, sealant, dowel bars, near approaches to bridge/culvert and construction joints, admixtures as approved, curing of concrete slabs for 14-days, using curing compound (where specified) and water finishing to lines and grade as per drawing and Technical Specification Clause 1501	Cum	1	350	14	0.20	980.00		
	For C.C pavement	Cum	4	30	14	0.20	336.00		
	For Couseway	Cum					1316.00	4500.0	5,922,000.00
	Total Quantity Say	Cum							
16	Dismantling Stone Masonry as per Technical Specification Clause 202 Dismantling of existing structures like culverts, bridges, retaining walls and other structure comprising of stone masonry, including disposal of unserviceable material and stacking the serviceable material with all lift and lead of 1000 m as per Technical Specification Clause 202 Rubble Stone Masonry in Cement Mortar								
	Existing Retaining wall (2.80+0.45)/2	Cum	1	130	1.625	3.30	697.13		82261.34
	Total Quantity Say	Cum					697.13	118.0	82,260.75
17	Stone masonry work in cement mortar in foundation complete as per drawing and technical specifications Clauses 702, 704, 1202 & 1203 Random Rubble Masonry in cement mortar 1:4								
	For Retaining wall and storm water drain (1.60+0.9)/2	Cum	1	100	1.25	1.20	150.00		
	(2.90+2.80)/2	Cum	1	130	2.85	1.20	444.60		
	Total Quantity Say	Cum					594.60	1851.0	1,100,604.60
18	Stone masonry in cement mortar for substructure complete as per drawing & technical specification Clauses 702, 704, 1202 and 1204. In 1:4 cement mortar								
	For Retaining wall and storm water drain (1.12+45)/2	Cum	1	100	0.785	1.55	121.68		1110083.50
	(1.12+45)/2	Cum	1	130	0.785	4.05	413.30		
	Total Quantity Say	Cum					534.98	2075.0	1,110,078.31
19	Pointing on stone masonry in cement sand mortar 1:3 (1 cement : 3 sand) : Flush or ruled pointing								
	For Retaining wall and storm water drain	Sqm	1	100		1.55	155.00		
		Sqm	1	130		4.05	526.50		
	Total Quantity Say	Sqm					681.50	51.0	34,756.50
20	Providing PCC M-20 architectural coping on the top of wing wall, return wall etc. complete as per drawing and technical specification Clauses 615, 710 and 1204.3.11 For 75 mm thickness								
	For Retaining wall and storm water drain	Sqm	1	100	0.45		45.00		
		Sqm	1	130	0.45		58.50		
	Total Quantity Say	Sqm					103.50	208.0	21,528.00
21	Construction of Embankment with Material Obtained from Roadway Cutting Construction of embankment with approved materials deposited at site from roadway cutting and excavation from drain and foundation of other structures graded and compacted to meet requirement of Tables 300.1 and 300.2 as per Technical Specification Clause (with lead upto 50 Mtr.)								
		Cum	1	130	10	4.33	5633.33		
	Total Quantity Say	Cum					5633.33	25.0	140,833.33
22	Providing and laying reinforced cement concrete pipe NP3 for culverts on first class bedding of granular material in single row including fixing collar with cement mortar 1:2 but excluding excavation, foundation works, backfilling, concrete and masonry: 750 mm dia								
		R.mtr	1	200			200.00		
	Total Quantity Say	Sqm					200.00	2130.0	426,000.00
23	Earth work in excavation in foundation trenches or drains including dressing of sides and ramming of bottoms, lift up to 1.5 Mtr. including taking out the excavated soil and depositing and refilling of jhiri with watering & ramming and disposal of surplus excavated soil as directed with in a lead of 50 meter								
		Cum	2	2200	0.4	0.30	528.00		67,056.00
	Total Quantity Say	Cum					528.00	127.0	

(दीपेन यादव)
अधिरायो अभियन्ता
अजमेर विकास प्राधिकरण
अजमेर

S.N	Item Description	Unit	Number	Length	Breadth	Depth	Quantity	Rate	Amount
24	Dismanting /diggingout complete old bituminous surface including disposal of scarified material within 50 Mtr. lead								
		Cum	2	1730	0.4	0.15	207.60		
	Total Quantity Say	Cum					207.60	338.0	70,168.800
25	Providing and laying in position cement concrete including curing, compaction etc. complete in specified grade excluding the cost of centering and shuttering - All work up to plinth level. M10 grade Nominal Mix (with graded stone aggregate 20mm nominal size)								
		Cum	2	2200.0	0.40	0.10	176.00		
	Total Quantity Say	Cum					176.00	3064.00	539264.00
26	Providing and laying in position specified grade of cement concrete for all RCC structural elements upto plinth level including curing, compaction, finishing with rendering in cement sand mortar 1:3 (1 cement: 3 coarse sand) and making good the joints excluding the cost of centering, shuttering and reinforcement M20 Grade nominal mix (with graded stone aggregate 20mm nominal size)								
		Cum	2	2200	0.3	0.3	396.00		
		Cum	2	2200	0.21	0.200	184.80		
		Cum	2	2200	0.12	0.4	211.20		
	For Drain both sides (2*2)X350X 2X 3	Cum	4	350	0.2	0.3	84.00		
	Total Quantity Say	Cum					876.00	4543.00	3979668.00
27	Centering & shuttering with plywood or steel sheets including strutting, propping bracing both ways with wooden members and of formwork for upto floor three level for : Walls (any type) including attached pilasters, buttresses plinth and string course								
		Sqm	2	2200	1		4400.00		
		Sqm	2	2200	0.9		3960		
		sqm	2	350	0.3		210		
	Total Quantity Say	Sqm					8,570.00	130.00	1114100.00
28	Supplying, fitting and placing TMT bar reinforcement (Fe 415) in substructure complete as per drawings and technical specification Clauses 1002, 1005, 1010 & 1202								
		Ton	876	7850	0.0063		43322.58		
	Total Quantity Say	Ton					43.32	48817.00	2114878.39
29	Supplying & fixing of 'L' type Bollard made out of 1.25 mm thick M.S. sheet height 134 cm, welded in circular type ring section having upper dia 15 cm. and lower dia 21 cm with another attachment of 15x15 cm circular section with 15 cm. face plate and hold fast at bottom, whole body is processed in white stoving enamel and red reflective 3 hands, each of 7.5 cm end one reflective sheet of 15 cm. dia provided to it complete in all respect.								
		Each	2	15			30		
	Total Quantity Say	Each					30.000	1584.00	47520.00
30	Supply & Stacking good earth at site complete including loading, unloading & transportation etc.								
		Cum	1	2200	1	0.5	1100.000		
	Total Quantity Say	Cum					1100.000	75.00	82500.00
31	Spreading of manure and good earth in required thickness (cost of manure and good earth to be paid separately).								
		Cum	1	2200	1	0.5	1100.00		
	Total Quantity Say	Cum					1,100.00	4.00	4400.00
32	Painting with enamel paint of approved brand and manufacture to give an even shade : Two or more coats on new work.								
		Sqm	2	2200	1.148		5051.2		
	Total Quantity Say	Sqm					5051.2	61	308,123.20
33	Providing weep holes in brick masonry/ stone masonry, plane forced concrete abutment, wing wall return wall with 100 mm dia pipe extending through the full width of the structure with the slope of 1(V) : 20(H) towards drawing face complete as per drawing and technical specification clause 614, 709, 1204 3.7								
		Rmtr	1	760			760		
	Total Quantity Say	Rmtr					760	50	38,000.00
								Total	37,737,943.59
								Add 4.5% Contingencies	1,698,207.46
								Grand Total	39,436,151.05
								Say Rs.	39,436,151.05

Technically sanctioned for Rs 397.00 lacs

A/P Sanctioned for Rs 397.00 lacs

21/11/17, 06/11/17

397.00 lacs

non-scholarship

Assistant Engineer

ADA, AJMER

(दीपन यादव)

अजमेर विकास प्राधिकरण

अजमेर

Executive Engineer
ADA, AJMER

मेर

तहसील अजमेर निकाला अजमेर से रवाडा बाबरत सन १३४६ एस की मुल गीक सन १९६९-७२ ई०
गोमते लियान मालियान

जंगल सर झर

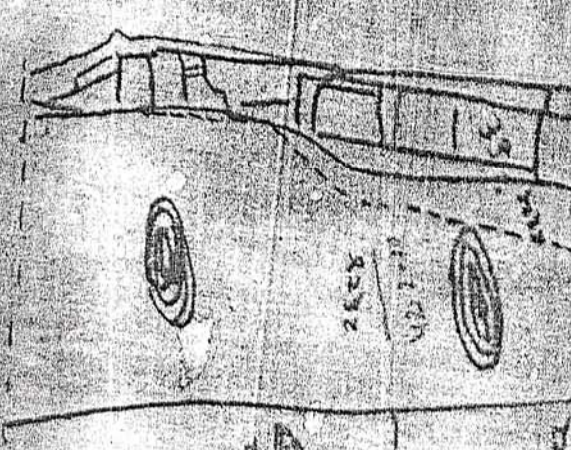

२६८४
५३३ २३७७

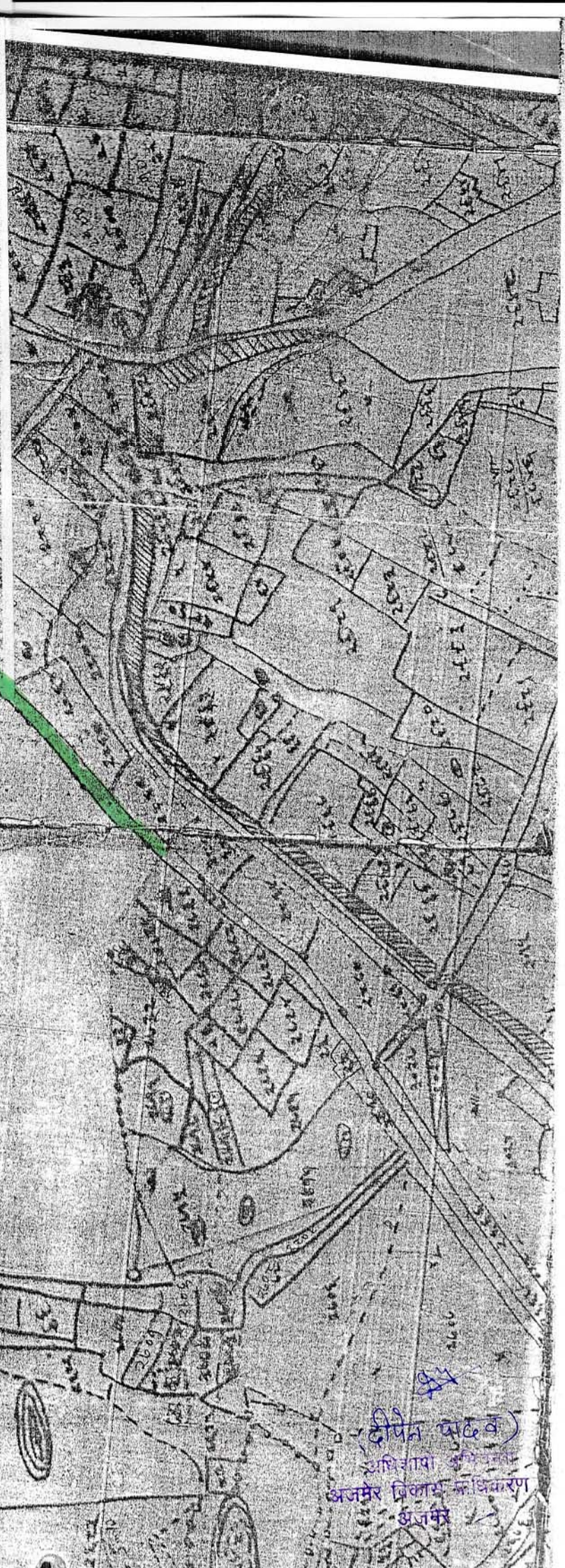
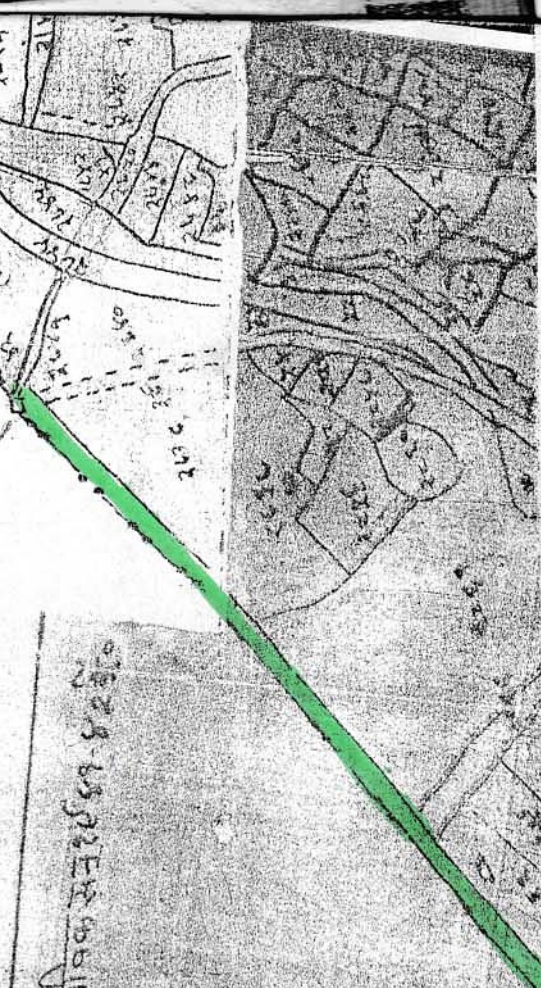

दीपेन चौधरी

अधिरावा अजमेर
अजमेर जिला अधिकारण
अजमेर



अजमेर विकास प्राधिकरण, अजमेर

आर - आर

क्रमिक टिप्पणी

722
4-18
5-18

विषय :- शास्त्री नगर पुलिस चौकी से लोहागल ग्राम तक की सड़क की राजस्व रेकॉर्ड के अनुसार सड़क की चौड़ाई बनाने का बत।

② उपरोक्त विषयानुसार निवेदन है की शास्त्री नगर पुलिस चौकी से लोहागल ग्राम तक सड़क सीमा में कौन-कौन से खसरो हैं। इन खसरो के अनुसार प्रति चैन सड़क की चौड़ाई कितनी है ताकी सड़क निर्माण की ज़रूरत की जा सके।

③ आग्रह कार्यवाही हेतु प्रस्तुत है।

④ A/E

23/4/18

23/4/18

⑤ E/E

2 RT
105
12.9.18
1.10.18

उक्त सड़क ADA के द्वितीय चरण के चौड़ी करने एवं सुदृढीकरण किया जा रहा है। इस सड़क का कार्य एवं कार्य के वन विभाग द्वारा दीवार बना करवीर लोकल निर्माण के लिये वन विभाग का पत्र प्राप्त हुआ जिसमें उन्होंने अनुमति के लिये लिखा है। अतः इस संवद्ध में बताया कि उक्त सड़क के विस्तार वन विभाग के अधीन है या नहीं। इस सड़क का रेवेन्यू रेकॉर्ड में विभिन्न स्थानों पर चौड़ाई क्या है। अतः इस सड़क पर प्रत्येक स्थान पर निर्माण कार्य करावे ताकि आग्रह कार्यवाही की जा सके।

72-3477
24/4/18

रहस्यीय

6. पत्र N/S के संदर्भ में रिपोर्ट करें।

7. श्री भाउ/प्रताप सिंह

24/4/18

शास्त्री नगर पुलिस चौकी से लोहागल ग्राम की सीमा तक सड़क बनाने का कार्य वन विभाग द्वारा कराया जा रहा है। अतः इस सड़क पर प्रत्येक स्थान पर निर्माण कार्य करावे ताकि आग्रह कार्यवाही की जा सके।

(दीपेन यादव)
अधिशायी अभियन्ता
अजमेर विकास प्राधिकरण
अजमेर



अजमेर विकास प्राधिकरण, अजमेर

क्रमिक टिप्पणी

8. TDR सा:

ग्राम लोहागल की सीमा के खसरे की रिपोर्ट
अंकित कर स्वामित्व टिप्पणी सहित उपर्युक्त करें।

9. धर्मि/सुरक्षा बाला

25/5/18

पैरा 8/14 के अनुसार ग्राम लोहागल के खसरे 1316 किला गैमुसडा
है जो कि पर वसूली गवाही (ADAR) के अनुसार 1315
उक्त सड़क की चौड़ाई 50 से 80 मीटर तक है। कुल खसरे 1315
वसूली के लिए गवाही के अनुसार ग्राम लोहागल की सीमा के
आसपास की धर्मि सुरक्षा बाला के पास की गवाही के लिए उपर्युक्त
है।

25/5/18

25/5/18
(सुरक्षा बाला)

10. पैरा N/7 अनुसार राजेश्वर ग्राम थोक मालिमान प्रकम में शास्त्री
नगर पुलिस चौकी से लोहागल सरहद तक सड़क की
भूमि अनसर्वेड क्षेत्र है। मोके पर सड़क निर्मित है तथा
ग्राम लोहागल की सरहद से लोहागल तक सड़क भूमि
ग्राम लोहागल का खसरे नं. 1316 वि.सू. गै.मु. सड़क प्राधिकरण
स्वामित्व की भूमि पैरा N/9 अनुसार है। जो मुताबिक नक्शा है।

अतः स्वामित्व रिपोर्ट अवलोकनार्थ एवं अग्रिम
कार्रवाई हेतु प्रस्तुत है।

X.EN. 84 (N).

25/5/18

T5-347
25/5/18

Ajmer Development Authority

File Identity

File No

LR-22

Date of Creation

25-May-2018

Department

Fresh Niyaman

Subject

GRAM LOHAGAL SEEMA SADAK
CHOUDAI

(दीपन यादव)

अधिशायो अभियन्ता

अजमेर विकास प्राधिकरण

अजमेर



18-19 May 2018

थोक मालिमान प्रकम में शास्त्री नगर पुलिस चौकी
से लोहागल सरहद तक सड़क की भूमि अनसर्वेड
क्षेत्र है। इसका खसरे नं. 1316
है। इस खसरे में सड़क की
लोहागल का खसरे नं. 1315
उपलब्ध करावे ताकि
वन विभाग से अनुमति की
कार्रवाई की जा सके।
- पत्रावली में सड़क अंकित
है ताकि वि.सू. गै.मु. नाम



अजमेर विकास प्राधिकरण, अजमेर (7)

N-12 की है इस संबंध में शीघ्र कार्यवाही की जा रही है।
क्रमिक टिप्पणी

TS-3477
11-9-18

13. तहसीलदार जी/अधिशायी अभियंता
अ.वि.प्रा. अजमेर

म/11/9/18
मानु प्रताप सिंह
कार्यवाही तहसीलदार
अ.वि.प्रा. अजमेर

14. श्री निजमवर्गीय/श्रीमति माया

अप्रसवेड होम का कोई कस्ता नंबर नहीं होता है। राजस्व
मानचित्र में सड़क अंकित नहीं है। राजस्व मानचित्र की
प्रतिलिपि सलोजन कर रिपोर्ट सायर प्रेषित है।

20-9-18
माया निजमवर्गीय
श्री. अ. वि. प्रा. अजमेर

20/9/2018
(विजय कुमार विजयप्रकाश)
पटवारी ADA.

15. Tds/Sir,

फैसल 04/14 अवलोकनार्थ एवं आदेशार्थ प्रस्तुत है।

म/1-10-18
मानु प्रताप सिंह
कार्यवाही तहसीलदार
अ.वि.प्रा. अजमेर

16. तकनीकी जांचवा.

वन विभाग के पत्र के संदर्भ में प्राप्ति उत्तर

मिलता है।

म/5/10/2018

कार्य स्थल पर गांव लोहागल के मुख्य गांव भावारी के पास
के मानचित्र के मकान, बाउण्ड्री बोल, डीवाल, 5 मीटर अडि
का प्रतिफल भी है। अतः उपरोक्त की निहित कर म
मकान के पत्रावली प्रतिफल होने की कार्यवाही हेतु
मकलोकनार्थ, एवं आदेशार्थ प्रीकानसी को प्रस्तुत है।

18. A.E./Sir-

Submitted for perusal/perusal/n/a/approval.

म/18/11/19
L.M. Ramani

M. M. M. M.
A.E. ADA

(दीपेन यादव)
अधिशायी अभियंता
अजमेर विकास प्राधिकरण
अजमेर

P.T.O