

The Divisional Forest Officer,
Shimla Forest Division,
Shimla-2.

Subject: Diversion of 0.2569 ha. forest land for the construction of proposed road for Ms Ojas Gram Tourism Site at Koti Shergata, Tehsil and District Shimla HP within the jurisdiction of Shimla Forest Division, District Shimla HP. (Onle Line File No. FP/HP/ROAD/41188/2019).

Sir,

Please refer to the GoI office letter No. FC/HPB/2023 dated 28.08.2023 on the subject cited above.

The point wise reply given as under:-

Point. No.1. a. Pertains to HP Forest Department.

b. Pertains to HP Forest Department.

c. Pertains to HP Forest Department.

d. Pertains to HP Forest Department.

e. No new construction of the road has been started. The construction of the road work will be started after final approval received from the GoI.

Point No. 2. The govt. of Himachal Pradesh through its flagship business event **"Rising Himachal Global Investors Meet 2019"** has called for investment opportunities across 08 focus sectors to boost economic activities in the state. The project titled **"Setting up of Ecotourism Resort and Meditation Centre at Village Mohal Sergata, P.O. Koti, Tehsil Junga, Distt. Shimla"** has been proposed as one such investment activity by the user agency and the same stands approved by the Govt. of H.P. The said project is being undertaken on Private land (Copy attached as Annex-) . However the project is located on 2 distant points on private land, thus require two access/approach roads from the existing main road i.e. Chalanda Piran PWD Road.

The state govt. has further issued one notification in this regard vide Notice No. FFE-S-F-(2)-3/2019 Dated 20th Sep 2019 vide which it has been provided that **"ALL the cases of diversion of forest land in order to provide access to the Investible projects being set up on non forest land/private land proposed by private individuals/firms or organizations including societies, trusts etc. will be recommended by the government for seeking approval under FCA-980"**

Keeping in view the supra quoted provisions , the proposal for seeking access for the said Investible project through forest land (copy attached as Annex-) has been sought under FCA-1980 and accordingly processed further.

The project titled Ecotourism Resort and Meditation Centre at village Mohal Sergata is a green field project to promote healthy life style and appreciate the nature in its original form. The project has been proposed keeping in view the climatic conditions and scenic beauty of the pristine mountains of Himachal Pradesh and is one such pioneer effort to establish facility for locals and visitors from nationals and international levels with objective to promote healthy life style. The project is in the line of medicinal tourism and involve meditation and yoga facilities. The state government is kind enough to accord opportunity to the firm and an initial investment of approx. 12 crore is proposed for the said project. Keeping in view the requirement of area for such project, efforts has been made to acquire/purchase pvt. Land in one stretch, however being hilly terrain it was not possible thus the single project has been conceptualized in two points/sites in the same area. The project sites lack accessibility thus efforts has been made to take access through the route which involve minimum forest land. The proposed access to the project site involves both forest as well as non forest land (pvt. Land). Thus the alignment which is passing through forest land has been proposed for diversion under FCA-1980 to make the project site accessible through road connectivity. Efforts has been further made to acquire minimum forest land and thus only 0.2569 hac. of forestland has been identified for diversion as the same was inescapable. Further three alternatives has been explored and the one with minimum forest area as well as no. of trees involved has been finalized. The project is going to boost the local economy of the area and will provide job opportunities to the locals as well as promote Local life style & economy of the area. Emphasis will be laid to boost organic cultivation/horticulture activities in the area. The project is not only important from investment side but also going to promote medical tourism in the long run.

Point No. 4. The proposed project is going to directly benefit two Patwar circles i.e. Piran and Koti which are having multiple villages and the beneficiary population is approx. 4765 which has been uploaded through online portal. The project is based on developing facilities such as stay, meditation, yoga etc. The engagement of locals is inescapable as without their active participation and support the project can't run in its fullest. Locals are being involved for the construction of the said facilities and keeping in view the estimated cost of the project approx. 1.5 Lakhs mandays will be generated. After the completion phase approx. 30 people will be directly engaged for carrying out day today activities such as, security guards, cleaning and sweeping, cooking, driving, electrician, plumbing, guides, administrative staff etc. The project is one of its kind to promote healthy life style and emphasis will be laid on yoga, mediation and other activities such as intake of organic food, fruits etc. The villages around the project site will be promoted for raising organic food crops, fruits and vegetables and the same will be procured through them. Further dairy products and other essential items will be sourced from these villages. The visitors who will be staying in the Resort will be taken around to showcase the village life as well as promote stays in villages and this can boost the economy of the locals.

Point No. 5. The revised KML file uploaded through online portal along with polygon.

Point No. 6. The digital copy of the layout plan uploaded through online portal.

Point No. 7. The undertaking to submit the NOC from PWD is uploaded as the same has been requested from the concerned department vide Letter dated 26.09.2023 copy of the

letter is uploaded through online portal for reference. Further the afresh NOC from PCB with regard to Consent to establish is also uploaded through online portal .

- Point No. 8. Pertains to Pr.CCF wildlife cum Chief wildlife warden.
Point No. 9. Pertains to HP Forest Department/ DFO Shimla.
Point No.10 .Pertains to HP Forest Department/ DFO Shimla.

Dated: 03.11.2023.

Place: Koti Shimla

Ojas Gram

[Handwritten Signature]

Partner
For OJAS GRAM

Auth. Sign.



OJAS GRAM
An abode of dancing Budhas

OJAS GRAM

Head Office: C-1202, Sushma Elite Cross, Old ambala road, Gazipur , Zirakpur District- Mohali (Punjab)

Site Office: Village Sergota, P.O. Koti, Tehsil Junga, Distt. Shimla (HP).

SITE PLAN - PLOT B

The site plan for Plot B is a detailed layout of a proposed development. It features a central area labeled 'ADVENTURE SPORTS' with blue contour lines indicating elevation. To the left, there is a 'GOLF PUTTING' area with red contour lines. A 'GOLF GREEN PUTTING COURSE' is also shown. The plan includes a 'BLOCK 6' area with red buildings, a 'BLOCK 7' area with red buildings, and a 'BLOCK 8' area with red buildings. A 'BLOCK 9' area is also indicated. The plan shows a network of roads, including a 'MAIN ROAD' and a 'SIDE ROAD'. A 'WATER TOWER' is located near the center. The plan also shows a 'WATER TREATMENT PLANT' and a 'WATER RESERVOIR'. The plan is bounded by a 'MAIN ROAD' on the left and a 'SIDE ROAD' on the right. The plan is titled 'SITE PLAN - PLOT B'.

Location map showing the proximity of Ojas Gram to Chalanda, Chail, and Kure. The map indicates Ojas Gram is 10 km from Chalanda. Distances are marked: 54 km to Chail, 50 km to Kure, and 10 km to Chalanda. The map also shows the location of Chalanda relative to the main road network.

[illegible]

The site plan on the left shows the layout of the development. It includes a road labeled 'PIRUND' with an arrow pointing towards the right. Three areas are marked with cross-hatching and labeled A, B, and C. Area A is a small, irregularly shaped plot. Area B is a small, irregularly shaped plot. Area C is a large, irregularly shaped plot. To the right of the site plan are two floor plans. The top floor plan is labeled 'BLOCK C' and shows a rectangular building with a central corridor and several rooms. The bottom floor plan is labeled 'BLOCK D' and shows a rectangular building with a central corridor and several rooms. Both floor plans include dimensions in meters.

[illegible]

```

PLT1 AREA = 53213.93 SQ M
PLT1 A
AREA OF BLOCK A = 1843.38 SQ M
AREA OF BLOCK B( NORTH ) = 2 X 4389.24 = 918.48 SQ M
AREA OF BLOCK C = 1095.11 SQ M
AREA OF BLOCK D = 2221.41 SQ M
TOTAL AREA = 18634.37 SQ M
PLT1 B
AREA OF BLOCK E = 1333.85 SQ M
PLT1 C
AREA OF BLOCK F( NORTH ) = 2691.81 = 274.83 SQ M
AREA OF BLOCK G( NORTH ) = 20 X 58.94 = 117.8 SQ M
AREA OF BLOCK H = 148.7 SQ M
AREA OF BLOCK I = 308.28 SQ M
TOTAL AREA = 1841.31 SQ M
TOTAL AREA PLT1 A+B+C+D = 8099.55 SQ M
DETERMINED FOR 1.75 X 3.5012 = 58175.75 SQ M

```

PLUT AREA = 33013.50 W
PLUT A
COVERGE OF BLOCK A = 451.68 50 W
COVERGE OF BLOCK B2 (N2) = 2 T 241.80 W = 463.96 50 W
COVERGE OF BLOCK C = 676.43 50 W
COVERGE OF BLOCK D = 656.48 50 W
TOTAL COVERGE = 2248.55 50 W
PLUT B
COVERGE OF BLOCK E = 512.81 50 W
PLUT C
COVERGE OF BLOCK F3 (N3) = 249.01 = 274.83 50 W
COVERGE OF BLOCK G2 (N2) = 23 16.25 = 112.5 50 W
COVERGE OF BLOCK H = 148.7 50 W
COVERGE OF BLOCK I = 305.88 50 W
TOTAL COVERGE = 841.31 50 W
TOTAL COVERNET PLUT AREA = 3387.87 50 W
PERCENTAGE COVERGE = 306 X 22513 = 1184.05 50 W

SIZE OF RAIN WATER TANK BLOK A
CAPACITY OF 19MM TANK $\times 20.5$ CM ROOF AREA = 80572.1 L
SIZE OF RAIN TANK BLOK B (2ND)
CAPACITY OF 19MM TANK $\times 20.5$ CM ROOF AREA = 48264.2 X 2 = 96528.4 L
SIZE OF RAIN TANK BLOK C
CAPACITY OF 19MM TANK $\times 20.5$ CM ROOF AREA = 13269 L
SIZE OF RAIN TANK BLOK D
CAPACITY OF 19MM $\times 20.5$ CM ROOF AREA = 13360 L
TOTAL CAPACITY OF 19MM TANK $\times 20.5$ CM ROOF AREA = 103754.6 L
SIZE OF 19MM = 2.5 X 4.0 X 0.305

RAIN WATER HARVESTING TANK PLOT B

SIZE OF RAIN TANK BLOK E
CAPACITY OF 19MM TANK $\times 20.5$ CM ROOF AREA = 10308 L
SIZE OF 19MM = 2.5 X 3.5 X 0.3

RAIN WATER HARVESTING TANK PLOT C

SIZE OF RAIN TANK BLOK F (3RD)

DENSITY OF 30'x30'x30' ROOF AREA = 1125.0 ± 0.2500 L
 DENSITY OF 30'x30'x30' ROOF AREA = 2974 L
 DENSITY OF 30'x30'x30' ROOF AREA = 3105 L
 DENSITY OF 30'x30'x30' ROOF AREA = 1885 L
 SIZE OF 30'x30'x30' = 2.0 ± 0.0 ± 0.0
PARKING PROVISION
 TOTAL AREA PAVED ± 30'x30' = 1700.00 ± 0.00
 PARKING REQUIRED IN 30'x30' ± 10.00 ± 0.00
 PARKING PROVIDED ± 100.00 ± 0.00 ± 100.00 ± 0.00 ± 100.00 ± 0.00
INDUSTRY

EXISTING	NEW	SEPTIC TANK
PROPOSED	IMPROVEMENT	IMPROVEMENT
STATE BOUNDARY	STATE BOUNDARY	STATE BOUNDARY
ROAD	ROAD	ROAD

PROPOSED RESORT FOR OJAS GRAM ON K NO 163, 165,
166, 167, 169, 170, 96, 213/4 ON MAUJJA SERGATHA ,
UP TEHSIL JUNGA AND DISTT SHIMLA

TITLE
SUBMISSION DRAWING - PLOT A, B, C

ARCHITECT'S SIGNATURE

THIS DRAWING IS THE PROPERTY AND COPYRIGHT OF © CH2M HILL & ASSOCIATES IT SHALL NOT BE COPIED, REPRODUCED OR USED WITHOUT WRITTEN CONSENT DO NOT SCALE THE DRAWING	
SCALE 1:300	DATE JUNE 2019

11/15/91	11/15/91
----------	----------

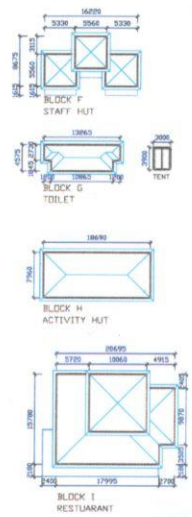
[illegible]

OWNER'S SIGNATURE

ARCHITECT'S SIGNATURE

JINDAL & ASSOCIATES
ARCHITECTS AND INTERIOR DESIGNERS
300, VASANT KUNJ PHASE II, COLONY - 110012
TEL: 88610-2471, 89150-8801

THIS DRAWING IS THE PROPERTY AND COPYRIGHT OF
J. INDAL & ASSOCIATES
IT IS TO BE USED ONLY FOR THE PROJECT AND LOCATION SPECIFICALLY
MENTIONED HEREON
DO NOT SCALE THE DRAWING

SCALE: 1:500 DATE: JUNE 2008 SHEET: 01/01 SEALING: CREATED

111/SD/SP-02

PRODUCED BY AN ATTORNEY

W. J. Beaulieu

FOR OJAS GRAM

Sign.

g/s K.T.
Divisional Forest Officer
Shimla Forest Division

UNDERTAKING

It is hereby submitted that the NOC from PWD for the construction of access road to the either sides of Chalanda Piran PWD Road will be submitted before stage II (In Principal Approval) as the same has been applied by the undersigned and is under process. I further assure that the same will be uploaded as and when the NOC is issued by the concerned.

Thanks and regards

Ojas Gram.

Rohit Bansal
FOR OJAS GRAM
Auth. Sign.

C/S
Divisional Forest Officer
Shimla Division
SHIMLA

OJAS GRAM
An abode of dancing Budhas

Point No. 7

To

Executive Engineer
H.P.P.W.D. B&R Shimla HP

Sub: Application for issuance of NOC.

Sir,

1. With due respect it is submitted that we are owners in possession of the land comprised in khasra Nos. 96, 163, 165, 166, 167, 169, 170, 213/4, measuring 03-32-13 hectares (33213 sq. metres) situated in Mohal Ser Gata, Sub Tehsil Junga, District Shimla HP
2. That just adjoining the above said land of the applicant, there exists forest land at the spot.
3. That there exists a motorable road at the spot which passes through the forest land and connects with H.P.P.W.D. Road at RD No.0/0 to RD 0/300 on the upper side of the main road.
4. That a demarcation of the aforesaid land i.e. the land of applicant and the forest land and HPPWD land was done at the spot in presence of your officials in case No. 19/2017 and 20/2017 on 11.8.2017. Copies enclosed.
5. That the applicant requires a NOC from your good self to the effect that your office has no objection if the applicant uses the forest road. The applicant has already applied to the Government of India, Ministry of Environment, Forest and Climate Change, CGO Complex, Shivalik Khand, Longwood Shimla for permission to use the aforesaid forest motorable road. The said Department vide its letter dated 28.8.2023 (copy enclosed) has demanded the NOC to be issued by your office.

*Copy
As Junga
for peruse*

*HP PWD.
NO: PW-SDA-WA-NOC/23-242 - 14503 dt: 9/23
Copy along with (1 No.) Case file in original is
forwarded to the Assistant Engineer Junga
Sub-Division, HP. PWD. Junga for information &
necessary action.
Encl 3 - As above.
C in original.*

*Executive Engineer
Shimla Division No. 1
H.P.P.W.D. Shimla-171003*

OJAS GRAM

Point No. 4

Details regarding population of Patwar Circle Piran and Pawar Circle Koti

As per the details available in the tehsil office Junga Tehsil Junga Distri Shimla (H.P.) the information regarding the population of Patwar Circle Piran and population of Patwar Circle Koti is as under: -

Sr. No.	Name of Patwar Circle	Name of Village and Code	Population (Approx.)
1.	Piran	Piran(004901), up-mohal Shilli Bagra(004903),Up-mohal Batola(004902), up- mohal Deothi (004905), Trai (004801), Thund (005001), Jangal Karoli (006201), Satlai (006401), Chikhar (006301), up-mohal Jhandi(004904)	3175
2.	Koti	Koti (005501), Sergata (005101), Ruhalti (005801), Neen (006001), Fanewat (005701), Jangal Fanewat(005601), Tungla (006101), Jangal Neen (005901), Kot Madhyad (005301), Jangal Chanai (005201), Jagedibagh (005401), Jangal Jagedibagh (002101), Jangal Manoon (002001)	1590

18/10/2022
कार्यालय
कानूनगो - तहसील
जुन्गा जिला शिमला

Point No. 7



H.P.STATE POLLUTION CONTROL BOARD

HIM PARIVESH, PHASE-III, NEW SHIMLA-171009

HPSPCB No : 264

Date: 11/10/2023

Industry Registration ID: HP09785198

Application No : 10779

To,

OJAS GRAM
VILLAGE SERGATA
JUNGA
Shimla
177005

Subject: Renewal of 'Consent to Establish' u/s 25/26 of Water (Prevention & Control of Pollution) Act, 1974 and u/s 21 of Air (Prevention & Control of Pollution) Act, 1981.

With reference to your application for obtaining Renewal of 'Consent to Establish' u/s 25/26 of Water (Prevention & Control of Pollution) Act, 1974 and u/s 21 of Air (Prevention & Control of Pollution) Act, 1981, you are hereby, authorized to Establish an industrial unit subject to the Terms and Conditions as mentioned in this Consent letter.

1. Particulars of Consent to Establish under Water Act, 1974 and Air Act, 1981 granted to the industry

Consent No.	CTE/BOTH/RENEW/RO/2023/10779
Date of issue :	01/04/2023
Date of expiry :	31/03/2024
Certificate Type :	RENEW
Previous CTE/CTO No. & Validity :	

2. Particulars of the Industry

Name & Designation of the Applicant	ROHIT BANSAL, (PARTNER)
Address of Industrial premises	OJAS GRAM, VILLAGE SERGATA, JUNGA, Shimla-177005
Capital Investment of the Industry	1168.0 lakhs
Category of Industry	Orange
Type of Industry	2038-Hotels (< 3 star) (or) hotels having > 20 rooms and less than 100 rooms, having waste water generation > 10 l and less than 100 KLD and having a coal/Oil fired Boiler
Scale of the Industry	Micro
Office District	Shimla
Capacity	

Products (Name with quantity per day)

Name of Products	Unit	Quantity	Intermediate Product	Principal Use
Luxury Rooms	Number/Year	14	Nil	Lodging Purpose
Luxury Cottage	Number/Year	16	Nil	Lodging Purpose
Ordinary Cottage	Number/Year	9	Nil	Lodging Purpose
Tents	Number/Year	40	NIL	Lodging Purpose
Dormitories	Number/Year	10	NIL	Lodging Purpose
Standard Room	Number/Year	8	NIL	Lodging Purpose

Details of the Effluent Treatment Plant

Type of Effluent	Capacity	Quantity
STP	35 KLD	1 KLD

Mode of Disposal

Description	Quantity(in KLD)	Method of Treatment	Method of Disposal
Domestic	28	STP	Irrigation/Garden

Quantity of fuel required (in TPD) and capacity of boilers/ Furnace/Thermo heater etc.

Type	No.of Boiler/'Heater /Evaporator/Incinerator/DG Set/Other	Capacity	Type of Boiler/'Heater s/Evaporators /Incinerator/DG Sets/Others	Type of Fuel	Fuel consumption rate in MT/hour or KL/hour or M3 /hour
DG Sets	1	125 KVA	DG Set	Diesel	5 LPH

Type of Air Pollution Control Devices installed

Equipment Type	Equipment Name	Date/proposed date of installation	Efficiency(%reduction)	Final concentration pollution being emitted
Acoustic Enclosure+ Exhaust Muffler	DG Sets	Mon Jan 01 00:01:00 IST 2024	95%	PM < 0.008 g/l hr, NOx < 1.2 g/kw-hr, CO < g/kw-hr



Member Sec
(H. P. State Pollution Control)

Endst. No.:

Copy To:-

1. The Regional Officer, HPSPCB, Shimla for information and to ensure the operation of the unit as per consent cor
& with adequate pollution control devices.



ANIL
JOSHI

Anil Jos
Member Sec
For & on be
(H. P. State Pollution Control)

TERMS AND CONDITIONS

A. SPECIFIC CONDITIONS

1. This Consent to Establish is only for the purpose and under the provision of Water Act, 1974 and Air Act, 1981 as the case may be, and will not construed as substitute for mandatory clearances required for the project under any other law/regulation/direction/order and the applicant shall obtain any such mandatory clearance before taking any steps to establish industry/ industrial plant, operation or process or any treatment and disposal system or extension or addition thereto.
2. Nothing in this Consent shall be deemed to neither preclude the institution of any legal action nor relieve the applicant from any responsibilities, liabilities or penalties to which the applicant is or may be subjected to under this or any other Act.
3. The unit shall apply for further extension in the validity of the Consent to Establish, at least two months before the expiry of this 'Consent to Establish', if applicable.
or
The unit shall obtain prior Consent to Operate from the State Board, before starting operational activity and gets its completion plan approved by the Competent Authority (if applicable).
4.
 - i) The unit shall made provisions for the compliance of Waste Management Rules i.e. Hazardous and Other Wastes (Management and Transboundary Movement) Rule 2016/ Plastic Waste Management Rules, 2016/ E-Waste (Management) Rule 2016/Construction & Demolition Waste Management Rules, 2016 and Manufacture, Storage & Import of Hazardous Chemical Rules, 1989 and provisions made thereunder, as amended from time to time, without any adverse effect on the environment, in any manner (As Applicable)
 - ii) The unit shall made provisions for the compliance Solid Waste Management Rule 2016 and provisions made thereunder and unit shall also not practice burning activity of solid waste/waste generated from fuel within/outside premises, to avoid public nuisance.
5. This 'Consent to Establish' is for:-
 - i) The emissions from all sources conforming to the norms as prescribed in Schedule-I of Environment (Protection) Rules, 1986 as amended from time to time.
 - ii) Noise and Ambient Air Quality shall be maintained within Ambient Air Quality Standards for noise as specified in Schedule-III of Environment (Protection) Rules, 1986 and Noise Pollution (Regulation and Control) Rules, 2000, as amended from time to time.
 - iii) The effluent (Domestic/Industrial) shall conform to the limits as prescribed in Schedule-II or Schedule-VI or Industry specific standards of Environment (Protection) Rules, 1986 as amended from time to time.
 - iv) Sewage and sullage generated from the unit to be disposed-off in a properly designed septic tank system/Sewage Treatment Plant/ Public Sewer System (as applicable).
6. The unit shall install adequate pollution control devices and provide the separate energy meter and flow meter. The unit shall maintain the logbook/ record with respect to operation of pollution control devices (As applicable). The achievement of the adequacy and efficiency of the effluent treatment plant/pollution control devices/re-circulation system installed shall be the entire responsibility of the unit.
7. **CONDITIONS UNDER WATER (PREVENTION & CONTROL OF POLLUTION) ACT, 1974.**
 - a) The unit shall provide terminal manhole(s) at the end of each collection system and manhole upstream of final outlet (s) out of the premises of the industry for measurement of flow and for taking samples.
 - b) The unit shall install flow meter and maintain the record regarding the daily water

- c) The pollution control devices shall be interlocked with the manufacturing process of the industry (if applicable) and the authorized outlet and mode of disposal shall not be changed without the prior written permission of the Board. Unit shall not use an unauthorized out-let(s) for discharging effluents from its premises.
- d) Solids, sludge, filter backwash or other pollutant removed from or resulting from treatment or control of waste waters shall be disposed-off in scientific manner.
- e) The unit shall submit a detailed plan showing therein, the distribution system for conveying wastewaters.

8. **CONDITIONS UNDER AIR (PREVENTION & CONTROL OF POLLUTION) ACT 1981.**

- a) The unit shall provide canopy and stack of adequate height of the D.G sets so as to control the noise & air pollution in order to comply with the provision of notification N GSR-371 E dated 17-5-2002 or direction as issued by MOEF from time to time, under Environment (Protection) Act, 1986.
- b) The unit shall ensure disposal of boiler ash/fuel ash through authorized person or within premises in a scientific manner (as the case may be) and shall maintain proper record for the same, if applicable.
- c) The unit shall provide proper and adequate air pollution control arrangements for controlling emission from its coal/fuel handling area and emissions from handling, transportation and processing of raw material & product of the industry, as applicable.
- d) The unit shall provide port-holes, platforms and/or other necessary facilities as may be required for collecting samples of emissions from any chimney, flue or duct or any other outlets as per the specifications.

Specifications of the port-holes shall be as under:-

- i) The sampling ports shall be provided at least 8 times chimney diameter downstream and 8 times upstream from the flow disturbance. For a rectangular cross section the equivalent diameter (D_e) shall be calculated from the following equation to determine upstream downstream distance:-

$$D_e = 2 LW / (L+W)$$

Where L= length in mts. W= Width in mts.
- ii) The sampling port shall be 7 to 10 cm in diameter
- e) The unit shall submit a detailed plan showing therein, the distribution system for conveying wastewaters.

(i) Stack height for boiler plants

S.NO. Boiler with Steam Generating Capacity Stack heights

1.	Less than 2 ton/hr.	9 meters or 2.5 times the height of neighboring building whichever is more
2.	More than 2 ton/hr. to 5 ton/hr.	12 meters
3.	More than 5 ton/hr. to 10 ton/hr	15 meters
4.	More than 10 ton/hr. to 15 ton/hr	18 meters

5. *More than 15 ton/hr. to 20 21 meters ton/hr*
6. *More than 20 ton/hr. to 25 24 meters ton/hr.*
7. *More than 25 ton/hr. to 30 27 meters ton/hr.*
8. *More than 30 ton/hr.* 30 meters or using the formula
 $H = 14 Q_g^{0.3}$ or
 $H = 74 (Q_p)^{0.24}$
 Where Q_g = Quantity of SO₂ in Kg/hr.
 Q_p = Quantity of particulate matter in Ton/day.

Note : Minimum Stack height in all cases shall be 9.0 mtr. or as calculated from relevant formula whichever is more.

(ii) For industrial furnaces and kilns, the criteria for selection of stack height would be based on fuel used for the corresponding steam generation.

(iii) Stack height for diesel generating sets:

Capacity of diesel generating set	Height of the Stack	
0-50 KVA	Height of the building	+ 1.5 mt
50-100 KVA	-do-	+ 2.0 mt.
100-150 KVA	-do-	+ 2.5 mt.
150-200 KVA	-do-	+ 3.0 mt.
200-250 KVA	-do-	+ 3.5 mt.
250-300 KVA	-do-	+ 3.5 mt.

For higher KVA rating stack height H (in meter) shall be worked out according to the formula:

$$H = h + 0.2 (KVA)^{0.5}$$

where h = height of the building in meters where the generator set is installed.

9. The unit shall submit on-site and off-site emergency plan approved by the Chief Inspector Factories, Himachal Pradesh (If applicable)
10. The unit shall provide real time online monitoring equipment's and provisions for the uninterrupted transfer of data as per guidelines of CPCB (if applicable).
11. The unit shall provide adequate arrangements for fighting the accidental leakages/ discharge of any air pollutant/gas/liquids from the vessels, mechanical equipment's etc. which are likely to cause environmental pollution.
12. The unit shall plant minimum three layer of trees so far possible as per plantation guide (may be download from the website <http://hppcb.nic.in/plantationguide.pdf>) all along the boundary of the industrial premises and check air/water/noise pollution at source.
13. Any guidelines issued by the Central Government/State Government/MoEF/CPCB/SPCB/any other authority concerned, shall be binding.
14. This 'Consent to Establish' is subject to orders on any litigation pending in any Court of Law. Any direction/order issued by any court shall be binding (if any).
15. The Board reserves the right to revoke the 'Consent to Establish' granted to the industry any time, in case the industry is found violating the provisions of Water (Prevention Control of Pollution) Act, 1974 and Air (Prevention & Control of Pollution) Act, 1981 amended from time to time.

1. The unit shall comply with the conditions imposed by the MoEF/State Level Environment Impact Assessment Authority/ District Level Environment Impact Assessment Authority the environmental clearance granted to it as required under EIA notification dated 14-9-06, applicable.
2. The issuance of this consent does not convey any property right in either real or person property, or any exclusive privileges, nor does it authorize any injury to private property any invasion of personal rights, nor any infringement of Central, State or Local Laws Regulations.
3. Stone Crusher units shall comply with the provisions of guidelines notified by the State Government vide Notification No. STE-E(3)-11/2012, dated 29-05-2014 (If Applicable).
4. Brick Kiln units shall comply with the provisions of guidelines notified by the MoEF vide Notification No. G.S.R.233.(E), dated-15-03-2018 and by the State Government vide Notification No. STE-E(5)-6/2013, dated-07-03-2014 (If Applicable).
5. Hydroelectric Projects shall install Online Real Time Monitoring System for the measurement of 15% of minimum discharge in lean season as per orders of Court/Government. The unit shall also ensure provisions for the regular and uninterrupted transfer of data from the real time online monitoring system for 15% of minimum discharge of flow to SPCB, failing which unit shall be liable for action on account of violation of the directions issued by the Court/Government/SPCB in this regard (If Applicable).
6. Unit shall strictly adhere to the capacity approved by the Industries Department/ Department of Tourism & Civil Aviation/any other concerned Authority (As Applicable).
7. The unit shall not cause any nuisance/traffic hazard in vicinity of the area.
8. The unit shall ensure that there will not be significant visible dust emissions beyond the property line.
9. The unit shall obtain and submit Insurance cover as required under the Public Liability Insurance Act, 1991.
10. The unit shall put display Board indicating environmental data in the prescribed format at the main entrance gate.
11. The unit shall maintain record regarding the operation of effluent treatment plant i.e. record quantity of chemicals and energy utilized for treatment and sludge generated from treatment so as to satisfy the Board regarding regular and proper operation of pollution control equipment.
12. Any amendments/revisions made by the Board/CPCB/MOEF in the emission/stack height standards shall be applicable to the industry from the date of such amendments/revision.

C. SPECIAL CONDITIONS

1. The unit shall carry out source segregation of solid waste and the biodegradable waste shall be reused after composting by providing organic waste composter machine or any such appropriate method in the premises.
2. The unit shall not carry out bulk laundry washing without prior consent of the State Board.
3. This consent has been issued considering the adequacy of the proposed pollution control devices and waste management systems/mechanism only.
4. This Consent of the State Board does not absolve the proponent of his responsibility to take pre-approvals / approvals / prior NOCs / from other departments/agencies as the case may be, for the violation of which, the State Board bears No responsibility.



एस.सी.ए रसीद संख्या: 3299155822384952

नाम : xy

पिता/पति : yz

पिता/पति : yz

पिता/पति : yz

रकबा ईकार्ड: है-आ-सै

हिस्सा या	
-----------	--

हिस्सा या	
-----------	--

हिस्सा या	
-----------	--

हिस्सा या	
-----------	--

हिस्सा या	
-----------	--

हिस्सा या	
-----------	--

हिस्सा या	
-----------	--

हिस्सा या	
-----------	--

हिस्सा या	
-----------	--

हिस्सा या	
-----------	--

हिस्सा या	
-----------	--

हिस्सा या	
-----------	--

हिस्सा या	
-----------	--

हिस्सा या	
-----------	--

हिस्सा या	
-----------	--

हिस्सा या	
-----------	--

हिस्सा या	
-----------	--

हिस्सा या	
-----------	--

हिस्सा या	
-----------	--

हिस्सा या	
-----------	--

हिस्सा या	
-----------	--

हिस्सा या	
-----------	--

हिस्सा या	
-----------	--

हिस्सा या	
-----------	--

हिस्सा या	
-----------	--

हिस्सा या	
-----------	--

हिस्सा या	
-----------	--

हिस्सा या	
-----------	--

हिस्सा या	
-----------	--

हिस्सा या	
-----------	--

हिस्सा या	
-----------	--

हिस्सा या	
-----------	--

हिस्सा या	
-----------	--

हिस्सा या	
-----------	--

हिस्सा या	
-----------	--

15. 20-07-2023

पृष्ठ संख्या: 1

निकनेट : हिमाचल प्रदेश - शिमला



सत्यमेव जयते

INDIA NON JUDICIAL

Government of Himachal Pradesh

₹100

e-Stamp

Certificate No.	: IN-HP08414872349699V
Certificate Issued Date	: 26-Oct-2023 12:14 PM
Account Reference	: CSCACC (GV)/ hpcscg07/ HP-SLNEE0056/ HP-SL
Unique Doc. Reference	: SUBIN-HPHPCSCG0714075398228181V
Purchased by	: RAJEEV GUPTA SON OF SH SOHAN LAL GUPTA
Description of Document	: Article 4 Affidavit
Property Description	: Not Applicable
Consideration Price (Rs.)	: 0 (Zero)
First Party	: RAJEEV GUPTA SON OF SH SOHAN LAL GUPTA
Second Party	: Not Applicable
Stamp Duty Paid By	: RAJEEV GUPTA SON OF SH SOHAN LAL GUPTA
Stamp Duty Amount(Rs.)	: 100 (One Hundred only)

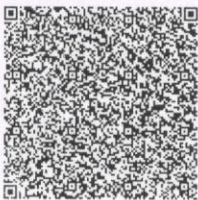

Please write or type below this line



Statutory Alert:

1. The authenticity of this Stamp certificate should be verified at 'www.sholestamp.com' or using e-Stamp Mobile App of Stock Holding.
2. Any discrepancy in the details on this Certificate and as available on the website / Mobile App renders it invalid.
3. The onus of checking the legitimacy is on the users of the certificate.
3. In case of any discrepancy please inform the Competent Authority.

AFFIDAVIT

I, Rajeev Gupta S/O Sh. Sohan Lal Gupta R/O House No 971 Sector 4 Panchkula Haryana 134112 do hereby solemnly affirm and declare as under:-

1. The road alignment proposed by ojas gram under FCA-1980 is passing through the land owned by me at kh No 213/5 msr 01-73-40 HCT 17340 Sqm. (between RD 0/105 to 0/205) Mauza Sergata Tehsil Junga Shimla H.P.
2. The undersigned is having no objection if the road approved under the said provision is constructed through my land. I am fully aware of the alignment going through my private land.

Deponent

Verification :- I, the above named deponents do hereby verify that the contents of our above affidavit are true and correct to the best of our knowledge and belief. No part of it is false and nothing has been concealed therefrom.

Verified At Solan on this :- 26-10-2023

Deponent

Witness:-

1. Archi Sehgal D/O Sh. Raj Kumar Sehgal
R/O Kamla Niwas Officer colony Solan H.P.

2. Swati Bhatt D/O Manoj Bhatt
R/O Chanderawani Dheradhun

Certified that the
have been read over and explained to
the who seems
perfectly to understand it and admitted it
to be correct.

ATTESTED
NOTARY
Anju Kohli, Solan

Anju Kohli
Notary
Anju Kohli,
Sub Division Solan