

CULVERT SECTION

AREA OF APPROACHES

AREA AT 'A' =6.0MX3.53M=21.18X2=42.36

AREA AT 'B'=AREA MARKED 'B'-AREA OF SEGMENT

$$X[(1/2x5.0MX3.53M)-2/3x6.12MX1.04M]$$

=2X[8.82-4.24]

SQ.M.

=2X4.58

SQ.M.=9.16

SQ.M.

TOTAL AREA =(A+B)

=(42.36+9.16)

SQ.M.

=51.52

SQ.M.

= 0.0052

HECT.

IN			OUT		
StNo.	Latitude	Longitude	StNo.	Latitude	Longitude
1	27 856.03	75 986.14	1	27 855.47	75 986.63
2	27 856.001	75 986.19	2	27 855.33	75 986.717
3	27 855.986	75 986.778	3	27 855.65	75 986.697
4	27 856.039	75 986.661	4	27 855.28	75 986.681

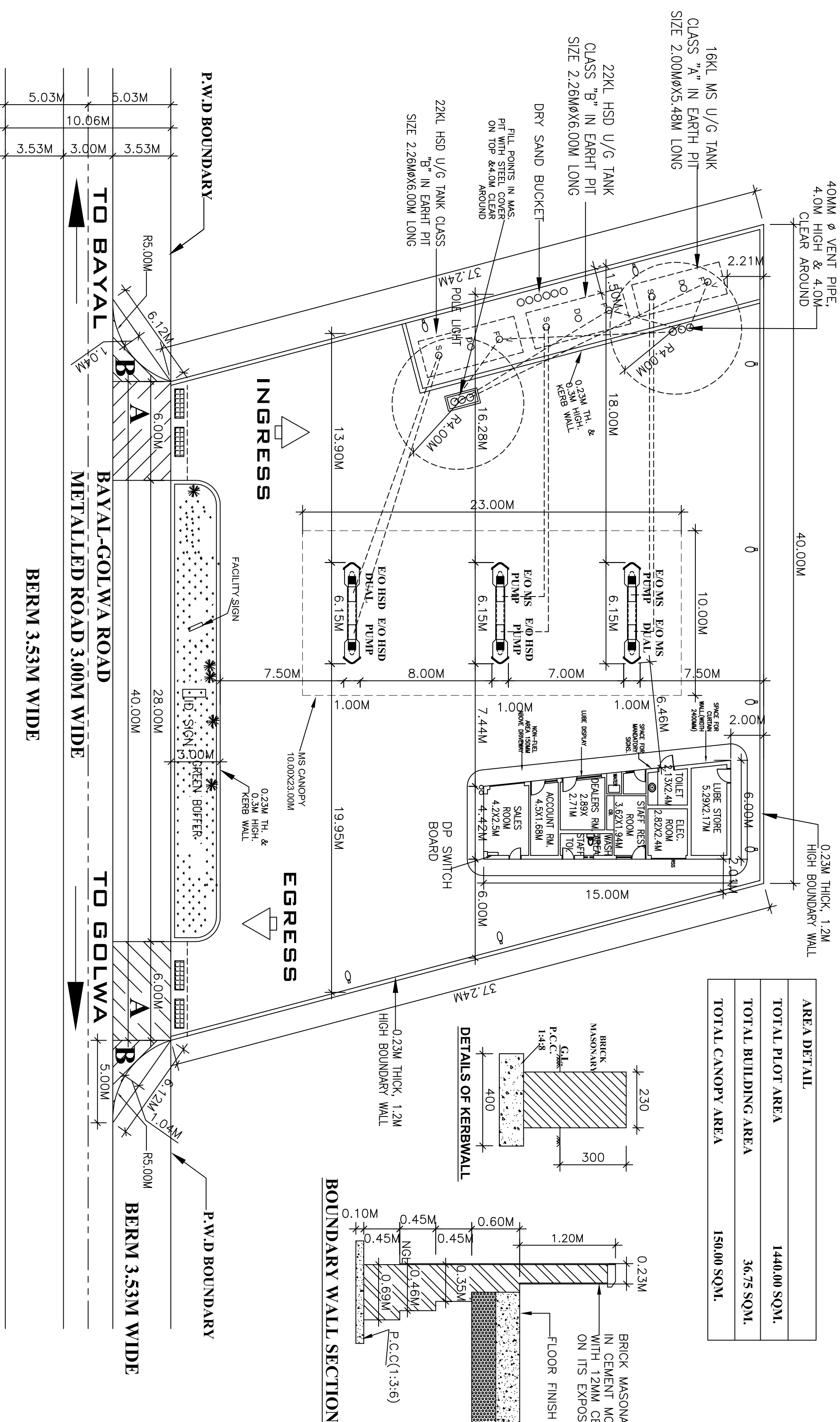
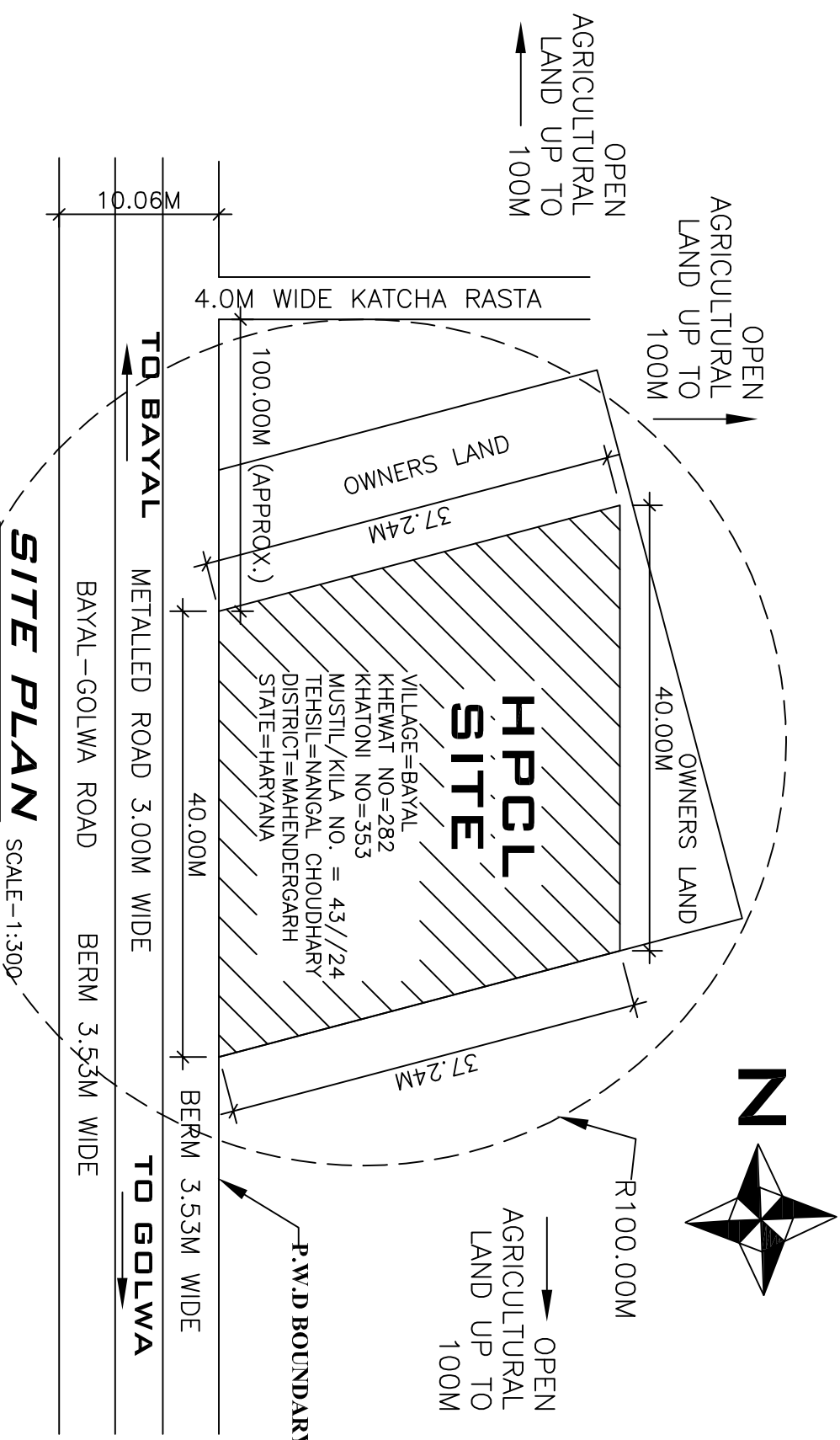

AREA DETAIL	
TOTAL PLOT AREA	1440.00 SQ.M.
TOTAL BUILDING AREA	36.75 SQ.M.
TOTAL CANOPY AREA	150.00 SQ.M.

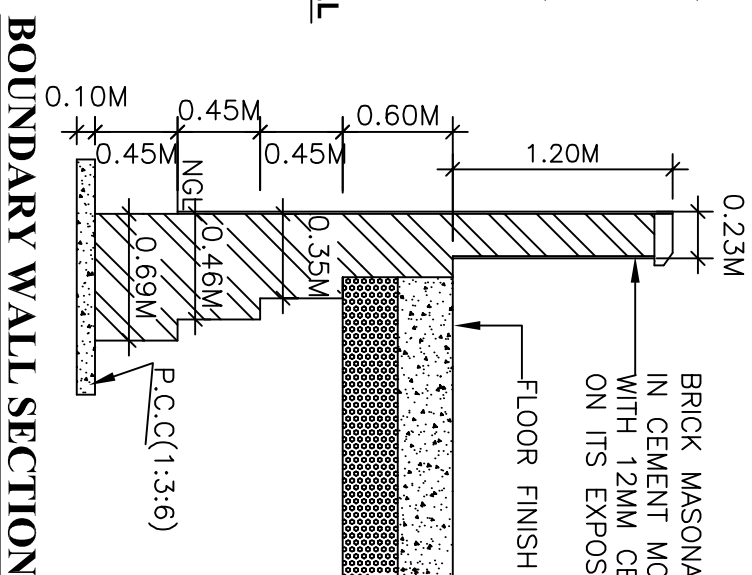
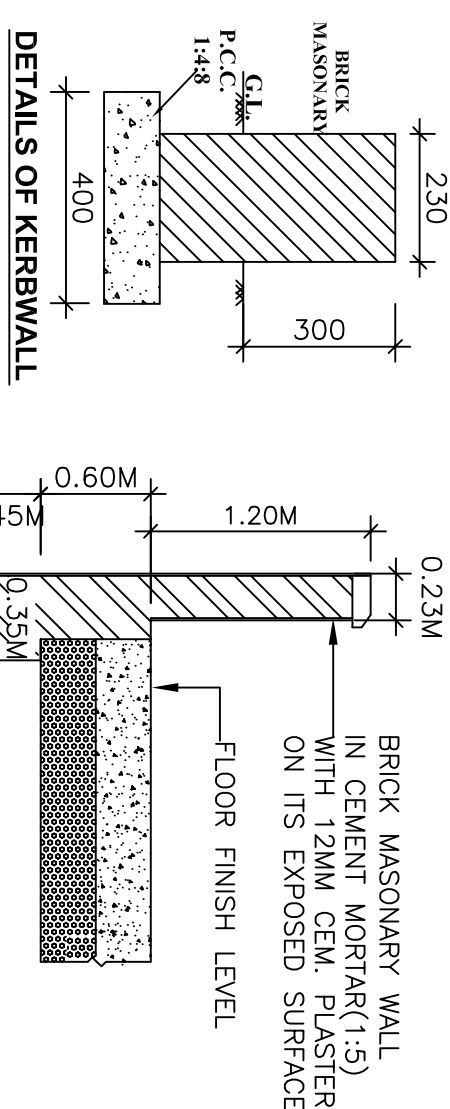

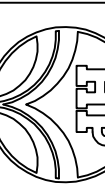
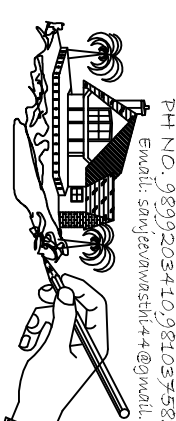
		हिन्दुस्तान पेट्रोलियम	
HINDUSTAN PETROLEUM CORPORATION LTD.		R/O	
GURGAON		VILLAGE = BAYAL	
PROPOSED SITE & LAYOUT PLAN OF RETAIL OUTLET ON BAYAL-GOLWA ROAD (LINK ROAD) AT VILLAGE BAYAL, THESIL NANGAL CHOUDHARY, DISTT. MAHENDERGARH (HARYANA)		KHEWAT NO. = 282 KANTONI NO. = 353 MUSTIL/KULA NO. = 43//24 POLICE STATION=NANGAL CHOUDHARY NEAREST RAILWAY STATION=NIZAMPUR	
LIC. NO.= NEW PROPOSAL		THESIL = NANGAL CHOUDHARY DISTRICT = MAHENDERGARH	
VASTAKIRTI CONSULTANTS PLOT NO. 89/91/2/3/4/5/6/7/8/9/10/11/12 PHASE II, INDUSTRIAL ESTATE-4, GURGAON HARYANA-122002		STATE = HARYANA	
APPL. BY		DATED: 26.01.2014	
			

NOTES & CERTIFICATES

1. CERTIFIED THAT THERE IS NO OTHER STRUCTURE WILL BE ERECTED NOR ANY OTHER SERVICE REMOVED EXCEPT THAT CONNECTED WITH THE PETROL PUMP WITHOUT THE PRIOR APPROVAL OF PWD.
2. CERTIFIED THAT THERE IS NO ROAD CROSSING WITH IN 100M BETWEEN THE ANJANT POINT OF APPROVAL AND THE PETROL PUMP.
3. CERTIFIED THAT THERE NO OBSTRUCTION FROM ROAD POINT OF VIEW FOR THE INSTALLATION OF THIS PUMP THE PROPOSAL, WILL NOT EFFECT THE FUTURE IMPROVEMENT OF THE ROAD.
4. CERTIFIED THAT NO OTHER PETROL PUMP EXISTS WITHIN THE DISTANCE OF 300M ON EITHER SIDE OF THE PILOT.
5. CERTIFIED THAT THE PETROL PUMP IS NOT SITUATED IN THE AREA OF LAND TO BE LEASED FROM PWD FOR APPROVAL, BECAUSE SITES TO BE METALLED BY THE GOVT. OF INDIA AND IRC FROM TIME TO TIME WITH THE LOCATION OF ROAD SIDE FUEL FILLING STATIONS HAVE BEEN COMPLIED WITH ENTIRE CONSTRUCTION WILL BE ON CORPORATION LAND.
6. NO DRINKWATER OR STRUCTURE WITH IN 15M FROM U/G TANKS.
7. THE PETROL PUMP IS NOT SITUATED IN THE AREA OF LAND TO BE LEASED FROM PWD FOR APPROVAL.
8. ELECTRIC FITTINGS CONNECTED TO THE CODE NO. 21485 DISPENSING PUMP ONLY.
9. D.P.S. BOARD 1.5M HIGH FROM FLOOR LEVEL AND WILL NOT BE KEPT UNDER LOCK AND KEY.
10. TANKS FED BY TANK LOUVER.
11. 40MM DIA. VENT PIPES 4.0M HIGH FROM G.O. AND 4M CLEAR ABOVE THE OPEN END OF VENT PIPES COVERED WITH ONE LAYER OF NON CORRODIBLE WHITE COLOUR OF 125MM PER CM. THERE SHOULD BE SUFFICIENT STANDING SPACE IN SIDE THE STATION FOR VEHICLES TO WAIT FOR THEIR TURN 15, IN AND OUT SIGNS ARE PUT UP TO GUIDE DRIVERS DURING THE DAY AND ARE PROPERLY LIT UP TO GUIDE THEM AT NIGHT.
12. NO SMOKING, STRIKE FIRE EXTINGUISHER AND FIRE BUCKETS PROVIDED AT SITE.
13. CERTIFIED THAT THE PETROL PUMP IS NOT SITUATED IN THE AREA OF LAND TO BE LEASED FROM PWD FOR APPROVAL, BECAUSE SITES TO BE METALLED BY THE GOVT. OF INDIA AND IRC FROM TIME TO TIME WITH THE LOCATION OF ROAD SIDE FUEL FILLING STATIONS HAVE BEEN COMPLIED WITH ENTIRE CONSTRUCTION WILL BE ON CORPORATION LAND.
14. CERTIFIED THAT THE PETROL PUMP IS NOT SITUATED IN THE AREA OF LAND TO BE LEASED FROM PWD FOR APPROVAL, BECAUSE SITES TO BE METALLED BY THE GOVT. OF INDIA AND IRC FROM TIME TO TIME WITH THE LOCATION OF ROAD SIDE FUEL FILLING STATIONS HAVE BEEN COMPLIED WITH ENTIRE CONSTRUCTION WILL BE ON CORPORATION LAND.
15. CERTIFIED THAT THERE WILL NOT BE ANY HINDRANCES FROM OVER HEAD LINES AND POLES.
16. CERTIFIED THAT THE SURPLUS WATER WILL NOT BE DISPOSED OFF IN PWD LAND.
17. CERTIFIED THAT ALL CLEARANCES/APPROVAL FROM MO-RC & OTHER RELEVANT GOVT.
18. CERTIFIED THAT THERE NO OBSTRUCTION FROM ROAD POINT OF VIEW FOR THE INSTALLATION OF THIS PUMP THE PROPOSAL, WILL NOT EFFECT THE FUTURE IMPROVEMENT OF THE ROAD.
19. CERTIFIED THAT THE PETROL PUMP IS NOT SITUATED IN THE AREA OF LAND TO BE LEASED FROM PWD FOR APPROVAL, BECAUSE SITES TO BE METALLED BY THE GOVT. OF INDIA AND IRC FROM TIME TO TIME WITH THE LOCATION OF ROAD SIDE FUEL FILLING STATIONS HAVE BEEN COMPLIED WITH ENTIRE CONSTRUCTION WILL BE ON CORPORATION LAND.
20. CERTIFIED THAT THE PETROL PUMP IS NOT SITUATED IN THE AREA OF LAND TO BE LEASED FROM PWD FOR APPROVAL, BECAUSE SITES TO BE METALLED BY THE GOVT. OF INDIA AND IRC FROM TIME TO TIME WITH THE LOCATION OF ROAD SIDE FUEL FILLING STATIONS HAVE BEEN COMPLIED WITH ENTIRE CONSTRUCTION WILL BE ON CORPORATION LAND.
21. CERTIFIED THAT THE PETROL PUMP IS NOT SITUATED IN THE AREA OF LAND TO BE LEASED FROM PWD FOR APPROVAL, BECAUSE SITES TO BE METALLED BY THE GOVT. OF INDIA AND IRC FROM TIME TO TIME WITH THE LOCATION OF ROAD SIDE FUEL FILLING STATIONS HAVE BEEN COMPLIED WITH ENTIRE CONSTRUCTION WILL BE ON CORPORATION LAND.
22. CERTIFIED THAT THE PETROL PUMP IS NOT SITUATED IN THE AREA OF LAND TO BE LEASED FROM PWD FOR APPROVAL, BECAUSE SITES TO BE METALLED BY THE GOVT. OF INDIA AND IRC FROM TIME TO TIME WITH THE LOCATION OF ROAD SIDE FUEL FILLING STATIONS HAVE BEEN COMPLIED WITH ENTIRE CONSTRUCTION WILL BE ON CORPORATION LAND.
23. CERTIFIED THAT THE PETROL PUMP IS NOT SITUATED IN THE AREA OF LAND TO BE LEASED FROM PWD FOR APPROVAL, BECAUSE SITES TO BE METALLED BY THE GOVT. OF INDIA AND IRC FROM TIME TO TIME WITH THE LOCATION OF ROAD SIDE FUEL FILLING STATIONS HAVE BEEN COMPLIED WITH ENTIRE CONSTRUCTION WILL BE ON CORPORATION LAND.
24. CERTIFIED THAT THE PETROL PUMP IS NOT SITUATED IN THE AREA OF LAND TO BE LEASED FROM PWD FOR APPROVAL, BECAUSE SITES TO BE METALLED BY THE GOVT. OF INDIA AND IRC FROM TIME TO TIME WITH THE LOCATION OF ROAD SIDE FUEL FILLING STATIONS HAVE BEEN COMPLIED WITH ENTIRE CONSTRUCTION WILL BE ON CORPORATION LAND.
25. 16/24X2 STEEL TANK HAS BEEN PARICATED AS PER DRG. APPROVED BY CCEO MASPIRA VIDE HIS LETTER NO. - P-6 6 OF DATED 6-01-2005
26. CERTIFIED THAT THE CANOPY MEASURING 10.0X15.00M CONFORM TO SOUND ENGINEERING SPECIFICATION

HINDUSTAN PETROLEUM CORPORATION LTD.
R/O
GURGAON

PROPOSED SITE & LAYOUT PLAN OF
RETAIL OUTLET ON BAYAL-GOLWA
ROAD (LINK ROAD) AT VILLAGE BAYY,
TEHSIL NANGAL CHAUDHARY,
DISTT. MAHENDERGARH (HARYANA)

