

NOTES:-

- THE VENT PIPES OF THE TANKS ARE 4 MTS ABOVE THE GROUND AND THEIR ENDS ARE COVERED 2 LAYERS OF BRASS WIRE GAUGE HAVING 11 MESH PER LINEAR CM.
- FILL POINTS 80 MM DIA. FITTED WITH CAM LOCK COUPLINGS AND AIR TIGHT THREADED BRASS CAP FOR DECANTING FROM TANK LORRY.
- ALL ELECTRICAL FITTINGS PROVIDED ARE FLAME PROOF CONFORMING TO I.S.-60079-1:2007.
- ALL THE DOORS AND WINDOWS OF THE BUILDINGS ARE PROVIDED TO OPEN OUTWARDS.
- DIP PIPE OF THE TANKS ARE WITH CAP ASSEMBLY.
- NO SEWER OR SURFACE DRAINS ARE WITHIN 6.0 M OF UNDERGROUND TANKS AND DUS.
- THE PREMISES TO BE USED FOR ONLY STORAGE OF PETROLEUM PRODUCTS.
- TANKS ARE PAINTED WITH 2 COATS OF BITUMINOUS PAINT OVER 2 COATS OF RED OXIDE PRIMER TO PROTECT CORROSIONS.
- FABRICATION DESIGN OF U/G STORAGE TANK ARE CONFORMING TO I.S.-10987:1998 AS PER CCE,NAGPUR APPROVAL NO. P-4(3)51, DT-04.05.2006.
- SAND BUCKETS AND FIRE EXTINGUISHERS ARE PROVIDED AS PER PATROLEUM RULES.
- TANK TESTING HAS BEEN DONE BY PROVIDING CONTROLLED PRESSURE OF 0.36KG/SQCM FOR 2 HOURS.
- DIP ROADS PROVIDED ARE 320 MM LONG.
- THICKNESS OF SHELL PLATES & END PLATES OF TANKS ARE SHELL 6 MM TH. & ENDS 8 MM TH.
- TANKS CONFORM TO CLAUSE 124,125 & 131 OF THE PETROLEUM RULES 2002.
- ALL LIGHT POLES FITTED AS PER APPROVAL OF CCE NAGPUR VIDE LETTER NO PL-III(MB) Dt 28/11/2003 ADEQUATE ARRANGEMENTS HAVE BEEN MADE FOR PROPER LIGHT AT THE PREMISES.
- NATURAL DOWN SLOPE FROM THE EDGE OF METALLIC ROAD TO CULVERT ON APPROACHES WILL BE MAINTAINED FREE FLOW OF WATER TOWARDS DRAINS.
- SITE MEETS APPLICABLE IRC 1983 NORMS WITH LATEST AMENDMENTS.
- THE PROPOSED SITE IS FREE FROM ANY TYPE OF LITIGATION, AND NO CASE IS PENDING IN ANY COURT OF LAW.
- NO HIGH TENSION LINE PASSES THROUGH THE PREMISES.
- TANKS ARE FED BY TANK LORRY ONLY.
- TANK CAPACITY OF 20KL = $3.14 \times (2.1/2)^2 \times 6.25 = 21.636$ LTS. LESS AIR CAPACITY=1636LTS ACTUAL PRODUCTS STORAGE CAPACITY =20000 LTS
- THE CONSTRUCTION OF RO AS PER IRC APPROVAL NO 12/83 AND IRC ARE BEING FOLLOWED.
- FLEX HOARDING WILL NOT BE USED. TIN BOARD HOARDING WILL BE USED FOR DISPLAY ADVERTISEMENT OR GOVT. SCHEMES.
- STEEL CANOPY APPROVAL NO. CCE G-40 (NC) P-CANOPY dt. 26.07.89.

TRAFFIC SIGNS:-

(IRC:67 AND IRC:SP:55)

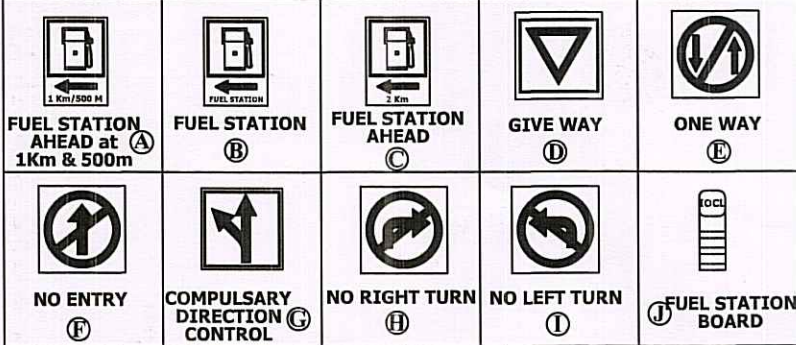

S.H. /M.D.R. / O.D.R. / NOTES:-

- ACCESS ROAD SHOULD HAVE MIN. PAVEMENT COMPOSITION OF 150mm THK. GSB, OVERLAID BY THREE LAYERS OF WBM, EACH OF 75mm THICKNESS (OTHER THAN WBM-GRADING NO. 1), TOPPED BY 50mm THK. BM & 25mm THK. SD8C.
- ALL PAVEMENT MARKING SHOULD BE AS PER LATEST IRC 35.
- ALL TRAFFIC SIGNS SHOULD BE AS PER LATEST IRC 67 & LATEST IRC SP-55. IN CASE OF A FUEL STATION LOCATED ON THE OTHER SIDE OF TRAVEL DIRECTION THE USER SHOULD BE INFORMED OF THE LOCATION OF THE FUEL STATION IN HIS/HER DIRECTION OF TRAVEL THROUGH INFORMATION SIGNS AS SHOWN IN THE TABLE OF THIS DRAWING.
- THE LENGTH OF SEPARATOR ISLAND SHOULD BE DETERMINED AS PER SITE CONDITION. ITS MINIMUM WIDTH SHOULD BE 3M.
- THE SEPARATOR ISLAND AND BUFFER STRIP SHALL BE TURFED WITH PROVISION OF 275MM HIGH KERBS.
- SLAB CULVERTS WITH GRATINGS TO BE PROVIDED IN THE LINE OF STORM WATER DRAIN ON ENTRY AND EXIT APPROACHES TO CATER TO THE EXPECTED DISCHARGE.
- ALL DIMENSION ARE IN METER UNLESS OTHERWISE SPECIFIED.

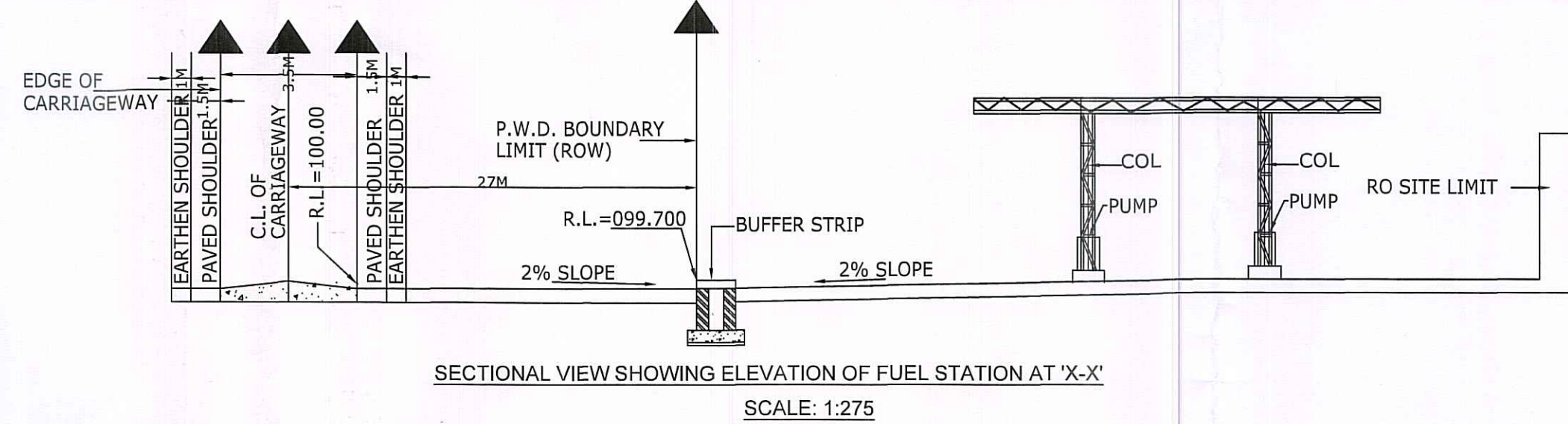

SECTIONAL VIEW SHOWING ELEVATION OF FUEL STATION AT 'X-X'
SCALE: 1:275

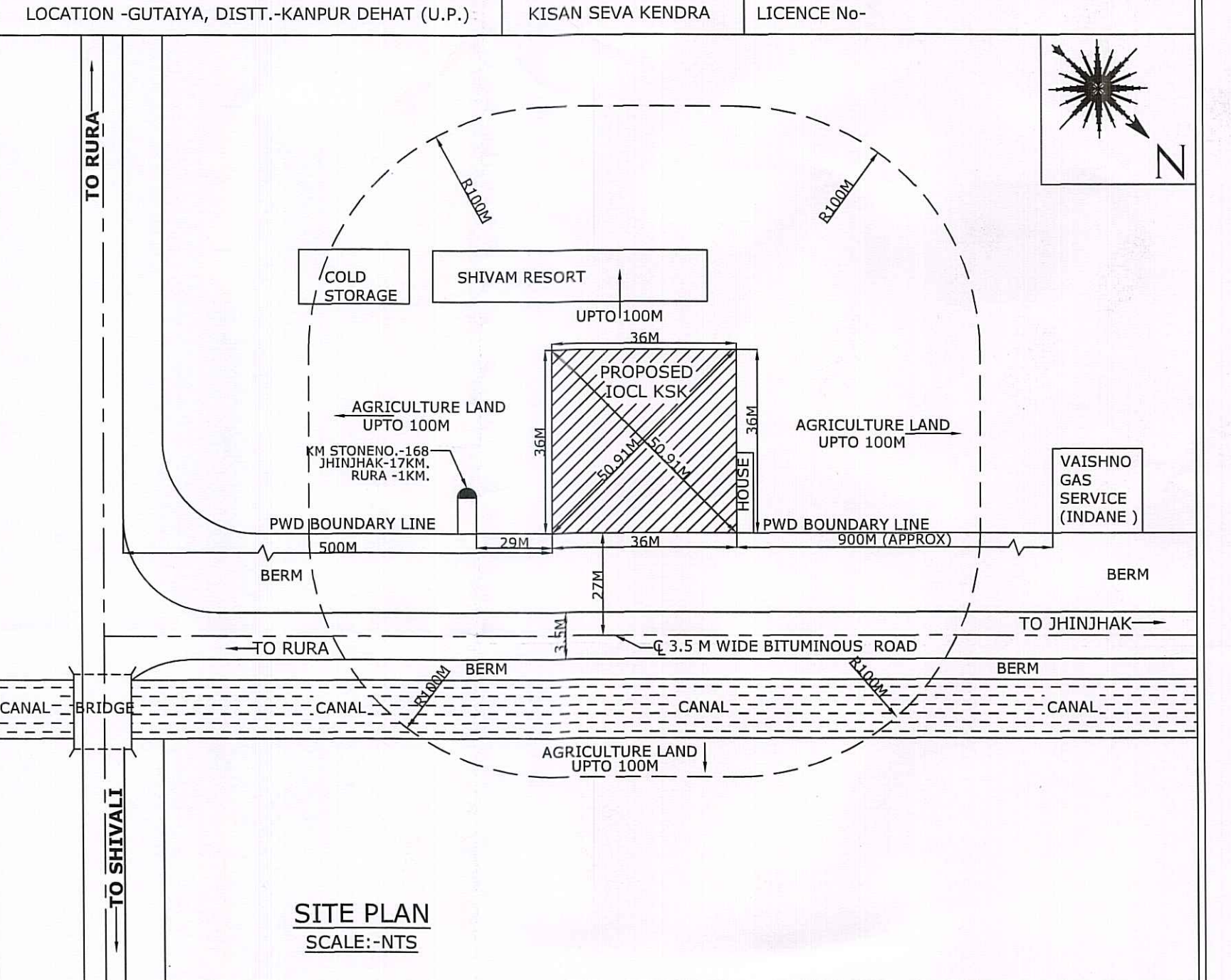

SITE PLAN
SCALE:-NTS

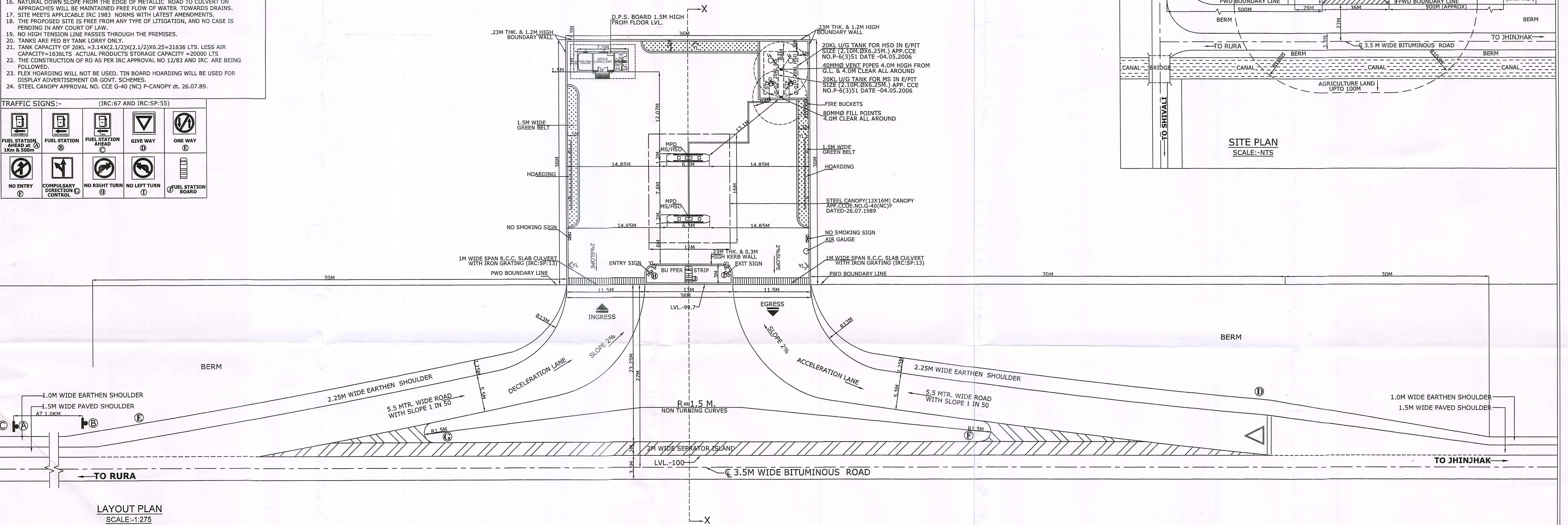

LAYOUT PLAN
SCALE:-1:275

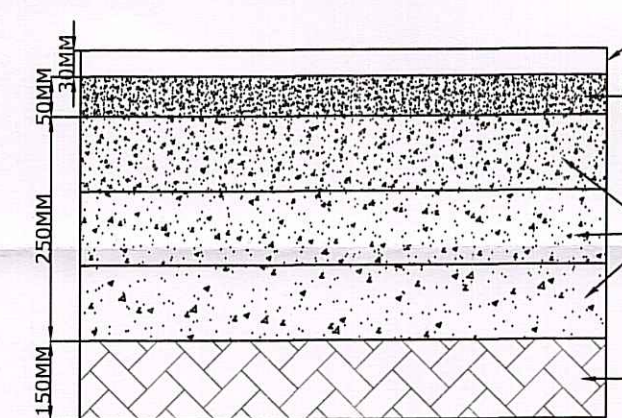

TYPICAL SECTION OF ACCESS ROAD

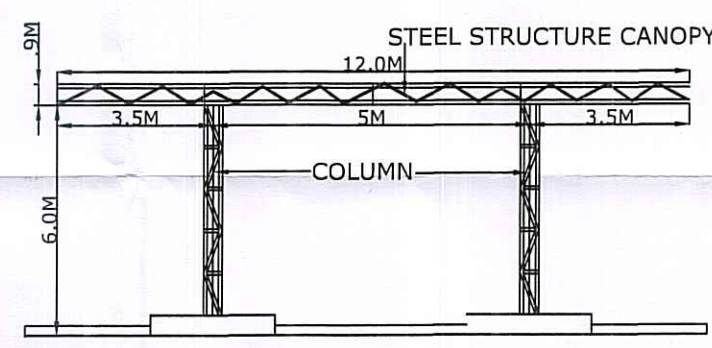

CANOPY SECTION

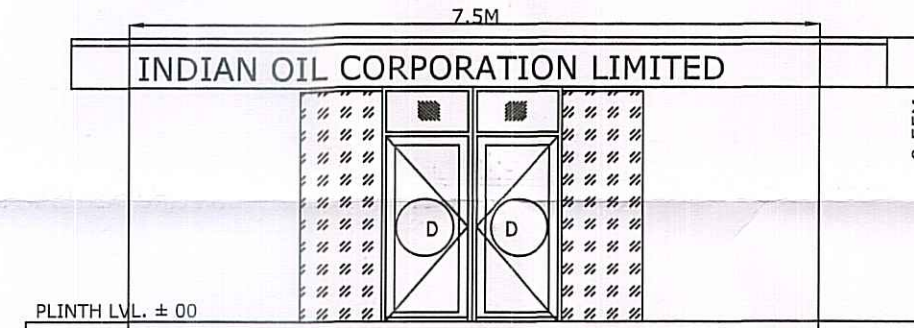

FRONT ELEVATION

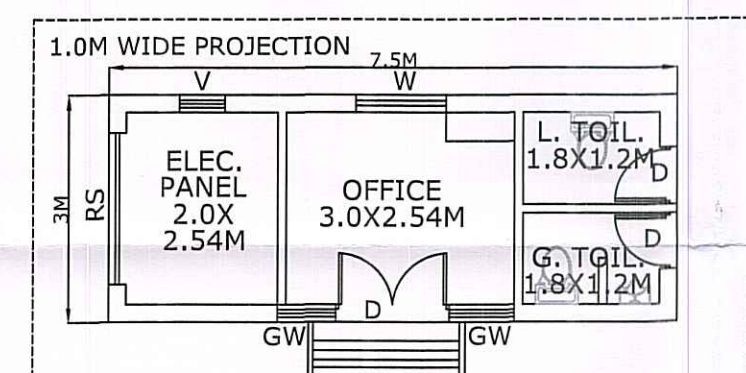

SALES BUILDING PLAN

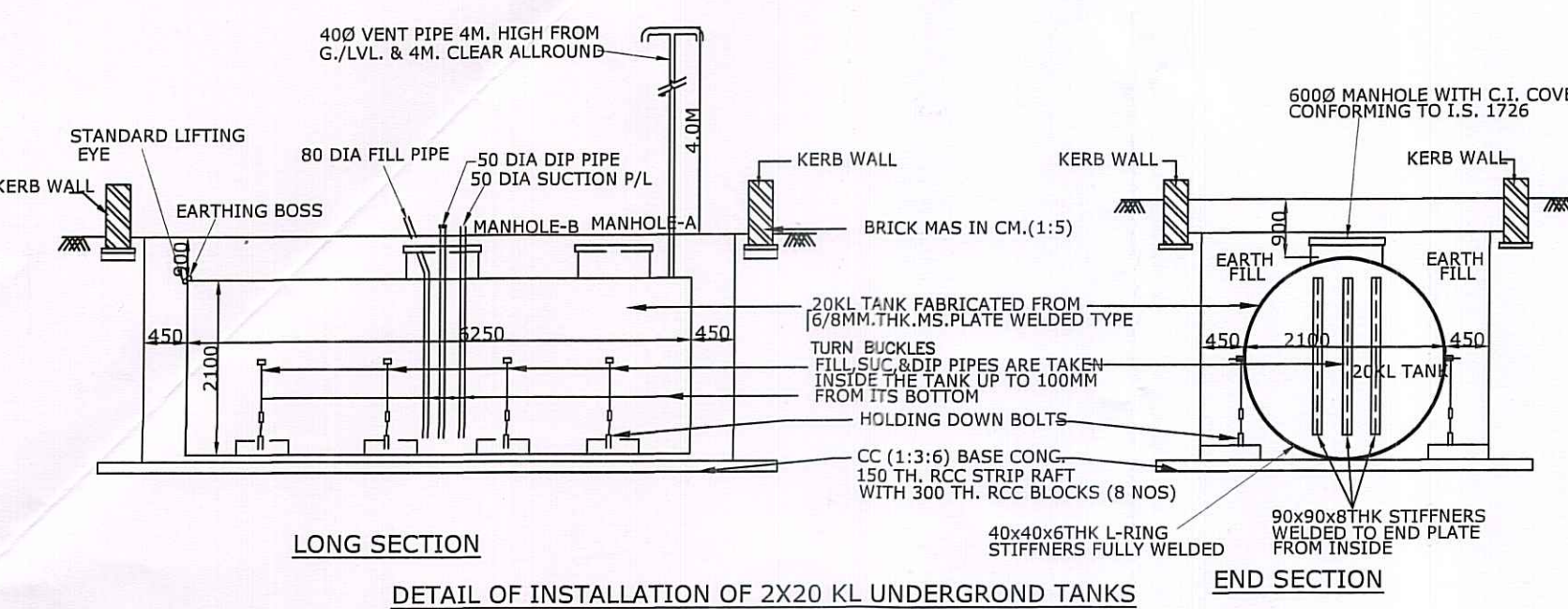

LONG SECTION
DETAIL OF INSTALLATION OF 2X20 KL UNDERGROUND TANKS IN EARTH PIT(SIZE 2.1M Ø X 6.25M LONG)

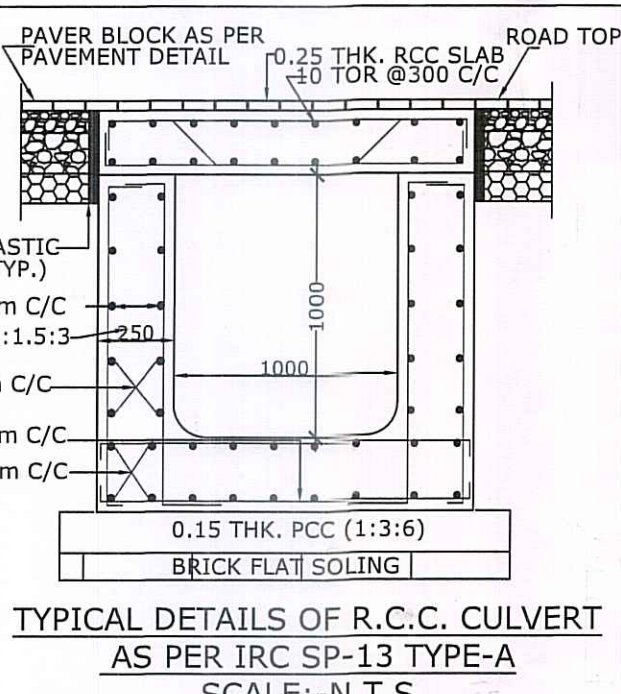

TYPICAL DETAILS OF R.C.C. CULVERT AS PER IRC SP-13 TYPE-A
SCALE:-N.T.S

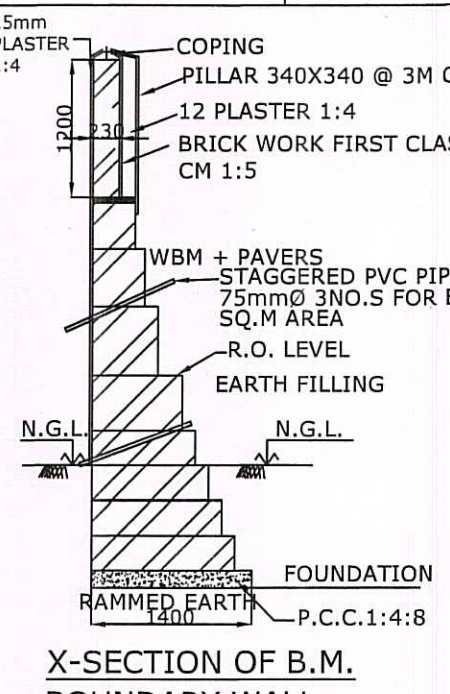

X-SECTION OF B.M. BOUNDARY WALL

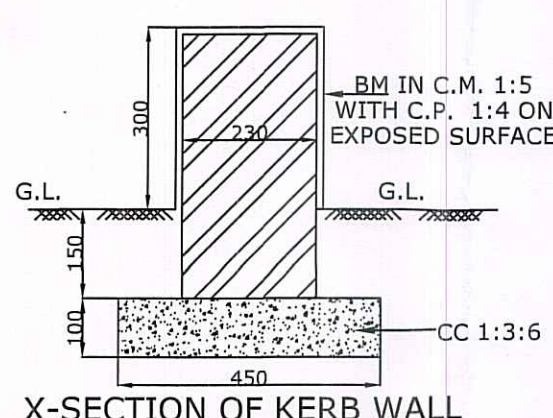

X-SECTION OF KERB WALL

SITE INFORMATION

VILLAGE	GUTAIYA
PHASRA/GATA/ARAZI/PLOT NO.	179
KHATONI NO.	
ROAD	RURA - JHINJHAK CANAL ROAD
BLOCK	AKBARPUR
TEHSIL	AKBARPUR
DISTRICT	KANPUR DEHAT
POLICE STATION	RURA
RAILWAY STATION	RURA
STATE	UTTAR PRADESH
PIN CODE	209303

AREA CHART:-

R.O. AREA = 1296 SQ.M.
BUILDING AREA = 22.5 SQ.M.
CANOPY AREA = 192 SQ.M.

TANK SCHEDULE :-

TANK NO.	PRODUCT	CAPACITY
1	MS	20KL
2	HSD	20KL

PUMP SCHEDULE :-

PRODUCT	NO.OF PUMP	NO.OF NOZZLE
MS	1	4
HSD	1	4

REV.NO.	DESCRIPTION	DATE	REV.BY	APP.BY
<div> INDIAN OIL CORPORATION LIMITED (MARKETING DIVISION) KANPUR DIVISIONAL OFFICE </div>				
TITLE		SITE & LAYOUT PLAN OF KSK		
PROJECT		PROPOSED KSK ON RURA-JHINJHAK CANAL ROAD, AT VILL.-GUTAIYA, TEHSIL- AKBARPUR, DISTT.- KANPUR DEHAT, STATE-UTTAR PRADESH.		
SCALE:1:275				
K.K.MISHRA		<div> </div>		
Drawn By		Mgr.(Engg.) Sr.Mgr.(R.S.) CDRSM		
DATE:- 30.10.2020		PREPARED BY:-		
DRG. NO:- SE/KDO/GUTAIYA/2607		<div> </div>		

SHUBHAM ENTERPRISES
NEW DELHI
PH. 25371428, 968611585