

LOCATION PLAN (NTS)

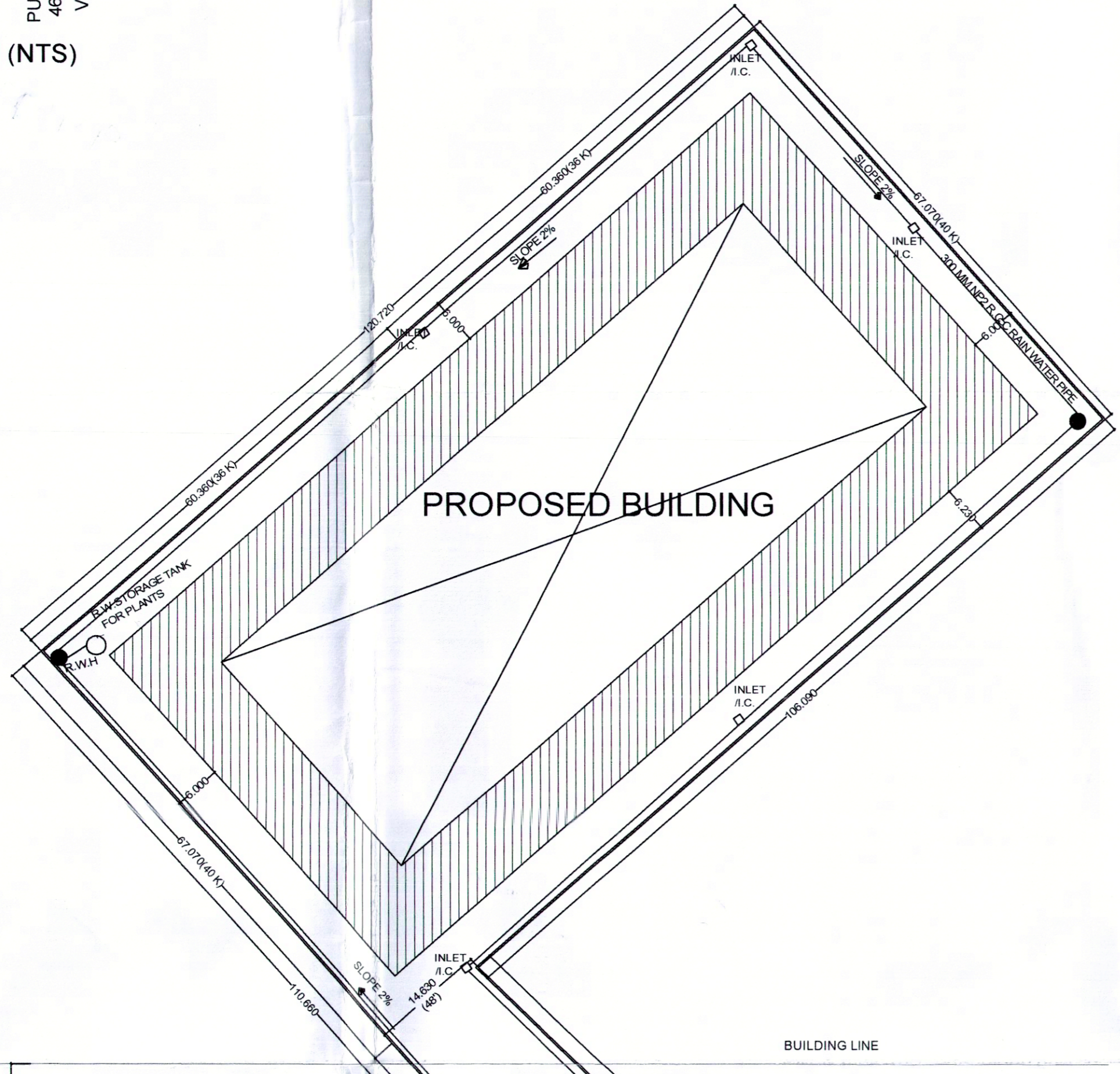

PROPOSED BUILDING

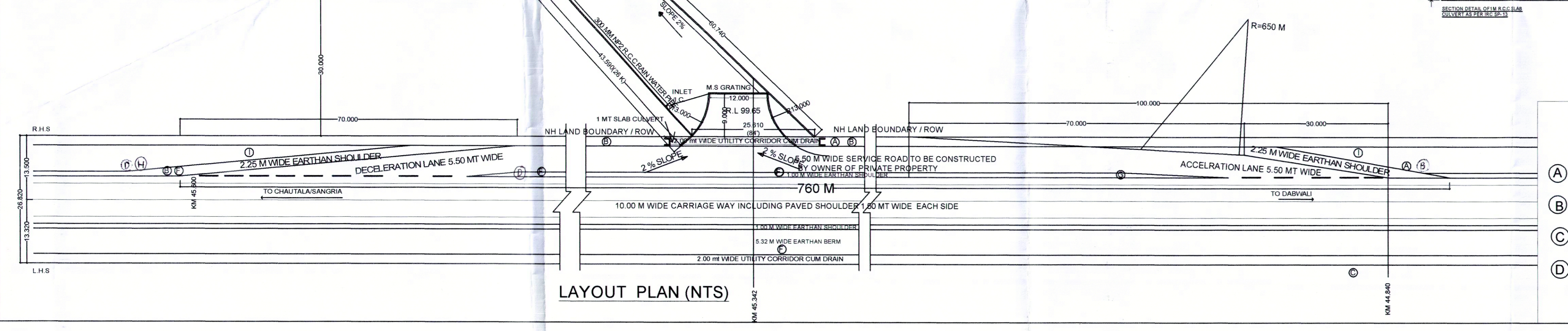

LAYOUT PLAN (NTS)

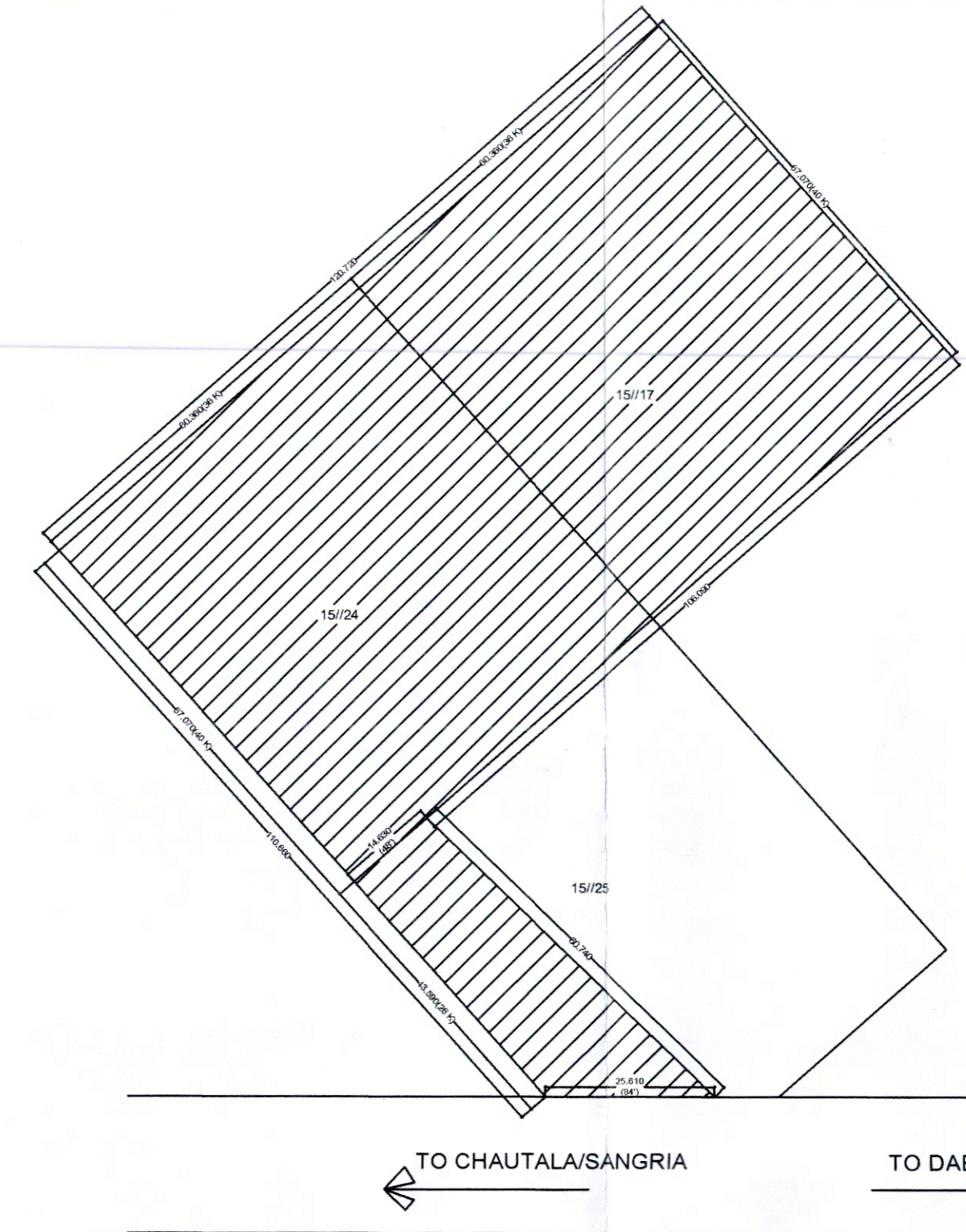

SITE PLAN

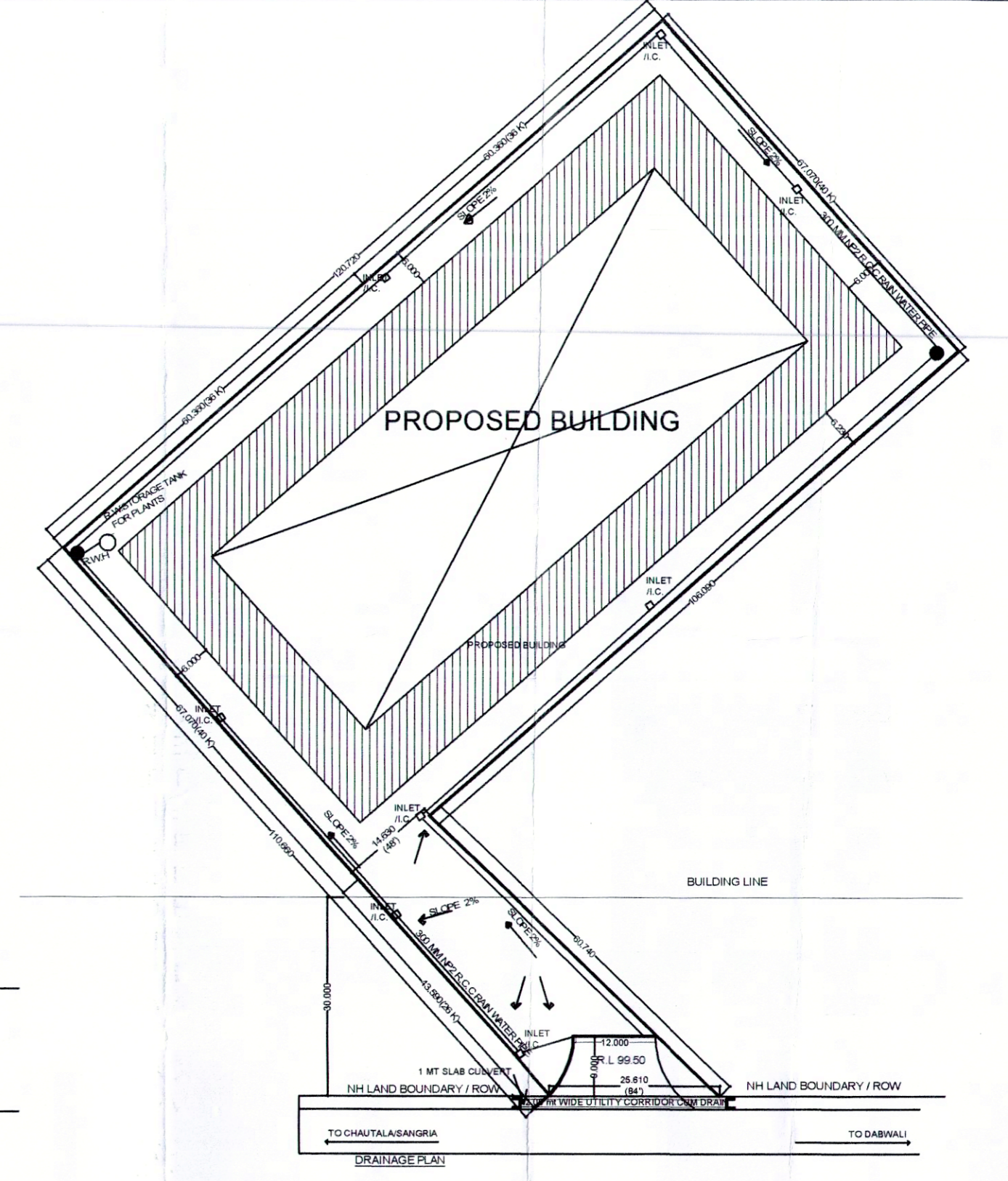

PROPOSED BUILDING

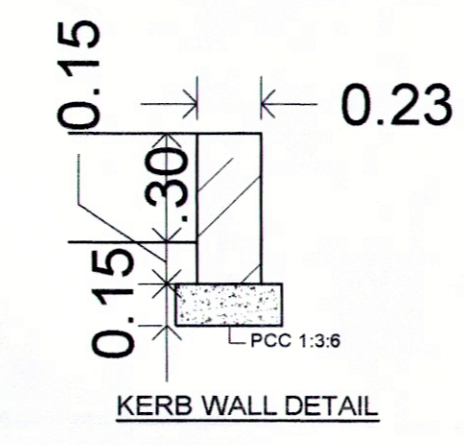

KERB WALL DETAIL

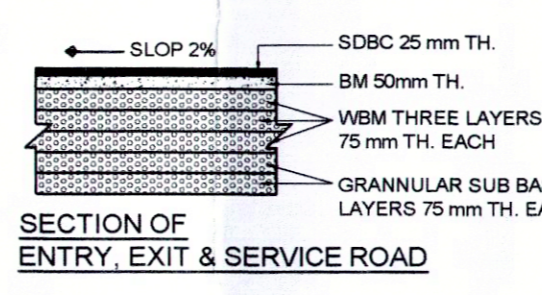

SECTION OF ENTRY, EXIT & SERVICE ROAD

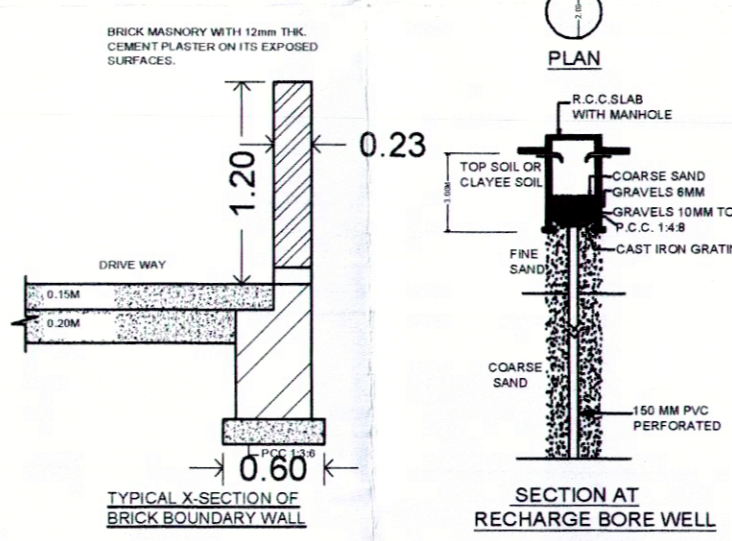

SECTION AT RECHARGE BORE WELL

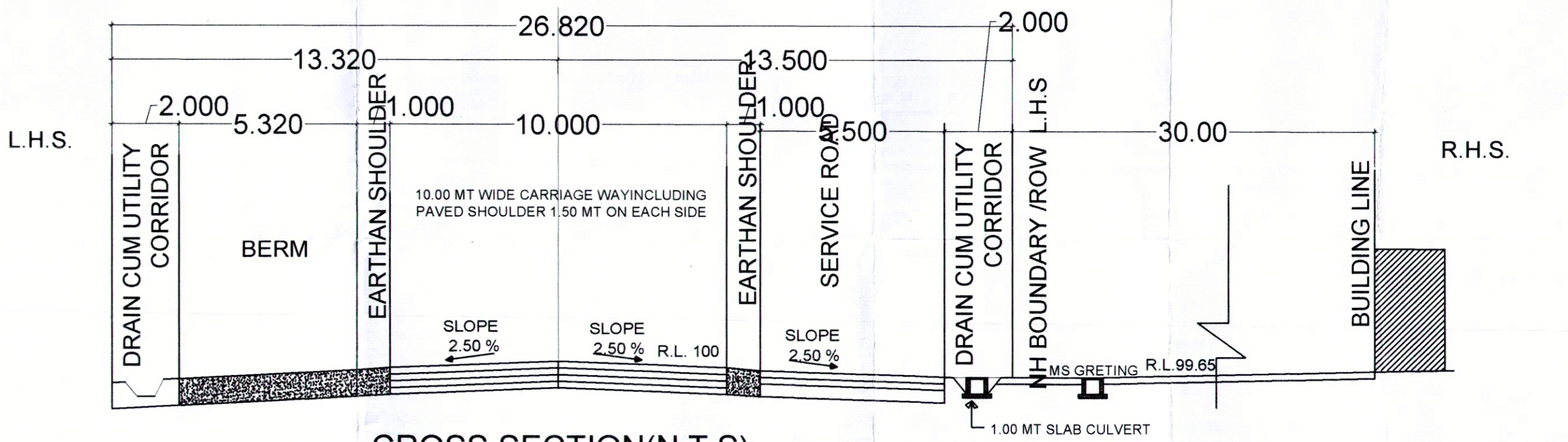

CROSS SECTION (N.T.S)

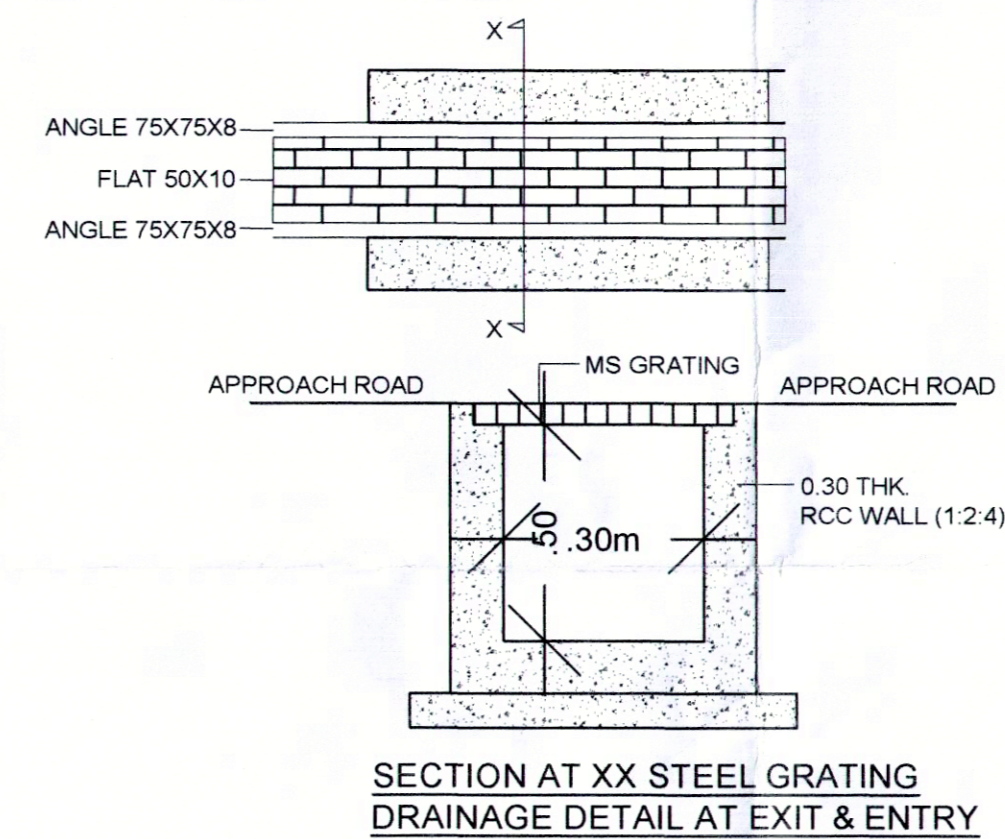

SECTION AT XX STEEL GRATING DRAINAGE DETAIL AT EXIT & ENTRY

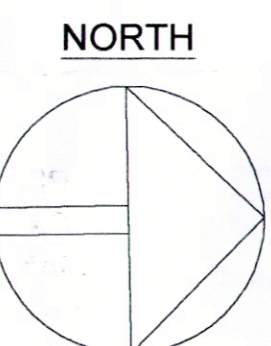

- CERTIFICATES / NOTES :-**
1. STORM WATER OF OUR BUILDING WILL NOT DISTURBS THE NH.
 2. 1.00 M WIDE SLAB CULVERT WILL BE PROVIDED BY US.
 3. LEVEL OF BUILDING WILL BE KEPT 2% SLOPE BELOW THE NH ROAD LEVEL.
 4. WE SHALL NOT DEMAND ANY GAP IN VERGE IN FRONT OF BUILDING.
 5. WE WILL NOT CONSTRUCT ANY PUCCA STRUCTURE WITH IN 30.0 M ON OUR LAND.
 6. THE MORTH INSTRUCTIONS SHALL NOT BE VIOLATED.
 7. CERTIFIED THAT ALL MORTH CONDITIONS HAVE BEEN SPECIFIED.
 8. CERTIFIED THAT WE WILL APPLY THE CASE FOR RENEWAL AFTER 5 YEARS FROM THE DATE OF ISSUE.
 9. WE WILL PAY THE NECESSARY RENT FOR THE USE OF NHAI LAND WHENEVER ASKED BY THE AUTHORITIES.
 10. 12.0 M WIDE ROAD FROM SERVICE ROAD WOULD BE CONSTRUCTED.

KHASRA NO 15/17,24,25 PART
 N.O.C FOR ACCESS PERMISSION TO PRIVATE PROPERTY MADAN MOHAN AGGARWAL PUBLIC SCHOOL DABWALI OWNED BY. BHAGWAN SHRI KRISHAN COLLEGE OF EDUCATION MANDI DABWALI SOCIETY AT NH 54 R.H.S KM 45.342 (DABWALI - CHAUTALA / SANGHARIA SECTION KM 4.422) AT VILLAGE SHERGARH TEHSIL DABWALI DISTRICT SIRSA (HR.)

LEGEND

- | | | | |
|-------------------|---|----------------------------------|---|
| (A) GIVE WAY | ▽ | (E) COMPULSORY DIRECTION CONTROL | ⊙ |
| (B) ONE WAY | ⊙ | (F) NO RIGHT TURN | ⊘ |
| (C) EATING PALACE | ⊙ | (G) NO LEFT TURN | ⊘ |
| (D) NO ENTRY | ⊙ | (H) SIDE ROAD | ⊘ |
| | | (I) NO PARKING | ⊘ |

<p>EMPANELLED CONSULTANT/ ARCHITECT</p> <p><i>S. G. Singh</i> President B.S.K. College of Education (for Women) Mandi Dabwali</p> <p>JAWANTRI ENGINEERS 888/5-4, OLD SUBZI MANDI, CHANDNI - 135003 (Dist. Yamuna Nagar)</p>	<p>OWNER'S</p> <p><i>S. K. Rajender</i> Project Director NHAI-PHJ, Sirsa</p>	<p>APPROVED BY</p> <p><i>S. K. Rajender</i> Project Director NHAI-PHJ, Sirsa</p>
---	---	---