

Himachal Pradesh
Public Works Department
No. SRDD-WA-D.O.F.L. /2022-
To

22019-20

Dated:- 18/11/2022

✓ The Divisional Forest Officer,
Shimla Forest Division,
Shimla, H.P

Subject:- Diversion of forest land 0.0442 ha. for the construction of link road from PHC Badhari Gurshalli to Village Dawath Km 0/0 to 1/500 with the jurisdiction of Shimla Forest Division Distt Shimla HP (online Proposal No FP/HP/Road/150852/2022.

Sir,

In this regard the reply of point No. 4 as per the observation raised by your office online on dated 29-09-2022. In this connection it is submitted that there is no violation in the present road/ Path. The said road/path was constructed during the year 1973-74 as per the revenue record (copy enclosed). At that time it was Mule road and some portion of this path the gradient is very steep and Ambulance/Jeep cannot be plying in this road and path need to improve the gradient to plying Ambulance and total length of this road is 1.500km . So the new alignment has been conducted in some reaches and the forest area 0.0442 hac. has been required.

As per para 4 DSS analysis report shows that 0.30ha. forest are is required but the PWD require total length of road i.e. 1.500 km and the area require 0.5250ha.

This is for your kind information and taking necessary action at your end please.

Encls:- As above.

Seeth
Executive Engineer,
Shimla Rural Division,
HP PWD, Dharni.

Copy to the Assistant Engineer, Sub-Division HPPWD Jutogh for information and necessary action w.r.t. his letter No. 1403 dated 17.11.2022.

Executive Engineer,
Shimla Rural Division,
HP.PWD, Dharni

09/08
रिपोर्ट

रिपोर्ट का जाला है कि माता गुड्डाबाई से दवाट
सड़क निर्माण हेतु माता दवाट का खण्ड नं 3
व गुड्डाबाई का खण्ड नं 4 को प्रस्तावित किया
गया है। माता दवाट के साविका आबलेख
जमावन्दी साख 1973-1974 का अवलोकन किया
गया पाया माता दवाट के हाल खण्ड नं 3 साविका
खण्ड नं 19 से बना है जिसकी किस्त गैर मुमकिन
रहता दर्ज साल कागजात है जोकि कसब माता पर
व कागजात में पत्रों चोड़ा मौजूद है। अतः रिपोर्ट
मांग करने पर जारा का गई।

21/09/2022

रिपोर्ट
माता दवाट
माता गुड्डाबाई

955 S. 2nd St.

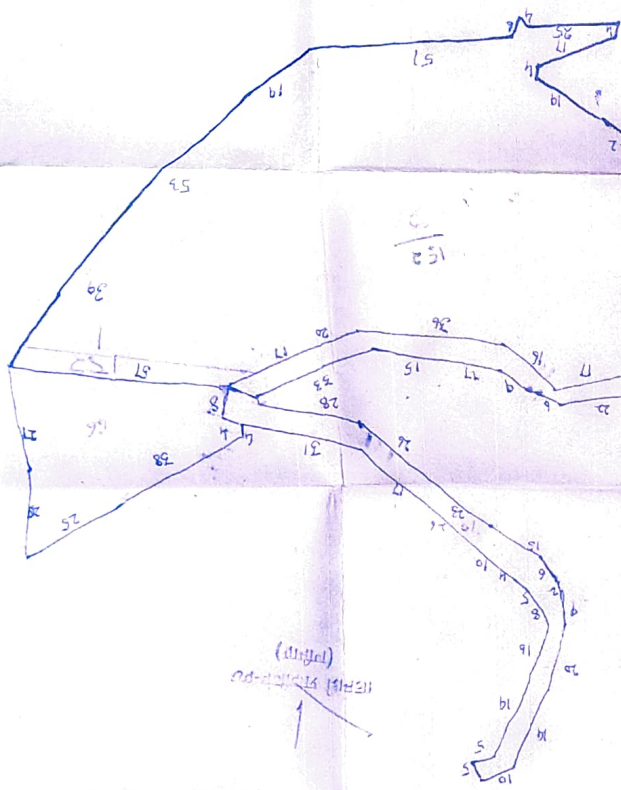

(dijet)

od-~~di~~ (1122)

↑

603001111

0803/1209/1207/12/1203/2/763/154/1210/1212/1240L

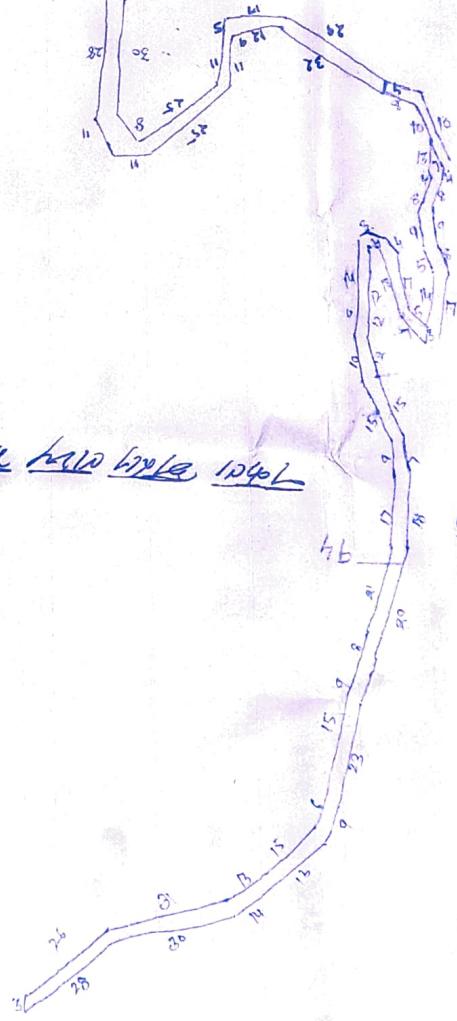

आनेस्टिक