

Chhattisgarh Forest Department

Forest Cover Map

Sheet. No. 64 L 12

Save Trees, Save Forests and Save Wildlife for the
Benefit of Self & the Nation

TOPOSHEET NO. 64 L 12

82°30'0"E

82°45'0"E

20°15'0"N

20°15'0"N



82°30'0"E

82°45'0"E

LEGEND

- | | |
|-----------------------------|-----------------------|
| TOWN / VILLAGE | Procted Area |
| Gp_Name | ROAD_TYPE |
| Non Forest | Cart Track |
| Forest_Route | Metalled Road |
| Connecting_OFC_Route | UnMetalled Road |
| Non Forest Area | chhattisgrah_2019.img |
| Forest_Area | Forest Cover |
| 10 Km Buffer | MDF |
| DIVISION REGION | NON FOREST |
| Railway Line | OPEN FOREST |
| Forest Range Boundary | SCRUB |
| Forest Compartment Boundary | VDF |
| | WATER |

1:50,000

0 0.5 1 2 3 4 Km

MAP PREPARED FOR:-

JCEO, Chhattishgarh Infotech Promotion Society CHIPS,
2nd Floor,SDC Building,
Civil Line, Raipur (C.G.)

REG.No. :- FP/CG/OFC/45530/2020

Diversion of forest land for non-forest purpose under Forest Conservation Act, 1980
Proposed for BharatNet Project Phase-II Udanti Seetanadi Tiger Reserve. Forest land
required for Optical Fiber Cable Laying work under BBNL for providing Broadband
Connectivity of Blocks to Gram Panchayats. Optical, Area- 9.589 ha.

Note :- Shapefile provided by user agencies.

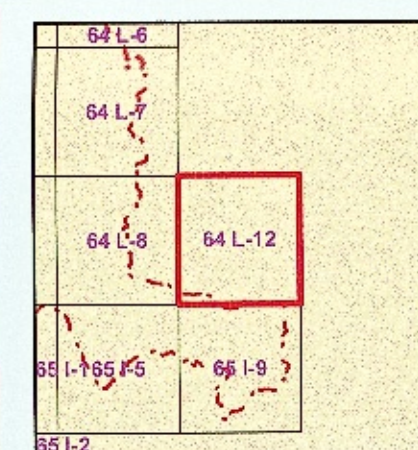

Sheet to Index

Data Source:- 1. Compartment Boundary from Stock Map
2. Forest Cover Based on Digital Interpretation of Data Period Oct 2017 to
Dec 2017 (LUS-III) from Resourcesat-2 and IRS-P6 (Resourcesat-0)
FSI Report 2018.
3. General Features are based on SSI Digital Data (Scale 1:50,000)
and Chhattisgarh GeoDatabase.

Source:- FOREST SURVEY OF INDIA FOREST COVER CLASSIFICATION SCHEME.
Very Dense Forest:- All land with tree cover (including Mangrove
cover) of canopy density of 70% and above.
Moderately Dense Forest:- All land with tree cover (including
Mangrove Cover) of canopy density between 40% and 70% above.
Open Forest:- All land with tree cover (including Mangrove Cover)
of canopy density between 10-40%.
Scrub:- All forest lands with poor tree growth mainly of small or
stunted trees having canopy density less than 10%.
Non Forest:- Any Area not included in the above classes.

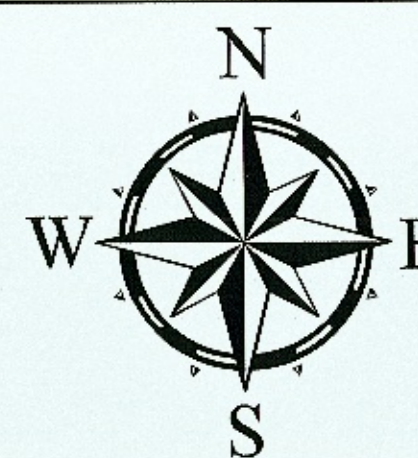

SCALE 1:50,000

NOT FOR EXPORT

TOPOSHEET NO. 64 L 12

Note(s):- Provisional Map
1. It is an indicative map showing distribution of vegetation.
2. Boundary of Brange Area have not been shown.
3. Validation of legal Forest Area with survey of India have not done.
4. If any difference occurs between vegetation and
stock map, stock map should be followed.
5. No survey should be performed on the basis of this map.

Disclaimer:- The Map provided is subject to inherent discrepancy
amongst layers associated with incompatibility between different
platforms of reference (LCC, WGS84 etc) and probable human
error angel in digitization. The user agency is advised to use the
features of map subject to prior authentication & supervision by the
authorized person of the concerned forest division. The FMS
division shall not be responsible for any complications (Legal or
otherwise), arising out of this maps.



Prepared and Printed by:- GTS Cell
Forest Management Information System Division, Raipur