

PROPOSED LAYOUT PLAN FOR KUPVI TEHSIL BUILDING CHOPAL DISTT. SHIMLA (H.P.)

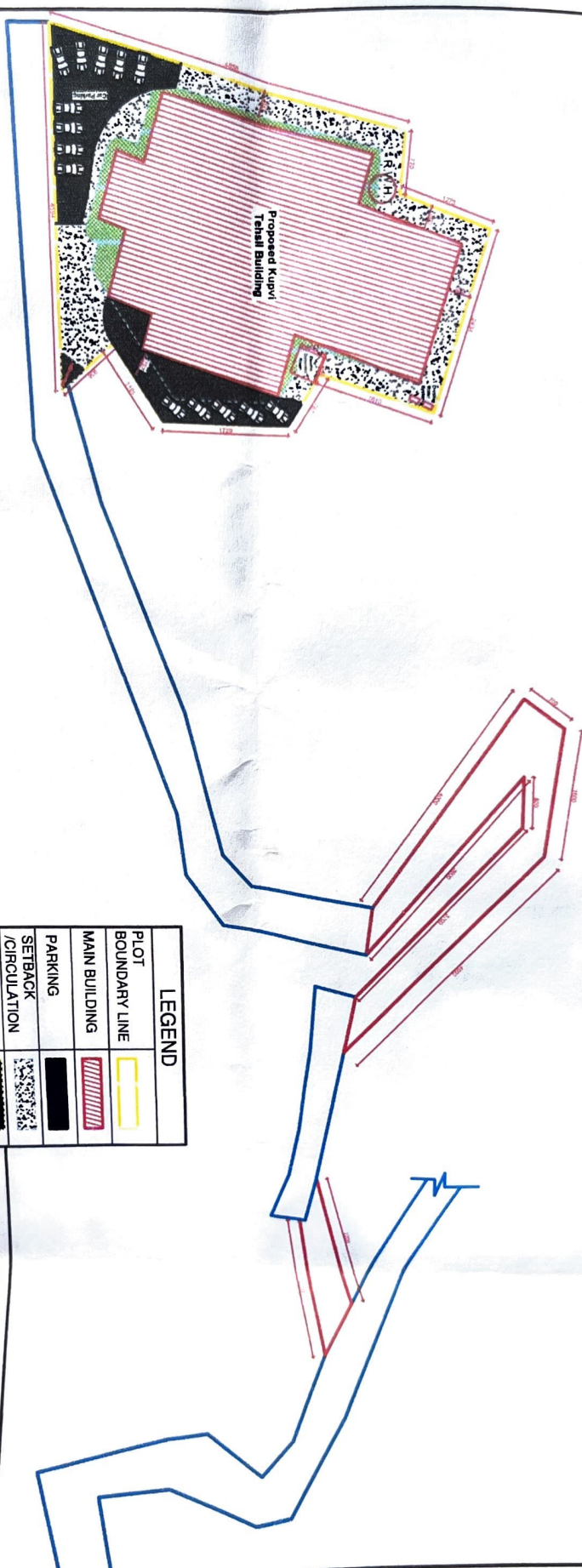

PROJECT :-
PROPOSED LAYOUT PLAN FOR
KUPVI TEHSIL BUILDING CHOPAL
DISTT. SHIMLA (H.P.)

NOTES	Area Statement	Road Area Statement
ALL DIMENSIONS ARE IN (CM.)	PROPOSED BUILDING AREA - 1174.03 SQ.MT.	APPROACH ROAD AREA - 68.20 SQ.MT.
Scale - NIS	GAZ PARKING AREA - 27.40 SQ.MT.	
DIN no. - 01	ELECTRIC GENERATOR AREA - 13.00 SQ.MT.	
CONCEPT DRAWING	R.W.I.Y AREA - 340.00 SQ.MT.	
SITE PLAN	FOREST AREA - 658.00 SQ.MT.	
	MAIN ENTRY AREA - 8.41 SQ.MT.	
	TOTAL AREA - 2147 SQ.MT.	

LEGEND	
PLLOT BOUNDARY LINE	
MAIN BUILDING	
PARKING	
SETBACK /CIRCULATION	
MAIN ENTRY	
APPROACH ROAD (FOREST AREA)	

VASTUKAR & ASSOCIATES
 ARCHITECTS ENGINEERS ESTIMATORS
 LANDSCAPERS INTERIOR DESIGNER
 CONTRACTOR & CONSULTANTS

N.S.D.
Naib-Tehsildar
 Kupvi, Tehsil Kupvi
 Distt. Shimla H.P.

Ashwini
Deputy Conservator of Forests
 Chopal Forest Division

Name
 C/o Road Faridaha Nalla
 Nallah to 3/270
 0/000 to 3/270
 K.P.