

**MAP SHOWING GEO-REFERENCED ZOOM VIEW DIGITAL MAP WITH PROPOSED ROAD ALIGNMENT AND REQUIRED FOREST LAND (Segment-29 to 32) Kasganj District**  
 Name of Project : Improvement and up-gradation of National Highway 530B from Mathura (NH-44) to Bareilly (NH-30) in the State of Uttar Pradesh (Package-II from Km. 66/000 to 123/100 Km, Under District -Hathras, Kasganj and Etah).  
 Proposal No. : FP/UP/ROAD/144204/2021 (Applied Area : 100.2396 Hectare)

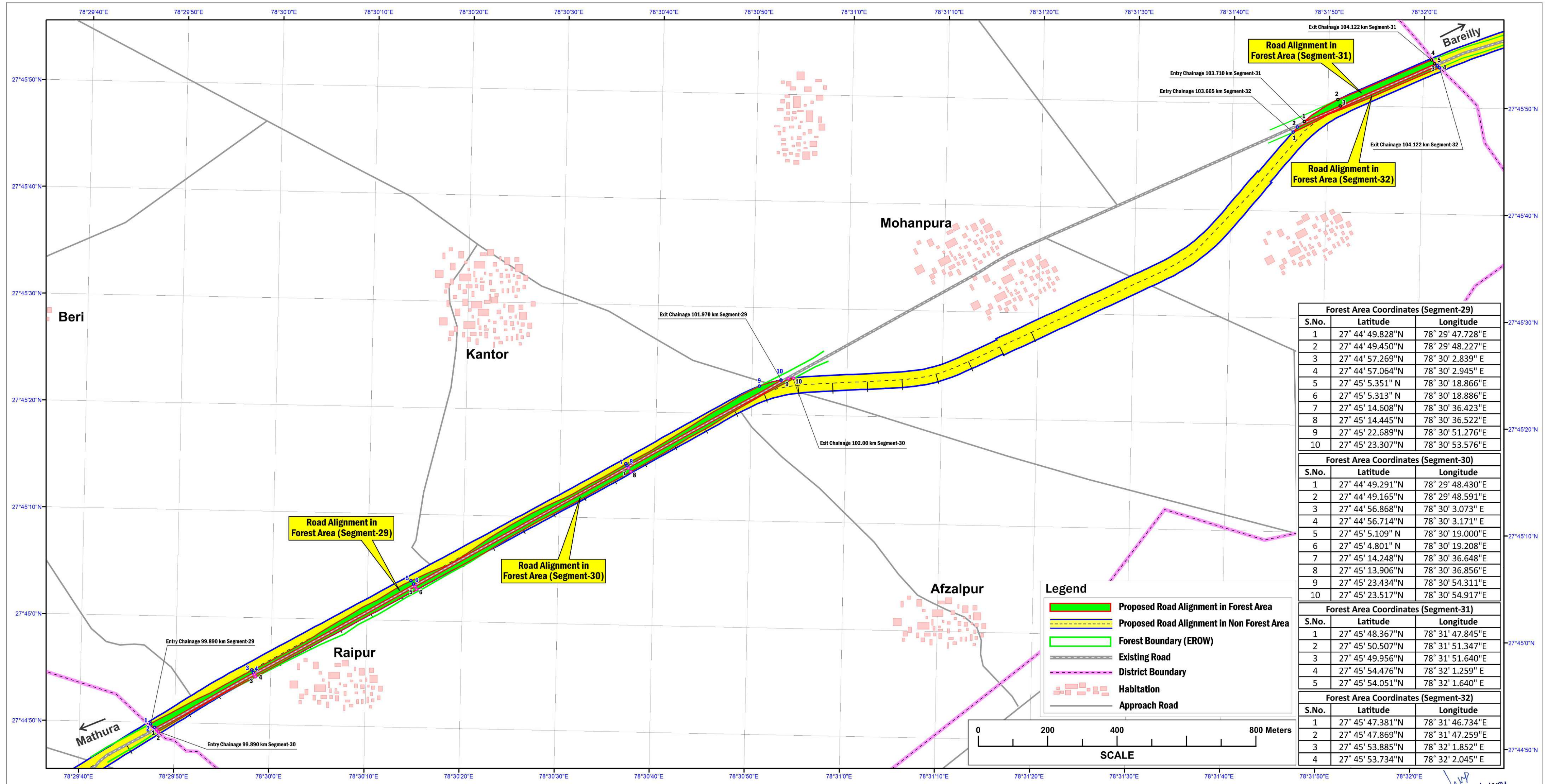

Forest Area Coordinates (Segment-29)		
S.No.	Latitude	Longitude
1	27° 44' 49.828"N	78° 29' 47.728"E
2	27° 44' 49.450"N	78° 29' 48.227"E
3	27° 44' 57.269"N	78° 30' 2.839" E
4	27° 44' 57.064"N	78° 30' 2.945" E
5	27° 45' 5.351" N	78° 30' 18.866"E
6	27° 45' 5.313" N	78° 30' 18.886"E
7	27° 45' 14.608"N	78° 30' 36.423"E
8	27° 45' 14.445"N	78° 30' 36.522"E
9	27° 45' 22.689"N	78° 30' 51.276"E
10	27° 45' 23.307"N	78° 30' 53.576"E

Forest Area Coordinates (Segment-30)		
S.No.	Latitude	Longitude
1	27° 44' 49.291"N	78° 29' 48.430"E
2	27° 44' 49.165"N	78° 29' 48.591"E
3	27° 44' 56.868"N	78° 30' 3.073" E
4	27° 44' 56.714"N	78° 30' 3.171" E
5	27° 45' 5.109" N	78° 30' 19.000"E
6	27° 45' 4.801" N	78° 30' 19.208"E
7	27° 45' 14.248"N	78° 30' 36.648"E
8	27° 45' 13.906"N	78° 30' 36.856"E
9	27° 45' 23.434"N	78° 30' 54.311"E
10	27° 45' 23.517"N	78° 30' 54.917"E

Forest Area Coordinates (Segment-31)		
S.No.	Latitude	Longitude
1	27° 45' 48.367"N	78° 31' 47.845"E
2	27° 45' 50.507"N	78° 31' 51.347"E
3	27° 45' 49.956"N	78° 31' 51.640"E
4	27° 45' 54.476"N	78° 32' 1.259" E
5	27° 45' 54.051"N	78° 32' 1.640" E

Forest Area Coordinates (Segment-32)		
S.No.	Latitude	Longitude
1	27° 45' 47.381"N	78° 31' 46.734"E
2	27° 45' 47.869"N	78° 31' 47.259"E
3	27° 45' 53.885"N	78° 32' 1.852" E
4	27° 45' 53.734"N	78° 32' 2.045" E

**Legend**

- Proposed Road Alignment in Forest Area
- Proposed Road Alignment in Non Forest Area
- Forest Boundary (EROW)
- Existing Road
- - - District Boundary
- Habitation
- Approach Road

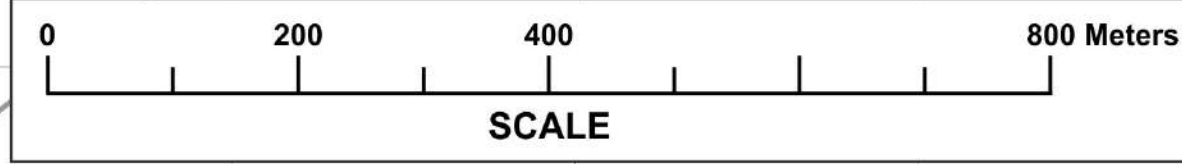

*Sanjay Verma*  
25/10/2021

**MAP SHOWING GEO-REFERENCED ZOOM VIEW DIGITAL MAP WITH PROPOSED ROAD ALIGNMENT AND REQUIRED FOREST LAND (Segment-35 and 36) Kasganj District**  
 Name of Project : Improvement and up-gradation of National Highway 530B from Mathura (NH-44) to Bareilly (NH-30) in the State of Uttar Pradesh (Package-II from Km. 66/000 to 123/100 Km, Under District -Hathras, Kasganj and Etah).  
 Proposal No. : FP/UP/ROAD/144204/2021 (Applied Area : 100.2396 Hectare)

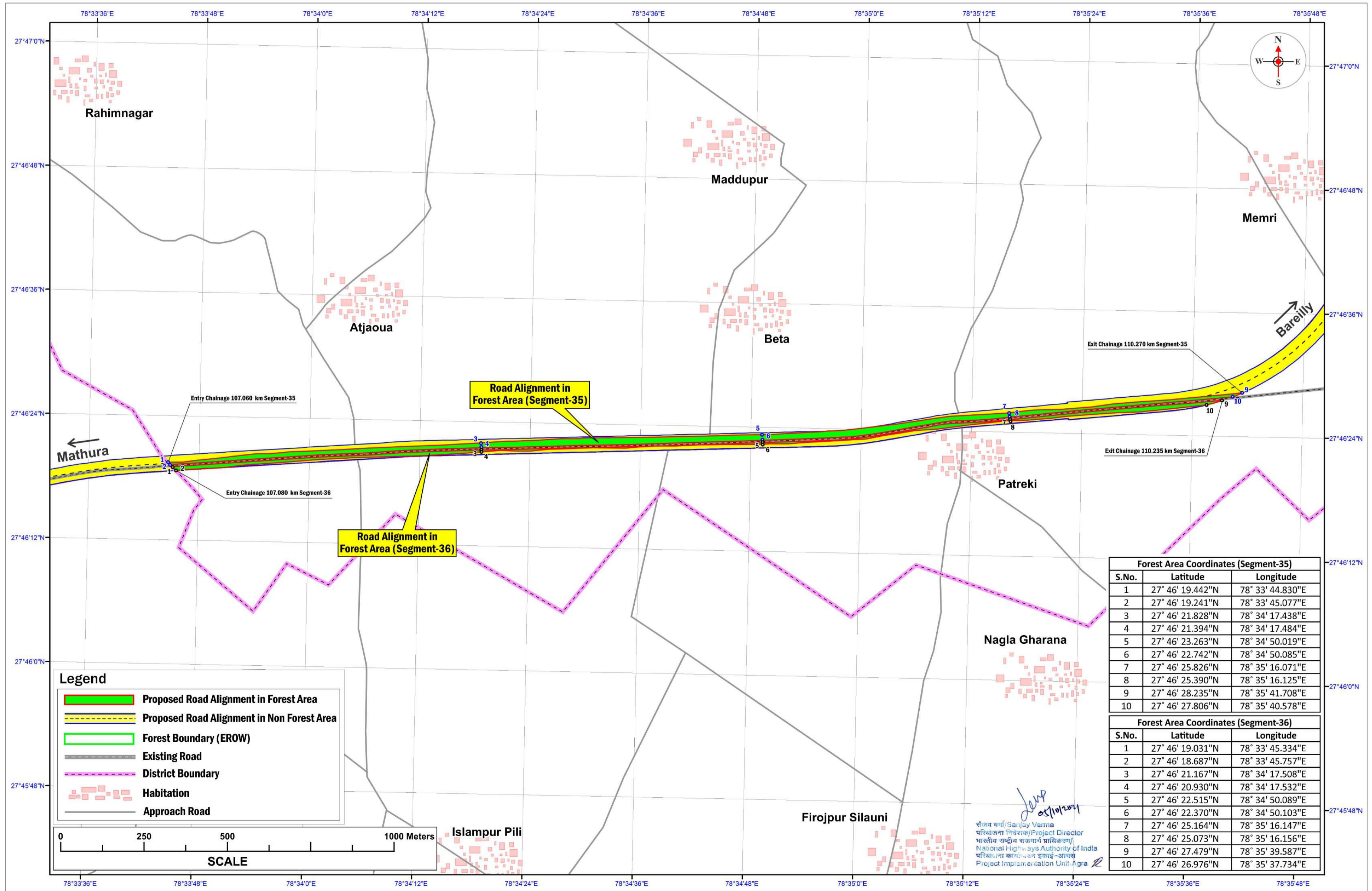

Forest Area Coordinates (Segment-35)		
S.No.	Latitude	Longitude
1	27° 46' 19.442"N	78° 33' 44.830"E
2	27° 46' 19.241"N	78° 33' 45.077"E
3	27° 46' 21.828"N	78° 34' 17.438"E
4	27° 46' 21.394"N	78° 34' 17.484"E
5	27° 46' 23.263"N	78° 34' 50.019"E
6	27° 46' 22.742"N	78° 34' 50.085"E
7	27° 46' 25.826"N	78° 35' 16.071"E
8	27° 46' 25.390"N	78° 35' 16.125"E
9	27° 46' 28.235"N	78° 35' 41.708"E
10	27° 46' 27.806"N	78° 35' 40.578"E

Forest Area Coordinates (Segment-36)		
S.No.	Latitude	Longitude
1	27° 46' 19.031"N	78° 33' 45.334"E
2	27° 46' 18.687"N	78° 33' 45.757"E
3	27° 46' 21.167"N	78° 34' 17.508"E
4	27° 46' 20.930"N	78° 34' 17.532"E
5	27° 46' 22.515"N	78° 34' 50.089"E
6	27° 46' 22.370"N	78° 34' 50.103"E
7	27° 46' 25.164"N	78° 35' 16.147"E
8	27° 46' 25.073"N	78° 35' 16.156"E
9	27° 46' 27.479"N	78° 35' 39.587"E
10	27° 46' 26.976"N	78° 35' 37.734"E

**Legend**

- Proposed Road Alignment in Forest Area
- Proposed Road Alignment in Non Forest Area
- Forest Boundary (EROW)
- Existing Road
- District Boundary
- Habitation
- Approach Road

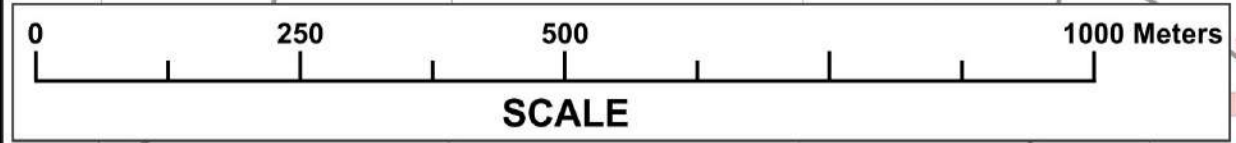

संजय वर्मा/Sanjay Verma  
 परियोजना निदेशक/Project Director  
 भारतीय राष्ट्रीय राजमार्ग प्राधिकरण/  
 National Highways Authority of India  
 परियोजना कार्यालय इकाई-आगरा  
 Project Implementation Unit-Agra

# MAP SHOWING GEO-REFERENCED ZOOM VIEW DIGITAL MAP WITH PROPOSED ROAD ALIGNMENT AND REQUIRED FOREST LAND (Segment-37 to 39) Kasganj District

Name of Project : Improvement and up-gradation of National Highway 530B from Mathura (NH-44) to Bareilly (NH-30) in the State of Uttar Pradesh (Package-II from Km. 66/000 to 123/100 Km, Under District -Hathras, Kasganj and Etah).

Proposal No. : FP/UP/ROAD/144204/2021 (Applied Area : 100.2396 Hectare)

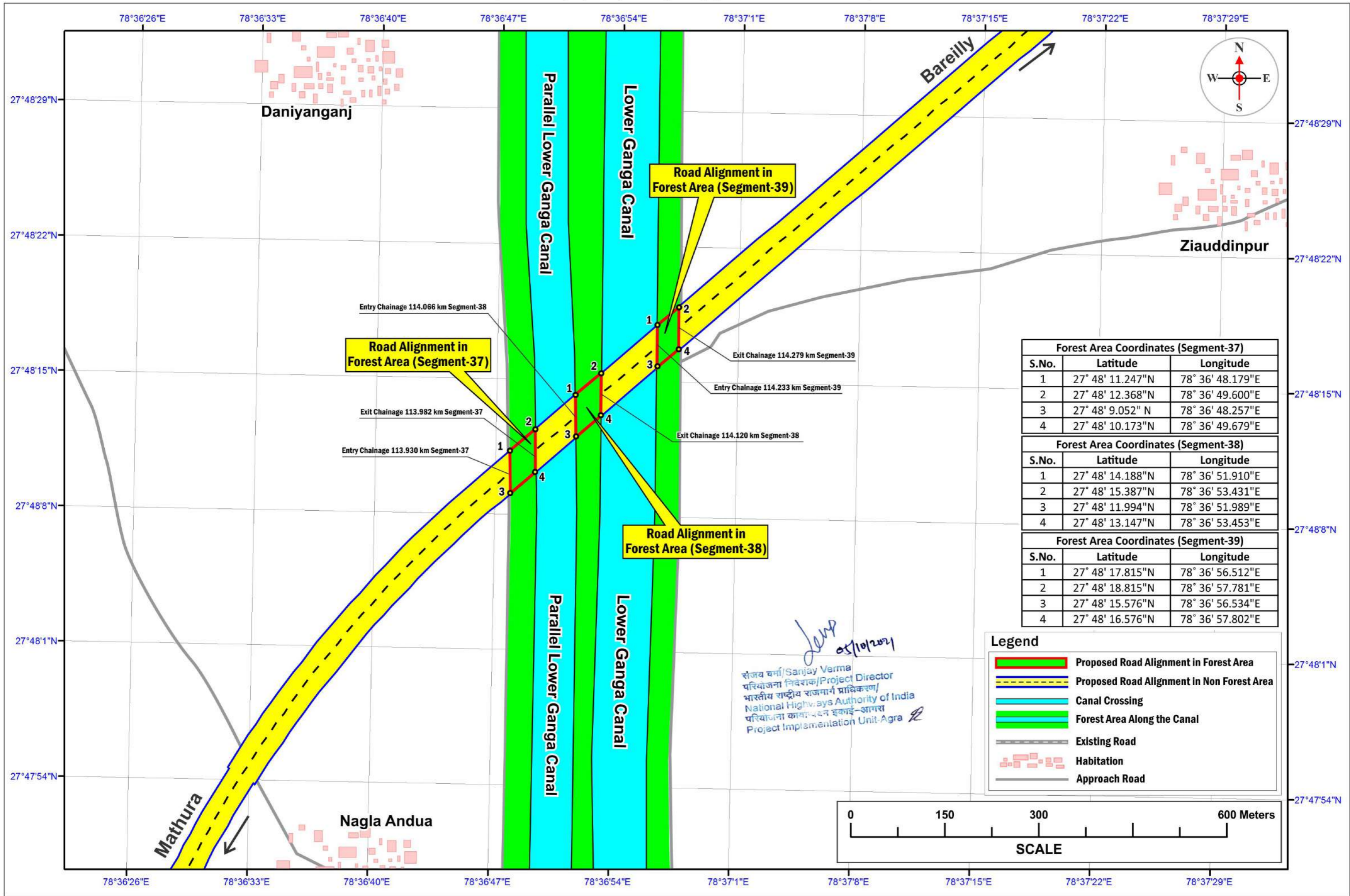

# MAP SHOWING GEO-REFERENCED ZOOM VIEW DIGITAL MAP WITH PROPOSED ROAD ALIGNMENT AND REQUIRED FOREST LAND (Segment-40) Kasganj District

Name of Project : Improvement and up-gradation of National Highway 530B from Mathura (NH-44) to Bareilly (NH-30) in the State of Uttar Pradesh (Package-II from Km. 66/000 to 123/100 Km, Under District -Hathras, Kasganj and Etah).

Proposal No. : FP/UP/ROAD/144204/2021 (Applied Area : 100.2396 Hectare)

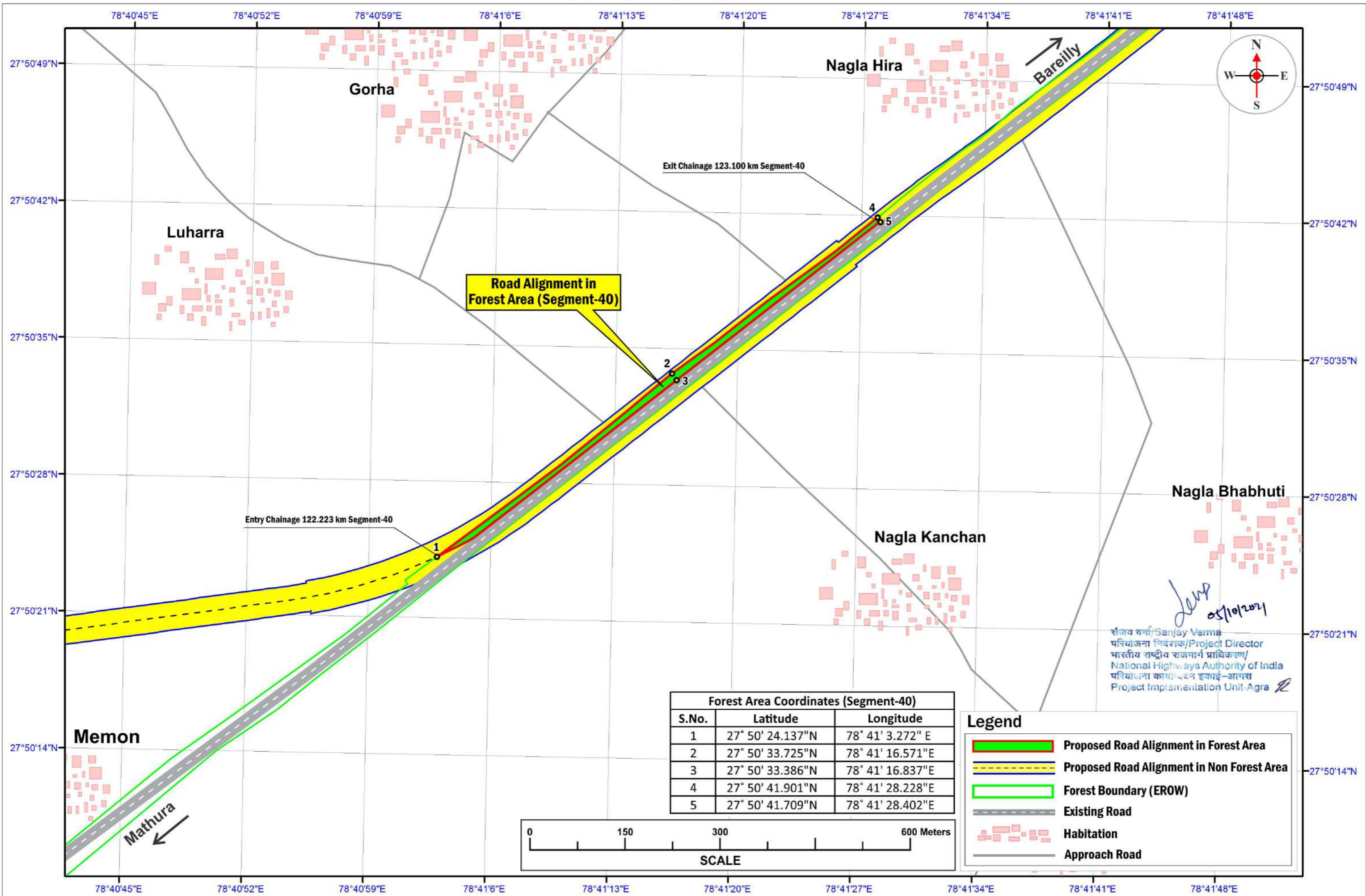

**Road Alignment in Forest Area (Segment-40)**

Exit Chainage 123.100 km Segment-40

Entry Chainage 122.223 km Segment-40

Forest Area Coordinates (Segment-40)		
S.No.	Latitude	Longitude
1	27° 50' 24.137"N	78° 41' 3.272" E
2	27° 50' 33.725"N	78° 41' 16.571"E
3	27° 50' 33.386"N	78° 41' 16.837"E
4	27° 50' 41.901"N	78° 41' 28.228"E
5	27° 50' 41.709"N	78° 41' 28.402"E

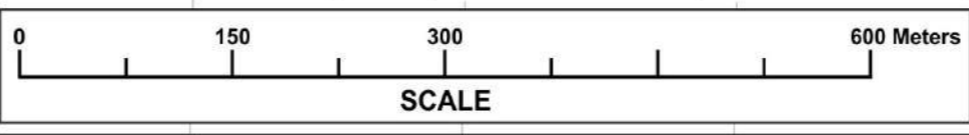

**Legend**

- Proposed Road Alignment in Forest Area
- Proposed Road Alignment in Non Forest Area
- Forest Boundary (EROW)
- Existing Road
- Habitation
- Approach Road

*Sanjay Verma*  
 संजय वर्मा/Sanjay Verma  
 परियोजना निदेशक/Project Director  
 भारतीय राष्ट्रीय राजमार्ग प्राधिकरण/  
 National Highways Authority of India  
 परियोजना कार्यान्वयन इकाई-आगरा  
 Project Implementation Unit-Agra