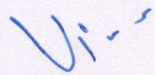

**ESTIMATE FOR CONSTRUCTION OF BOUNDARY Wall BLOCK FOREST KHANAK in
Bhiwani Division YEAR 2021-22**

Sr. No.	PWD. Item No.	Description	No.	L	B	H	Quantity	
1	4.14.1	Earth work in excavation in by mechanical means (Hydraulic excavator)/manual means in foundtion trenches. All kinds of soil.	1	832	0.9	0.9	673.92	Cum
							Total	673.92 Cum
2	6.1.7	Providing and laying in position cement concrete of specified grade excluding the cost of centering and shuttering with 1:5:10 cement concrete.	1	832	0.9	0.15	112.32	Cum
							Total	112.32 Cum
3	7.21.1	Bricks works with common burnt clay non-modular bricks of class designation 7.5 in foundation and plinth in: cement mortar 1:4						
		1 st Step	1	579.0	0.57	0.15	49.50	cum
		2 nd Step	1	579.0	0.45	0.15	39.08	cum
		3 rd Step	1	579.0	0.34	0.15	29.53	cum
		4th Step	1	579.0	0.23	0.45	59.93	cum
							Total	178.04 cum
4	6.14.1	Providing and laying in position specified grade of reinforced cement and concrete, excluding the cost of centering with C.Conc. 1:1.5:3, 20mm nominal size.						
		1 st Step	253	0.23	0.57	0.15	4.98	cum
		2 nd Step	253	0.23	0.45	0.15	3.93	cum
		3 rd Step	253	0.23	0.34	0.15	2.97	cum
		4th Step	253	0.23	0.23	0.45	6.02	cum
							Total	17.89 cum
	6.15.1	Reinforced cement concrete works in wall ,including attached pilasters buttresses, plinth and string courses with C.Conc. 1:1.5:3, 20mm nominal size.						
		Beam on Boundary Wall at plinh level	1	832	0.23	0.23	44.01	cum
							Total	44.01 Cum
6	6.33.3	Steel reinforced for RCC works where not including in the complete rate of RCC, Cold twisted bars						
		Take Same Area item No. 6.14+6.15+6.16+6.15.1 9.97+24.49+16.41+24.49+17.89+44.02 + 29.45+44.02	135.38*1.10			Or	148.92 148.92	Qtl
					say			
							Total	148.92 Qtl
7	6.16	Reinforced cement and concrete works in beams , suspended floors , roofs havind slope up to 15* landing , balconies , shelves.	253	0.23	0.23	2.2	29.44	cum
							Total	29.44 Cum

8	6.15.1	Reinforced cement concrete works in wall, including attached pilasters buttresses, plinth and string courses with C.Conc 1:1.5:3, 20mm nominal size.	1	832	0.23	0.23	44.01	cum
			Total				44.01	Cum
9	7.22.1	Bricks works with common burnt clay non-modular bricks of class designation 7.5 in superstructure above plinth level up to floor IV level in all shape and size in with cement mortar 1:4						
		Boundary Wall	1	832	0.23	2.2	420.99	cum
			Total				420.99	cum
10	11.5.3	12 mm cement plaster on wall						
		Wall	2	832		2.43	4043.52	Sqm
			Total				4043.52	Sqm
11	11.64.1	Distempering with oil bound washable					4043.52	sqm
			Total				4043.52	Sqm
		Take Same Area item No. 11.5.3						
12	6.29.1	Centering and Shuttering Foundation footing base for columns						
			1x2	253		0.9	455.4	Sqm
			1x2	832		0.23	382.72	Sqm
			1x2	253		2.2	1113.2	Sqm
			1x2	832		0.23	382.72	Sqm
			Total				2334.04	Sqm

 Divisional Forest Officer
 BHIWANI

LABOUR AND MATERIAL TOTAL COST ESTIMATE FOR CONSTRUCTION OF BOUNDARY YEAR 2021-22

Sr. No.	PWD. Item No.	Description	Unit	Quantity	Rate	Amount
1	4.14.1	Earth work in excavation in by mechanical means (Hydraulic excavator)/manual means in foundtion trenches. All kinds of soil	cum	673.92	93	62675
2	6.1.7	Providing and laying in position cement concrete of specified grade excluding the cost of centering and shuttering with 1:5:10 cement concrete.	Cum	112.32	2455	275746
3	7.21.1	Bricks works with common burnt clay non- modular bricks of class designation 7.5 in foundation and plinth in cement mortar 1:4	Cum	178.04	4135	736195
4	6.14.1	Providing and laying in position specified grade of reinforced cement	Cum	17.89	4899	87643
5	6.15.1	Reinforced cement concrete works in wall ,including attached pilasters buttresses, plinth and string courses with C.Conc. 1:1.5:3, 20mm nominal size.	Cum	44.01	6684	294163
		Beam on Boundary Wall at plinh level				
6	6.33.3	Steel reinforced for RCC works where not including in the complete rate of RCC, Cold twisted bars	Qtl	148.92	6800	1012656
7	6.16	Reinforced cement and concrete works in beams , suspended floors , roofs	Cum	29.45	6845	201585
	6.15.1	Reinforced cement concrete works in wall ,including attached pilasters buttresses, plinth and string courses with C.Conc. 1:1.5:3, 20mm nominal size.	Cum	44.01	6684	294163
9	7.22.1	Bricks works with comman brunt clay non-modular bricks of class designation 7.5 in superstructure above plinth level up to floor IV level in all sshape and size in with cement mortar 1:4	Cum	420.99	4343	1828360
10	11.5.3	12 mm cement plaster on walls 1:4	sqm	4043.52	94	380091
11	11.64.1	Distempering with oil bound washable	sqm	4043.52	50	202176
12	6.29.1	Centering and Shuttering Foundation footing base for columns	Sqm	2334.04	174	406123
		Total				5781575
		Add to big and small gate				200000
		G.Total				5981575
		Add. 2.5% Cont.				149539
		Add 1% consultancy & architure charges				59815
		Gross Total				6190929

PROPOSED DRAINAGE FOUNDATION WALL

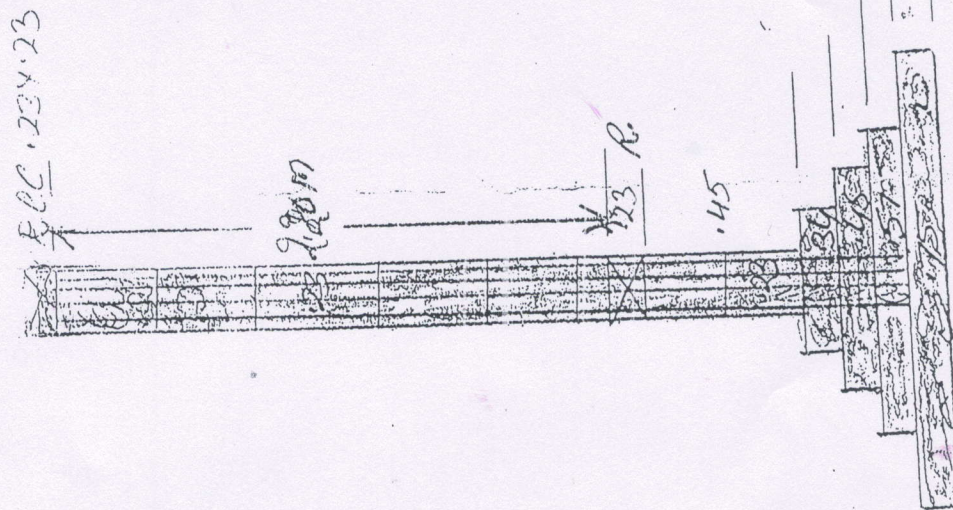

X-SECTION ON PILLAR R.C.C.

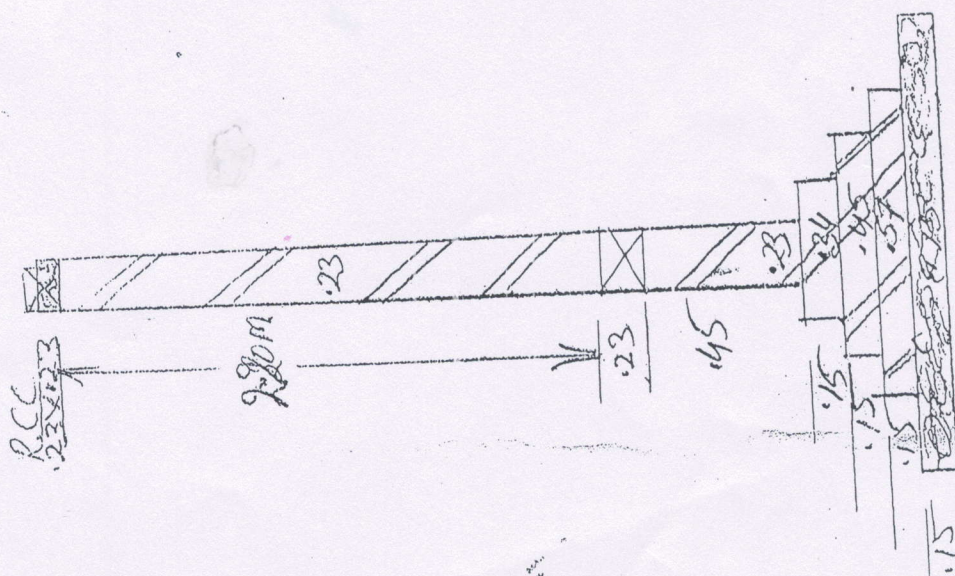

X-SECTION BOUNDARY WALL

Divisional Forest Officer
BHIVANI

LAND PLAN OF KHANK (38 KM L 05 MARLA)

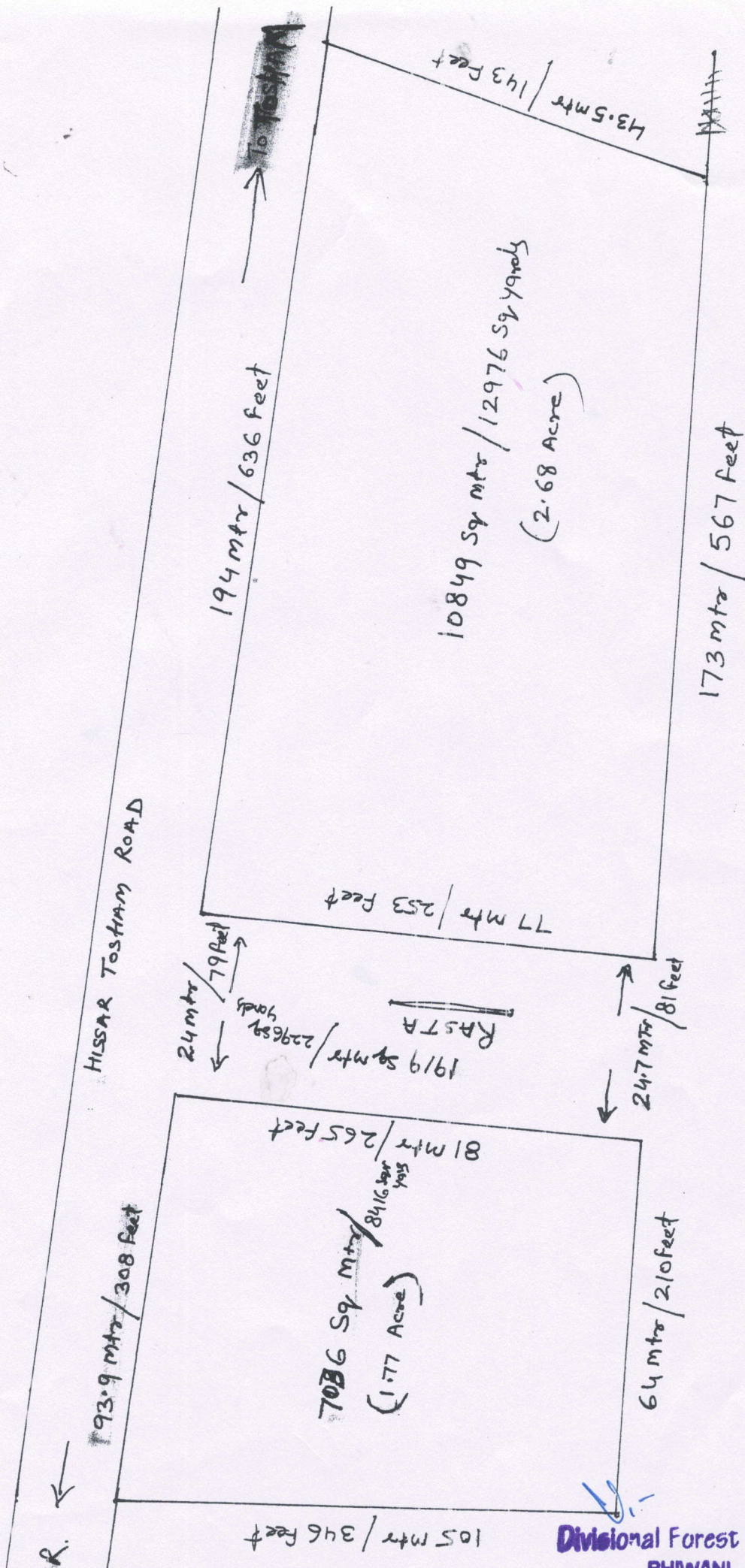

Divisional Forest Officer

BHAWANI