

No. **17866**...../OMC/F&E/2017  
19<sup>th</sup> December, 2017

To

**The Divisional Forest Officer  
Keonjhar Forest Division  
Keonjhar**

**Sub:** Proposal for according permission for use of 6.699 ha of forest land within total Mining lease area of 104.86 ha in Parulipada Manganese Ore Mining lease located in Barbil Tahasil and Barbil Forest Range of Keonjhar Forest Division in Keonjhar district for undertaking exploratory drilling of 97 no. of bore holes of 4" dia (97 boreholes @ 0.02 ha each totaling 1.94 ha and 4.759 ha for construction of road) by M/s.Odisha Mining Corporation Ltd. for prospecting of minerals: OSFMCP-Proposal No:FP/OR/MRL/17/2014.

**Ref:** (i) Memo No.10F (Cons)-166/2015-20243/F&E, dt.03.10.2017 of Special Secretary to Govt. Forest & Environment Department, Govt. of Odisha, addressed to the P.C.C.F, Odisha.  
(ii) Your Letter No. 6332/Mining, dtd. 13.10.2017 by DFO, Keonjhar.

Sir,

The point-wise compliance to the observations made by Special Secretary to Government is submitted herewith for kind perusal and necessary action.

Sl No.	Observations	Compliance
(i)	GOI, MoEF & CC while considering earlier prospecting proposal, had earlier imposed CA against forest land to be used for road purpose. Since 4.759 ha of forest land is proposed to be used for temporary road purpose, suitable non-forest land of equal extent, free from encroachment and encumbrance, may be identified and allotted for raising CA over such non-forest land. A site specific CA scheme prepared for the project, shall be approved by competent authority and appended to the proposal.	Non-forest land for Compensatory Afforestation over 4.759 ha. has been allotted in Tala Ambapadar Revenue village in Thuamul Rampur Tahasil of Kalahandi District. Site Specific Compensatory Afforestation Scheme has been prepared by the D.F.O, Kalahandi South Division and submitted to the Additional P.C.C.F (Forest Diversion and Nodal Officer, F.C Act) for approval. The copy of the allotment letter by Collector, Kalahandi as copy of CA scheme by DFO, Kalahandi(S) is enclosed as <b>Annexure-I</b> series for reference.
(ii)	User agency shall furnish undertaking to pay NPV for the forest land of 4.759 ha to be used for road purpose.	Total NPV for the entire Mining Lease area has been deposited by OMC. The documents regarding payment of NPV are enclosed as <b>Annexure-II</b>
(iii)	Location of proposed boreholes indicated at	DFO, Keonjhar Forest Division will

**The Odisha Mining Corporation Ltd.**

(A Gold Category State PSU)

Registered Office : OMC House, Bhubaneswar-751001, India  
Tel: 0674-2377400/2377401, Fax: 0674-2396889, 2391629, www.omcltd.in  
**CIN : U13100OR1956SGC000313**

	page 39-41 of the proposal needs to be authenticated by the DFO, Keonjhar.	authenticate the location of proposed boreholes.
(iv)	DFO, Keonjhar in his site inspection report (page 12 of proposal) has indicated that <i>felling of trees will bring temporary changes in land use in the mining lease. However, the user agency has undertaken that prospecting activities will not involve any clearing of forest or cutting of trees. This ambiguity may be clarified as to whether any tree felling is involved.</i>	No tree will be felled for prospecting activities. OMC has submitted an undertaking not to fall any tree while undertaking prospecting work.
(v)	ML period has been extended up to 24.04.2031 as per order dt. 513 dt. 19.01.2016 of Steel, & Mines Department. Whether the applicant has got permission under Section 2(iii) of FC Act for the entire forest land of this lease may be indicated. This would enable execution of supplementary lease deed for extended lease period.	Permission has not been obtained under Section 2(iii) of FC Act for this mine. The ML period has been extended till 24.04.2031, subject to execution of Supplementary Lease Deed (SLD) within 3 months i.e before dt.18.04.2016. Section 2(iii) of FC Act provides facility for execution of ML and was notified vide order No.11-599/2014-FC, dtd.19.10.2015 and 10.11.2015. OMC had applied to Addl. Secretary to Govt., Steel & Mines Department, Govt. of Odisha, for seeking general approval for execution of ML including Parulipada Manganese mines vide letter no.4665, dt.31.03.2016. Supplementary lease deed for the extended period could not be executed due to want of approval under section-2 of FC Act, 1980. Accordingly OMC, vide letter no. 5203, dt.12.04.2016 requested the State Govt. to allow minimum one year for obtaining Forest and Environmental Clearance and execute the Supplementary Lease Deed (SLD). The documents in this regard are enclosed as <b>Annexure-III (Series)</b> .

In view of the above, it is requested to kindly examine the compliance and forward to the higher quarter for taking necessary action.

Encl: As above

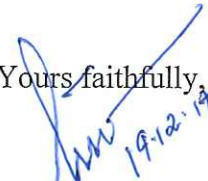
Yours faithfully  
  
 19.12.19  
 Executive Director (F&E)



Memo No. /OMC/F&E/2017, dtd.19.12.2017

Copy forwarded to the Special Secretary to Government of Odisha, F&E Department, Bhubaneswar for kind information and necessary action.

Copy forwarded to the Addl. Principal Chief Conservator of Forests, Forest Diversion and Nodal Officer, FC Act, O/o the Principal Chief Conservator of Forests, Odisha, Bhubaneswar for kind information and necessary action.

Copy forwarded to the Regional Chief Conservator of Forest, Rourkela Circle for kind information and necessary action.

  
Executive Director (F&E)

Memo No. /OMC/F&E/2017, dtd.19.12.2017

Copy forwarded to the Regional Manager, Barbil, OMC Ltd, for information. He is requested to co-ordinate with the DFO, Keonjhar to forward the compliance to the higher quarter at an early date.

  
Executive Director (F&E)

**SCHEME FOR  
COMPENSATORY AFFORESTATION  
  
FOR  
  
DIVERSION OF FOREST LAND FOR NON-FOREST PURPOSE  
IN EXPLORATION OF MINERALS IN PARULIPADA  
MANGANESE ORE MINES OF  
ODISHA MINING CORPORATION LTD.**

**Over an area of 4.759 hectares situated  
in Keonjhar Forest Division**



**Detailed scheme for Compensatory Afforestation to be carried out in lieu of 4.759 hectares of forest area to be diverted for prospecting in Parulipada Iron & Manganese Ore Mines of Odisha Mining Corporation Ltd. in Keonjhar District.**

Exploration will be done in Parulipada Iron & Manganese Ore Mines of OMC Ltd in Keonjhar District. Total Mining Lease area of the mine is 104.86 hectare out of which 84.188 ha. area is forest land. Temporary roads to be constructed for movement of drilling equipments to 30 Bore Hole Pads will cover forest area of 4.754 ha. and Compensatory Afforestation needs to be raised over equivalent non-forest area. Collector, Kalahandi vide letter No.1901/Rev Dated 9.11.2017 (Annexure-A) forwarded the land details with trace maps to DFO, Kalahandi South Division permitting transfer of 4.759 hectares non-forest land for raising compensatory afforestation by the State Forest Department at project cost. The site specific schemes are therefore prepared as follows:

**1. Details of non-forest land:-**

District: Kalahandi

Tahasil: Thuamul Rampur

Village	Khata No	Kisam	Plot No.	Area of the plot	Area taken for this project
Tala	51	Dangar	61	38.75	8.76
Ambapadar	(Abad Ajogya Anabadi)	Dangar	62	34.25	3.00
Total					11.76 ac. Or 4.759 ha.

The village maps showing the land details for the proposed compensatory afforestation is enclosed as Plate No. \_\_\_\_\_ of the FDP.

The jointly verified non-forest land by Forest and Revenue authorities is enclosed as Annexure-(B).

Proposed Compensatory Afforestation area showing on the topo sheet No. E44F2 is furnished as Annexure-(C).

G.P.S co-ordinates of survey stations of Compensatory Afforestation area are furnished as Annexure-(D).

**2. Description of Area**

- I. **Whether the site selected for Compensatory Afforestation is a land bank or not:** This identified non-forest area is under the control of Revenue Department and classified as 'Dangar'. It is not a land bank
- II. **If the CA site is other than the land bank, reasons be given:** No land bank has been established yet for this purpose.

III. In case of non forest area identified for CA, then what is the distance of CA site from the adjoining forest boundary: 1 km from Khakes R.F.

IV. Soil type: Lateritic soil.

V. Topography :

- a) Hilly/Undulating/Plain: The Compensatory Afforestation sites are hilly and undulating.
- b) Slope: Steep/Medium/Gentle: The sites selected for Compensatory Afforestation have medium to gentle slope.

VI. Whether the area is bearing any root stock of vegetation: The sites selected for Compensatory Afforestation are either barren or with weed growth like *Lantana*, *Eupatorium*, *Woodfordia fruticosa*, *Combretum decandrum*. Root stock of any principal species like Sal is not available.

### 3. Plantation Model:-

Since the area is hilly, Bald Hill plantation with 1600 plants per hectare will be raised. Maintenance of plantation for 10 years is also required as per F.No. 11-168/2009-FC Date 14.2.2012 of MoEF. Considering these facts a site specific cost norm for the plantation is furnished as Annexure-(F).

### 4. Schedule of Plantation Programme:-

Detail of year wise break up of requirements of funds is as under:-

Year	Area in Ha.	Rate/ Ha.	Amount
0th Year	4.759	69978.00	333025.00
1st Year		65752.75	312917.00
2nd Year		24632.50	117226.00
3rd Year		14945.00	71123.00
4th Year		11315.50	53850.00
5th Year		11315.50	53850.00
6 <sup>th</sup> Year		11315.50	53850.00
7th Year		11315.50	53850.00
8th Year		11315.50	53850.00
9th Year		11315.50	53850.00
10th Year		11315.50	53850.00
Total		254516.75	1211245.00

5. Technical details:- Technical details of Compensatory Afforestation Scheme are as follows:

a) General Details :

**Survey & Demarcation of boundary:**

The identified area will be surveyed by DGPS and the area will be demarcated with RCC pillars of size 2.5 mtr x 30 cm x 30 cm. This work will be done by the User Agency at Project cost.

**Fencing:**

To protect the plantation from grazing and other biotic interference, it will be provided with 7 strand barbed wire fencing with RCC pillars, the cost for which will be paid by the User Agency. Since non-forest areas adjoining this site have also been taken for Compensatory Afforestation for other projects and barbed wire fencing will be done around the entire patch, the length of barbed wire fence needed in this project is furnished below.

Sl No	Village	Length of outer periphery of the site in mtr	Length of enclosures if required to be fenced	Length of common fence of adjoining project which need not be fenced	Total length of fence required (3+4-5)
(1)	(2)	(3)	(4)	(5)	(6)
1	Tala Ambapadar	1048.919	Nil	With Chrome Block-I CA = 288.62 mtr + with CA for Daitari conveyor 135.78 mtr	624.519 mtr
Total		1048.919		424.4 mtr	624.519 mtr

Estimate for barbed wire fencing has been provided in Annexure – (E).

**Planting and post-planting:**

- b) Compensatory Afforestation areas of this project and its adjoining projects should be treated as a single plantation for proper management. Bald Hill plantation shall be taken up with 1600 plants per hectares at spacing of 2.5 m x 2.5 m. Alignment and pit marking should be done carefully in slopes so that the horizontal distance between plants in a row remains 2.5 mtrs and not the distance measured along the slope. All post planting measures like casualty replacement, soil working, manuring, fire protection etc. will be undertaken. The plantation area should be divided into 4 hectare plots. These plots should be demarcated in the field before digging of pits so that the demarcating line does not cross a plantation row. The 4 ha plots should be shown on map. Cost norm for Bald Hill plantation is furnished as Annexure-(F).

While taking up plantation, the following vital points shall be taken up for consideration: -

- Care to be taken to raise healthy plantable seedlings of minimum 60 cm height. 10% extra seedlings are to be raised for replacement of casualty.
- Pitting shall invariably be done during November-February i.e., before onset of monsoon. If possible the soil of upper portion and lower portion of pit should be placed separately in specific direction so that while planting the pits will be filled with top-soil first.
- Planting shall be done on the onset of monsoon to get full benefit of monsoon rain and planting should never be delayed.



- Basal dose of 50 grams of NPK and 5 grams of Chlorpyrifos dust per plant should be applied at the time of planting carefully by mixing with top-soil so that the roots of seedlings do not come in direct contact with fertilizer.
- In case of any mortality of planted seedlings, it should be replaced with good seedlings as soon as possible for better success rate.
- Complete weeding in proper time will be done. Strip weeding will not be permitted.
- Soil-working and application of 2<sup>nd</sup> dose fertilizer of 50 gms NPK per plant should be done in time.
- Since the area is provided with barbed wire fence, watch & ward will be easier and the watchers may be engaged in weeding in problematic areas alongwith watch & ward.

**c) Species:**

Although indigenous species are to be preferred in the plantation, considering adverse soil & moisture conditions we may go for hardy exotic species where required so that the plants are able to survive. For success of plantation in interior tribal areas, plantation of fruit and NTFP species plays a great role since economic species have a little value for local people. Considering the topography, soil and moisture availability of the plantation area, the following species will be planted

Name of species	Common name	Remarks
<i>Azadirachta indica</i>	Neem	
<i>Derris indica</i>	Karanja	
<i>Emblica officinalis</i>	Amla	
<i>Terminalia chebula</i>	Harida	In lower areas with good soil depth
<i>Terminalia bellirica</i>	Bahada	In lower areas with good soil depth
<i>Dalbergia sissoo</i>	Sissoo	In lower areas with good soil depth
<i>Gmelina arborea</i>	Gambhari	In lower areas with good soil depth
<i>Dendrocalamus strictus</i>	Salia bamboo	In lower areas with good soil depth healthy seedlings from rhizomes may be planted
<i>Cassia siamea</i>	Chakunda	In lower areas with good soil depth
<i>Tamarindus indica</i>	Tentuli	In lower areas with good soil depth
<i>Madhuca indica</i>	Mahul	Only two years old seedlings may be planted
<i>Simaruba glauca</i>	Simaruba	In rocky areas with low soil depth
<i>Zizyphus mauritania</i>	Barkoli	In rocky areas with low soil depth
<i>Tectona grandis</i>	Teak	Potted seedlings from pre-sprouted healthy stumps will be planted
<i>Mangifera indica</i>	Mango	In situ plantation (direct placing of mango stone in planting site) during pre-monsoon may be adopted in few lower areas or where life-saving watering can be done during summer

**d) Soil and Moisture Conservation Works :-**

Since most of the areas are hilly and undulating, half-moon trenches on down-hill side of plants should be constructed.

**e) Protection of the plantation:** - 7 strand Barbed wire fence with RCC pillars all along the periphery of the plantation will be provided. Few watchers will also be engaged for protection of the plantation.

**6. Proposed Monitoring Mechanism:** - The scheme shall be executed by the Divisional Forest Officer, Kalahandi South Division with his staff and all prescribed records are to be maintained. In addition to internal monitoring by Forest Officers of State Government, a Monitoring Committee under item no. 3.4(iii) of consolidated guidelines under F.C Act 1980 issued by MoEF, shall be established with a nominee of the Central Government to oversee that the stipulations, including those pertaining to Compensatory Afforestation are carried out.

**7. Total cost of the project:** The total cost of the project is Rs. 24, 16,800.00 (Rupees Twenty-four lakh Sixteen thousand Eight hundred) only as detailed in Annexure-(G) which shall be payable by the user agency to the D.F.O, Kalahandi South Division on demand.

  
Divisional Forests Officer  
Kalahandi South Division  
Divisional Forest Officer  
Kalahandi South Division

## OFFICE OF THE COLLECTOR &amp; DISTRICT MAGISTRATE, KALAHANDI

No. 1901 /Rev- Date: 09.11.2017

To,

Divisional Forest Officer (South)  
Kalahandi, Bhawanipatna

Sub: Filing of requisition for Compensatory Afforestation – allocation of non-forest Govt. land.

Ref: This office letter No. 1610/Rev. dtd 26.09.2017 and your letter No. 4083 / 3F dated 27.10.2017.

Sir,

I am to say that non-forest Government land measuring to an area of 21.483 hector in village Tal Ambapadar under Th.Rampur Tahasil has been identified for allocation for raising compensatory afforestation in lieu of diversion of forest land pertaining to different mining projects of M/S. OMC Ltd., Bhubaneswar.

As such, you are requested to file requisition in Form No. 1-A for each project separately alongwith copy of joint verification reports before Tahasildar, Th.Rampur immediately for processing the alienation of the said Govt land in favour of Forest & Environment Department.

Yours faithfully,

  
Collector,  
Kalahandi

Memo No. 1902 /Rev. Date: 09.11.2017

Copy alongwith joint verification report forwarded to Tahasildar, Th.Rampur for information. He is requested to process the alienation proposal in favour of the Forest & Environment Department on obtaining the requisition from the Divisional Forest Officer (South), Kalahandi

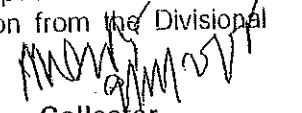
  
Collector,  
Kalahandi

Memo No. 1903 /Rev. Date: 09.11.2017

Copy to Sub-Collector, Bhawanipatna for information and necessary action.

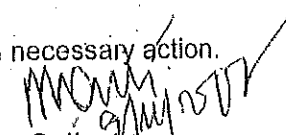
  
Collector,  
Kalahandi

Memo No. 1904 /Rev. Date: 09.11.2017

Copy to Managing Director, OMC Ltd., Odisha, Bhubaneswar with reference to his letter No.13323/OMC dtd 11.09.2017 for information and necessary action.

  
Collector,  
Kalahandi



JOINT VERIFICATION REPORT OF NON-FOREST GOVT. LAND IN VILLAGE TALA AMBAPADAR UNDER TH.RAMPUR TAHASIL OF KALAHANDI DISTRICT FOR RAISING COMPENSATORY AFFORESTATION AGAINST EXPLORATORY DRILLING OF PARULIPADA MANGANESE MINES OF OMC LTD LOCATED IN THE DISTRICT OF KEONJHAR, ODISHA.

Certified that on joint verification of non-forest Govt. land (Kissam- Dangar) in Village Tala Ambapadar of Th.Rampur Tahasil of Kalahandi District, it is found that the schedule wise land mentioned as given under is suitable for bald hill block plantation and free from encroachment and encumbrances, does not comes under DLC land and FR Settlement.

Name of the Mines	Tahasil	Village	Khata No	Plot No	Kissam	Total area of the plot (Ac)	Area considered (Ac)
Parulipada Manganese Mines	THUAMULRAMPUR	TALA AMBAPADAR	53 (AAA)	61	Dangar	38.75	8.76
				62	Dangar	34.25	3.00
		Total					11.760 Ac or 4.759 Ha.

Revenue Inspector  
Nakarundi

Forester  
Th. Rampur  
Gumpur Section

Range Officer  
Th. Rampur  
Range Officer  
Th. Rampur

Tahasil Dar  
Th. Rampur



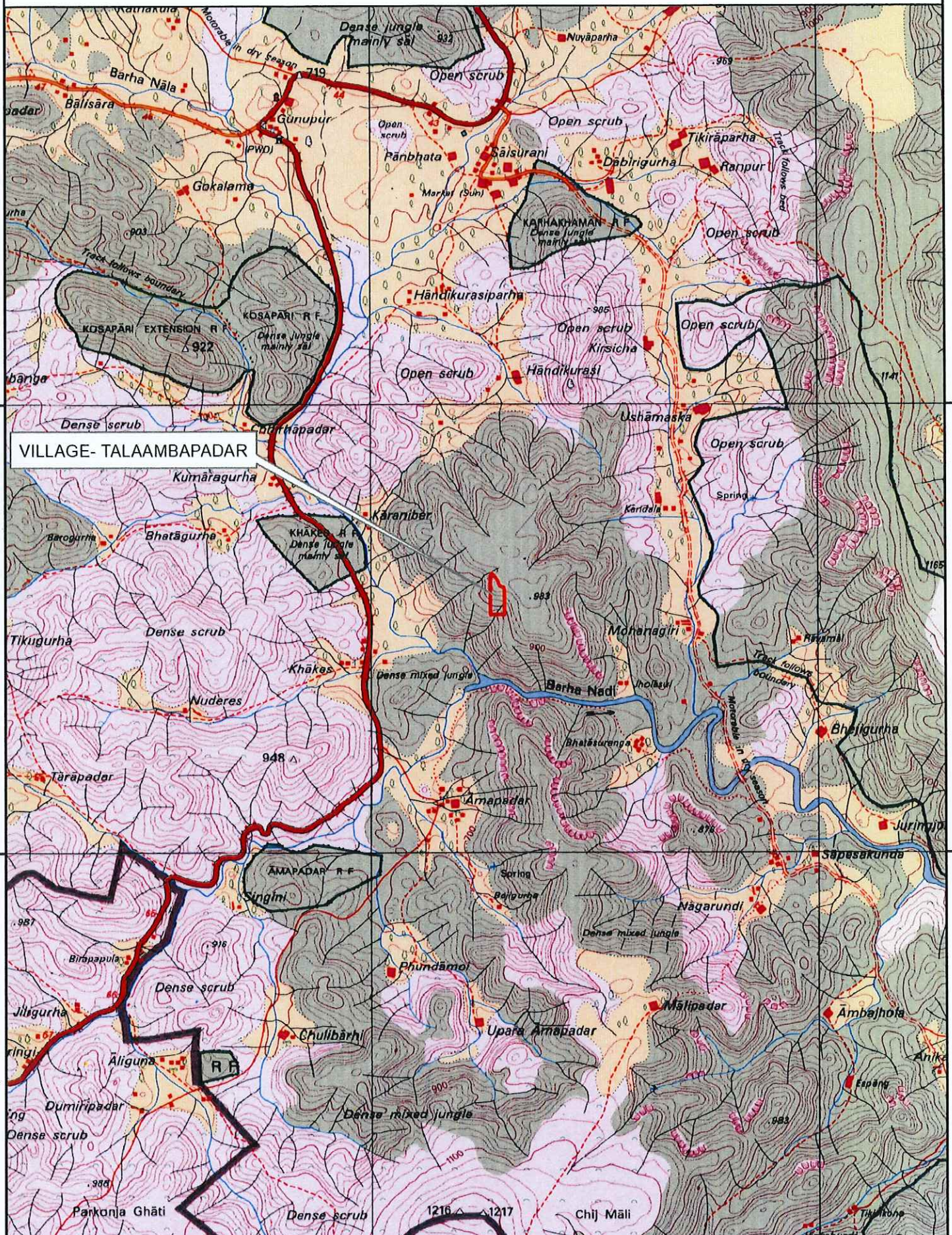

VILLAGE- TALAAMBAPADAR



AREA PROPOSED FOR COMPENSATORY AFFORESTATION (4.759 HA.)

Revenue Inspector  
Nakrundi

Divisional Forest Officer  
Kalahandi South Division

Range Officer  
Th. Rampur North Range

Range Officer  
Th. Rampur North Range



## ANNEXURE - (D)

## GPS READING OF THE AREA PROPOSED FOR COMPENSATORY AFFORESTATION

Points		CO-ORDINATES		Forward bearing	Backward bearing	Distance in mtr
From	To	Longitude	Latitude			
1	2	E83° 8' 10.448"	19° 34' 3.154" N	40°21'23"	220°21'23"	18.555
2	3	E83° 8' 10.866"	19° 34' 3.609" N	128°55'08"	308°55'08"	23.542
3	4	E83° 8' 11.488"	19° 34' 3.120" N	136°57'07"	316°57'07"	16.465
4	5	E83° 8' 11.868"	19° 34' 2.725" N	147°43'57"	327°43'57"	58.989
5	6	E83° 8' 12.927"	19° 34' 1.090" N	158°06'55"	338°06'55"	27.801
6	7	E83° 8' 13.271"	19° 34' 0.247" N	151°00'15"	331°00'15"	26.566
7	8	E83° 8' 13.703"	19° 33' 59.487" N	106°58'33"	286°58'33"	40.446
8	9	E83° 8' 15.025"	19° 33' 59.087" N	178°18'42"	358°18'42"	288.622
9	10	E83° 8' 15.193"	19° 33' 49.704" N	269°55'41"	89°55'41"	135.79
10	1	E83° 8' 10.536"	19° 33' 49.754" N	358°55'45"	178°55'45"	412.143
PERIMETER- 1048.919 METERS & AREA - 4.759 HA						

  
Revenue Inspector  
Nakrundi

  
Tahasildar  
Th. Rampur

  
Range Officer  
Th. Rampur North Range

  
Divisional Forest Officer  
Kalahandi South Division



## ANNEXURE-(E)

COST NORM FOR BALD HILL PLANTATION @ 1600 PLANTS PER HECTARE						
Labour cost @ Rs 213.50 per manday						
Sl No	Item of work	Preferable period of execution	Manday	Labour cost @ Rs 213.50 per day	Material cost per hectare in Rs	Total cost per hectare in Rs.
<b>Preparatory operation (0<sup>th</sup> Year)</b>						
1.	Survey and demarcation	June	2	427.00	0	427.00
2.	Pitting (1600 pits per ha.)- each pit 45cm <sup>3</sup>	Nov-Dec	128	27328.00	0	27328.00
3.	Soil and water conservation measures					
	(a) Staggered trench along the contour @ 300 per ha (2.5mx0.5mx0.5m), digging of percolation pits @ 600 per ha in lieu of staggered trenches, gully plugging and Drainage line treatment, half moon trench on the uphill side of each planting pit (100 MD for staggered trench/ percolation pits and 30 MD for gully plugging, drainage line treatment and half moon trench)	Sept-Nov	130	27755.00	0	27755.00
	(b) Green Fencing To be strengthened by planting of bamboo and other seedlings in two rows. Bamboo to be planted at 2 meters spacing in staggered manner on the two rows, and the rest of the species to be planted at ½ meter spacing along the two rows, the rows being 2m apart. Thus 500 plant (125 bamboo and 375 others) to be planted in two rows to cover 126 m of periphery / Ha. by the vegetative fence (Bamboo seedlings @ Rs. 9.45 per seedling x 125 = Rs. 1181.00 Agave seedling @ Rs. 3.50per seedling x 375 + Rs. 1312.00)	June -- Sept.	11	2348.50	2493.00	4841.50
	(c) Site clearance-8 MD. Alignment and staking of contour lines on ground, planting pits, contour trenches/ percolation pits and check dam sites etc.-2 MD	July-Aug	10	2135.00	0	2135.00
4	Raising of seedlings in poly bags (minimum 60 cm high) @ Rs 9.45 per seedling (Rs 6.67 in 0 <sup>th</sup> year) Part (1760 saplings to be raised for one hectare from January-March @ Rs 11739/-	October-March	44	9394.00	2939.00	12333.00
<b>Total 0<sup>th</sup> year</b>			<b>325</b>	<b>69387.50</b>	<b>5432.00</b>	<b>74819.50</b>
<b>Planting Operation (1<sup>st</sup> Year)</b>						
1	Cost of sapling (balance) from April-June/July @ Rs 2.78 per seedling for 1760 seedlings = Rs.4893/-	April-July	21.5	4590.25	593.00	5183.25
2	Freshening of pits-64 MD, filling with fertile soil and farm yard manure (FYM)-24 MD, application of insecticide and planting of 60 cm tall saplings including carriage of plants-21MD	June-July	109	23271.50	0	23271.50
3	Cost of fertile soil 0.25 cft @ Rs 6 per cft/ FYM 0.25 cft @ Rs 15 per cft per pit		0	0	9200.00	9200.00
4	Sowing of seeds on dug out earth of trench	June	6	1281.00	200.00	1481.00
5	Carriage-6 MD. Planting including casualty replacement-6 MD, fertilizer application-5 MD, 1 <sup>st</sup> weeding-7 MD, 2 <sup>nd</sup> weeding-5 MD, soil working-7 MD.	July-August	36	7686.00	0	7686.00
6	Cost of fertilizer and insecticide (Granular insecticide @ 5gms/plant @Rs 80/- per kg = Rs 640.00, NPK 100 gms/plant in two doses @ Rs 24 per kg = Rs		0	0	4480.00	4480.00

	3840.00					
7	Maintenance of Soil and Moisture Conservation measures (20% of cost)	October-Dec	26	5551.00	0	5551.00
8	Closure to grazing, fire and other biotic interference by engaging watch & ward	April-March	30	6405.00	0	6405.00
9	Fire tracing and control, display board construction, painting/writing, other miscellaneous cost	Jan-Feb	10	2135.00	360.00	2495.00
<b>Total (1<sup>st</sup> year)</b>			<b>238.5</b>	<b>50919.75</b>	<b>14833.00</b>	<b>65752.75</b>
<b>Maintenance Operation (2<sup>nd</sup> Year)</b>						
1	Casualty replacement-6 MD including seedling cost @ Rs 9.45 per seedling and its transportation	June-July	10	2135.00	1512.00	3647.00
2	Soil working-7 MD, 1 <sup>st</sup> weeding-6 MD, 2 <sup>nd</sup> weeding-6 MD and fertilizer application-4 MD	August-October	23	4910.50	0	4910.50
3	Cost of fertilizer @ 50 gms NPK per plant @ Rs 24/- per kg for 1600 plants = Rs 1920.00. Insecticide @ 5 gm per plant for 160 nos of plants @ Rs 80 per kg = Rs 64.00		0	0	1984.00	1984.00
4	Maintenance of Soil and Moisture Conservation measures (20% of cost)	August-October	26	5551.00	0	5551.00
5	Fire tracing and control, and other misc. cost	Feb-Mar	10	2135.00	0	2135.00
6	Closure to grazing, fire and other biotic interference by engaging watch & ward	April-March	30	6405.00	0	6405.00
<b>Total 2<sup>nd</sup> Year</b>			<b>99</b>	<b>21136.50</b>	<b>3496.00</b>	<b>24632.50</b>
<b>Maintenance Operation (3<sup>rd</sup> Year)</b>						
1.	S.M.C measures (Renovation)--	Apr-Mar	26	5551.00	0	5551.00
2	Maintenance of plantation	Apr-Mar	14	2989.00	0	2989.00
3	Closure to grazing, fire and other biotic interference by engaging watch & ward	April-March	30	6405.00	500.00	6905.00
4	Repair of barbed wire fence		42.15	9000.00	0	9000.00
<b>Total 3<sup>rd</sup> Year</b>			<b>112.15</b>	<b>23945.00</b>	<b>500.00</b>	<b>24445.00</b>
<b>Maintenance Operation (4<sup>th</sup> Year)</b>						
1	S.M.C measures- 21MD, and maintenance of plantation – 14 MD	April-March	35	7472.50	0	7472.50
2	Closure to grazing, fire and other biotic interference by engaging watch & ward	April-March	65	13877.50	500.00	14377.50
<b>Total 4<sup>th</sup> Year</b>			<b>100</b>	<b>21350.00</b>	<b>500.00</b>	<b>21850.00</b>
<b>Maintenance Operation (5<sup>th</sup> Year)</b>						
1	S.M.C measures- 21MD, and maintenance of plantation – 14 MD	April-March	35	7472.50	0	7472.50
2	Closure to grazing, fire and other biotic interference by engaging watch & ward	April-March	65	13877.50	500.00	14377.50
<b>Total 5<sup>th</sup> Year</b>			<b>100</b>	<b>21350.00</b>	<b>500.00</b>	<b>21850.00</b>
<b>Maintenance Operation (6<sup>th</sup> Year)</b>						
1	S.M.C measures- 21MD, and maintenance of plantation – 14 MD	April-March	35	7472.50	0	7472.50
2	Closure to grazing, fire and other biotic interference by engaging watch & ward	April-March	65	13877.50	500.00	14377.50
3	Repair of barbed wire fence		42.15	9000.00	0	9000.00
<b>Total 6<sup>th</sup> Year</b>			<b>142.15</b>	<b>30350.00</b>	<b>500.00</b>	<b>30850.00</b>
<b>Maintenance Operation (7<sup>th</sup> Year)</b>						
1	S.M.C measures- 21MD, and maintenance of plantation – 14 MD	April-March	35	7472.50	0	7472.50
2	Closure to grazing, fire and other biotic interference by engaging watch & ward	April-March	65	13877.50	500.00	14377.50
<b>Total 7<sup>th</sup> Year</b>			<b>100</b>	<b>21350.00</b>	<b>500.00</b>	<b>21850.00</b>
<b>Maintenance Operation (8<sup>th</sup> Year)</b>						

1	S.M.C measures- 21MD, and maintenance of plantation – 14 MD	April-March	35	7472.50	0	7472.50
2	Closure to grazing, fire and other biotic interference by engaging watch & ward	April-March	65	13877.50	500.00	14377.50
	<b>Total 8<sup>th</sup> Year</b>		<b>100</b>	<b>21350.00</b>	<b>500.00</b>	<b>21850.00</b>
<b>Maintenance Operation (9<sup>th</sup> Year)</b>						
1	S.M.C measures- 21MD, and maintenance of plantation – 14 MD	April-March	35	7472.50	0	7472.50
2	Closure to grazing, fire and other biotic interference by engaging watch & ward	April-March	65	13877.50	500.00	14377.50
3	Repair of barbed wire fence		42.15	9000.00	0	9000.00
	<b>Total 9<sup>th</sup> Year</b>		<b>142.15</b>	<b>30350.00</b>	<b>500.00</b>	<b>30850.00</b>
<b>Maintenance Operation (10<sup>th</sup> Year)</b>						
1	S.M.C measures- 21MD, and maintenance of plantation – 14 MD	April-March	35	7472.50	0	7472.50
2	Closure to grazing, fire and other biotic interference by engaging watch & ward	April-March	65	13877.50	500.00	14377.50
	<b>Total 10<sup>th</sup> Year</b>		<b>100</b>	<b>21350.00</b>	<b>500.00</b>	<b>21850.00</b>

### ABSTRACT

Sl	Year	Mandays	Labour cost (Rs.)	Material cost (Rs.)	Total (Rs.)
1	0 <sup>th</sup> year	325	69387.50	5432.00	74819.50
2	1 <sup>st</sup> year	238.5	50919.75	14833.00	65752.75
3	2 <sup>nd</sup> year	99	21136.50	3496.00	24632.50
4	3 <sup>rd</sup> year	112.15	23945.00	500.00	24445.00
5	4 <sup>th</sup> year	100	21350.00	500.00	21850.00
6	5 <sup>th</sup> year	100	21350.00	500.00	21850.00
7	6 <sup>th</sup> year	142.15	30350.00	500.00	30850.00
8	7 <sup>th</sup> year	100	21350.00	500.00	21850.00
9	8 <sup>th</sup> year	100	21350.00	500.00	21850.00
10	9 <sup>th</sup> year	142.15	30350.00	500.00	30850.00
11	10 <sup>th</sup> year	100	21350.00	500.00	21850.00
<b>Grand Total</b>		<b>1558.95</b>	<b>332838.75</b>	<b>27761.00</b>	<b>360599.75</b>



**ESTIMATE FOR BARBED WIRE FENCE**

7 strands (5 straight + 2 cross strands) of 2 ply barbed wire on RCC posts fixed at 2.5 mtr intervals.							
Two fencing posts extra, used as struts at each corner point							
Number of fence posts required per kilometer 500 nos.							
Fence post size 2 mtr long; 10cm x 10cm top; 15cm x 15cm bottom							
Minimum wage rate Rs. 213.50 per day for unskilled labourer							
<b>Lead Statement &amp; cost of materials</b>							
Sl. No	Item	Unit	Basic price	Lead in Km	Transport charge	Royalty	Total price
1	4cm hand broken granite metal	Cum	609.00	15	248.40	98.79	956.19
2	12mm H.G hand broken chips	Cum	934.00	15	248.40	98.79	1281.19
3	Screened & washed sand	Cum	59.00	25	340.40	27.44	426.84
4	M.S rod	Ant.	4000.00	90	76.80	0.00	4076.80
5	Cement	Qntl.	651.00	90	76.80	0.00	727.80
6	Barbed wire	Kg	66.00	90	0.76	0.00	66.76
<b>Analysis of rate</b>							
Sl. No.	Item	Qty.	Unit	Rate	Amount		
<b>1</b>	<b>Cement concrete (1:4:8) with 4 cm HG metal</b>						
a	Materials						
	Hand broken granite stone 4 cm size	0.96	Cum	956.19	917.94		
	Sand (Screened & washed)	0.48	Cum	426.84	204.88		
	Cement	1.72	Qntl.	727.80	1251.82		
					2374.64		
b	Labour						
	Mason second class	0.18	Each	253.50	45.63		
	Man mulia	1.80	Each	213.50	384.30		
	Women mulia	1.40	Each	213.50	298.90		
	Man mulia for mixing stone, sand and cement and water	0.70	Each	213.50	149.45		
					878.28		
c	Overhead charges 7.5% of (a+b)				243.97		
	<b>Total cost per cum</b>				<b>3496.89</b>		
<b>2</b>	<b>C.C (1:2:4) in 12 mm hand broken H,G chips including hoisting and laying per cum.</b>						
a	Materials						
	Hand broken granite stone 12 cm size	0.96	Cum	1281.19	1229.94		
	Sand (Screened & washed)	0.45	Cum	426.84	192.08		
	Cement	3.23	Qntl.	727.80	2350.79		
					3772.81		
b	Labour						
	Mason second class	0.68	Each	253.50	172.38		
	Man mulia	1.80	Each	213.50	384.30		
	Women mulia	1.40	Each	213.50	298.90		
	Man mulia for mixing stone, sand and cement and water	1.40	Each	213.50	298.90		
	Mason second class	0.50	Each	233.50	106.75		
					1261.23		
c	Overhead charges 7.5% of (a+b)				377.55		
	<b>Total cost per cum</b>				<b>5411.59</b>		

3	<b>Labour for M.S reinforcement for R.C.C work including cutting, bending and tying the grills and placing in position, including cost of binding wire (per 1 Qntl.)</b>				
	Blacksmith (Special)	1.00	Each	273.50	273.50
	Semiskilled mulia	1.00	Each	233.50	233.50
	30% sundries, binding wires and T&P etc.				152.10
	Total charges per quintal				<b>659.10</b>
	<b>Estimated cost per fence post of 2 mtr long, 15 cm x 15cm bottom and 10 cm x 10 cm top in RCC (1:2:4) with 12mm H.G chips</b>				
	Cost for concrete 2.0 mtr x 0.01625 sq. mtr =	0.0325	Cum	5411.59	175.88
	Cost of 8 mm rod (4 x 2 mtr) + 6mm rod 0.6 mtr for rings =	3.25	Kg	40.77	132.50
	Labour for cutting, bending, binding & laying in position of rods including cost of binding wire	3.15	Kg	6.59	20.76
	Cost of staples for holding barbed wire				20.00
					<b>349.14</b>
	<b>Estimated cost for fixing each fence post with C.C (1:4:8) cm metal</b>				
1	Cost of concrete (45cm x 45 cm) + 45cm) - (15cm x 15cm x 15cm)	0.081	Cum	3496.89	<b>283.25</b>
	<b>Estimated per Kilometre of Barbed wire Fencing</b>				
SI No	Work	Qty.	Unit	Rate	Amount
1	Cost of fence post RCC (1:2:4) with 12mm H.G chips 2 mtr long 15cm x 15cm bottom and 10cm x 10cm top	500.00	Each	349.14	174570.00
2	Digging of pits for fixing of fence posts	500.00	Each	20.00	10000.00
3	Fixing of fence post with C.C (1:4:8) with 4 cm H.G metal	500.00	Each	283.25	141625.00
4	Cost of 2 ply barbed wire 7 strands x 1000 mtr= 7000 mtr @ 8 mtr per kg	875.00	Kg	66.76	58415.00
5	Labour for fixing barbed wire fencing and post by means of staples and straining hooks	7000	Mtr	6.00	42000.00
6	Average expenditure needs for extra lead for transporting RCC fence posts in hill slopes manually 0.5 man-day per pillar	500.00	Each	100.00	50000.00
	<b>Total expenditure for 1 km of barbed wire fence</b>				<b>476610.00</b>

## ANNEXURE-(G)

**TOTAL COST OF THE COMPENSATORY AFFORESTATION SCHEME**

Sl. No.	Item of Work	Total Estimated cost in Rs.
1	Barbed wire fence around plantation site Rs 476610/- X 0.625 km	297881.25
2	Bald Hill plantation over 4.759 ha. X Rs 360599.75	1716094.21
	Total	2013975.46
	Cost of Escalation in future 20%	402795.09
	Grand Total	2416770.55 or say Rs.24,16,800.00

(Rupees Twenty-four lakh Sixteen thousand Eight hundred only)



Divisional Forest Officer,  
Kalahandi South Division.  
Divisional Forest Officer  
Kalahandi South Division



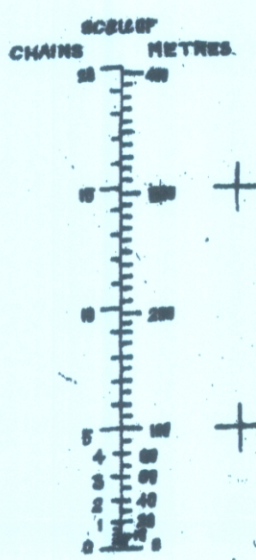
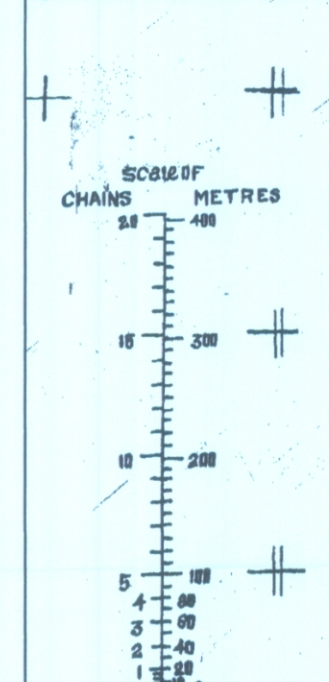
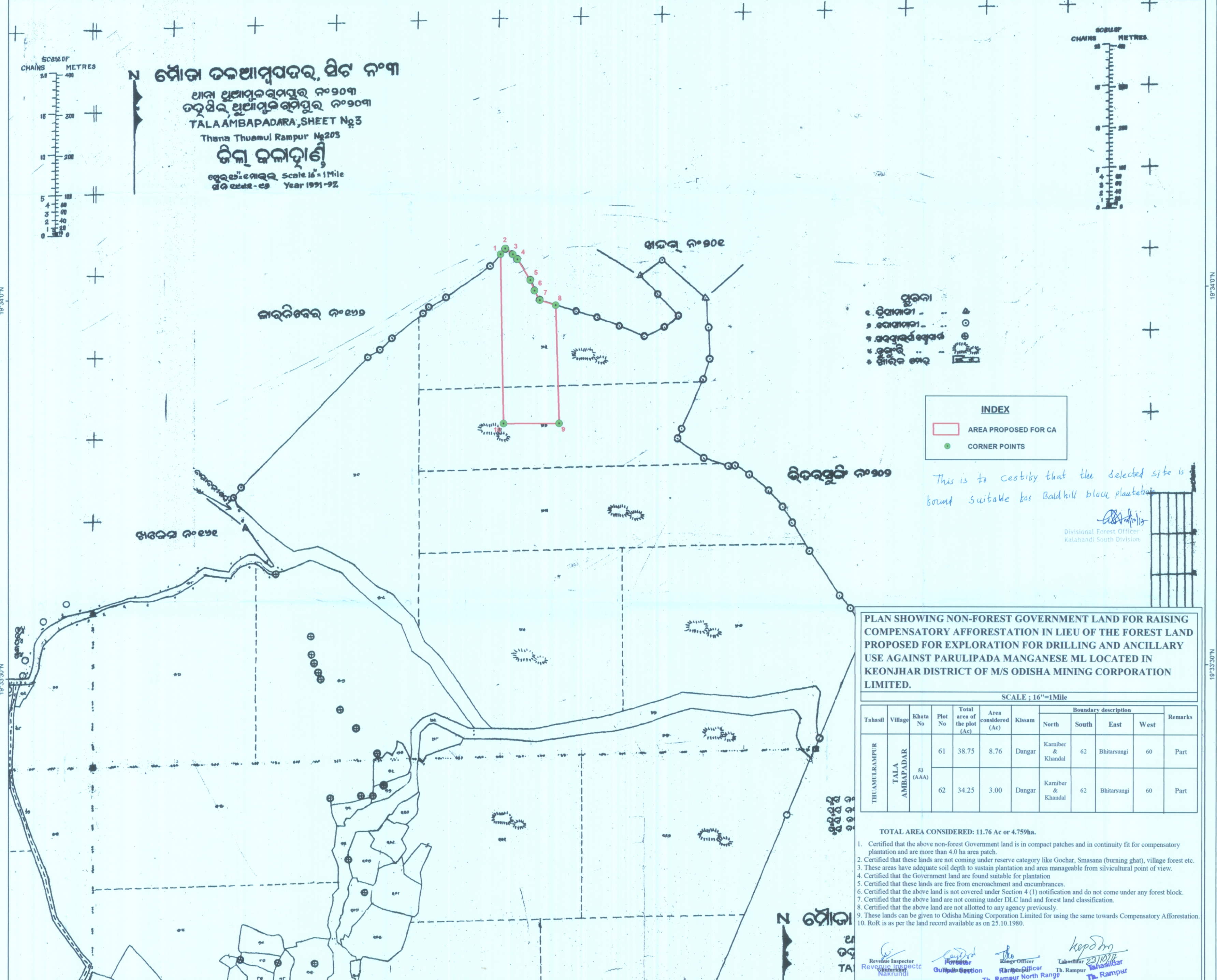

ମୌଜା ତାଲୁକାପଦର, ଶିବ ନଂ ୩  
ଥାନା ଥୁଆମୁଲରାମପୁର ନଂ ୨୦୩  
ତହସିଲ, ଥୁଆମୁଲରାମପୁର ନଂ ୨୦୩  
TALAAMBAPADARA, SHEET No 3  
Thana Thuamul Rampur No 203  
ଜିଲ୍ଲା କଲକତ୍ତା  
ପ୍ଲଟ୍ ନଂ ୧୩୧୧-୧୨ Scale 16"=1 Mile  
ସନ ୧୯୯୧-୯୨ Year 1991-92

- ସୂଚକ
- ୧. ଶିଖରା
  - ୨. ଗୋସାଇଁ
  - ୩. ଗୋସାଇଁ
  - ୪. ଗୋସାଇଁ
  - ୫. ଗୋସାଇଁ
  - ୬. ଗୋସାଇଁ
  - ୭. ଗୋସାଇଁ
  - ୮. ଗୋସାଇଁ
  - ୯. ଗୋସାଇଁ
  - ୧୦. ଗୋସାଇଁ

**INDEX**

AREA PROPOSED FOR CA

CORNER POINTS

This is to certify that the selected site is bound suitable for Balhul bloc plantation

Divisional Forest Officer  
Kalahandi South Division

PLAN SHOWING NON-FOREST GOVERNMENT LAND FOR RAISING COMPENSATORY AFFORESTATION IN LIEU OF THE FOREST LAND PROPOSED FOR EXPLORATION FOR DRILLING AND ANCILLARY USE AGAINST PARULIPADA MANGANESE ML LOCATED IN KEONJHAR DISTRICT OF M/S ODISHA MINING CORPORATION LIMITED.

SCALE : 16"=1Mile

Tahasil	Village	Khata No	Plot No	Total area of the plot (Ac)	Area considered (Ac)	Kissam	Boundary description				Remarks
THUAMULRAMPUR	TALA AMBAPADAR	53 (AAA)	61	38.75	8.76	Dangar	Karniber & Khandal	62	Bhitarungi	60	Part
			62	34.25	3.00	Dangar	Karniber & Khandal	62	Bhitarungi	60	Part

- TOTAL AREA CONSIDERED: 11.76 Ac or 4.759ha.
1. Certified that the above non-forest Government land is in compact patches and in continuity fit for compensatory plantation and are more than 4.0 ha area patch.
  2. Certified that these lands are not coming under reserve category like Gochar, Smasana (burning ghat), village forest etc.
  3. These areas have adequate soil depth to sustain plantation and area manageable from silvicultural point of view.
  4. Certified that the Government land are found suitable for plantation
  5. Certified that these lands are free from encroachment and encumbrances.
  6. Certified that the above land is not covered under Section 4 (1) notification and do not come under any forest block.
  7. Certified that the above land are not coming under DLC land and forest land classification.
  8. Certified that the above land are not allotted to any agency previously.
  9. These lands can be given to Odisha Mining Corporation Limited for using the same towards Compensatory Afforestation.
  10. RoR is as per the land record available as on 25.10.1980.

Revenue Inspector  
Nakundi

Range Officer  
Rampur North Range

Th. Rampur

Th. Rampur



Cable: ORMINCORP, Bhubaneswar

Tel: +0674 2393431, 2395689, 2393389 (EPABX), 2392747 (Dir)  
Fax: 0674-2391629, 2396889, 2394772**The Orissa Mining Corporation Ltd.**

(A Government of Orissa Undertaking)

OMC HOUSE, BHUBANESWAR -751001

No. 14323 /OMC/F&amp;E/10

To

The Divisional Forest Officer  
Keonjhar Forest Division,

Date. 23.07.2010

Sub: Payment of NPV in respect of Parulipada Manganese Ore Mines of O.M.C.Ltd.

Ref: Your office letter No.249/dt 19.06.2010.

Sir

In inviting a kind reference to the letter and subject cited above we are enclosing herewith a demand draft amounting Rs 06,14,58,700.00 (Rupees six crores fourteen lakhs fifty eight thousand and seven hundred) only, bearing DD No.650877/dt 23.07.2010 drawn in favour of Compensatory Afforestation Fund (CAF) Orissa, Account No.CA-1585 in Corporation Bank, Lodhi Road, New Delhi.

An undertaking to pay the differential amount in case of upward revision of NPV duly signed is enclosed for necessary action.

Further if the total forest area will not be cleared under the Forest Clearance (FC) or Environmental Clearance (EC) the balance NPV may kindly be refunded. Moreover the total forest area included in this mining lease is not fully explored. One to three years time will be required to complete the exploration and basing on the exploration result, the forest area proved barren shall be surrendered for which the NPV already paid for this non-mineralised forest area may be refunded back to OMC.

This is for favour of kind information and necessary action.

Encls.DD Bearing No. 650877/dt 23.07.2010

Yours faithfully

Dy. General Manager (Geology)

Power of attorney holder

Memo No. 14324 /OMC/F&amp;E/10, dt 23.07.2010

Copy to the Regional Chief Conservator of Forests, Rourkela/ CCF (Nodal), O/o the PCCF, Orissa, Bhubaneswar for kind information and necessary action.

Dy. General Manager (Geology)

Power of attorney holder

Memo No. .... /OMC/F&amp;E/10, dt 23.07.2010

Copy to the Regional Manager, Barbil/ Manager (Acts), H.O. for kind information and necessary action.

Dy. General Manager (Geology)

Power of attorney holder

epc

INSTRUMENTS FOR RF 30.0KV & ABOVE ARE NOT VALID UNLESS SIGNED BY TWO OFFICERS

दिनांक / DATE 23/07/2010  
 Key TUGKOP  
 Srl No. 622993

Key TUGKOP  
SF No 622993

SGP No. 622993

ॐ नमो भगवते वासुदेवाय ॥

रु. 61458700/- Ps. 00

अदा करें।

मूल्य प्राप्त / VALUE RECEIVED

STATE BANK OF INDIA  
DRAWEE

C. R. MOHAPATRA  
AUTHORIZED SIGNATORY  
M-5205

BRANCH MANAGER

Key: TUGKOP Sr. No: 622993

(हस्ताक्षर गणना क्र०) S. No. JAGADISH RATH  
SS No.-R-8779

№ 508 771 00000 20001 00,0 10 711 17



Office Order No. 299 /Mining  
Dated, Keonjhar the 19.6.2010.

Parulipada

01. Whereas M/s. OMC Ltd has applied for ML/RML under Section- 2 of F.C. Act over 104.860 ha. of land for their Parulipada Manganese Mines out of which 84.190 ha. is forest land as per the following classification:
- |                   |             |
|-------------------|-------------|
| i. Reserve Forest | - 31.93Ha.  |
| ii Revenue Forest | - 52.26Ha   |
| Total             | - 84.19 Ha. |
02. Whereas the Apex Court on the recommendation of Central Empowered Committee have issued order for recovery of NPV for the entire forest area deducting the amount of NPV already paid.
03. Whereas the Divisional Forest Officer is vested with the authority by the Apex Court to issue Demand by 24<sup>th</sup> of June, 2010 at the appropriate rate depending on Eco-value class and the canopy density of the forest area in question.
04. Whereas the lessee has already paid an amount of Rs. Nil towards NPV in respect of forest land.
05. Whereas the forest area in question falls under Class - I of Eco-value class for which NPV for Rs. 6,14,58,700/- is to be charged at the rate of Rs.7,30,000/- per ha. over an area of 84.19 ha
06. Now therefore the undersigned by virtue of authority vested by the Apex Court, hereby issue demand notice for payment of differential amount of Rs. . 6,14,58,700/- towards NPV within 30 days of issue of this order, failing which the payment along with the interest is to be deposited. The above amount be deposited in shape of Demand Draft drawn in favour of Compensatory Afforestation Fund (CAF) Orissa, Account No. CA-1585 in Corporation Bank Lodhi Road, New Delhi.
- It is further ordered that in the event of upward revisions of NPV, an undertaking to pay the differential is to be submitted by the lessee.

(S.K. Mohanty, IFS)  
Divisional Forest Officer,  
Keonjhar Division.

Memo No 5071 /Dated. 19-6-10  
Copy forwarded to the Regional Manager, M/s OMC, Barbil, At / Po- Barbil,  
Dist-Keonjhar for information.

19-6-10  
Divisional Forest Officer,  
Keonjhar Division.

Memo No /Dated.  
Copy forwarded to the Range Officer, Barbil Range for information and  
necessary action..

Divisional Forest Officer,  
Keonjhar Division.



# Odisha Mining Corporation Limited

ANNEXURE-III  
Serial.

(A GOLD CATEGORY STATE PSU)  
No. 5203 /OMC/2016  
11<sup>th</sup> April, 2016  
12

To

The Principal Secretary to Govt.  
Govt. of Odisha  
Steel & Mines Department  
Bhubaneswar.

Sub: Extension of validity period of Parlipada manganese mining lease of OMC over 104.86 H. in Keonjhar district: Allowing further time for execution of Supplementary lease deed.

Ref: Govt. of Odisha, Steel & Mines Department order no. III(MN) SM-21/2015/513/SM, dated 19.1.16.

Sir,

In inviting a reference to the above letter and subject this is to submit that State Govt. in terms of rule 3 (1) of Mineral (Mining by Government Company) Rule, 2015 has extended the lease period of Parlipada ML of OMC over 104.86 H for manganese in Keonjhar district till 24.4.31 subject to execution of supplementary lease deed, obtaining all statutory clearances and payment of requisite dues within 3 months, i.e. before 19.4.2016. Earlier Collector, Keonjhar vide letter no. 1353, dated 24.8.15 had intimated that supplementary lease deed cannot be executed in absence of part or full forest clearance under section 2 of FC Act, 1980 (copy enclosed).

FDP for Parlipada ML has not yet been processed due to want of land use plan covering entire forest land. Land use plan covering entire lease hold could not be prepared so far due to non-availability of exploration data for total lease area.

Meanwhile, permission for exploration in Form-'C' under FC Act has been applied, which is under consideration. ORSAC and the approved team of State Govt. are preparing the authenticated DGPS ML map and map showing the forest area boundary inside the lease hold. FDP will be processed after landuse plan is finalized. OMC has also requested State Govt. to kindly seek approval under section 2 (iii) of FC Act for execution of lease deed vide letter no. 4665/OMC, dated 31.3.16.

In view of above, further time of minimum one year may kindly be allowed so as to enable OMC to obtain statutory clearances & execute supplementary lease deed extending the lease period of Parlipada ML of OMC for manganese till 24.4.31 and commence mining operation.

Yours faithfully,

Memo No. 5204 /OMC/ 2016

Copy to the **Director of Mines, Odisha, Directorate of Mines, Bhubaneswar/ Collector, Keonjhar** for kind information.

Managing Director  
11<sup>th</sup> April, 2016  
12

Managing Director

Memo No. 5205 /OMC/2016

11<sup>th</sup> April, 2016

Copy to the **Mining Officer, Keonjhar /Regional Manager, OMC Limited, Barbil/ Dy. General Manager (M) Production/ Dy. General Manager (M), PMC/ Sr. Manager (Geo) F&E**, OMC Limited, Bhubaneswar for kind information and necessary action.

Dy. General Manager (Geo)

o/e



# Odisha Mining Corporation Limited

(A GOLD CATEGORY STATE PSU)

1143

No. 4665 /OMC/GS/2016  
31<sup>st</sup> March, 2016

To

**Addl. Secretary to Govt.,  
Department of Steel & Mines  
Government of Odisha  
Bhubaneswar**

Sub: Guidelines dated 19.10.15 & 10.11.15 issued by MoEF & CC for diversion of forest land for non-forest purpose: Seeking approval of MoEF & CC, Govt. of India under section 2 (iii) of FC Act in respect of different mining leases of OMC.

- Ref: (1) FC Guideline no. F. No. 11-599/2014-FC, dated 19.10.2015  
(2) FC Guideline no.F. No.11-599/2014-FC, dated 10.11.2015  
(3) Minerals (Mining by Govt. company) Rule, 2015.

Sir,

In inviting a reference to the above cited subject and MoEF guidelines, we are enclosing herewith a list of mining leases of OMC giving details of information with a request to kindly seek general approval under section 2 (iii) of FC Act, 1980, so as to enable OMC to execute the supplementary lease deed and commence mining operation at the earliest.

Yours faithfully,

Managing Director

Encl: as above.

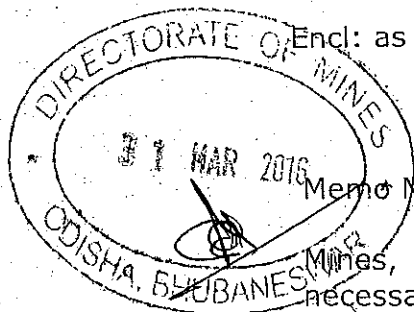

Memo No. 4666 /OMC/GS/2016

31<sup>st</sup> March, 2016

Copy to the **Director of Mines**, Odisha, Directorate of Mines, Govt. of Odisha, Bhubaneswar for kind information and necessary action.

Copy to the **Addl. General Manager (M)/ Sr. Manager (F&E)**, OMC Limited, Bhubaneswar for kind information and necessary action.

Dy. General Manager (Geo)

OK  
Geologist  
Section

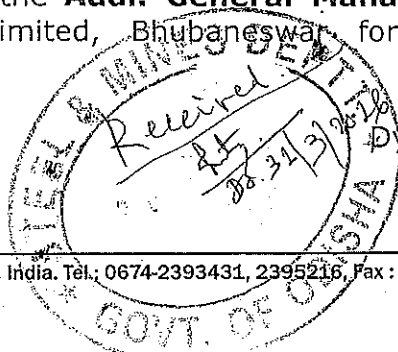

142

**Details of Mining leases of OMC for which approval under section 2(iii) of FC Act is required**

Sl. No	Name of the mine (District)	Mineral	Area in Hects			Date of execution	Period of Lease	Lease Status
			Forest	Non-Forest	Total			
1	Kaliapani (Jajpur)	Chromite	749.995	221.25	971.245	8.7.67	20 years (8.7.67-7.7.87)	1 <sup>st</sup> RML filed on 24.5.86 (8.7.87-7.7.2007). 2 <sup>nd</sup> RML applied on 4.7.06 for 20 yrs (8.7.07-7.7.2027).
2	Kathpal (Dhenkanal)	Chromite	176.69	87.776	264.466	10.2.69 over 386.879 hecta	20 years (10.2.69-9.2.89)	1 <sup>st</sup> RML filed on 6.2.88 (10.2.89-9.2.09). 2 <sup>nd</sup> RML filed on 29.1.08 for 20 yrs. (10.2.09-9.2.2029).
3	Kalarangi (Jajpur)	Chromite	700.12	236.10	936.22	9.12.66	20 years (9.12.66-8.12.86)	1 <sup>st</sup> RML filed on 30.10.85 (9.12.86-8.12.2006). 2 <sup>nd</sup> RML applied on 29.11.05 for 20 yrs (9.12.2006-8.12.2026).
4	Boula (Keonjhar)	Chromite	207.36	-	207.36	7.8.65	20 years (7.8.65-6.8.85)	1 <sup>st</sup> RML filed on 19.7.84 (7.8.85-6.8.2005). 2 <sup>nd</sup> RML filed on 28.7.04 for 20 yrs (7.8.2005-6.8.2025).
5	Birasal (Dhenkanal)	Chromite	504.3	78.721	583.021	4.11.76	20 years (4.11.76-3.11.96)	1 <sup>st</sup> RML filed on 1.11.95 for 20 yrs (4.11.96-3.11.2016).
6	Baniapank (Keonjhar)	Chromite	295.3891	1287.444	1582.833	15.1.86	20 years (15.1.86-14.1.06)	1 <sup>st</sup> RML filed on 1.1.05 for 20 yrs. (15.1.06-14.1.2026).
7	Base of Mahagiri (Jajpur)	Chromite	185.81	-	185.81	9.9.70	20 years (9.9.70-8.9.90)	1 <sup>st</sup> RML filed on 19.8.89 (20 yrs 9.9.90-8.9.2010). 2 <sup>nd</sup> RML filed on 29.8.09 for 20 yrs (9.9.2010-8.9.2030).
8	Saruabil-Sukrangi (Jajpur)	Chromite	23.243	-	23.243	29.1.81	15 years (29.1.81-28.1.96)	1 <sup>st</sup> RML filed on 20.1.95 for 20 yrs (29.1.96-28.1.2016). 2 <sup>nd</sup> RML applied on 12.01.2015.
9	Gandhamardan-A (Keonjhar)	Iron	519.7472	98.8288	618.576	21.5.63	30 years (21.5.63-20.5.93)	1 <sup>st</sup> RML filed on 6.4.92 for 20 yrs (21.5.93-

								20.5.2013). 2 <sup>nd</sup> RML filed on 1.5.12 for a further period of 20 years (21.5.2013-20.5.33).
10	Banspani (Keonjhar)	Iron	188.717	191.683	380.4	21.5.66	30 years (21.5.66-20.5.96)	1 <sup>st</sup> RML filed on 17.5.95 for 20 yrs. (21.5.96-20.5.2016).
11	Khandbandh (Keonjhar)	Iron	294.53	71.781	366.311	30.11.63	30 years (30.11.63-29.11.93)	1 <sup>st</sup> RML filed on 9.11.92 for 20 years (30.11.93-29.11.2013). 2 <sup>nd</sup> RML filed on 14.11.12 (30.11.13-29.11.33)
12	Tiringpahar (Keonjhar)	Iron	79.3		79.3	24.8.64	30 years (24.8.64-23.8.94)	1 <sup>st</sup> RML filed on 13.8.93 for 20 yrs (24.8.94-23.8.2014). 2 <sup>nd</sup> RML filed on 23.7.13.
13	BPJ (Keonjhar)	Iron	359.28	477.4083	836.6883 (Original lease area 861.521 Hects)	27.2.70 over 861.521 Hects	30 years (27.2.70-26.2.00)	1 <sup>st</sup> RML filed on 24.2.99 for 20 yrs. (27.2.00-26.2.2020).
14	Koira-Bhanjpali (Sundargarh)	Iron	99.963	41.272	141.235	6.4.87 (w.e.f. 7.5.82)	30 years (7.5.82 - 6.5.2012)	1 <sup>st</sup> RML was filed on 26.4.2011 for 20 years (7.5.12-6.5.32).
15	Koira-Kasira (Sundargarh)	Iron	231.670	186.685	418.355	13.10.76	20 years (13.10.76-12.10.96)	1 <sup>st</sup> RML filed on 6.10.95 for 20 yrs (13.10.96-12.10.2016.).
16	Rantha (Sundargarh)	Iron	268.8731		268.8731	31.12.68 over 408.8731 Hects	30 years (31.12.68-30.12.98)	1 <sup>st</sup> RML filed on 26.12.97 for 20 yrs (31.12.98-30.12.2018).
17	Sekradihi (area-564.64H) (Keonjhar)	Iron & Manganese	1141.697	190.322	1322.998 4 (amalgamated area over 1332.019 )	Sakeradihi for iron : 28.12.59	30 years (28.12.59-27.12.89)	1 <sup>st</sup> RML was filed on 17.12.88 for 20 yrs (28.12.89-27.12.09).
	Dubna (Area-1135.419 H) (Keonjhar)					Dubna for manganese : 8.9.71	20 years (8.9.1971-7.9.1991)	1 <sup>st</sup> RML filed on 25.8.90 for 20 years (8.9.91-7.9.2011). Two leases amalgamated to 1332.019 hecets vide Govt. order No.3607 dt.18.2.06 for balance period of Sekdradihi i.e. till 28.12.09. 2 <sup>nd</sup>



(140) 

								RML filed on 18.3.08 over revised area of 1322.9984 H for 20 yrs. (28.12.09-27.12.2029).
18	Seremda-Bhadrasahi (Keonjhar)	Iron & Manganese	1086.756	647.814	1734.57	30.8.86	20 years (30.8.86-29.8.06)	1 <sup>st</sup> RML filed on 7.3.05 for 20 yrs (30.8.06-29.8.2026).
19	Dalki (Keonjhar)	Iron & Manganens e	246.524	18.766	265.29	19.11.88	20 years w.e.f. 7.8.76 (7.8.76-6.8.96)	1 <sup>st</sup> RML filed on 18.7.95 for 20 yrs (7.8.96-6.8.2016).
20	Nishikhal (Rayagada)	Manganese	454.79	46.88	501.67	28.6.64	20 years (28.6.64-27.6.84)	1 <sup>st</sup> RML executed (28.6.84-27.6.2004). 2 <sup>nd</sup> RML filed on 26.6.03. for 20 yrs. (28.6.04-27.6.2024).
21	Roida-78 (Keonjhar)	Manganese	78.711		78.711	25.4.81	20 years (25.4.81-24.4.01)	1 <sup>st</sup> RML filed on 22.4.00 for 20 yrs (25.4.01 - 24.4.2021).
22	Parlipada (Keonjhar)	Manganese	84.188	20.672	104.86	25.4.81 over 170.17 hec	20 years (25.4.81-24.4.01)	1 <sup>st</sup> RML filed on 22.4.00 for 20 yrs (25.4.01-24.4.2021).
23	Umpavally (Koraput)	Limestone	215.79	644.2	859.99	20.8.75 over 1300.79 hec	20 years (20.8.75-19.8.95)	1 <sup>st</sup> RML filed on 12.8.94 for 20 yrs. (20.8.95-19.8.2015). 2 <sup>nd</sup> RML applied on 02.08.2014 for 20 yrs (20.08.2015-19.08.2035).